

NOTICE IS HEREBY GIVEN that the Lake No. 309
 lode mining claim has been located by AMERICAN SELCO INC.
 a New York corporation, whose address is 90 West Grove Street,
 Suite 100, Reno, Nevada 89509. The general course of this claim
 is North/South. This claim is 1500 feet in length
 along the course of the claim, being 20 feet from the point
 of discovery in a North direction to the North end
 line of this claim, and 1480 feet in a South
 direction to the South end line of the claim. This claim is
 600 feet in width, being 300 feet in width on each side of the
 center line of the claim.

This claim is located within the 1 SW Quarter
 of Section 14, Township 18 North, Range 52
 East, Mount Diablo Base and Meridian, unknown Mining District,
 Eureka County, Nevada. The location monument of this claim is
 situated with reference to some natural object or permanent monument
 as follows: The number one corner of this claim is located approx-
imately 9,600 feet S 37°W from CLM-LA-3.

The claim location marker LA-3, a 3" x 6" steel pipe is loc-
 ated approximately 7,350' N 69½° W of BM 7709; 6,800' N 24° E of BM
 7336; 10,100' S 85½ E of Temple Peak.

The corners of this claim are marked by 4"x4" posts or 4" trees
 with metal tags inscribed with the appropriate corner number as
 shown on the following sketch and the accompanying claim map.

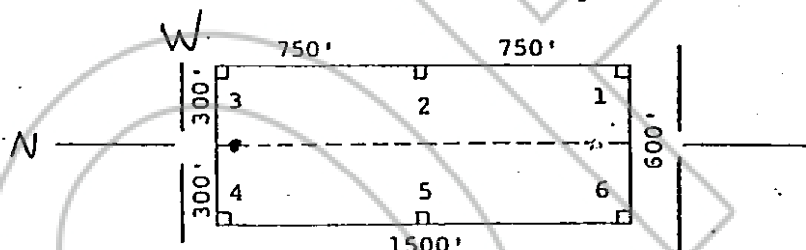

The location work consisted of making the maps as provided in
 NRS 517.040.

Dated and posted on the ground this 7 day of November
 1990.

Witnesses:

Locator:

AMERICAN SELCO INC.

By

Agent for

American Selco Inc.

RECORDED AT REQUEST OF
 AMERICAN SELCO INC.
 BOOK 91 PAGE 85

STATE OF NEVADA
 COUNTY OF

)
) ss.
)

I hereby certify that the within
 instrument was filed and recorded at
 the request of: _____
 FILE NO. _____
 on _____
 at _____
 Docket _____ Page _____

Witness my hand and official
 seal the day and year aforesaid.

 County Recorder
 By BOOK 91 PAGE 85
 Deputy Recorder