

78786

STATE OF NEVADA
 CERTIFICATE OF MINING LOCATION
 LODE CLAIM ON PUBLIC DOMAIN

NOTICE IS HEREBY GIVEN that the St. Pat No. 413 lode mining claim has been located by AMERICAN SELCO INC. a New York corporation, whose address is 90 West Grove Street, Suite 100, Reno, Nevada 89509. The general course of this claim is North/South. This claim is 1500 feet in length along the course of the claim, being 1490 feet from the point of discovery in a North direction to the North end line of this claim, and 10 feet in a South direction to the South end line of the claim. This claim is 600 feet in width, being 300 feet in width on each side of the center line of the claim.

This claim is located within the SE/NE Quarter of Section 16/21, Township 18 North, Range 52 East, Mount Diablo Base and Meridian, EUREKA Mining District, EUREKA County, Nevada. The location monument of this claim is situated with reference to some natural object or permanent monument as follows: The #3 corner of this claim is located approximately 22,300 feet N47°W from the S.E. corner of section 36T18N; R52E MDM

The corners of this claim are marked by 4"x4" posts or 4" trees with metal tags inscribed with the appropriate corner number as shown on the following sketch and the accompanying claim map.

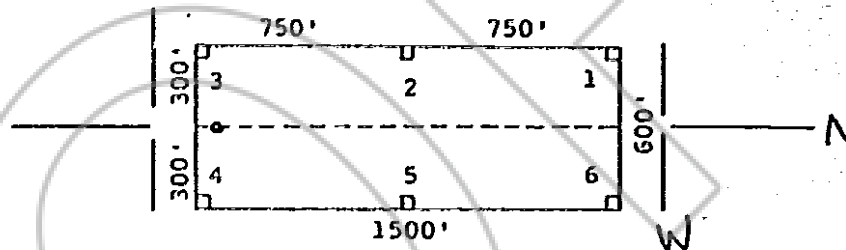

The location work consisted of making the maps as provided in NRS 517.040.

Dated and posted on the ground this 27 day of January, 1981.

Witnesses: AMERICAN SELCO INC
 BOOK 91 PAGE 306

Locator:

AMERICAN SELCO INC.

By Mike Perry
 Agent for
American Selco Inc.

81 FEB 8 AM 10

OFFICIAL RECORDS
 EUREKA COUNTY, NEVADA
 WILLIS A. DEPAULIS-RECORDER
 FILE NO. 78786
 FEE \$ 3.00

STATE OF NEVADA)
) ss.
 COUNTY OF _____)

I hereby certify that the within instrument was filed and recorded at the request of: _____
 FILE NO. _____
 on _____
 at _____
 Docket _____ Page _____

Witness my hand and official seal the day and year aforesaid.

County Recorder

By BOOK 91 PAGE 306
 Deputy Recorder

STATE OF NEVADA
 CERTIFICATE OF MINING LOCATION
 LODE CLAIM ON PUBLIC DOMAIN

NOTICE IS HEREBY GIVEN that the St. Pat No. 414 lode mining claim has been located by AMERICAN SELCO INC. a New York corporation, whose address is 90 West Grove Street, Suite 100, Reno, Nevada 89509. The general course of this claim is North/South. This claim is 1500 feet in length along the course of the claim, being 1490 feet from the point of discovery in a North direction to the North end line of this claim, and 10 feet in a South direction to the South end line of the claim. This claim is 600 feet in width, being 300 feet in width on each side of the center line of the claim.

This claim is located within the SE/NE Quarter of Section 16/21, Township 18 North, Range 52 East, Mount Diablo Base and Meridian, Eureka Mining District, Eureka County, Nevada. The location monument of this claim is situated with reference to some natural object or permanent monument as follows: The #3 corner of this claim is located approximately 22,300 feet N 47° W from the S.E. corner of section 36T18N; R52E MDM

The corners of this claim are marked by 4"x4" posts or 4" trees with metal tags inscribed with the appropriate corner number as shown on the following sketch and the accompanying claim map.

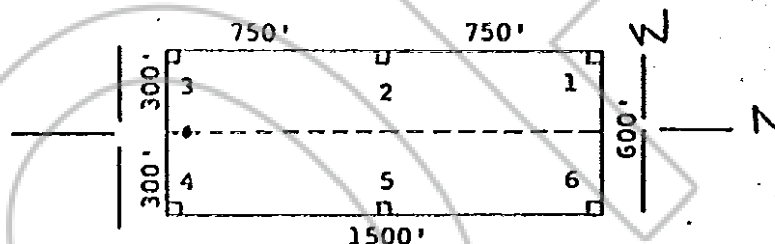

The location work consisted of making the maps as provided in NRS 517.040.

Dated and posted on the ground this 27 day of January, 1981.

Witnesses: RECORDED AT REQUEST OF
AMERICAN SELCO INC. Locator:
BOOK 91 PAGE 307

AMERICAN SELCO INC.

By Mike Perry
 Agent for
American Selco Inc.

81 FEB 6 AM: 11

OFFICIAL RECORDS
 EUREKA COUNTY, NEVADA
 WILLIS A. DEPAULI, RECORDER
 FILE NO. 78787
 FEE \$ 3.00

STATE OF NEVADA

COUNTY OF _____

) ss.

I hereby certify that the within instrument was filed and recorded at the request of: _____

FILE NO. _____

on _____

at _____

Docket _____

page _____

Witness my hand and official seal the day and year aforesaid.

County Recorder

By BOOK 91 PAGE 307
 Deputy Recorder

78788 STATE OF NEVADA
CERTIFICATE OF MINING LOCATION
LODE CLAIM ON PUBLIC DOMAIN

NOTICE IS HEREBY GIVEN that the St. Pat No. 415
lode mining claim has been located by AMERICAN SELCO INC.
a New York corporation, whose address is 90 West Grove Street,
Suite 100, Reno, Nevada 89509. The general course of this claim
is North/South. This claim is 1500 feet in length
along the course of the claim, being 1490 feet from the point
of discovery in a North direction to the "North" end
line of this claim, and 10 feet in a South
direction to the South end line of the claim. This claim is
600 feet in width, being 300 feet in width on each side of the
center line of the claim.

This claim is located within the SW/NW Quarter
of Section 15/22, Township 18 North, Range 52
East, Mount Diablo Base and Meridian, Eureka Mining District,
Eureka County, Nevada. The location monument of this claim is
situated with reference to some natural object or permanent monument
as follows: The #3 corner of this claim is located approximately
21450' feet N45°W from the S.E. corner of
section 36T18N; R52E MDM

The corners of this claim are marked by 4"x4" posts or 4" trees
with metal tags inscribed with the appropriate corner number as
shown on the following sketch and the accompanying claim map.

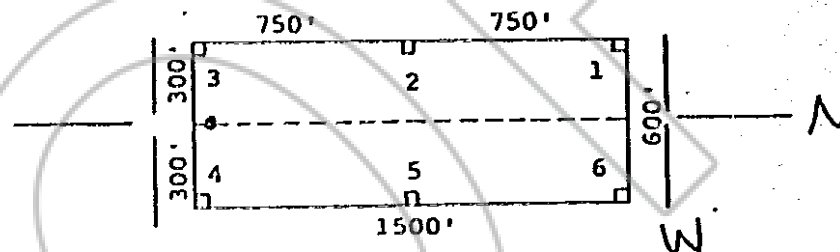

The location work consisted of making the maps as provided in
NRS 517.040.

Dated and posted on the ground this 27 day of January,
1981

Witnesses:

RECORDED AT REQUEST OF
AMERICAN SELCO INC

BOOK 91 PAGE 308

Locator:

AMERICAN SELCO INC.

81 FEB 6 AM 11

OFFICIAL RECORDS
EUREKA COUNTY, NEVADA
WILLIS A. DEPAULI-RECORDER
FILE NO. 78788
FEE \$ 3.00

By Mike Perry
Agent for
American Selco Inc.

STATE OF NEVADA)

COUNTY OF _____) ss.

I hereby certify that the within
instrument was filed and recorded at
the request of: _____

FILE NO. _____

on _____

at _____

Docket _____ page _____

Witness my hand and official
seal the day and year aforesaid

County Recorder

By BOOK 91 PAGE 308
Deputy Recorder

78789 STATE OF NEVADA
CERTIFICATE OF MINING LOCATION
LODE CLAIM ON PUBLIC DOMAIN

NOTICE IS HEREBY GIVEN that the St. Pat No. 416 lode mining claim has been located by AMERICAN SELCO INC. a New York corporation, whose address is 90 West Grove Street, Suite 100, Reno, Nevada 89509. The general course of this claim is North/South. This claim is 1500 feet in length along the course of the claim, being 1490 feet from the point of discovery in a North direction to the "North" end line of this claim, and 10 feet in a South direction to the South end line of the claim. This claim is 600 feet in width, being 300 feet in width on each side of the center line of the claim.

This claim is located within the SW/NW Quarter of Section 15/22, Township 18 North, Range 52 East, Mount Diablo Base and Meridian, Eureka Mining District, Eureka County, Nevada. The location monument of this claim is situated with reference to some natural object or permanent monument as follows: The #3 corner of this claim is located approximately 21,450 feet N45°W from the S.E. corner of section 36T18N; R52E MDM

The corners of this claim are marked by 4"x4" posts or 4" trees with metal tags inscribed with the appropriate corner number as shown on the following sketch and the accompanying claim map.

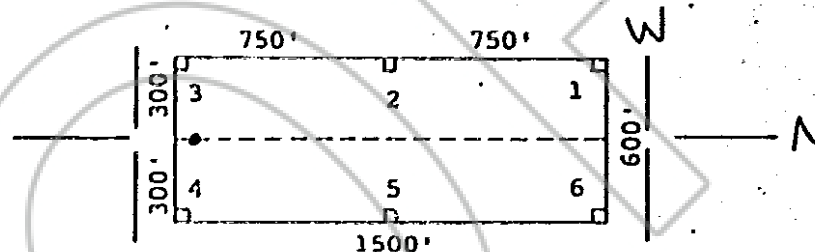

The location work consisted of making the maps as provided in NRS 517.040.

Dated and posted on the ground this 27 day of January, 1981

Witnesses: RECORDED AT REQUEST OF
AMERICAN SELCO INC
BOOK 91 PAGE 309

Locator:

AMERICAN SELCO INC.

By Mike Perry
Agent for
American Selco Inc.

FILED FEB 6 AM 11
OFFICIAL RECORDS
EUREKA COUNTY, NEVADA
WILLIS A. DEPAOLI - RECORDER
FILE NO. 78789
FEE \$ 3.00

STATE OF NEVADA)

COUNTY OF _____) ss.

I hereby certify that the within instrument was filed and recorded at the request of:

FILE NO. _____

on _____

at _____

Docket _____

Page _____

Witness my hand and official seal the day and year aforesaid.

County Recorder

By BOOK 91 PAGE 309
Deputy Recorder

78790 STATE OF NEVADA
CERTIFICATE OF MINING LOCATION
LODE CLAIM ON PUBLIC DOMAIN

NOTICE IS HEREBY GIVEN that the St. Pat No. 417
lode mining claim has been located by AMERICAN SELCO INC.
a New York corporation, whose address is 90 West Grove Street,
Suite 100, Reno, Nevada 89509. The general course of this claim
is North/South. This claim is 1500 feet in length
along the course of the claim, being 1490 feet from the point
of discovery in a North direction to the North end
line of this claim, and 10 feet in a South
direction to the South end line of the claim. This claim is
600 feet in width, being 300 feet in width on each side of the
center line of the claim.

This claim is located within the SW/NW Quarter
of Section 15/22, Township 18 North, Range 52
East, Mount Diablo Base and Meridian, Eureka Mining District,
Eureka County, Nevada. The location monument of this claim is
situated with reference to some natural object or permanent monument
as follows: The #3 corner of this claim is located approximately
20600 feet N 43° W from the S.E. corner of
section 36T18N; R52E MDM

The corners of this claim are marked by 4"x4" posts or 4" trees
with metal tags inscribed with the appropriate corner number as
shown on the following sketch and the accompanying claim map.

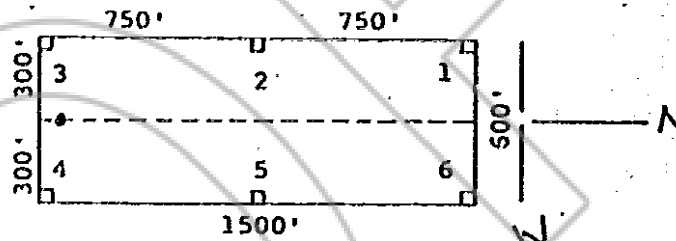

The location work consisted of making the maps as provided in
NRS 517.040.

Dated and posted on the ground this 27 day of January,
1981

Witnesses: RECORDED AT REQUEST OF
AMERICAN SELCO INC
BOOK 91 PAGE 310

Locator:

AMERICAN SELCO INC.

By

Mr. Perry
Agent for

American Selco Inc.

OFFICIAL RECORDS
EUREKA COUNTY, NEVADA
WILLIS A. DEPAOLI - RECORDER
FILE NO. 78790
FEE \$ 3.00

STATE OF NEVADA)

) ss.

COUNTY OF _____)

I hereby certify that the within instrument was filed and recorded at the request of: _____

FILE NO. _____

on _____

at _____

Docket _____

page _____

County Recorder

By

BOOK 91 PAGE 310

Deputy Recorder

78791 STATE OF NEVADA
CERTIFICATE OF MINING LOCATION
LODE CLAIM ON PUBLIC DOMAIN

NOTICE IS HEREBY GIVEN that the St. Pat No. 418
lode mining claim has been located by AMERICAN SELCO INC.
a New York corporation, whose address is 90 West Grove Street,
Suite 100, Reno, Nevada 89509. The general course of this claim
is North/South. This claim is 1500 feet in length
along the course of the claim, being 1490 feet from the point
of discovery in a North direction to the North end
line of this claim, and 10 feet in a South
direction to the South end line of the claim. This claim is
600 feet in width, being 300 feet in width on each side of the
center line of the claim.

This claim is located within the SW/NW Quarter
of Section 15/22, Township 18 North, Range 52
East, Mount Diablo Base and Meridian, Eureka Mining District,
Eureka County, Nevada. The location monument of this claim is
situated with reference to some natural object or permanent monument
as follows: The #6 corner of this claim is located approximately
21,300 feet N39°W from the S.E. corner of
section 36T18N; R52E MDM

The corners of this claim are marked by 4"x4" posts or 4" trees
with metal tags inscribed with the appropriate corner number as
shown on the following sketch and the accompanying claim map.

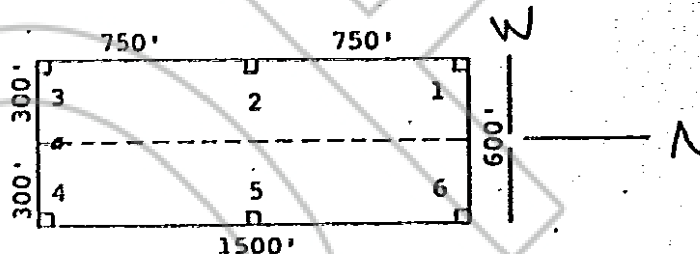

The location work consisted of making the maps as provided in
NRS 517.040.

Dated and posted on the ground this 27 day of January,
1981

Witnesses: RECORDED AT REQUEST OF
AMERICAN SELCO INC Locator:
BOOK 91 PAGE 311

AMERICAN SELCO INC.

8 FEB 6 AM: 11

OFFICIAL RECORDS
EUREKA COUNTY, NEVADA
WILLIS A. DEPAOLI-RECORDER
FILE NO. 78791
FILE # 3.00

By Mike Perry
Agent for
American Selco Inc.

STATE OF NEVADA)

COUNTY OF) ss.

I hereby certify that the within
instrument was filed and recorded at
the request of:

FILE NO.

on

at

Docket Page

Witness my hand and official
seal the day and year aforesaid

County Recorder

By BOOK 91 PAGE 311
Deputy Recorder

**78792 STATE OF NEVADA
CERTIFICATE OF MINING LOCATION
LODE CLAIM ON PUBLIC DOMAIN**

NOTICE IS HEREBY GIVEN that the St. Pat No. 419
lode mining claim has been located by AMERICAN SELCO INC.
a New York corporation, whose address is 90 West Grove Street,
Suite 100, Reno, Nevada 89509. The general course of this claim
is North/South. This claim is 1500 feet in length
along the course of the claim, being 1490 feet from the point
of discovery in a North direction to the "North" end
line of this claim, and 10 feet in a South
direction to the South end line of the claim. This claim is
600 feet in width, being 300 feet in width on each side of the
center line of the claim.

This claim is located within the SW Quarter
of Section 15, Township 18 North, Range 52
East, Mount Diablo Base and Meridian, Eureka Mining District,
Eureka County, Nevada. The location monument of this claim is
situated with reference to some natural object or permanent monument
as follows: The #6 corner of this claim is located approximately
21,360 feet N39°W from the S.E. corner of
Section 36T18N; R52E MDM

The corners of this claim are marked by 4"x4" posts or 4" trees
with metal tags inscribed with the appropriate corner number as
shown on the following sketch and the accompanying claim-map.

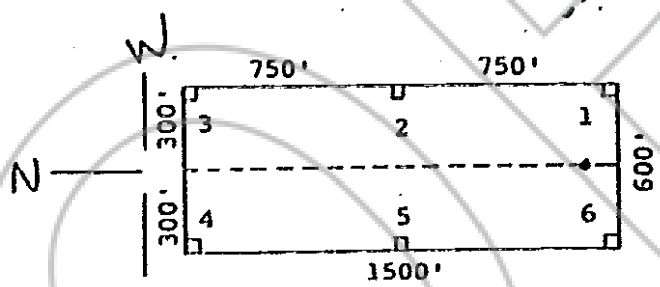

The location work consisted of making the maps as provided in
NRS 517.040.

Dated and posted on the ground this 27 day of January,
1981.

RECORDED AT REQUEST OF
Witnesses: AMERICAN SELCO INC
BOOK 91 PAGE 312

Locator:
AMERICAN SELCO INC.

By Mike Perry
Agent for
American Selco Inc.

81 FEB 6 AM 11
OFFICIAL RECORDS
EUREKA COUNTY, NEVADA
WILLIS A. DENK, RECORDER
FILE NO. 78792
FEE \$ 3.00

STATE OF NEVADA)
COUNTY OF) ss.

I hereby certify that the within
instrument was filed and recorded at
the request of:
FILE NO.
on
at
Docket Page

Witness my hand and official
seal the day and year aforesaid.

County Recorder
By BOOK 91 PAGE 312
Deputy Recorder