

**78791 STATE OF NEVADA
 CERTIFICATE OF MINING LOCATION
 LODE CLAIM ON PUBLIC DOMAIN**

NOTICE IS HEREBY GIVEN that the St. Pat No. 418 lode mining claim has been located by AMERICAN SELCO INC. a New York corporation, whose address is 90 West Grove Street, Suite 100, Reno, Nevada 89509. The general course of this claim is North/South. This claim is 1500 feet in length along the course of the claim, being 1490 feet from the point of discovery in a North direction to the North end line of this claim, and 10 feet in a South direction to the South end line of the claim. This claim is 600 feet in width, being 300 feet in width on each side of the center line of the claim.

This claim is located within the SW/NW Quarter of Section 15/22, Township 18 North, Range 52 East, Mount Diablo Base and Meridian, Mining District, County, Nevada. The location monument of this claim is situated with reference to some natural object or permanent monument as follows: The #6 corner of this claim is located approximately 21,300 feet N39'W from the S.E. corner of section 36T18N; R52E MDM

The corners of this claim are marked by 4"x4" posts or 4" trees with metal tags inscribed with the appropriate corner number as shown on the following sketch and the accompanying claim map.

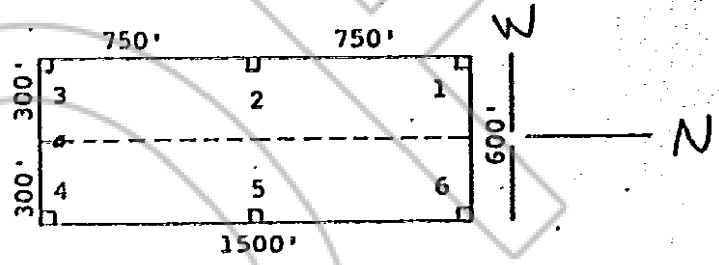

The location work consisted of making the maps as provided in NRS 517.040.

Dated and posted on the ground this 27 day of January, 1981

Witnesses: RECORDED AT REQUEST OF AMERICAN SELCO INC Locator:
BOOK 91 PAGE 311

AMERICAN SELCO INC.

8 FEB 6 AM: 11

By Mike Perry
 Agent for
 American Selco Inc.

OFFICIAL RECORDS
 EUREKA COUNTY, NEVADA
 WILLIS A. DEPAOLI-RECORDER
 FILE NO. 78791
 FEE \$ 3.00

STATE OF NEVADA)
)
 COUNTY OF) ss.

I hereby certify that the within instrument was filed and recorded at the request of: _____
 FILE NO. _____
 on _____
 at _____
 Docket _____ Page _____

Witness my hand and official seal the day and year aforesaid

 County Recorder
 By BOOK 91 PAGE 311
 Deputy Recorder