

**78792 STATE OF NEVADA
CERTIFICATE OF MINING LOCATION
LODE CLAIM ON PUBLIC DOMAIN**

NOTICE IS HEREBY GIVEN that the St. Pat No. 419
lode mining claim has been located by AMERICAN SELCO INC.
a New York corporation, whose address is 90 West Grove Street,
Suite 100, Reno, Nevada 89509. The general course of this claim
is North/South. This claim is 1500 feet in length
along the course of the claim, being 1490 feet from the point
of discovery in a North direction to the "North" end
line of this claim, and 10 feet in a South
direction to the South end line of the claim. This claim is
600 feet in width, being 300 feet in width on each side of the
center line of the claim.

This claim is located within the SW Quarter
of Section 15, Township 18 North, Range 52
East, Mount Diablo Base and Meridian, Eureka Mining District,
Eureka County, Nevada. The location monument of this claim is
situated with reference to some natural object or permanent monument
as follows: The SE corner of this claim is located approximately
21,360 feet N39°W from the S.E. corner of
Section 36T18N; R52E MDM

The corners of this claim are marked by 4"x4" posts or 4" trees
with metal tags inscribed with the appropriate corner number as
shown on the following sketch and the accompanying claim-map.

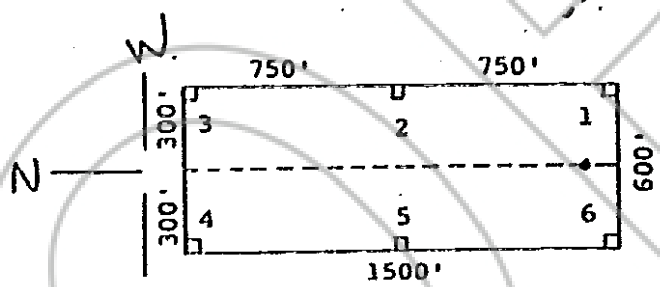

The location work consisted of making the maps as provided in
NRS 517.040.

Dated and posted on the ground this 27 day of January,
1981.

RECORDED AT REQUEST OF
Witnesses: AMERICAN SELCO INC
BOOK 91 PAGE 312

Locator:
AMERICAN SELCO INC.

By Mike Perry
Agent for
American Selco Inc.

81 FEB 6 AM 11

OFFICIAL RECORDS
EUREKA COUNTY, NEVADA
WILLIS A. DENK, RECORDER
FILE NO. 78792
FEE \$ 3.00

STATE OF NEVADA)
COUNTY OF) ss.)

I hereby certify that the within
instrument was filed and recorded at
the request of: _____
FILE NO. _____
on _____
at _____
Docket _____ Page _____

Witness my hand and official
seal the day and year aforesaid.

County Recorder
By BOOK 91 PAGE 312
Deputy Recorder