

NOTICE IS HEREBY GIVEN that St. Pat No. 148 mining claim has been located by American Selco, a New York corporation whose address 90 West Grove Street, Suite 100, Reno, Nevada 89509. This claim is a relocation of the St. Pat No. 148 lode mining claim, the certificate of location of which is of record in the office of the Recorder of Eureka County, Nevada in Book 88 Page 437, in accordance with NRS 517.080. The general course of this claim is North/South. This claim is 150 feet in length along the course of the claim, being 1490 feet from the point of discovery in an North direction to the North end line of this claim, and 10 feet in a South direction to the South end line of the claim. This claim is 600 feet in width, being 300 feet in width on each side of the center line of the claim.

This claim is located within the NE Quarter of Section 4, Township 17 North, Range 52 East, Mount Diablo Base Meridian, Eureka Mining District, Eureka County, Nevada. The location monument of this claim is situated with reference to some natural object or permanent monument as follows: The number one corner of this claim is located approximately 76,300 feet S78°W from the SE corner of section 36, T18N, R52E, MDM.

The corners of this claim are marked by 4" x 4" x 5' posts or pipes with metal tags inscribed with the appropriate corner number as shown in the following sketch and the accompanying claim map.

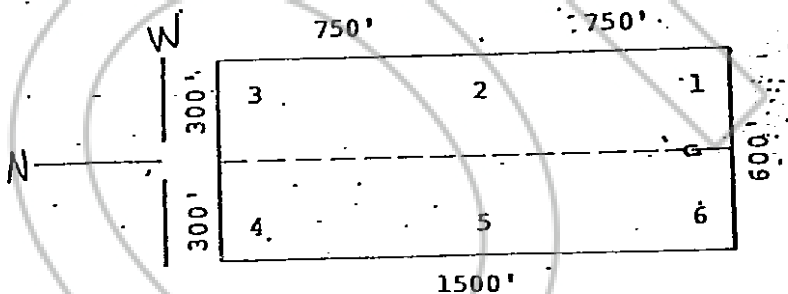

The location work consisted of making the map provided in NRS 517.

Dated and posted on the ground this 17 day of December

1980.

RECORDED AT REQUEST OF AMERICAN SELCO INC

Witnesses:

DATE OF FEB 13 A.O. 48

OFFICIAL RECORDS EUREKA COUNTY NEVADA JULIA A. DEPAULI RECORDER FILE NO. 78857 FEE \$ 3.00

COUNTY OF

Locator:

AMERICAN SELCO, INC.

By Mike Perry Agent for AMERICAN SELCO, INC.

I hereby certify that the within instrument was filed and recorded at the request of:

FILE NO. _____ on _____ at _____ Docket _____ Page _____

Witness my hand and official seal the day and year aforesaid.

BOOK 91 PAGE 446

County Recorder

ny

NOTICE IS HEREBY GIVEN that St. Pat No. 162 lode mining claim has been located by American Selco, a New York corporation, whose address 90 West Grove Street, Suite 100, Reno, Nevada 89509. This claim is a relocation of the St. Pat No. 162 lode mining claim; the certificate of location of which is of record in the office of the Recorder of Eureka County, Nevada in Book 88 Page 451, in accordance with NRS 517.080. The general course of this claim is North/South. This claim is 1500 feet in length along the course of the claim, being: 10 feet from the point of discovery in an North direction to the North end line of this claim, and 1490 feet in a South direction to the South end line of the claim. This claim is 600 feet in width, being 300 feet in width on each side of the center line of the claim.

This claim is located within the SE Quarter of Section 4, Township 17 North, Range 52 East, Mount Diablo Base and Meridian, Eureka Mining District, Eureka County, Nevada. The location monument of this claim is situated with reference to some natural object or permanent monument as follows: The number one corner of this claim is located approximately 12,700 feet S 79°W from the SE corner of section 36, T18N, R52E, MDM.

The corners of this claim are marked by 4" x 4" x 5' posts or pipe with metal tags inscribed with the appropriate corner number as shown on the following sketch and the accompanying claim map.

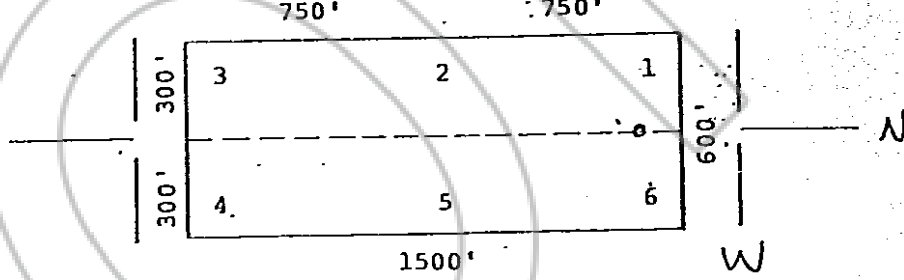

The location work consisted of making the map provided in NRS 517.04 Dated and posted on the ground this 18 day of December

RECORDED AT REQUEST OF AMERICAN SELCO, INC. BOOK 91 PAGE 417

81 FEB 13 AM 11:46
EUREKA COUNTY, NEVADA

OFFICIAL RECORDS
EUREKA COUNTY, NEVADA
WILLIS A. DEPTY
FILE NO. 78858
FEE \$ 3.00

Locator:
AMERICAN SELCO, INC.

By Mike Perry
Agent for
AMERICAN SELCO, INC.

STATE OF NEVADA)
COUNTY OF _____) ss.

I hereby certify that the within instrument was filed and recorded at the request of: _____
FILE NO. _____
on _____
at _____
Docket _____ Page _____

Witness my hand and official seal the day and year aforesaid.

BOOK 91 PAGE 417
County Recorder

By _____
Deputy Recorder

NOTICE IS HEREBY GIVEN that St. Pat No. 163 lode mining claim has been located by American Selco, a New York corporation, whose address 90 West Grove Street, Suite 100, Reno, Nevada 89509. This claim is a relocation of the St. Pat No. 163 lode mining claim, the certificate of location of which is of record in the office of the Recorder of Eureka County, Nevada in Book 88 Page 452, in accordance with NRS 517.080. The general course of this claim is North/South. This claim is 1500 feet in length along the course of the claim, being 10 feet from the point of discovery in an North direction to the North end line of this claim, and 1490 feet in a South direction to the South end line of the claim. This claim is 600 feet in width, being 300 feet in width on each side of the center line of the claim.

This claim is located within the SE Quarter of Section 8, Township 17 North, Range 52 East, Mount Diablo Base and Meridian, Eureka Mining District, Eureka County, Nevada. The location monument of this claim is situated with reference to some natural object or permanent monument as follows: The number one corner of this claim is located approximately 12,700 feet S79°W from the SE corner of section 36, T18N, R52E, MDM.

The corners of this claim are marked by 4" x 4" x 5' posts or pipe with metal tags inscribed with the appropriate corner number as shown on the following sketch and the accompanying claim map.

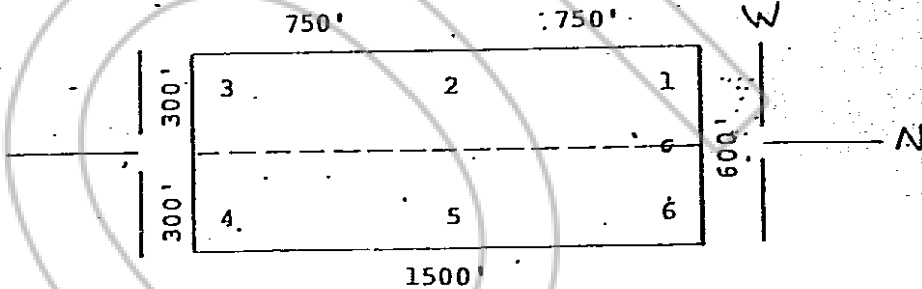

The location work consisted of making the map provided in NRS 517.04 Dated and posted on the ground this 18 day of December

1980
 AMERICAN SELCO, INC.
 BOOK 91 PAGE 418
 FEB 13 10:46
 OFFICIAL RECORDS
 EUREKA COUNTY, NEVADA
 WILLIS A. DEPAOLI, RECORDER
 FILE NO. 78859
 FEE \$ 3.00
 STATE OF NEVADA)
 COUNTY OF _____) ss.

Locator: _____
 AMERICAN SELCO, INC.
 By Mike Peery
 Agent for
 AMERICAN SELCO, INC.

I hereby certify that the within instrument was filed and recorded at the request of: _____
 FILE NO. _____
 on _____
 at _____
 Docket _____ Page _____

Witness my hand and official seal the day and year aforesaid.

BOOK 91 PAGE 418
 County Recorder

By _____
 County Recorder

NOTICE IS HEREBY GIVEN that St. Pat No. 164 lode mining claim has been located by American Selco, a New York corporation, whose address 90 West Grove Street, Suite 100, Reno, Nevada 89509. This claim is a relocation of the St. Pat No. 164 lode mining claim, the certificate of location of which is of record in the office of the Recorder of Eureka County, Nevada in Book 88 Page 453, in accordance with NRS 517.080. The general course of this claim is North/South. This claim is 1500 feet in length along the course of the claim, being 10 feet from the point of discovery in an North direction to the North end line of this claim, and 1490 feet in a South direction to the South end line of the claim. This claim is 600 feet in width, being 300 feet in width on each side of the center line of the claim.

This claim is located within the SE Quarter of Section 4, Township 17 North, Range 52 East, Mount Diablo Base and Meridian, Eureka Mining District, Eureka County, Nevada. The location monument of this claim is situated with reference to some natural object or permanent monument as follows: The number one corner of this claim is located approximately 16300 feet S 78° W from the SE corner of section 36, T18N, R52E, MDM.

The corners of this claim are marked by 4" x 4" x 5' posts or pipe with metal tags inscribed with the appropriate corner number as shown on the following sketch and the accompanying claim map.

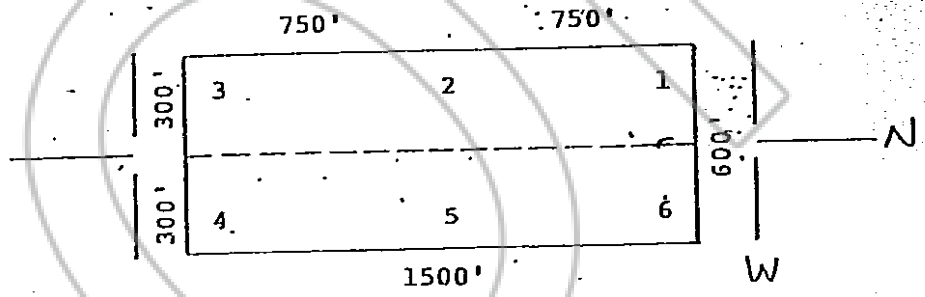

The location work consisted of making the map provided in NRS 517.0. Dated and posted on the ground this 18 day of December

1980.

RECORDED AT REQUEST OF: AMERICAN SELCO, INC.
 BY: WILLIS A. DEBOL RECORDER
 EUREKA COUNTY, NEVADA
 FILE NO. 78860
 FEE \$ 3.00
 NOV 13 10:48 AM '80

Locator: AMERICAN SELCO, INC.
 By: Mike Peig
 Agent for AMERICAN SELCO, INC.

I hereby certify that the within instrument was filed and recorded at the request of: _____
 FILE NO. _____
 on _____
 at _____
 Docket _____ Page _____

Witness my hand and official seal the day and year aforesaid.
BOOK 91 PAGE 419
 County Recorder
 By: _____
 Deputy Recorder

NOTICE IS HEREBY GIVEN that St. Pat No. 165 lode mining claim has been located by American Selco, a New York corporation, whose address 90 West Grove Street, Suite 100, Reno, Nevada 89509. This claim is a relocation of the St. Pat No. 165 lode mining claim, the certificate of location of which is of record in the office of the Recorder of Eureka County, Nevada in Book 88 Page 454, in accordance with NRS 517.080. The general course of this claim is North/South. This claim is 1500 feet in length along the course of the claim, being: 10 feet from the point of discovery in an North direction to the North end line of this claim, and 1490 feet in a South direction to the South end line of the claim. This claim is 600 feet in width, being 300 feet in width on each side of the center line of the claim.

This claim is located within the SE Quarter of Section 4, Township 17 North, Range 52 East, Mount Diablo Base and Meridian, Eureka Mining District, Eureka County, Nevada. The location monument of this claim is situated with reference to some natural object or permanent monument as follows: The number one corner of this claim is located approximately 16,300 feet 578°W from the SE corner of section 36, T18N, R52E, MDM.

The corners of this claim are marked by 4" x 4" x 5' posts or pipe with metal tags inscribed with the appropriate corner number as shown on the following sketch and the accompanying claim map.

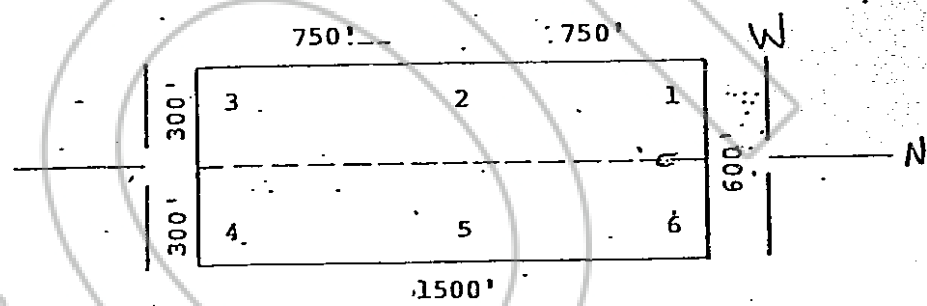

The location work consisted of making the map provided in NRS 517.0

Dated and posted on the ground this 18 day of December

19
RECORDED AT REQUEST OF
AMERICAN SELCO, INC.
BOOK 91 PAGE 420

OF NEVADA
FEB 13 AID: 46
OFFICIAL RECORDS
EUREKA COUNTY, NEVADA
WILLIS A. DEPA
FILE NO. 78861
FEE \$ 3.00

Locator:
AMERICAN SELCO, INC.

By Mike Perry
Agent for
AMERICAN SELCO, INC.

I hereby certify that the within instrument was filed and recorded at the request of: _____
FILE NO. _____
on _____
at _____
Docket _____ Page _____

Witness my hand and official seal the day and year aforesaid.

BOOK 91 PAGE 420
County Recorder

By _____
County Recorder

NOTICE IS HEREBY GIVEN that St. Pat No. 166 lode mining claim has been located by American Selco, a New York corporation, whose address 90 West Grove Street, Suite 100, Reno, Nevada 89509. This claim is a relocation of the St. Pat No. 166 lode mining claim, the certificate of location of which is of record in the office of the Recorder of Eureka County, Nevada in Book 88 Page 455, in accordance with NRS 517.080. The general course of this claim is North/South. This claim is 1500 feet in length along the course of the claim, being: 10 feet from the point of discovery in an North direction to the North end line of this claim, and 1490 feet in a South direction to the South end line of the claim. This claim is 600 feet in width, being 300 feet in width on each side of the center line of the claim.

This claim is located within the SW Quarter of Section 3, Township 17 North, Range 52 East, Mount Diablo Base and Meridian, Eureka Mining District, Eureka County, Nevada. The location monument of this claim is situated with reference to some natural object or permanent monument as follows: The number one corner of this claim is located approximately 10,000 feet S76W from the SE corner of section 36, T18N, R52E, MDM.

The corners of this claim are marked by 4" x 4" x 5' posts or pipe with metal tags inscribed with the appropriate corner number as shown on the following sketch and the accompanying claim map.

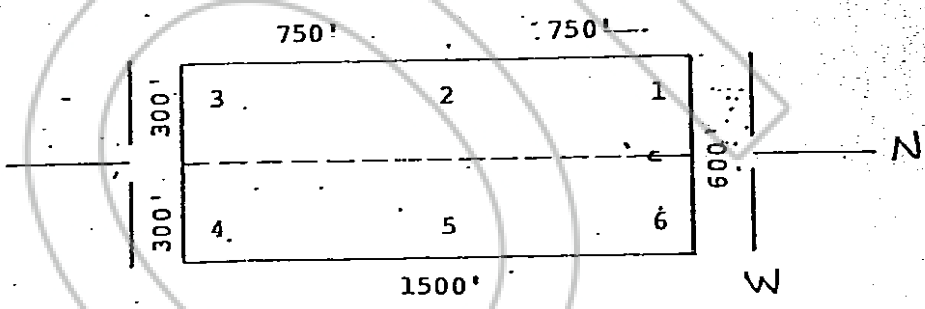

The location work consisted of making the map provided in NRS 517.0

Dated and posted on the ground this 18 day of December

1980

RECORDED AT REQUEST OF AMERICAN SELCO, INC. BOOK 88 PAGE 455

OFFICIAL RECORDS
EUREKA COUNTY, NEVADA
WILLIS A. DEPAULI, RECORDER
FILE NO. 78862
FEE \$ 3.00

Locator: AMERICAN SELCO, INC.
By: Mika Peris
Agent for AMERICAN SELCO, INC.

I hereby certify that the within instrument was filed and recorded at the request of: _____
FILE NO. _____
on _____
at _____
Docket _____ Page _____

Witness my hand and official seal the day and year afore-said.
BOOK 91 PAGE 421
County Recorder
By: _____
County Recorder

NOTICE IS HEREBY GIVEN that St. Pat No. 167 lode mining claim has been located by American Selco, a New York corporation, whose address 90 West Grove Street, Suite 100, Reno, Nevada 89509. This claim is a relocation of the St. Pat No. 167 lode mining claim, the certificate of location of which is of record in the office of the Recorder of Eureka County, Nevada in Book 88 Page 456, in accordance with NRS 517.080. The general course of this claim is North/South. This claim is 1500 feet in length along the course of the claim, being 10 feet from the point of discovery in an North direction to the North end line of this claim, and 1490 feet in a South direction to the South end line of the claim. This claim is 600 feet in width, being 300 feet in width on each side of the center line of the claim.

This claim is located within the SW Quarter of Section 3, Township 17 North, Range 52 East, Mount Diablo Base and Meridian, Eureka Mining District, Eureka County, Nevada. The location monument of this claim is situated with reference to some natural object or permanent monument as follows: The number one corner of this claim is located approximately 10,000 feet S 76° W from the SE corner of section 36, T18N, R52E, MDM.

The corners of this claim are marked by 4" x 4" x 5' posts or pipe with metal tags inscribed with the appropriate corner number as shown on the following sketch and the accompanying claim map.

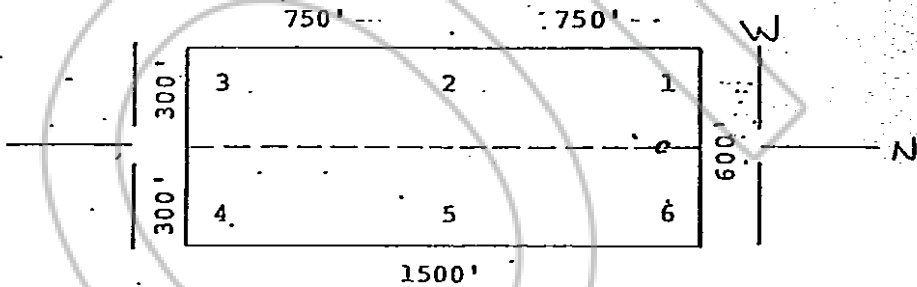

The location work consisted of making the map provided in NRS 517.04 Dated and posted on the ground this 18 day of December 1980.

RECORDED AT REQUEST OF
 AMERICAN SELCO, INC.
 BOOK 91 PAGE 422
 FEB 13 10:46
 OFFICIAL RECORDS
 EUREKA COUNTY, NEVADA
 WILLIS A. DEPAUL RECORDER
 FILE NO. 78863
 FEES \$2.00

Locator:
 AMERICAN SELCO, INC.
 By Mike Peig
 Agent for
 AMERICAN SELCO, INC.

I hereby certify that the within instrument was filed and recorded at the request of:
 FILE NO. _____
 ON _____
 at _____
 Docket _____ Page _____

Witness my hand and official seal the day and year aforesaid.
 BOOK 91 PAGE 422
 County Recorder
 By _____
 County Recorder

NOTICE IS HEREBY GIVEN that St. Pat No. 168 lode mining claim has been located by American Selco, a New York corporation, whose address 90 West Grove Street, Suite 100, Reno, Nevada 89509. This claim is a relocation of the St. Pat No. 168 lode mining claim, the certificate of location of which is of record in the office of the Recorder of Eureka County, Nevada in Book 88 Page 457, in accordance with NRS 517.080. The general course of this claim is North/South. This claim is 1500 feet in length along the course of the claim, being 10 feet from the point of discovery in an North direction to the North end line of this claim, and 1490 feet in a South direction to the South end line of the claim. This claim is 600 feet in width, being 300 feet in width on each side of the center line of the claim.

This claim is located within the SW Quarter of Section 3, Township 17 North, Range 52 East, Mount Diablo Base and Meridian, Eureka Mining District, Eureka County, Nevada. The location monument of this claim is situated with reference to some natural object or permanent monument as follows: The number one corner of this claim is located approximately 8,700 feet S 74°W from the SE corner of section 36, T18N, R52E, MDM.

The corners of this claim are marked by 4" x 4" x 5' posts or pipe with metal tags inscribed with the appropriate corner number as shown on the following sketch and the accompanying claim map.

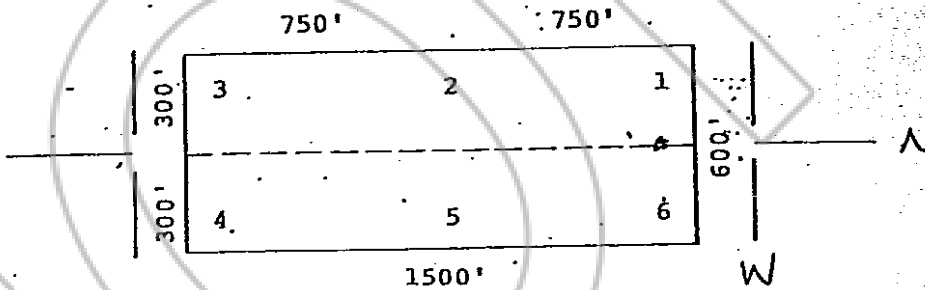

The location work consisted of making the map provided in NRS 517.04

Dated and posted on the ground this 18 day of December

1980

RECORDED AT REQUEST OF
 AMERICAN SELCO, INC.
 BOOK 91 PAGE 423
 FEB 13 10:16
 OFFICIAL RECORDS
 EUREKA COUNTY, NEVADA
 WILLIS A. DEPAOLI - RECORDER
 FILE NO. 78864
 FEES \$ 3.00

Locator:
 AMERICAN SELCO, INC.
 By Mike Perry
 Agent for
 AMERICAN SELCO, INC.

I hereby certify that the within instrument was filed and recorded at the request of: _____
 FILE NO. _____
 on _____
 at _____
 Docket _____ Page _____

Witness my hand and official seal the day and year afore-said.

BOOK 91 PAGE 423
 County Recorder

By _____
 Deputy Recorder

NOTICE IS HEREBY GIVEN that St. Pat No. 169 lode mining claim has been located by American Selco, a New York corporation, whose address 90 West Grove Street, Suite 100, Reno, Nevada 89509. This claim is a relocation of the St. Pat No. 169 lode mining claim, the certificate of location of which is of record in the office of the Recorder of Eureka County, Nevada in Book 88 Page 458, in accordance with NRS 517.080. The general course of this claim is North/South. This claim is 1500 feet in length along the course of the claim, being 10 feet from the point of discovery in an North direction to the North end line of this claim, and 1490 feet in a South direction to the South end line of the claim. This claim is 600 feet in width, being 300 feet in width on each side of the center line of the claim.

This claim is located within the SW Quarter of Section 3, Township 17 North, Range 52 East, Mount Diablo Base and Meridian, Eureka Mining District, Eureka County, Nevada. The location monument of this claim is situated with reference to some natural object or permanent monument as follows: The number one corner of this claim is located approximately 8,700 feet S 74°W from the SE corner of section 36, T18N, R52E, MDM.

The corners of this claim are marked by 4" x 4" x 5' posts or pipe with metal tags inscribed with the appropriate corner number as shown on the following sketch and the accompanying claim map.

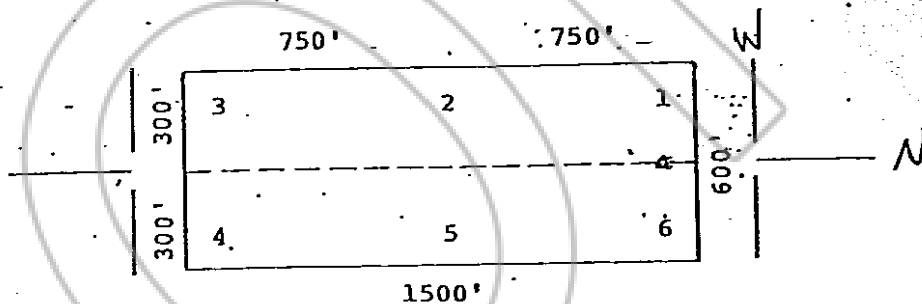

The location work consisted of making the map provided in NRS 517.0

Dated and posted on the ground this 18 day of December

1980

RECORDED AT REQUEST OF AMERICAN SELCO, INC. BOOK 91 PAGE 424

OFFICE OF THE COUNTY RECORDER EUREKA COUNTY, NEVADA WILLIS A. DUMAS RECORDER FILE NO. 78865 FEE \$ 3.00

Locator:

AMERICAN SELCO, INC.

By Mike Perry
Agent for
AMERICAN SELCO, INC.

I hereby certify that the within instrument was filed and recorded at the request of:

FILE NO. _____
on _____
at _____
Docket _____ Page _____

Witness my hand and official seal the day and year aforesaid.

BOOK 91 PAGE 424

County Recorder

By _____
County Recorder

NOTICE IS HEREBY GIVEN that St. Pat No. 170 lode mining claim has been located by American Selco, a New York corporation, whose address 90 West Grove Street, Suite 100, Reno, Nevada 89509. This claim is a relocation of the St. Pat No. 170 lode mining claim, the certificate of location of which is of record in the office of the Recorder of Eureka County, Nevada in Book 88 Page 459, in accordance with NRS 517.080. The general course of this claim is North/South. This claim is 1500 feet in length along the course of the claim, being 10 feet from the point of discovery in an North direction to the North end line of this claim, and 1490 feet in a South direction to the South end line of the claim. This claim is 600 feet in width, being 300 feet in width on each side of the center line of the claim.

This claim is located within the SE Quarter of Section 3, Township 17 North, Range 52 East, Mount Diablo Base and Meridian, Eureka Mining District, Eureka County, Nevada. The location monument of this claim is situated with reference to some natural object or permanent monument as follows: The number one corner of this claim is located approximately 7,500 feet S 72° W from the SE corner of section 36, T18N, R52E, MDM.

The corners of this claim are marked by 4" x 4" x 5' posts or pipe with metal tags inscribed with the appropriate corner number as shown on the following sketch and the accompanying claim map.

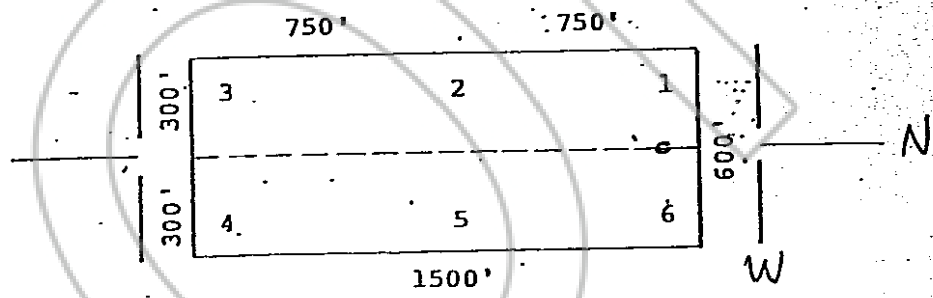

The location work consisted of making the map provided in NRS 517.04

Dated and posted on the ground this 18 day of December

RECORDED AT REQUEST OF
AMERICAN SELCO, INC.
BOOK 91 PAGE 435
81 FEB 13 1904
STATE OF NEVADA
COUNTY OF

OFFICIAL RECORDS
EUREKA COUNTY NEVADA
WILLIS A. DEPAOLI, RECORDER
FILE NO. 78866
FEE \$ 3.00

Locator:
AMERICAN SELCO, INC.
By Mike Peay
Agent for
AMERICAN SELCO, INC.

I hereby certify that the within instrument was filed and recorded at the request of: _____
FILE NO. _____
on _____
at _____
Docket _____ Page _____

Witness my hand and official seal the day and year afore-said.
BOOK 91 PAGE 435
County Recorder
By _____
County Recorder

NOTICE IS HEREBY GIVEN that St. Pat No. 171 lode mining claim has been located by American Selco, a New York corporation, whose address 90 West Grove Street, Suite 100, Reno, Nevada 89509. This claim is a relocation of the St. Pat No. 171 lode mining claim, the certificate of location of which is of record in the office of the Recorder of Eureka County, Nevada in Book 88 Page 460, in accordance with NRS 517.080. The general course of this claim is North/South. This claim is 1500 feet in length along the course of the claim, being 10 feet from the point of discovery in an North direction to the North end line of this claim, and 1490 feet in a South direction to the South end line of the claim. This claim is 600 feet in width, being 300 feet in width on each side of the center line of the claim.

This claim is located within the SE Quarter of Section 3, Township 17 North, Range 52 East, Mount Diablo Base and Meridian, Eureka Mining District, Eureka County, Nevada. The location monument of this claim is situated with reference to some natural object or permanent monument as follows: The number one corner of this claim is located approximately 750 feet S 72° W from the SE corner of section 36, T18N, R52E, MDM.

The corners of this claim are marked by 4" x 4" x 5' posts or pipe with metal tags inscribed with the appropriate corner number as shown on the following sketch and the accompanying claim map.

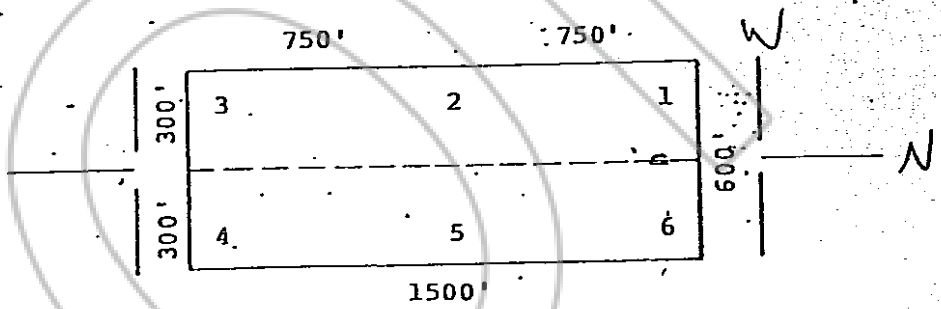

The location work consisted of making the map provided in NRS 517.0 Dated and posted on the ground this 18 day of December

RECORDED AT REQUEST OF AMERICAN SELCO, INC. BOOK 91 PAGE 426

FILED FEB 13 1980
OFFICIAL RECORDS
EUREKA COUNTY, NEVADA
WILLIS A. DEPAPE, RECORDER
FILE NO. 78867
FEE \$ 3.00

Locator:
AMERICAN SELCO, INC.
By Mike Peiry
Agent for
AMERICAN SELCO, INC.

I hereby certify that the within instrument was filed and recorded at the request of: _____
FILE NO. _____
on _____
at _____
Docket _____ Page _____

Witness my hand and official seal the day and year aforesaid.
91 PAGE 426
County Recorder
By _____
Deputy Recorder

NOTICE IS HEREBY GIVEN that St. Pat No. 172 lode mining claim has been located by American Selco, a New York corporation, whose address 90 West Grove Street, Suite 100, Reno, Nevada 89509. This claim is a relocation of the St. Pat No. 172 lode mining claim, the certificate of location of which is of record in the office of the Recorder of Eureka County, Nevada in Book 88 Page 461, in accordance with NRS 517.080. The general course of this claim is North/South. This claim is 1500 feet in length along the course of the claim, being: 10 feet from the point of discovery in an North direction to the North end line of this claim, and 1490 feet in a South direction to the South end line of the claim. This claim is 600 feet in width, being 300 feet in width on each side of the center line of the claim.

This claim is located within the SE Quarter of Section 3, Township 17 North, Range 52 East, Mount Diablo Base and Meridian, Eureka Mining District, Eureka County, Nevada. The location monument of this claim is situated with reference to some natural object or permanent monument as follows: The number one corner of this claim is located approximately 6,200 feet S 68° W from the SE corner of section 36, T18N, R52E, MDM.

The corners of this claim are marked by 4" x 4" x 5' posts or pipe with metal tags inscribed with the appropriate corner number as shown on the following sketch and the accompanying claim map.

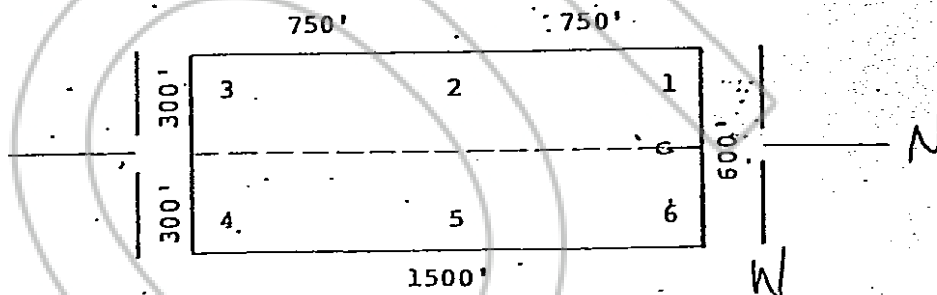

The location work consisted of making the map provided in NRS 517.0

Dated and posted on the ground this 18 day of December 1980.

RECORDED AT REQUEST OF
AMERICAN SELCO, INC.
BOOK 91 PAGE 427

ASSAY
FEB 18 AIO: 4

OFFICIAL RECORDS
EUREKA COUNTY, NEVADA
WILLIS A. DEPTY, RECORDER
FILE NO. 78868
FEE \$ 3.00

Locator:
AMERICAN SELCO, INC.

By Mike Peirce
Agent for
AMERICAN SELCO, INC.

I hereby certify that the within instrument was filed and recorded at the request of: _____
FILE NO. _____
on _____
at _____
Docket _____ Page _____

Witness my hand and official seal the day and year aforesaid.

BOOK 91 PAGE 427
County Recorder

By _____
Deputy Recorder

78869

NOTICE IS HEREBY GIVEN that St. Pat No. 173 lode mining claim has been located by American Selco, a New York corporation, whose address 90 West Grove Street, Suite 100, Reno, Nevada 89509. This claim is a relocation of the St. Pat No. 173 lode mining claim, the certificate of location of which is of record in the office of the Recorder of Eureka County, Nevada in Book 88 Page 452, in accordance with NRS 517.080. The general course of this claim is North/South. This claim is 1500 feet in length along the course of the claim, being 10 feet from the point of discovery in an North direction to the North end line of this claim, and 1490 feet in a South direction to the South end line of the claim. This claim is 600 feet in width, being 300 feet in width on each side of the center line of the claim.

This claim is located within the SE Quarter of Section 3, Township 17 North, Range 52 East, Mount Diablo Base and Meridian, Eureka Mining District, Eureka County, Nevada. The location monument of this claim is situated with reference to some natural object or permanent monument as follows: The number one corner of this claim is located approximately 6,200 feet 568°W from the SE corner of section 36, T18N, R52E, MDM.

The corners of this claim are marked by 4" x 4" x 5' posts or pipe with metal tags inscribed with the appropriate corner number as shown on the following sketch and the accompanying claim map.

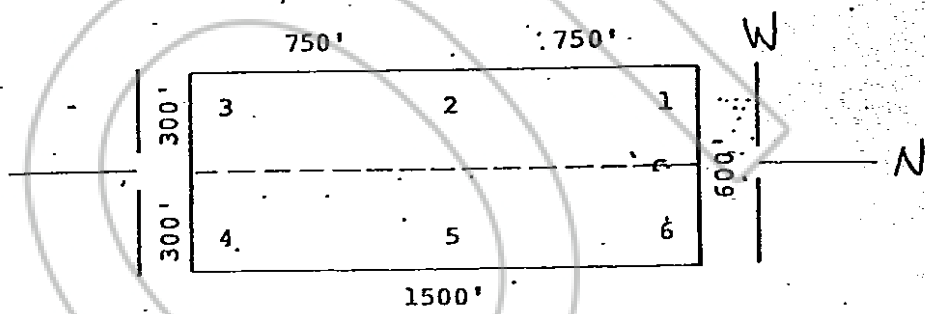

The location work consisted of making the map provided in NRS 517.04

Dated and posted on the ground this 18 day of December 19 80.

Witnesses: _____

RECORDED AT REQUEST OF AMERICAN SELCO, INC. BOOK 88 PAGE 428

OP FEB 13 AID: 47
 FEB 13

OFFICIAL RECORDS
 EUREKA COUNTY, NEVADA
 WILLIS A. DEPAUL, RECORDER
 FILE NO. 78869
 FEE \$ 5.00

Locator: _____
 AMERICAN SELCO, INC.
 By Mike Peiny
 Agent for
 AMERICAN SELCO, INC.

I hereby certify that the within instrument was filed and recorded at the request of: _____
 FILE NO. _____
 on _____
 at _____
 Docket _____ Page _____

Witness my hand and official seal the day and year aforesaid.

 County Recorder
 By _____
 Deputy Recorder

BOOK 91 PAGE 428

NOTICE IS HEREBY GIVEN that St. Pat. No. 174 lode mining claim has been located by American Selco, a New York corporation, whose address 90 West Grove Street, Suite 100, Reno, Nevada 89509. This claim is a relocation of the St. Pat. No. 174 lode mining claim, the certificate of location of which is of record in the office of the Recorder of Eureka County, Nevada in Book 88 Page 463, in accordance with NRS 517.080. The general course of this claim is North/South. This claim is 1500 feet in length along the course of the claim, being 10 feet from the point of discovery in an North direction to the North end line of this claim, and 1490 feet in a South direction to the South end line of the claim. This claim is 600 feet in width, being 300 feet in width on each side of the center line of the claim.

This claim is located within the SE Quarter of Section 5, Township 17 North, Range 52 East, Mount Diablo Base and Meridian, Eureka Mining District, Eureka County, Nevada. The location monument of this claim is situated with reference to some natural object or permanent monument as follows: The number one corner of this claim is located approximately 17,400 feet S70°W from the SE corner of section 36, T18N, R52E, MDM.

The corners of this claim are marked by 4" x 4" x 5' posts or pipe with metal tags inscribed with the appropriate corner number as shown on the following sketch and the accompanying claim map.

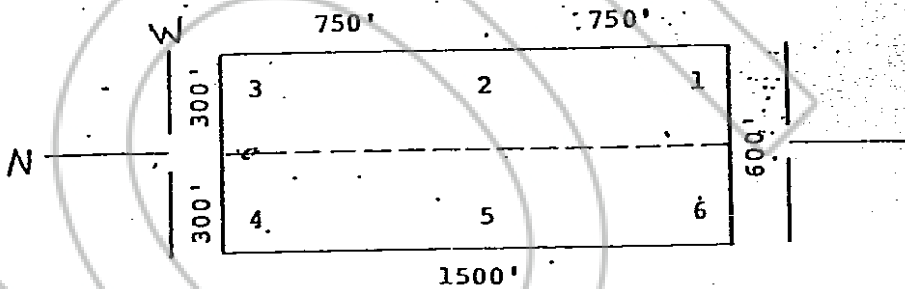

The location work consisted of making the map provided in NRS 517.0

Dated and posted on the ground this 27 day of January 1981.

RECORDED AT REQUEST OF
AMERICAN SELCO, INC.
 BOOK 91 PAGE 429
 FEB 13 10:40 AM '81
 OFFICIAL RECORDS
 EUREKA COUNTY, NEVADA
 WILLIS A. DEPAULIS, RECORDER
 FILE NO. 78870
 FEE \$ 3.00

Locator:
 AMERICAN SELCO, INC.

By: Mike Reiny
 Agent for
 AMERICAN SELCO, INC.

I hereby certify that the within instrument was filed and recorded at the request of:

FILE NO. _____
 on _____
 at _____
 Docket _____ Page _____

Witness my hand and official seal the day and year aforesaid.

91 PAGE 429
 County Recorder

By _____
 County Recorder

NOTICE IS HEREBY GIVEN that St. Pat No. 175 lode mining claim has been located by American Selco, a New York corporation, whose address 90 West Grove Street, Suite 100, Reno, Nevada 89509. This claim is a relocation of the St. Pat No. 175 lode mining claim, the certificate of location of which is of record in the office of the Recorder of Eureka County, Nevada in Book 88 Page 464, in accordance with NRS 517.080. The general course of this claim is North/South. This claim is 1500 feet in length along the course of the claim, being 10 feet from the point of discovery in an North direction to the North end line of this claim, and 1490 feet in a South direction to the South end line of the claim. This claim is 600 feet in width, being 300 feet in width on each side of the center line of the claim.

This claim is located within the SW Quarter of Section 4, Township 17 North, Range 52 East, Mount Diablo Base and Meridian, Eureka Mining District, Eureka County, Nevada. The location monument of this claim is situated with reference to some natural object or permanent monument as follows: The number one corner of this claim is located approximately 16,300 feet 569°W from the SE corner of section 36, T18N, R52E, MDM.

The corners of this claim are marked by 4" x 4" x 5' posts or pipe with metal tags inscribed with the appropriate corner number as shown on the following sketch and the accompanying claim map.

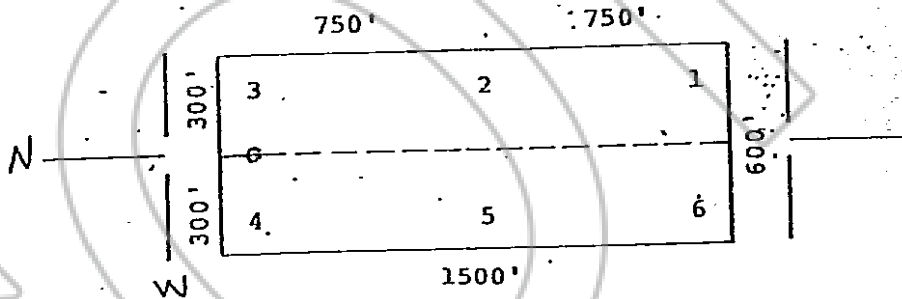

The location work consisted of making the map provided in NRS 517.0 Dated and posted on the ground this 27 day of January, 19 81.

RECORDED AT REQUEST OF AMERICAN SELCO, INC. BOOK 97 PAGE 430

OFFICIAL RECORDS EUREKA COUNTY, NEVADA WILLIS A. DEPAUL, RECORDER FILE NO. 78871

I hereby certify that the within instrument was filed and recorded at the request of: _____ FILE NO. _____ on _____ at _____ Docket _____ Page _____

Locator: AMERICAN SELCO, INC. By: Mike Peirce Agent for AMERICAN SELCO, INC.

Witness my hand and official seal the day and year aforesaid.

91 430 County Recorder

By _____ County Recorder

78872

NOTICE IS HEREBY GIVEN that St. Pat No. 181 lode mining claim has been located by American Selco, a New York corporation, whose address 90 West Grove Street, Suite 100, Reno, Nevada 89509. This claim is a relocation of the St. Pat No. 181 lode mining claim, the certificate of location of which is of record in the office of the Recorder of Eureka County, Nevada in Book 88 Page 470, in accordance with NRS 517.080. The general course of this claim is North/South. This claim is 1500 feet in length along the course of the claim, being 490 feet from the point of discovery in an North direction to the North end line of this claim, and 10 feet in a South direction to the South end line of the claim. This claim is 600 feet in width, being 300 feet in width on each side of the center line of the claim.

This claim is located within the SE¹ Quarter of Section 4, Township 17 North, Range 52 East, Mount Diablo Base and Meridian, Eureka Mining District, Eureka County, Nevada. The location monument of this claim is situated with reference to some natural object or permanent monument as follows: The number one corner of this claim is located approximately 12,600 feet S67°W from the SE corner of section 36, T18N, R52E, MDM.

The corners of this claim are marked by 4" x 4" x 5' posts or pipe with metal tags inscribed with the appropriate corner number as shown on the following sketch and the accompanying claim map.

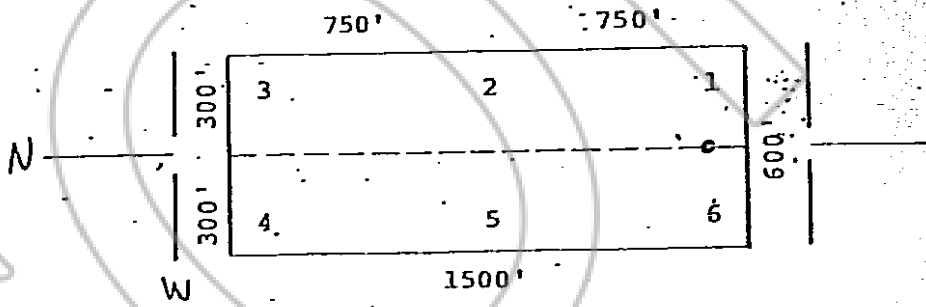

The location work consisted of making the map provided in NRS 517. Dated and posted on the ground this 18 day of December 19 80.

RECORDED AT REQUEST OF
AMERICAN SELCO INC
 BOOK 91 PAGE 431
 FEB 13 AID: 87
 OFFICIAL RECORDS
 EUREKA COUNTY, NEVADA
 WILLIAM A. BEPko, RECORDER
 FILE NO. 78872
 FEE \$ 3.00

Locator: AMERICAN SELCO, INC.

By: Mike Peris
 Agent for
AMERICAN SELCO INC.

I hereby certify that the within instrument was filed and recorded at the request of: _____
 FILE NO. _____
 on _____
 at _____
 Book _____ Page _____

Witness my hand and official seal the day and year afore said.

BOOK 91 PAGE 431
 County Recorder

NOTICE IS HEREBY GIVEN that St. Pat No. 182 lode mining claim has been located by American Selco, a New York corporation, whose address 90 West Grove Street, Suite 100, Reno, Nevada 89509. This claim is a relocation of the St. Pat No. 182 lode mining claim, the certificate of location of which is of record in the office of the Recorder of Eureka County, Nevada in Book 88 Page 471, in accordance with NRS 517.080. The general course of this claim is North/South. This claim is 1500 feet in length along the course of the claim, being 1490 feet from the point of discovery in an North direction to the North end line of this claim, and 10 feet in a South direction to the South end line of the claim. This claim is 600 feet in width, being 300 feet in width on each side of the center line of the claim.

This claim is located within the SE Quarter of Section 4, Township 17 North, Range 52 East, Mount Diablo Base Meridian, Eureka Mining District, Eureka County, Nevada. The location monument of this claim is situated with reference to some natural object or permanent monument as follows: The number 12,600 feet S 62° W from the SE corner of section 36, T18N, R52E, MDM.

The corners of this claim are marked by 4" x 4" x 5' posts or pipe with metal tags inscribed with the appropriate corner number as shown on the following sketch and the accompanying claim map.

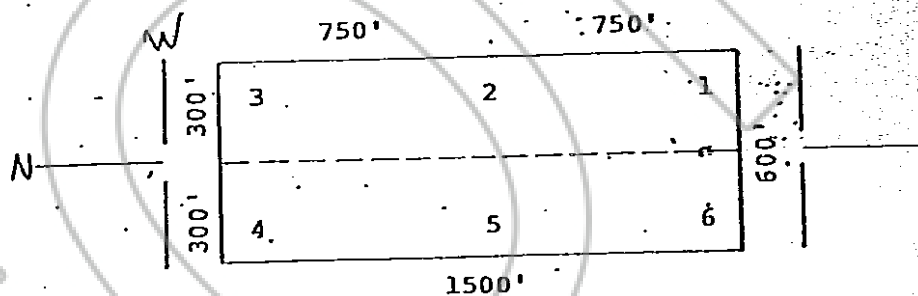

The location work consisted of making the map provided in NRS 517 Dated and posted on the ground this 18 day of December 1980.

RECORDED AT REQUEST OF
AMERICAN SELCO, INC.
 BOOK 91 PAGE 432
 FEB 13 10:57
 OFFICIAL RECORDS
 EUREKA COUNTY, NEVADA
 WILLIS A. DEPAOLI - RECORDER
 FILE NO. 78873
 FEE \$ 3.00

Locator: AMERICAN SELCO, INC.
 By Mike Perry
 Agent for
AMERICAN SELCO, INC.

ss. _____
 COUNTY OF _____
 I hereby certify that the within instrument was filed and recorded at the request of: _____
 FILE NO. _____
 on _____
 at _____
 Docket _____ Page _____

Witness my hand and official seal the day and year aforesaid.
BOOK 91 PAGE 432
 County Recorder

NOTICE IS HEREBY GIVEN that St. Pat No. 183 lode mining claim has been located by American Selco, a New York corporation, whose address 90 West Grove Street, Suite 100, Reno, Nevada 89509. This claim is a relocation of the St. Pat No. 183 lode mining claim, the certificate of location of which is of record in the office of the Recorder of Eureka County, Nevada in Book 88 Page 472, in accordance with NRS 517.080. The general course of this claim is North/South. This claim is 1500 feet in length along the course of the claim, being 1470 feet from the point of discovery in an North direction to the North end line of this claim, and 10 feet in a South direction to the South end line of the claim. This claim is 600 feet in width, being 300 feet in width on each side of the center line of the claim.

This claim is located within the SW Quarter of Section 3, Township 17 North, Range 52 East, Mount Diablo Base and Meridian, Eureka Mining District, Eureka County, Nevada. The location monument of this claim is situated with reference to some natural object or permanent monument as follows: The number one corner of this claim is located approximately 16,300 feet 560' W from the SE corner of section 36, T18N, R52E, MDM.

The corners of this claim are marked by 4" x 4" x 5' posts or pipe with metal tags inscribed with the appropriate corner number as shown on the following sketch and the accompanying claim map.

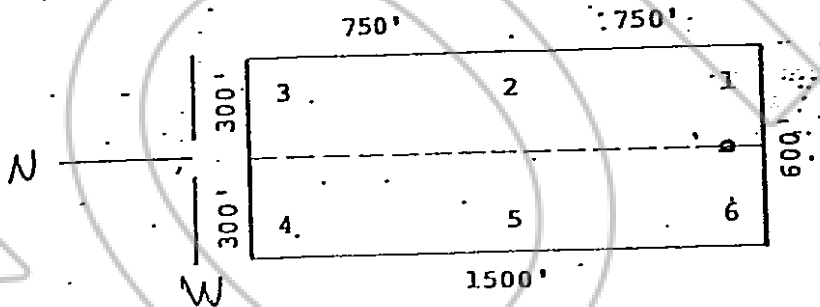

The location work consisted of making the map provided in NRS 517 Dated and posted on the ground this 18 day of December

RECORDED AT REQUEST OF
 AMERICAN SELCO, INC.
 BOOK 91 PAGE 433
 81 FEB 13 AM 11:47
 OFFICIAL RECORDS
 EUREKA COUNTY, NEVADA
 WILLIS A. DEPAOLI, RECORDER
 FILE NO. 78874
 FEE \$ 3.00

Locator:
 AMERICAN SELCO, INC.
 By Mike Perry
 Agent for
 AMERICAN SELCO, INC.

STATE OF NEVADA)
 COUNTY OF _____) ss.
 I hereby certify that the within instrument was filed and recorded at the request of: _____
 FILE NO. _____
 on _____
 at _____
 Docket _____ Page _____

Witness my hand and official seal the day and year aforesaid.
 Book 91 Page 433
 County Recorder
 By _____

NOTICE IS HEREBY GIVEN that St. Pat No. 184 lode mining claim has been located by American Selco, a New York corporation, whose address 90 West Grove Street, Suite 100, Reno, Nevada 89509. This claim is a relocation of the St. Pat No. 184 lode mining claim, the certificate of location of which is of record in the office of the Recorder of Eureka County, Nevada in Book 88 Page 473, in accordance with NRS 517.080. The general course of this claim is North/South. This claim is 1500 feet in length along the course of the claim, being 1490 feet from the point of discovery in an North direction to the North end line of this claim, and 10 feet in a South direction to the South end line of the claim. This claim is 600 feet in width, being 300 feet in width on each side of the center line of the claim.

This claim is located within the SW Quarter of Section 3, Township 17 North, Range 52 East, Mount Diablo Base and Meridian, Eureka Mining District, Eureka County, Nevada. The location monument of this claim is situated with reference to some natural object or permanent monument as follows: The number one corner of this claim is located approximately 11300 feet S 60°W from the SE corner of section 36, T18N, R52E, MDM.

The corners of this claim are marked by 4" x 4" x 5' posts or pipe with metal tags inscribed with the appropriate corner number as shown on the following sketch and the accompanying claim map.

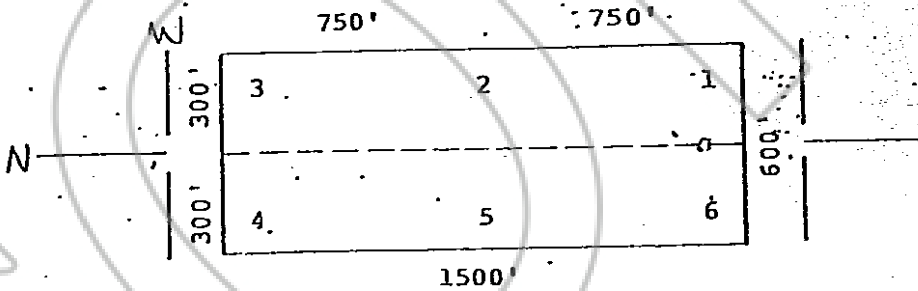

The location work consisted of making the map provided in NRS 517.

Dated and posted on the ground this 18 day of December

1980
RECORDED AT REQUEST OF
AMERICAN SELCO, INC.
BOOK 91 PAGE 434

81 FEB 13 AM 11 47
OFFICIAL RECORDS
EUREKA COUNTY, NEVADA
WILFRED A. DEPAOLI - RECORDER
FILE NO. 78875
FEE \$ 3.50

STATE OF NEVADA)
COUNTY OF) ss. _____

I hereby certify that the within instrument was filed and recorded at the request of: _____
FILE NO. _____
on _____
at _____
Docket _____ Page _____

Locator: _____
AMERICAN SELCO, INC.
By Mike Peirig
Agent for
AMERICAN SELCO, INC.

Witness my hand and official seal the day and year afore said.

BOOK 91 PAGE 434
County Recorder

NOTICE IS HEREBY GIVEN that St. Pat. No. 185 lode mining claim has been located by American Selco, a New York corporation, whose address 90 West Grove Street, Suite 100, Reno, Nevada 89509. This claim is a relocation of the St. Pat. No. 185 lode mining claim, the certificate of location of which is of record in the office of the Recorder of Eureka County, Nevada in Book 88 Page 474, in accordance with NRS 517.080. The general course of this claim is North/South. This claim is 1500 feet in length along the course of the claim, being 1490 feet from the point of discovery in an North direction to the North end line of this claim, and 10 feet in a South direction to the South end line of the claim. This claim is 600 feet in width, being 300 feet in width on each side of the center line of the claim.

This claim is located within the SW Quarter of Section 3, Township 17 North, Range 52 East, Mount Diablo Base and Meridian, Eureka Mining District, Eureka County, Nevada. The location monument of this claim is situated with reference to some natural object or permanent monument as follows: The number one corner of this claim is located approximately 10,000 feet S 56°W from the SE corner of section 36, T18N, R52E, MDM.

The corners of this claim are marked by 4" x 4" x 5' posts or pipe with metal tags inscribed with the appropriate corner number as shown on the following sketch and the accompanying claim map.

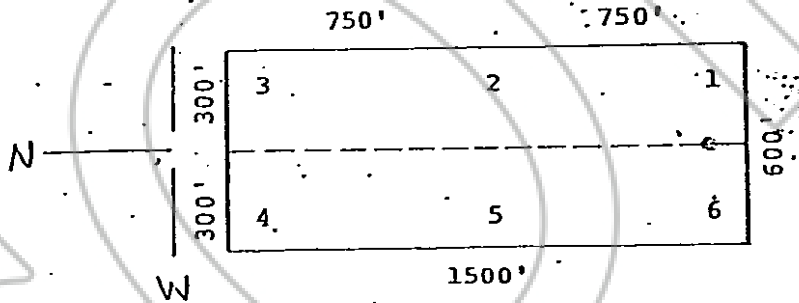

The location work consisted of making the map provided in NRS 517.0

Dated and posted on the ground this 18 day of December

1980

RECORDED AT REQUEST OF
AMERICAN SELCO, INC.
BOOK 91 PAGE 435

FEB 13 AIO 1980

OFFICIAL RECORDS
EUREKA COUNTY, NEVADA
WILLIS A. DEPAUL RECORDER
FILE NO. 78876
FEE \$ 3.00

COUNTY OF NEVADA

COUNTY OF

I hereby certify that the within instrument was filed and recorded at the request of:

FILE NO. _____
on _____
at _____
Docket _____ Page _____

Locator:

AMERICAN SELCO, INC.

By: Mike Peiry
Agent for
AMERICAN SELCO, INC.

Witness my hand and official seal the day and year afore-said.

BOOK 91 PAGE 435

County Recorder

By

NOTICE IS HEREBY GIVEN that St. Pat No. 186 lode mining claim has been located by American Selco, a New York corporation, whose address 90 West Grove Street, Suite 100, Reno, Nevada 89509. This claim is a relocation of the St. Pat No. 186 lode mining claim, the certificate of location of which is of record in the office of the Recorder of Eureka County, Nevada in Book 88 Page 475, in accordance with NRS 517.080. The general course of this claim is North/South. This claim is 1500 feet in length along the course of the claim, being 1490 feet from the point of discovery in an North direction to the North end line of this claim, and 10 feet in a South direction to the South end line of the claim. This claim is 600 feet in width, being 300 feet in width on each side of the center line of the claim.

This claim is located within the SW Quarter of Section 3, Township 17 North, Range 52 East, Mount Diablo Base and Meridian, Eureka Mining District, Eureka County, Nevada. The location monument of this claim is situated with reference to some natural object or permanent monument as follows: The number one corner of this claim is located approximately 10,200 feet 556'W from the SE corner of section 36, T18N, R52E, MDM.

The corners of this claim are marked by 4" x 4" x 5" posts or pipe with metal tags inscribed with the appropriate corner number as shown on the following sketch and the accompanying claim map.

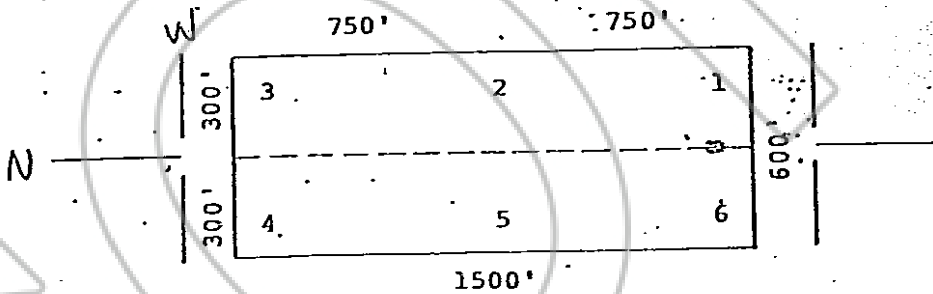

The location work consisted of making the map provided in NRS 517.0. Dated and recorded on the ground this 18 day of December 1947.

RECORDED AT REQUEST OF
AMERICAN SELCO, INC.
 BOOK 88 PAGE 475
 8 FEB 13 AID 47

OFFICIAL RECORDS
 EUREKA COUNTY, NEVADA
 WILLIS A. DEBOLD, CLERK
 FILE NO. 18877
 FEE \$ 3.00

Locator: AMERICAN SELCO, INC.
 By Mike Perry
 Agent for AMERICAN SELCO, INC.

STATE OF NEVADA)
) ss.
 COUNTY OF _____)

I hereby certify that the within instrument was filed and recorded at the request of: _____
 FILE NO. _____
 on _____
 at _____
 Docket _____ Page _____

Witness my hand and official seal the day and year aforesaid.
 BOOK 91 PAGE 436
 County Recorder
 By _____

NOTICE IS HEREBY GIVEN that St. Pat No. 187 lode mining claim has been located by American Selco, a New York corporation, whose address 90 West Grove Street, Suite 100, Reno, Nevada 89509. This claim is a relocation of the St. Pat No. 187 lode mining claim, the certificate of location of which is of record in the office of the Recorder of Eureka County, Nevada in Book 88 Page 476, in accordance with NRS 517.080. The general course of this claim is North/South. This claim is 1500 feet in length along the course of the claim, being 1490 feet from the point of discovery in an North direction to the North end line of this claim, and 10 feet in a South direction to the South end line of the claim. This claim is 600 feet in width, being 300 feet in width on each side of the center line of the claim.

This claim is located within the SE Quarter of Section 3, Township 17 North, Range 52 East, Mount Diablo Base and Meridian, Eureka Mining District, Eureka County, Nevada. The location monument of this claim is situated with reference to some natural object or permanent monument as follows: The number one corner of this claim is located approximately 9.100 feet S 50°W from the SE corner of section 36, T18N, R52E, MDM.

The corners of this claim are marked by 4" x 4" x 5' posts or pipe with metal tags inscribed with the appropriate corner number as shown on the following sketch and the accompanying claim map.

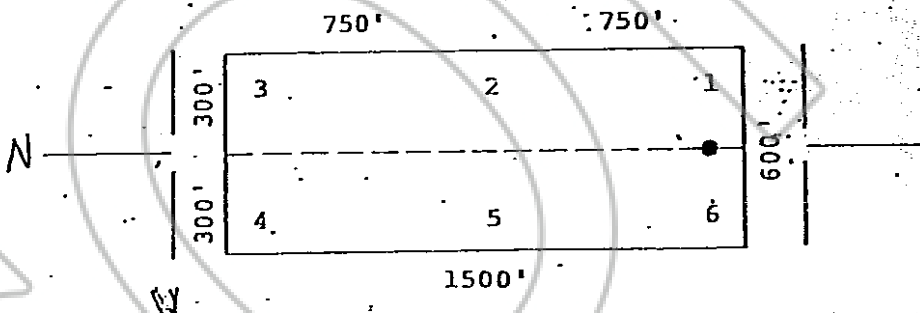

The location work consisted of making the map provided in NRS 517.0

Dated and posted on the ground this 18 day of December

19 80

RECORDED AT REQUEST OF
AMERICAN SELCO, INC.
 BOOK 91 PAGE 437
 FEB 13 10 18 AM '80
 OFFICIAL RECORDS
 EUREKA COUNTY, NEVADA
 WILLIS A. DEPAUL RECORDER
 FILE NO. 78878
 FEE \$ 3.00

Locator:
 AMERICAN SELCO, INC.

By Mike Perry
 Agent for
 AMERICAN SELCO, INC.

OF NEVADA)
 COUNTY OF) ss.

I hereby certify that the within instrument was filed and recorded at the request of: _____
 FILE NO. _____
 ON _____
 at _____
 Docket _____ Page _____

Witness my hand and official seal the day and year afore-said.

BOOK 91 PAGE 437
 County Recorder

By

NOTICE IS HEREBY GIVEN that St. Pat No. 188 lode mining claim has been located by American Selco, a New York corporation, whose address 90 West Grove Street, Suite 100, Reno, Nevada 89509. This claim is a relocation of the St. Pat No. 188 lode mining claim, the certificate of location of which is of record in the office of the Recorder of Eureka County, Nevada in Book 88 Page 477, in accordance with NRS 517.080. The general course of this claim is North/South. This claim is 1500 feet in length along the course of the claim, being 1490 feet from the point of discovery in an North direction to the North end line of this claim, and 10 feet in a South direction to the South end line of the claim. This claim is 600 feet in width, being 300 feet in width on each side of the center line of the claim.

This claim is located within the SE Quarter of Section 3, Township 17 North, Range 52 East, Mount Diablo Base and Meridian, Eureka Mining District, Eureka County, Nevada. The location monument of this claim is situated with reference to some natural object or permanent monument as follows: The number one corner of this claim is located approximately 9,100 feet 550°W from the SE corner of section 36, T18N, R52E, MDM.

The corners of this claim are marked by 4" x 4" x 5' posts or pipe with metal tags inscribed with the appropriate corner number as shown on the following sketch and the accompanying claim map.

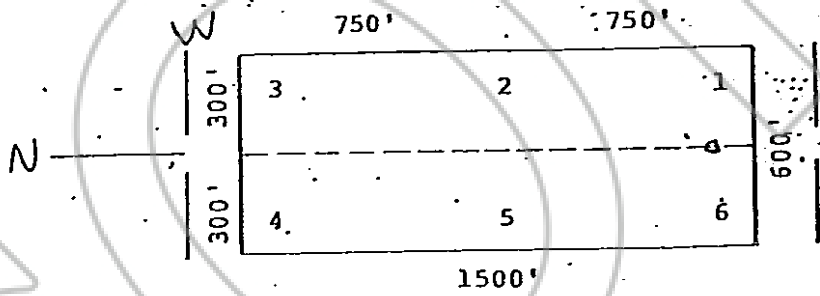

The location work consisted of making the map provided in NRS 517. Dated and posted on the ground this 18 day of December

RECORDED AT REQUEST OF
 AMERICAN SELCO, INC.
 BOOK 88 PAGE 438
 81 FEB 13 AM 10:48
 OFFICIAL RECORDS
 EUREKA COUNTY, NEVADA
 WILLIS A. TEPAL - RECORDER
 FILE # 178879
 FEE \$ 3.00

Locator:
AMERICAN SELCO, INC.

By Mike Perry
Agent for
AMERICAN SELCO, INC.

STATE OF NEVADA)
COUNTY OF _____) ss.

I hereby certify that the within instrument was filed and recorded at the request of: _____
FILE NO. _____
on _____
at _____
Docket _____ Page _____

Witness my hand and official seal the day and year afore said.

BOOK 91 PAGE 438
County Recorder

By _____

NOTICE IS HEREBY GIVEN that St. Pat No. 189 1080
 mining claim has been located by American Selco, a New York corporation,
 whose address 90 West Grove Street, Suite 100, Reno, Nevada 89509. This
 claim is a relocation of the St. Pat No. 189 1080
 mining claim, the certificate of location of which is of record in the
 office of the Recorder of Eureka County, Nevada in Book
 88 Page 478, in accordance with NRS 517.080.
 The general course of this claim is North/South. This claim is 1500
 feet in length along the course of the claim, being 1490 feet from the
 point of discovery in an North direction to the North
 end line of this claim, and 10 feet in a South direction to
 the South end line of the claim. This claim is 600 feet in
 width, being 300 feet in width on each side of the center line of the
 claim.

This claim is located within the SE Quarter of Section
 3, Township 17 North, Range 52 East, Mount Diablo Base and
 Meridian, Eureka Mining District, Eureka County,
 Nevada. The location monument of this claim is situated with reference
 to some natural object or permanent monument as follows: The number
 one corner of this claim is located approximately 8100 feet
 S45°W from the SE corner of section 36, T18N, R52E, MDM.

The corners of this claim are marked by 4" x 4" x 5' posts or pipe
 with metal tags inscribed with the appropriate corner number as shown on
 the following sketch and the accompanying claim map.

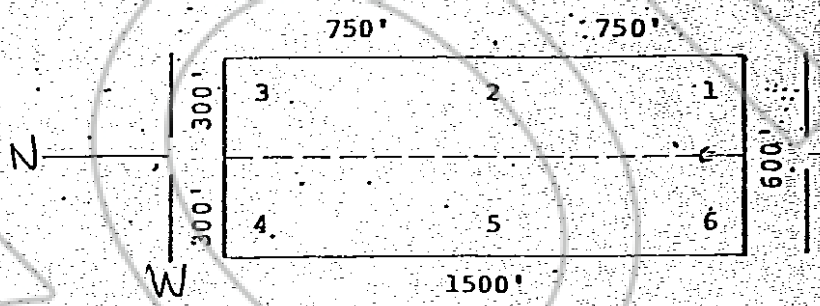

The location work consisted of making the map provided in NRS 517.0
 Dated and posted on the ground this 18 day of December
 1980.

RECORDED AT REQUEST OF
 AMERICAN SELCO, INC.
 BOOK 91 PAGE 439
 FILED 13 AD: 43
 OFFICIAL RECORDS
 EUREKA COUNTY NEVADA
 WILLIS A. DEAN, CLERK
 FILE NO. 78880
 FEE \$ 3.00

Locator:
 AMERICAN SELCO, INC.
 By: Mike Puij
 Agent for
 AMERICAN SELCO, INC.

I hereby certify that the within
 instrument was filed and recorded at
 the request of:
 FILE NO. _____
 on _____
 at _____
 Docket _____ Page _____

Witness my hand and official
 seal the day and year afore-
 said.
 91 PAGE 439
 County Recorder

NOTICE IS HEREBY GIVEN that St. Pat No. 190 lode mining claim has been located by American Selco, a New York corporation, whose address 90 West Grove Street, Suite 100, Reno, Nevada 89509. This claim is a relocation of the St. Pat No. 190 lode mining claim, the certificate of location of which is of record in the office of the Recorder of Eureka County, Nevada in Book 88 Page 479, in accordance with NRS 517.080. The general course of this claim is North/South. This claim is 1500 feet in length along the course of the claim, being: 1490 feet from the point of discovery in an North direction to the North end line of this claim, and 10 feet in a South direction to the South end line of the claim. This claim is 600 feet in width, being 300 feet in width on each side of the center line of the claim.

This claim is located within the SE Quarter of Section 3, Township 17 North, Range 52 East, Mount Diablo Base and Meridian, Eureka Mining District, Eureka County, Nevada. The location monument of this claim is situated with reference to some natural object or permanent monument as follows: The number one corner of this claim is located approximately 8,100 feet 545°W from the SE corner of section 36, T18N, R52E, MDM.

The corners of this claim are marked by 4" x 4" x 5" posts or pipe with metal tags inscribed with the appropriate corner number as shown on the following sketch and the accompanying claim map.

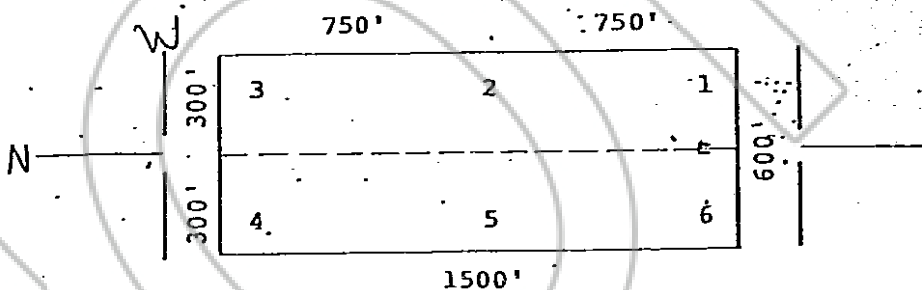

The location work consisted of making the map provided in NRS 517.

Dated and posted on the ground this 18 day of December 1980.

CREDITED AT REQUEST OF
 AMERICAN SELCO, INC.
 N 8008 91 PAGE 440
 FEB 13 AIO: 48
 OFFICIAL RECORDS
 EUREKA COUNTY, NEVADA
 WILLIS A. DI PAOLI-RECORDER
 FILE NO. 78881
 FEE \$ 3.00

Locator:
 AMERICAN SELCO, INC.

By: Mike Perry
 Agent for
 AMERICAN SELCO, INC.

I hereby certify that the within instrument was filed and recorded at the request of:
 FILE NO. _____
 on _____
 at _____
 Docket _____ Page _____

Witness my hand and official seal the day and year aforesaid.

91 440
 County Recorder

By

NOTICE IS HEREBY GIVEN that St. Pat No. 195 lode mining claim has been located by American Selco, a New York corporation, whose address 90 West Grove Street, Suite 100, Reno, Nevada 89509. This claim is a relocation of the St. Pat No. 195 lode mining claim, the certificate of location of which is of record in the office of the Recorder of Eureka County, Nevada in Book 88 Page 480, in accordance with NRS 517.080. The general course of this claim is North/South. This claim is 1500 feet in length along the course of the claim, being 1490 feet from the point of discovery in an North direction to the North end line of this claim, and 10 feet in a South direction to the South end line of the claim. This claim is 600 feet in width, being 300 feet in width on each side of the center line of the claim.

This claim is located within the NE Quarter of Section 8, Township 17 North, Range 52 East, Mount Diablo Base and Meridian, Eureka Mining District, Eureka County, Nevada. The location monument of this claim is situated with reference to some natural object or permanent monument as follows: The number one corner of this claim is located approximately 17,400 feet S 70° W from the SE corner of section 36, T18N, R52E, MDM.

The corners of this claim are marked by 4" x 4" x 5' posts or pipe with metal tags inscribed with the appropriate corner number as shown on the following sketch and the accompanying claim map.

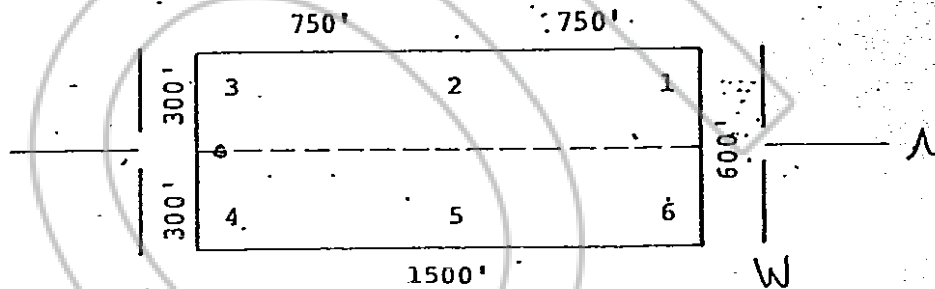

The location work consisted of making the map provided in NRS 517.0

Dated and posted on the ground this 27 day of January

RECORDED AT REQUEST OF
AMERICAN SELCO, INC.
 BOOK 91 PAGE 441
 19 81
 FEB 13 AID 10:48
 OFFICIAL RECORDS
 EUREKA COUNTY, NEVADA
 WILLIS A. COPPIN - RECORDER
 FILE NO. 78882
 FEES 3.00

Locator:
 AMERICAN SELCO, INC.

By Mike Perry
 Agent for
 AMERICAN SELCO, INC.

I hereby certify that the within instrument was filed and recorded at the request of:
 FILE NO. _____
 on _____
 at _____
 Docket _____ Page _____

Witness my hand and official seal the day and year aforesaid.

BOOK 91 PAGE 441
 County Recorder

By _____
 County Recorder

NOTICE IS HEREBY GIVEN that St. Pat No. 196 lode mining claim has been located by American Selco, a New York corporation, whose address 90 West Grove Street, Suite 100, Reno, Nevada 89509. This claim is a relocation of the St. Pat No. 196 lode mining claim, the certificate of location of which is of record in the office of the Recorder of Eureka County, Nevada in Book 88 Page 481, in accordance with NRS 517.080. The general course of this claim is North/South. This claim is 1500 feet in length along the course of the claim, being 1490 feet from the point of discovery in an North direction to the North end line of this claim, and 10 feet in a South direction to the South end line of the claim. This claim is 600 feet in width, being 300 feet in width on each side of the center line of the claim.

This claim is located within the NE Quarter of Section 8, Township 17 North, Range 52 East, Mount Diablo Base and Meridian, Eureka Mining District, Eureka County, Nevada. The location monument of this claim is situated with reference to some natural object or permanent monument as follows: The number one corner of this claim is located approximately 17,400 feet S 70° W from the SE corner of section 36, T18N, R52E, MDM.

The corners of this claim are marked by 4" x 4" x 5' posts or pipe with metal tags inscribed with the appropriate corner number as shown on the following sketch and the accompanying claim map.

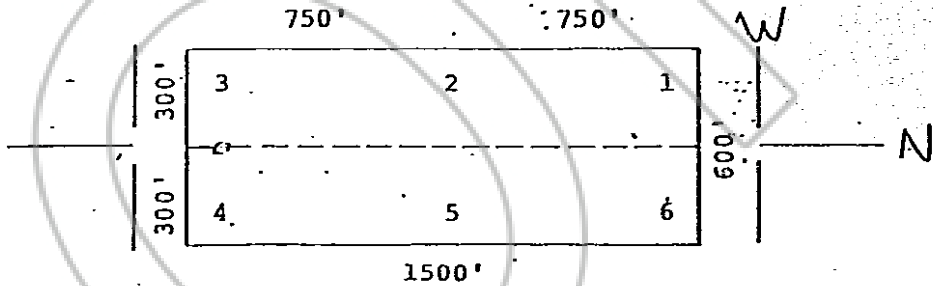

The location work consisted of making the map provided in NRS 517.0

Dated and posted on the ground this 27 day of January 1981.

Witnesses:

RECORDED AT REQUEST OF AMERICAN SELCO INC. BOOK 91 PAGE 442
 OF FILE 13 AID: 48
 OFFICIAL RECORDS EUREKA COUNTY NEVADA WILLIS A. DEPAULI RECORDER FILE NO. 19883 FEE \$ 3.00

I hereby certify that the within instrument was filed and recorded at the request of: _____
 FILE NO. _____
 on _____
 at _____
 Docket _____ Page _____

Locator:

AMERICAN SELCO, INC.

By Mick Perry
 Agent for
 AMERICAN SELCO, INC.

Witness my hand and official seal the day and year afore-said.

BOOK 91 PAGE 442
 County Recorder

By _____

NOTICE IS HEREBY GIVEN that St. Pat No. 197 lode mining claim has been located by American Selco, a New York corporation, whose address 90 West Grove Street, Suite 100, Reno, Nevada 89509. This claim is a relocation of the St. Pat No. 197 lode mining claim, the certificate of location of which is of record in the office of the Recorder of Eureka County, Nevada in Book 88 Page 482, in accordance with NRS 517.080. The general course of this claim is North/South. This claim is 1500 feet in length along the course of the claim, being 1490 feet from the point of discovery in an North direction to the North end line of this claim, and 10 feet in a South direction to the South end line of the claim. This claim is 600 feet in width, being 300 feet in width on each side of the center line of the claim.

This claim is located within the NE Quarter of Section 9, Township 17 North, Range 52 East, Mount Diablo Base and Meridian, Eureka Mining District, Eureka County, Nevada. The location monument of this claim is situated with reference to some natural object or permanent monument as follows: The number one corner of this claim is located approximately 16,300' feet S 69°W from the SE corner of section 36, T18N, R52E, MDM.

The corners of this claim are marked by 4" x 4" x 5' posts or pipe with metal tags inscribed with the appropriate corner number as shown on the following sketch and the accompanying claim map.

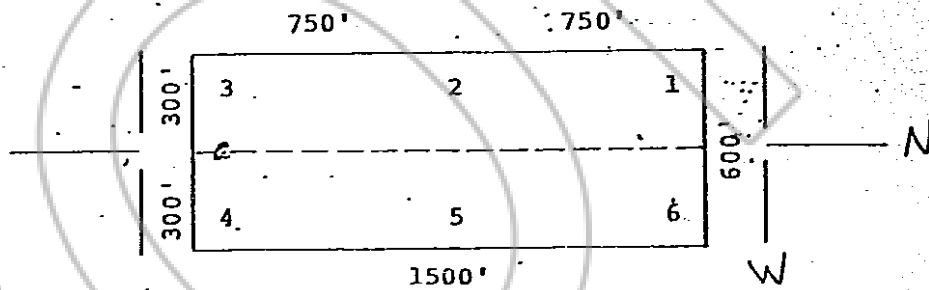

The location work consisted of making the map provided in NRS 517.04

Dated and posted on the ground this 27 day of January

19 81

RECORDED AT REQUEST OF
AMERICAN SELCO INC
 BOOK 91 PAGE 443
 FEB 13 10:48
 OFFICIAL RECORDS
 EUREKA COUNTY, NEVADA
 WILLIS A. DEBARTOLIS, RECORDER
 FILE NO. 78884
 FEE \$ 3.00

Locator:
 AMERICAN SELCO, INC.

By Mike Perry
 Agent for
 AMERICAN SELCO, INC.

I hereby certify that the within instrument was filed and recorded at the request of:
 FILE NO. _____
 on _____
 at _____
 Docket _____ Page _____

Witness my hand and official seal the day and year aforesaid.

BOOK 91 PAGE 443
 County Recorder

By _____