

NOTICE IS HEREBY GIVEN that St. Pat No. 170 lode mining claim has been located by American Selco, a New York corporation, whose address 90 West Grove Street, Suite 100, Reno, Nevada 89509. This claim is a relocation of the St. Pat No. 170 lode mining claim, the certificate of location of which is of record in the office of the Recorder of Eureka County, Nevada in Book 88 Page 459, in accordance with NRS 517.080. The general course of this claim is North/South. This claim is 1500 feet in length along the course of the claim, being 10 feet from the point of discovery in an North direction to the North end line of this claim, and 1490 feet in a South direction to the South end line of the claim. This claim is 600 feet in width, being 300 feet in width on each side of the center line of the claim.

This claim is located within the SE Quarter of Section 3, Township 17 North, Range 52 East, Mount Diablo Base and Meridian, Eureka Mining District, Eureka County, Nevada. The location monument of this claim is situated with reference to some natural object or permanent monument as follows: The number one corner of this claim is located approximately 7,500 feet S 72° W from the SE corner of section 36, T18N, R52E, MDM.

The corners of this claim are marked by 4" x 4" x 5' posts or pipe with metal tags inscribed with the appropriate corner number as shown on the following sketch and the accompanying claim map.

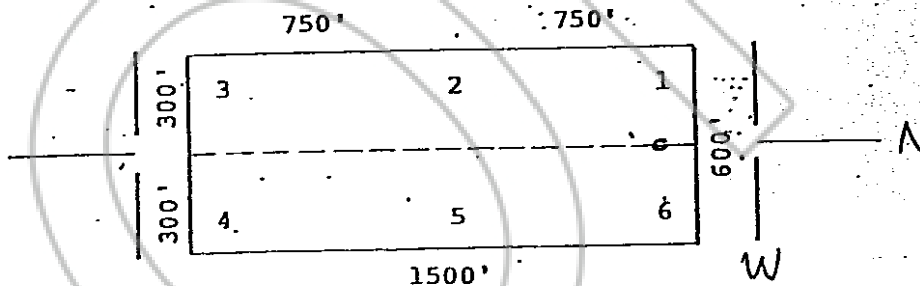

The location work consisted of making the map provided in NRS 517.04

Dated and posted on the ground this 18 day of December

1980

RECORDED AT REQUEST OF

AMERICAN SELCO, INC.

BOOK 91 PAGE 435

81 FEB 13 1980

OFFICIAL RECORDS

EUREKA COUNTY, NEVADA

WILLIS A. DEPAOLI, RECORDER

FILE NO. 78866

FEE \$ 3.00

STATE OF NEVADA

COUNTY OF

ss.

)

)

)

)

)

)

)

)

)

)

)

)

)

)

)

)

)

)

Locator:

AMERICAN SELCO, INC.

By

Agent for
AMERICAN SELCO, INC.

Witness my hand and official seal the day and year aforesaid.

BOOK 91 PAGE 435

County Recorder

By

County Recorder

I hereby certify that the within instrument was filed and recorded at the request of:

FILE NO. _____

on _____

at _____

Docket _____ Page _____