

NOTICE IS HEREBY GIVEN that St. Pat No. 175 lode mining claim has been located by American Selco, a New York corporation, whose address 90 West Grove Street, Suite 100, Reno, Nevada 89509. This claim is a relocation of the St. Pat No. 175 lode mining claim, the certificate of location of which is of record in the office of the Recorder of Eureka County, Nevada in Book 88 Page 464, in accordance with NRS 517.080. The general course of this claim is North/South. This claim is 1500 feet in length along the course of the claim, being 10 feet from the point of discovery in an North direction to the North end line of this claim, and 1490 feet in a South direction to the South end line of the claim. This claim is 600 feet in width, being 300 feet in width on each side of the center line of the claim.

This claim is located within the SW Quarter of Section 4, Township 17 North, Range 52 East, Mount Diablo Base and Meridian, Eureka Mining District, Eureka County, Nevada. The location monument of this claim is situated with reference to some natural object or permanent monument as follows: The number one corner of this claim is located approximately 16,300 feet 569°W from the SE corner of section 36, T18N, R52E, MDM.

The corners of this claim are marked by 4" x 4" x 5' posts or pipe with metal tags inscribed with the appropriate corner number as shown on the following sketch and the accompanying claim map.

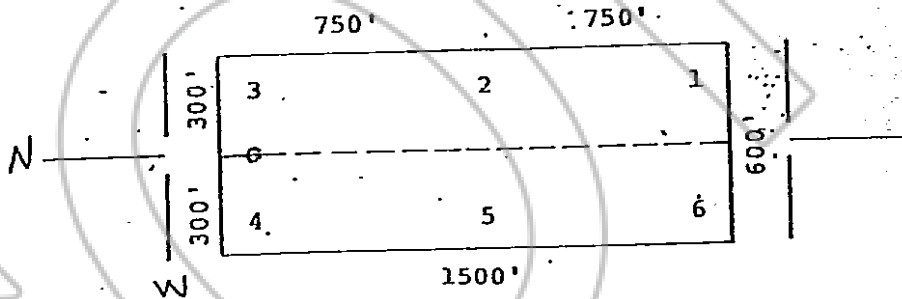

The location work consisted of making the map provided in NRS 517.0 Dated and posted on the ground this 27 day of January, 19 81.

RECORDED AT REQUEST OF AMERICAN SELCO, INC. BOOK 97 PAGE 430

OFFICIAL RECORDS OF NEVADA
EUREKA COUNTY RECORDER
WILLIS A. DEPAUL
FILE NO. 78871
FEE \$ 2.00

Locator: AMERICAN SELCO, INC.

By Mike Peirce
Agent for AMERICAN SELCO, INC.

I hereby certify that the within instrument was filed and recorded at the request of: _____
FILE NO. _____
on _____
at _____
Docket _____ Page _____

Witness my hand and official seal the day and year aforesaid.

91 page 430
County Recorder

By _____
County Recorder