

NOTICE IS HEREBY GIVEN that St. Pat No. 353 lode mining claim has been located by American Selco, a New York corporation, whose address 90 West Grove Street, Suite 100, Reno, Nevada 89509. This claim is a relocation of the St. Pat No. 353 lode mining claim, the certificate of location of which is of record in the office of the Recorder of Eureka County, Nevada in Book 89 Page 25, in accordance with NRS 517.080. The general course of this claim is North/South. This claim is 1500 feet in length along the course of the claim, being 1490 feet from the point of discovery in an North direction to the North end line of this claim, and 10 feet in a South direction to the South end line of the claim. This claim is 600 feet in width, being 300 feet in width on each side of the center line of the claim.

This claim is located within the NW/SW Quarter of Section 35, Township 18 North, Range 52 East, Mount Diablo Base and Meridian, Eureka Mining District, Eureka County, Nevada. The location monument of this claim is situated with reference to some natural object or permanent monument as follows: The number 6 corner of this claim is located approximately 11,150 feet N 81° W from the SE corner of section 36, T18N, R52E, MDM.

The corners of this claim are marked by 4" x 4" x 5' posts or pipe with metal tags inscribed with the appropriate corner number as shown on the following sketch and the accompanying claim map.

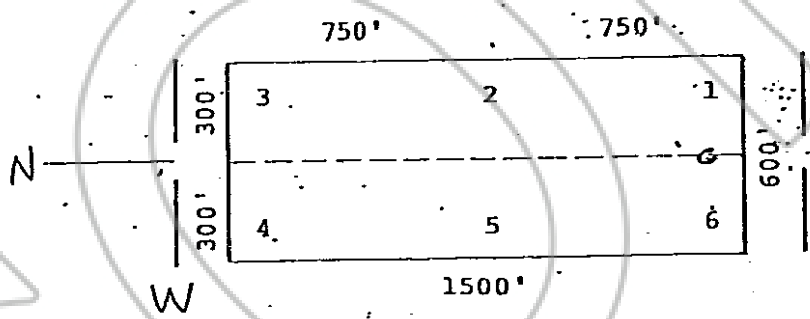

The location work consisted of making the map provided in NRS 517.0 Dated and posted on the ground this 10 day of December

RECORDED AT REQUEST OF  
 AMERICAN SELCO, INC.  
 BOOK 91 PAGE 444  
 81 FEB 13 AM 10:49  
 EUREKA COUNTY, NEVADA  
 OFFICIAL RECORDS  
 WILLIS A. DEPAUL RECORDER  
 FILE 14-78886  
 FEE \$ 3.00

Locator:  
 AMERICAN SELCO, INC.  
 By Mike Perry  
 Agent for  
 AMERICAN SELCO, INC.

STATE OF NEVADA )  
 ) ss.  
 COUNTY OF \_\_\_\_\_ )  
 I hereby certify that the within instrument was filed and recorded at the request of: \_\_\_\_\_  
 FILE NO. \_\_\_\_\_  
 on \_\_\_\_\_  
 at \_\_\_\_\_  
 Docket \_\_\_\_\_ Page \_\_\_\_\_

Witness my hand and official seal the day and year afore-said.  
 BOOK 91 PAGE 444  
 \_\_\_\_\_  
 County Recorder  
 ny

NOTICE IS HEREBY GIVEN that St. Pat No. 354 lode mining claim has been located by American Selco, a New York corporation, whose address 90 West Grove Street, Suite 100, Reno, Nevada 89509. This claim is a relocation of the St. Pat No. 354 lode mining claim, the certificate of location of which is of record in the office of the Recorder of Eureka County, Nevada in Book 89 Page 26, in accordance with NRS 517.080. The general course of this claim is North/South. This claim is 1500 feet in length along the course of the claim, being: 10 feet from the point of discovery in an North direction to the North end line of this claim, and 1490 feet in a South direction to the South end line of the claim. This claim is 600 feet in width, being 300 feet in width on each side of the center line of the claim.

This claim is located within the SW Quarter of Section 35, Township 18 North, Range 52 East, Mount Diablo Base and Meridian, Eureka Mining District, Eureka County, Nevada. The location monument of this claim is situated with reference to some natural object or permanent monument as follows: The number 6 corner of this claim is located approximately 11150 feet N 81° W from the SE corner of section 36, T18N, R52E, MDM.

The corners of this claim are marked by 4" x 4" x 5' posts or pipe with metal tags inscribed with the appropriate corner number as shown on the following sketch and the accompanying claim map.

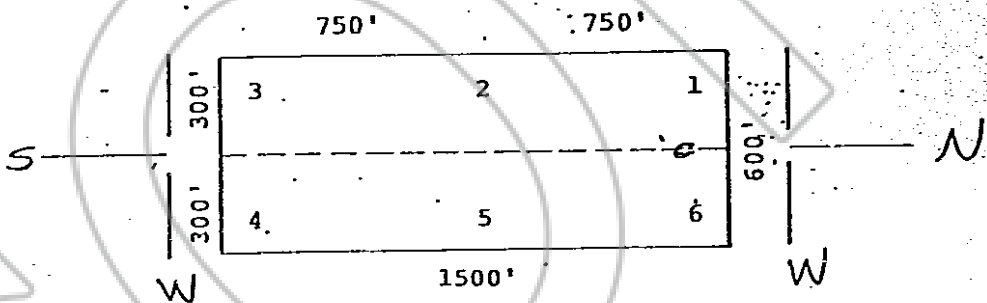

The location work consisted of making the map provided in NRS 517.040

Dated and posted on the ground this 10 day of December 1980.

Witnesses:  
 \_\_\_\_\_  
 \_\_\_\_\_  
 \_\_\_\_\_  
 \_\_\_\_\_  
 \_\_\_\_\_  
 \_\_\_\_\_

Locator:  
 AMERICAN SELCO, INC.

By: Mike Perry  
 Agent for  
 AMERICAN SELCO, INC.

I hereby certify that the within instrument was filed and recorded at the request of:  
 FILE NO. \_\_\_\_\_  
 on \_\_\_\_\_  
 at \_\_\_\_\_  
 Docket \_\_\_\_\_ Page \_\_\_\_\_

Witness my hand and official seal the day and year afore-said.

BOOK 91 PAGE 445  
 County Recorder

By \_\_\_\_\_  
 \_\_\_\_\_

RECORDED AT REQUEST OF  
 AMERICAN SELCO, INC.  
 BOOK 91 PAGE 445  
 FILED ON FEB 13 1981  
 OFFICIAL RECORDS  
 EUREKA COUNTY, NEVADA  
 WILLIS A. ORF, CLERK  
 FILE NO. 18887  
 FEE \$ 3.00

NOTICE IS HEREBY GIVEN that St. Pat No. 355 lode mining claim has been located by American Selco, a New York corporation, whose address 90 West Grove Street, Suite 100, Reno, Nevada 89509. This claim is a relocation of the St. Pat No. 355 lode mining claim, the certificate of location of which is of record in the office of the Recorder of Eureka County, Nevada in Book 89 Page 27, in accordance with NRS 517.080. The general course of this claim is North/South. This claim is 1500 feet in length along the course of the claim, being 1490 feet from the point of discovery in an North direction to the North end line of this claim, and 10 feet in a South direction to the South end line of the claim. This claim is 600 feet in width, being 300 feet in width on each side of the center line of the claim.

This claim is located within the NW/SE Quarter of Section 35, Township 18 North, Range 52 East, Mount Diablo Base and Meridian, Eureka Mining District, Eureka County, Nevada. The location monument of this claim is situated with reference to some natural object or permanent monument as follows: The number 6 corner of this claim is located approximately 10,000 feet N 80° W from the SE corner of section 36, T18N, R52E, MDM.

The corners of this claim are marked by 4" x 4" x 5' posts or pipe with metal tags inscribed with the appropriate corner number as shown on the following sketch and the accompanying claim map.

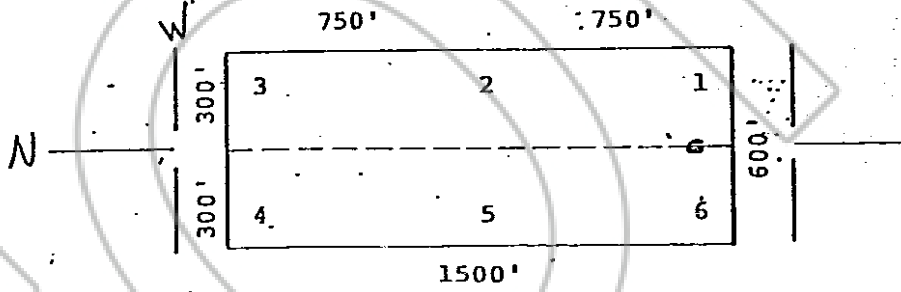

The location work consisted of making the map provided in NRS 517.0. Dated and posted on the ground this 10 day of December 1980.

RECORDED AT REQUEST OF  
**AMERICAN SELCO INC**  
 BUSINESS ADDRESS:  
 FEB 13 AID: 119  
 OFFICIAL RECORDS  
 EUREKA COUNTY, NEVADA  
 WILLIS A. DEPAULIS, RECORDER  
 FILE NO. 78888  
 FEE \$ 3.00

Locator: \_\_\_\_\_  
 AMERICAN SELCO, INC.  
 By: Mike Perry  
 Agent for  
 AMERICAN SELCO, INC.

COUNTY OF \_\_\_\_\_ ) ss. \_\_\_\_\_  
 I hereby certify that the within instrument was filed and recorded at the request of: \_\_\_\_\_  
 FILE NO. \_\_\_\_\_  
 on \_\_\_\_\_  
 at \_\_\_\_\_  
 Docket \_\_\_\_\_ Page \_\_\_\_\_

Witness my hand and official seal the day and year aforesaid.  
 BOOK 91 PAGE 446  
 County Recorder  
 By: \_\_\_\_\_  
 Deputy Recorder

NOTICE IS HEREBY GIVEN that St. Pat No. 356 lode mining claim has been located by American Selco, a New York corporation, whose address 90 West Grove Street, Suite 100, Reno, Nevada 89509. This claim is a relocation of the St. Pat No. 356 lode mining claim, the certificate of location of which is of record in the office of the Recorder of Eureka County, Nevada in Book 89 Page 28, in accordance with NRS 517.080. The general course of this claim is North/South. This claim is 1500 feet in length along the course of the claim, being 10 feet from the point of discovery in an North direction to the North end line of this claim, and 1490 feet in a South direction to the South end line of the claim. This claim is 600 feet in width, being 300 feet in width on each side of the center line of the claim.

This claim is located within the SW Quarter of Section 35, Township 18 North, Range 52 East, Mount Diablo Base and Meridian, Eureka Mining District, Eureka County, Nevada. The location monument of this claim is situated with reference to some natural object or permanent monument as follows: The number 6 corner of this claim is located approximately 10,000 feet N 80° W from the SE corner of section 36, T18N, R52E, MDM.

The corners of this claim are marked by 4" x 4" x 5" posts or pipe with metal tags inscribed with the appropriate corner number as shown on the following sketch and the accompanying claim map.

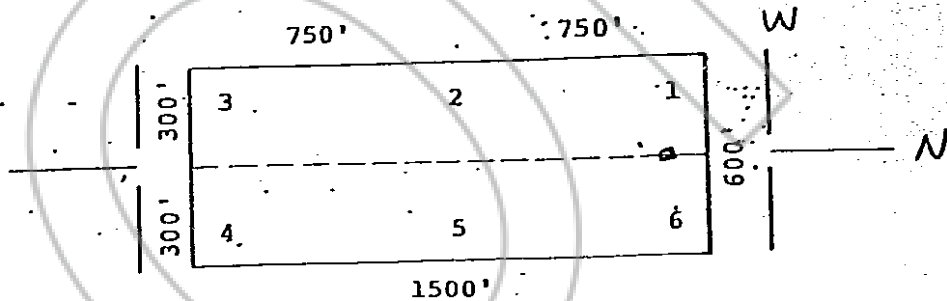

The location work consisted of making the map provided in NRS 517.0

Dated and posted on the ground this 10 day of December

19 80

RECORDED AT REQUEST OF  
**AMERICAN SELCO, INC.**  
 BOOK 91 PAGE 447

FEB 13 10:49  
 AMERICAN SELCO, INC.

OFFICIAL RECORDS  
 EUREKA COUNTY, NEVADA  
 WILLIS A. DEPAULIS, RECORDER  
 FILE NO. 78889  
 FEE \$ 3.00

AMOUNTY OF \_\_\_\_\_ )  
 ) ss.

I hereby certify that the within instrument was filed and recorded at the request of: \_\_\_\_\_  
 FILE NO. \_\_\_\_\_  
 on \_\_\_\_\_  
 at \_\_\_\_\_  
 Docket \_\_\_\_\_ Page \_\_\_\_\_

Locator: AMERICAN SELCO, INC.

By: Mike Perry  
 Agent for  
AMERICAN SELCO, INC.

Witness my hand and official seal the day and year afore-said.

BOOK 91 PAGE 447  
 \_\_\_\_\_  
 County Recorder

By \_\_\_\_\_

NOTICE IS HEREBY GIVEN that St. Pat No. 357 lode mining claim has been located by American Selco, a New York corporation, whose address 90 West Grove Street, Suite 100, Reno, Nevada 89509. This claim is a relocation of the St. Pat No. 357 lode mining claim, the certificate of location of which is of record in the office of the Recorder of Eureka County, Nevada in Book 89 Page 29, in accordance with NRS 517.080. The general course of this claim is North/South. This claim is 1500 feet in length along the course of the claim, being 1490 feet from the point of discovery in an North direction to the North end line of this claim, and 10 feet in a South direction to the South end line of the claim. This claim is 600 feet in width, being 300 feet in width on each side of the center line of the claim.

This claim is located within the NW 1/4 SW Quarter of Section 35, Township 18 North, Range 52 East, Mount Diablo Base Meridian, Eureka Mining District, Eureka County, Nevada. The location monument of this claim is situated with reference to some natural object or permanent monument as follows: The number 6 corner of this claim is located approximately 10,000 feet N 80° W from the SE corner of section 36, T18N, R52E, MDM.

The corners of this claim are marked by 4" x 4" x 5' posts or pipes with metal tags inscribed with the appropriate corner number as shown on the following sketch and the accompanying claim map.

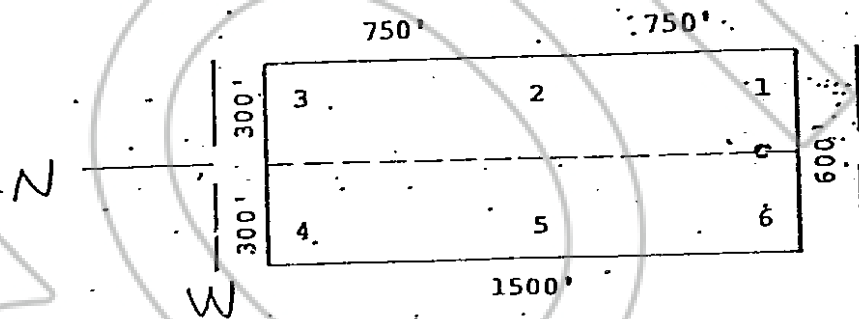

The location work consisted of making the map provided in NRS 517. Dated and posted on the ground this 10 day of December 19 80.

RECORDED AT REQUEST OF  
**AMERICAN SELCO, INC.**  
 BOOK 91 PAGE 448  
 FILED FEB 13 AM 10:49  
 OFFICIAL RECORDS  
 EUREKA COUNTY NEVADA  
 WILLIS A. DEPAUL RECORDER  
 FILE NO. 78890  
 FEE \$ 3.00  
 COUNTY OF NEVADA  
 ) ss.  
 )  
 COUNTY OF \_\_\_\_\_

Locator: AMERICAN SELCO, INC.  
 By Mike Perry  
 Agent for AMERICAN SELCO, INC.

I hereby certify that the within instrument was filed and recorded at the request of: \_\_\_\_\_  
 FILE NO. \_\_\_\_\_  
 on \_\_\_\_\_  
 at \_\_\_\_\_  
 Page \_\_\_\_\_

Witness my hand and official seal the day and year aforesaid.  
 BOOK 91 PAGE 448  
 County Recorder

NOTICE IS HEREBY GIVEN that St. Pat No. 358 lode mining claim has been located by American Selco, a New York corporation, whose address 90 West Grove Street, Suite 100, Reno, Nevada 89509. This claim is a relocation of the St. Pat No. 358 lode mining claim, the certificate of location of which is of record in the office of the Recorder of Eureka County, Nevada in Book 89 Page 30, in accordance with NRS 517.080. The general course of this claim is North/South. This claim is 1500 feet in length along the course of the claim, being 10 feet from the point of discovery in an North direction to the North end line of this claim, and 1490 feet in a South direction to the South end line of the claim. This claim is 600 feet in width, being 300 feet in width on each side of the center line of the claim.

This claim is located within the SW Quarter of Section 35, Township 18 North, Range 52 East, Mount Diablo Base and Meridian, Eureka Mining District, Eureka County, Nevada. The location monument of this claim is situated with reference to some natural object or permanent monument as follows: The number 6 corner of this claim is located approximately 10,000 feet N 80° W from the SE corner of section 36, T18N, R52E, MDM.

The corners of this claim are marked by 4" x 4" x 5' posts or pipe with metal tags inscribed with the appropriate corner number as shown on the following sketch and the accompanying claim map.

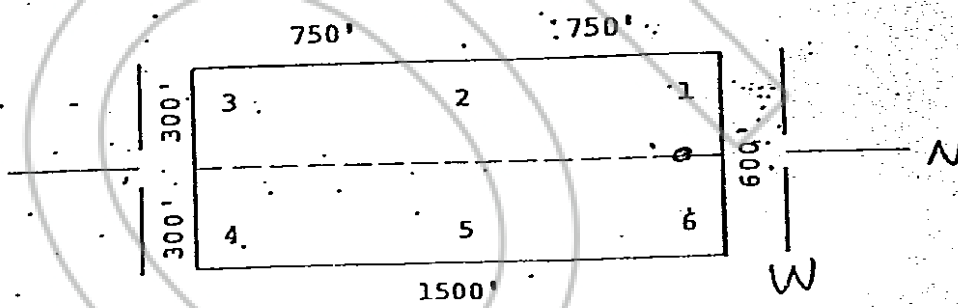

The location work consisted of making the map provided in NRS 517 Dated and posted on the ground this 10 day of December 1980.

Witnesses:  
 \_\_\_\_\_  
 \_\_\_\_\_  
 CITY OF EUREKA, NEVADA  
 OFFICIAL RECORDS  
 EUREKA COUNTY, NEVADA  
 WILLIS A. BRADY, RECORDER  
 FILE NO. 78891  
 FILE \$ 3.00

Locator:  
 AMERICAN SELCO, INC.  
 By Mike Perry  
 Agent for  
 AMERICAN SELCO, INC.

I hereby certify that the within instrument was filed and recorded at the request of:  
 FILE NO. \_\_\_\_\_  
 on \_\_\_\_\_  
 at \_\_\_\_\_

Witness my hand and official seal the day and year aforesaid.  
 BOOK 91 PAGE 449  
 County Recorder

NOTICE IS HEREBY GIVEN that St. Pat No. 359 106 mining claim has been located by American Selco, a New York corporation, whose address 90 West Grove Street, Suite 100, Reno, Nevada 89509. This claim is a relocation of the St. Pat No. 359 lode mining claim, the certificate of location of which is of record in the office of the Recorder of Eureka County, Nevada in Book 89 Page 31, in accordance with NRS 517-080. The general course of this claim is North/South. This claim is 1500 feet in length along the course of the claim, being: 1490 feet from the point of discovery in an North direction to the North end line of this claim, and 10 feet in a South direction to the South end line of the claim. This claim is 600 feet in width, being 300 feet in width on each side of the center line of the claim.

This claim is located within the SW & NW Quarter of Section 35, Township 18 North, Range 52 East, Mount Diablo Base and Meridian, Eureka Mining District, Eureka County, Nevada. The location monument of this claim is situated with reference to some natural object or permanent monument as follows: The number 6 corner of this claim is located approximately 8,750 feet N 79° W from the SE corner of section 36, T18N, R52E, MDM.

The corners of this claim are marked by 4" x 4" x 5" posts or pipe with metal tags inscribed with the appropriate corner number as shown on the following sketch and the accompanying claim map.

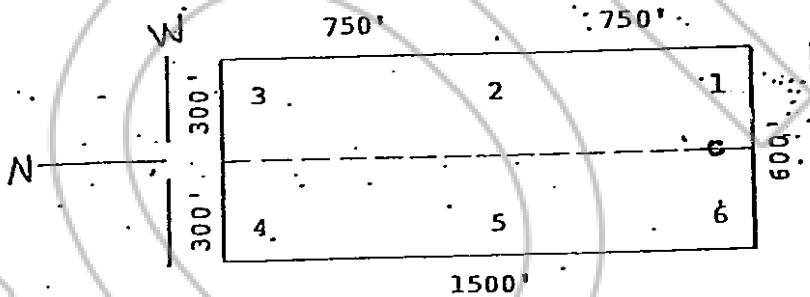

The location work consisted of making the map provided in NRS 517 Dated and posted on the ground this 10 day of December 19 80.

RECORDED AT REQUEST OF  
**AMERICAN SELCO, INC.**  
 FEB 13. AIO: 49  
 OFFICIAL RECORDS  
 EUREKA COUNTY, NEVADA  
 WILLIS A. DEPAUL - RECORDER  
 FILE NO. 78892  
 FEES 3.00

Locator:  
 AMERICAN SELCO, INC.

By Mike Perry  
 Agent for  
 AMERICAN SELCO, INC.

I hereby certify that the within instrument was filed and recorded at the request of: \_\_\_\_\_ FILE NO. \_\_\_\_\_ on \_\_\_\_\_ at \_\_\_\_\_

Witness my hand and official seal the day and year aforesaid.

Book 91 Page 450  
 County Recorder

NOTICE IS HEREBY GIVEN that St. Pat No. 360 lode mining claim has been located by American Selco, a New York corporation, whose address 90 West Grove Street, Suite 100, Reno, Nevada 89509. This claim is a relocation of the St. Pat No. 360 lode mining claim, the certificate of location of which is of record in the office of the Recorder of Eureka County, Nevada in Book 89 Page 32, in accordance with NRS 517.080. The general course of this claim is North/South. This claim is 1500 feet in length along the course of the claim, being 10 feet from the point of discovery in an North direction to the North end line of this claim, and 1490 feet in a South direction to the South end line of the claim. This claim is 600 feet in width, being 300 feet in width on each side of the center line of the claim.

This claim is located within the SW Quarter of Section 35, Township 18 North, Range 52 East, Mount Diablo Base and Meridian, Eureka Mining District, Eureka County, Nevada. The location monument of this claim is situated with reference to some natural object or permanent monument as follows: The number 6 corner of this claim is located approximately 8,750 feet N79°W from the SE corner of section 36, T18N, R52E, MDM.

The corners of this claim are marked by 4" x 4" x 5' posts or pipe with metal tags inscribed with the appropriate corner number as shown on the following sketch and the accompanying claim map.

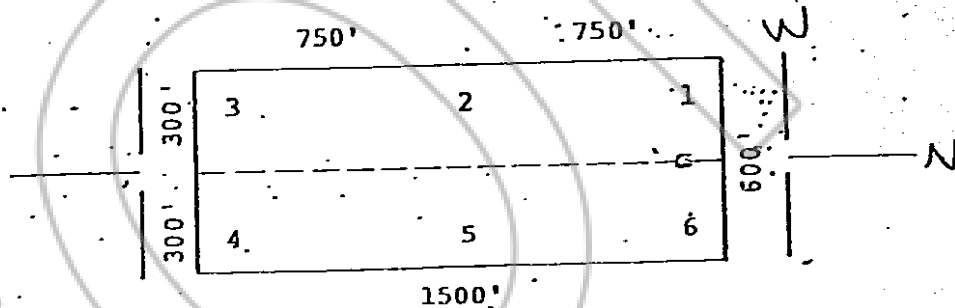

The location work consisted of making the map provided in NRS 517.

Dated and posted on the ground this 10 day of December

1980

RECORDED AT REQUEST OF  
AMERICAN SELCO, INC.  
BOOK 91 PAGE 451

FEB 13 4 10 PM '80

OFFICIAL RECORDS  
EUREKA COUNTY, NEVADA  
WILLIS A. DEPAULO, RECORDER  
FILE NO. 78893  
FEE \$ 3.00

COUNTY OF \_\_\_\_\_ )  
 ) ss.

Locator:

AMERICAN SELCO, INC.

By Mike Perry  
Agent for  
AMERICAN SELCO, INC.

I hereby certify that the within instrument was filed and recorded at the request of: \_\_\_\_\_  
FILE NO. \_\_\_\_\_  
on \_\_\_\_\_  
at \_\_\_\_\_

Witness my hand and official seal the day and year afore said.

BOOK 91 PAGE 451  
County Recorder



NOTICE IS HEREBY GIVEN that St. Pat No. 361 lode mining claim has been located by American Selco, a New York corporation, whose address 90 West Grove Street, Suite 100, Reno, Nevada 89509. This claim is a relocation of the St. Pat No. 361 lode mining claim, the certificate of location of which is of record in the office of the Recorder of Eureka County, Nevada in Book 89 Page 33, in accordance with NRS 517.080. The general course of this claim is North/South. This claim is 1500 feet in length along the course of the claim, being 1490 feet from the point of discovery in an North direction to the North end line of this claim, and 10 feet in a South direction to the South end line of the claim. This claim is 600 feet in width, being 300 feet in width on each side of the center line of the claim.

This claim is located within the NW & SW Quarter of Section 35, Township 18 North, Range 52 East, Mount Diablo Base and Meridian, Eureka Mining District, Eureka County, Nevada. The location monument of this claim is situated with reference to some natural object or permanent monument as follows: The number one corner of this claim is located approximately 8,750 Feet N 79°W from the SE corner of section 36, T18N, R52E, MDM.

The corners of this claim are marked by 4" x 4" x 5' posts or pipe with metal tags inscribed with the appropriate corner number as shown on the following sketch and the accompanying claim map.

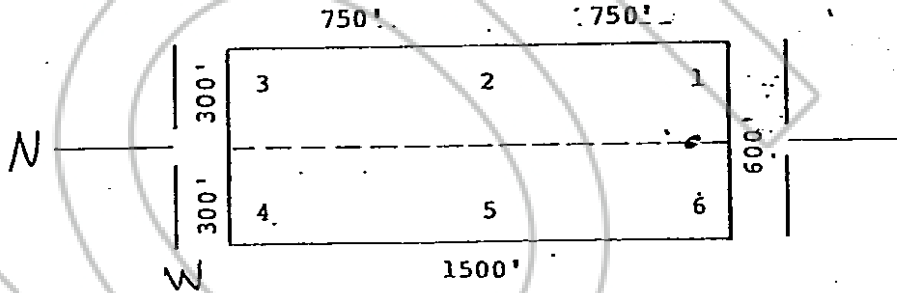

The location work consisted of making the map provided in NRS 517.0

Dated and posted on the ground this 10 day of December

RECORDED AT REQUEST OF  
**AMERICAN SELCO INC**  
 BOOK 91 PAGE 452  
 81 FEB 13 AM: 48  
 WITNESSES:

OFFICIAL RECORDS:  
 EUREKA COUNTY, NEVADA  
 WILLIS A. DEPAUL, RECORDER  
 FILE NO. 78894  
 FEES 3.00

STATE OF NEVADA  
 COUNTY OF \_\_\_\_\_

Locator:  
 AMERICAN SELCO, INC.

By Mike Perry  
 Agent for  
 AMERICAN SELCO, INC.

)  
 ) ss. \_\_\_\_\_

I hereby certify that the within instrument was filed and recorded at the request of: \_\_\_\_\_  
 FILE NO. \_\_\_\_\_  
 on \_\_\_\_\_  
 at \_\_\_\_\_  
 Docket \_\_\_\_\_ Page \_\_\_\_\_

Witness my hand and official seal the day and year afore-said.

BOOK 91 PAGE 452  
 County Recorder

By \_\_\_\_\_  
 Deputy Recorder

NOTICE IS HEREBY GIVEN that St. Pat No. 362 lode mining claim has been located by American Selco, a New York corporation whose address 90 West Grove Street, Suite 100, Reno, Nevada 89509. This claim is a relocation of the St. Pat No. 362 lode mining claim, the certificate of location of which is of record in the office of the Recorder of Eureka County, Nevada in Book 89 Page 34, in accordance with NRS 517.080. The general course of this claim is North/South. This claim is 150 feet in length along the course of the claim, being 10 feet from the point of discovery in an North direction to the North end line of this claim, and 1490 feet in a South direction to the South end line of the claim. This claim is 600 feet in width, being 300 feet in width on each side of the center line of the claim.

This claim is located within the SW Quarter of Section 35, Township 18 North, Range 52 East, Mount Diablo Base Meridian, Eureka Mining District, Eureka County, Nevada. The location monument of this claim is situated with reference to some natural object or permanent monument as follows: The number 6 corner of this claim is located approximately 8,750 feet N79°W from the SE corner of section 36, T18N, R52E, MDM.

The corners of this claim are marked by 4" x 4" x 5" posts or pipe with metal tags inscribed with the appropriate corner number as shown the following sketch and the accompanying claim map.

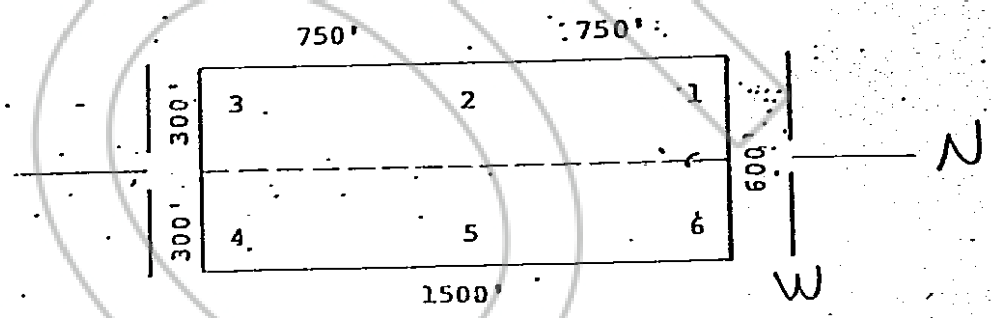

The location work consisted of making the map provided in NRS 517. Dated and posted on the ground this 10 day of December 1980.

RECORDED AT REQUEST OF  
**AMERICAN SELCO, INC.**  
 FEB 13 10 1 AM '81  
 COUNTY OF NEVADA

Locator: AMERICAN SELCO, INC.  
 By Mike Rey  
 Agent for AMERICAN SELCO, INC.

I hereby certify that the within instrument was filed and recorded at the request of: \_\_\_\_\_  
 FILE NO. \_\_\_\_\_  
 on \_\_\_\_\_  
 at \_\_\_\_\_  
 Book of \_\_\_\_\_ Page \_\_\_\_\_

Witness my hand and official seal the day and year aforesaid.  
91 453  
 County Recorder

NOTICE IS HEREBY GIVEN that St. Pat No. 363 lode mining claim has been located by American Selco, a New York corporation, whose address 90 West Grove Street, Suite 100, Reno, Nevada 89509. This claim is a relocation of the St. Pat No. 363 lode mining claim, the certificate of location of which is of record in the office of the Recorder of Eureka County, Nevada in Book 89 Page 35, in accordance with NRS 517.080. The general course of this claim is North/South. This claim is 1500 feet in length along the course of the claim, being 1490 feet from the point of discovery in an North direction to the North end line of this claim, and 10 feet in a South direction to the South end line of the claim. This claim is 600 feet in width, being 300 feet in width on each side of the center line of the claim.

This claim is located within the NE & SE Quarter of Section 35, Township 18 North, Range 52 East, Mount Diablo Base and Meridian, Eureka Mining District, Eureka County, Nevada. The location monument of this claim is situated with reference to some natural object or permanent monument as follows: The number 6 corner of this claim is located approximately 7,600 feet N 77° W from the SE corner of section 36, T18N, R52E, MDM.

The corners of this claim are marked by 4" x 4" x 5' posts or pipe with metal tags inscribed with the appropriate corner number as shown on the following sketch and the accompanying claim map.

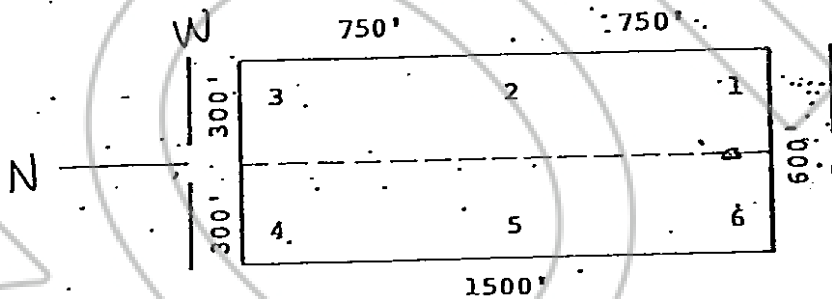

The location work consisted of making the map provided in NRS 517

Dated and posted on the ground this 10 day of December

RECORDED AT REQUEST OF AMERICAN SELCO, INC. BOOK 91 PAGE 454

81 FEB 13 80:49

OFFICIAL RECORDS EUREKA COUNTY, NEVADA WILLIS A. DEPAULI, RECORDER FILE NO. 78896 FEES \$3.00

Locator:

AMERICAN SELCO, INC.

By Mike Peir  
Agent for  
AMERICAN SELCO, INC.

STATE OF NEVADA )  
COUNTY OF \_\_\_\_\_ ) ss.

I hereby certify that the within instrument was filed and recorded at the request of: \_\_\_\_\_

FILE NO. \_\_\_\_\_  
on \_\_\_\_\_  
at \_\_\_\_\_  
Page \_\_\_\_\_

Witness my hand and official seal the day and year aforesaid.

BOOK 91 PAGE 454  
County Recorder

NOTICE IS HEREBY GIVEN that St. Pat No. 364 lode mining claim has been located by American Selco, a New York corporation, whose address 90 West Grove Street, Suite 100, Reno, Nevada 89509. This claim is a relocation of the St. Pat No. 364 lode mining claim, the certificate of location of which is of record in the office of the Recorder of Eureka County, Nevada in Book 89 Page 36, in accordance with NRS 517.080. The general course of this claim is North/South. This claim is 1500 feet in length along the course of the claim, being 10 feet from the point of discovery in an North direction to the North end line of this claim, and 1490 feet in a South direction to the South end line of the claim. This claim is 600 feet in width, being 300 feet in width on each side of the center line of the claim.

This claim is located within the SE Quarter of Section 35, Township 18 North, Range 52 East, Mount Diablo Base and Meridian, Eureka Mining District, Eureka County, Nevada. The location monument of this claim is situated with reference to some natural object or permanent monument as follows: The number 6 corner of this claim is located approximately 7,600 feet N77°W from the SE corner of section 36, T18N, R52E, MDM.

The corners of this claim are marked by 4" x 4" x 5' posts or pipe with metal tags inscribed with the appropriate corner number as shown on the following sketch and the accompanying claim map.

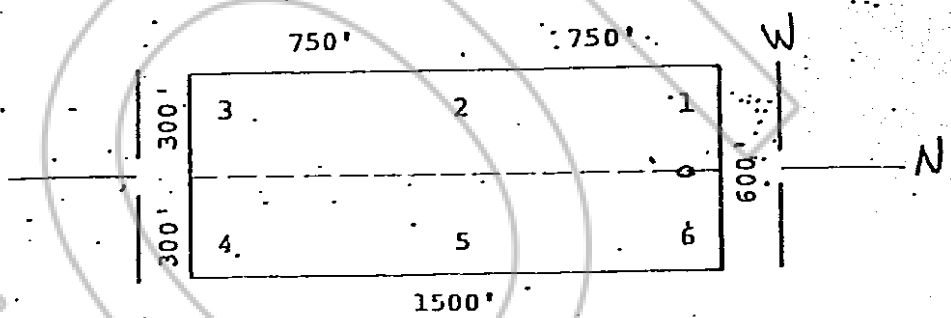

The location work consisted of making the map provided in NRS 517. Dated and posted on the ground this 10 day of December

RECORDED AT REQUEST OF  
AMERICAN SELCO, INC.  
BOOK 89 PAGE 455

OFFICIAL RECORDS  
EUREKA COUNTY, NEVADA  
WILLIS ADRIAN RECORDER  
FILE NO. 8897  
FEES \$ 3.00

81 FEB 19 49

Locator:  
AMERICAN SELCO, INC.

By: Mike Perij  
Agent for  
AMERICAN SELCO, INC.

STATE OF NEVADA )  
COUNTY OF \_\_\_\_\_ ) ss. \_\_\_\_\_

I hereby certify that the within instrument was filed and recorded at the request of: \_\_\_\_\_  
FILE NO. \_\_\_\_\_  
on \_\_\_\_\_  
at \_\_\_\_\_  
County Recorder

Witness my hand and official seal the day and year afore said.  
BOOK 91 PAGE 455  
County Recorder

NOTICE IS HEREBY GIVEN that St. Pat No. 365 lode mining claim has been located by American Selco, a New York corporation, whose address 90 West Grove Street, Suite 100, Reno, Nevada 89509. This claim is a relocation of the St. Pat No. 365 lode mining claim, the certificate of location of which is of record in the office of the Recorder of Eureka County, Nevada in Book 89 Page 37, in accordance with NRS 517.080. The general course of this claim is North/South. This claim is 1500 feet in length along the course of the claim, being 1490 feet from the point of discovery in an North direction to the North end line of this claim, and 10 feet in a South direction to the South end line of the claim. This claim is 600 feet in width, being 300 feet in width on each side of the center line of the claim.

This claim is located within the NE & SE Quarter of Section 35, Township 18 North, Range 52 East, Mount Diablo Base and Meridian, Eureka Mining District, Eureka County, Nevada. The location monument of this claim is situated with reference to some natural object or permanent monument as follows: The number 6 corner of this claim is located approximately 7,600 feet N 77° W from the SE corner of section 36, T18N, R52E, MDM.

The corners of this claim are marked by 4" x 4" x 5' posts or pipe with metal tags inscribed with the appropriate corner number as shown on the following sketch and the accompanying claim map.

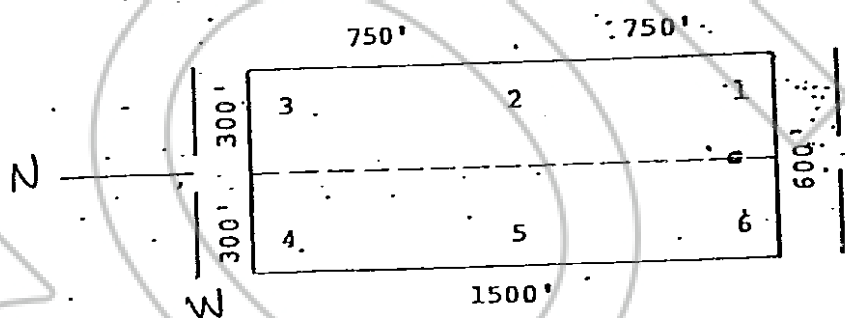

The location work consisted of making the map provided in NRS 517. Dated and posted on the ground this 10 day of December

RECORDED AT REQUEST OF  
**AMERICAN SELCO, INC.**  
 BOOK 91 PAGE 456  
 81 FEB 18 AM: 49  
 OFFICIAL RECORDS  
 EUREKA COUNTY, NEVADA  
 WILLIS A. DUFFELL, RECORDER  
 FILE NO. 78898  
 FEE \$ 3.00

Locator:  
 AMERICAN SELCO, INC.

By: Mike Perry  
 Agent for  
 AMERICAN SELCO, INC.

STATE OF NEVADA )  
 COUNTY OF \_\_\_\_\_ ) ss.  
 I hereby certify that the within instrument was filed and recorded at the request of: \_\_\_\_\_  
 FILE NO. \_\_\_\_\_  
 on \_\_\_\_\_  
 at \_\_\_\_\_  
 Page \_\_\_\_\_

Witness my hand and official seal the day and year aforesaid.  
91 456  
 County Recorder

NOTICE IS HEREBY GIVEN that St. Pat No. 366 100 mining claim has been located by American Selco, a New York corporation, whose address 90 West Grove Street, Suite 100, Reno, Nevada 89509. This claim is a relocation of the St. Pat No. 366 lode mining claim, the certificate of location of which is of record in the office of the Recorder of Eureka County, Nevada in Book 89 Page 38, in accordance with NRS 517.080. The general course of this claim is North/South. This claim is 1500 feet in length along the course of the claim, being 10 feet from the point of discovery in an North direction to the North end line of this claim, and 1490 feet in a South direction to the South end line of the claim. This claim is 600 feet in width, being 300 feet in width on each side of the center line of the claim.

This claim is located within the SE Quarter of Section 35, Township 18 North, Range 52 East, Mount Diablo Base and Meridian, Eureka Mining District, Eureka County, Nevada. The location monument of this claim is situated with reference to some natural object or permanent monument as follows: The number 6 corner of this claim is located approximately 7,600 feet N77°W from the SE corner of section 36, T18N, R52E, MDM.

The corners of this claim are marked by 4" x 4" x 5' posts or pipe with metal tags inscribed with the appropriate corner number as shown in the following sketch and the accompanying claim map.

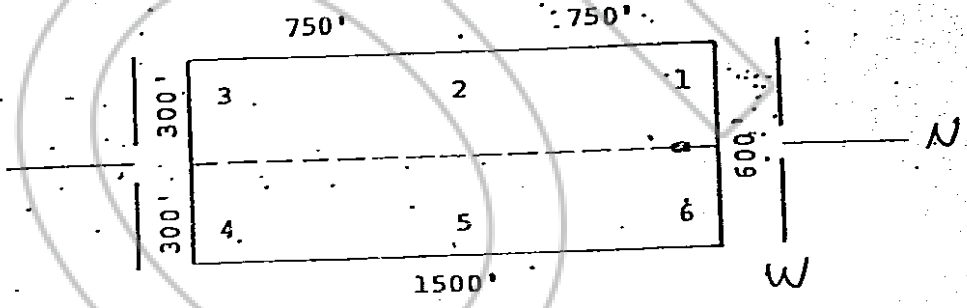

The location work consisted of making the map provided in NRS 517 Dated and posted on the ground this 10 day of December

1980  
 RECORDED AT REQUEST OF  
**AMERICAN SELCO, INC.**  
 BOOK 91 PAGE 457

81 FEB 13 A.M. 49

OFFICIAL RECORDS  
 EUREKA COUNTY, NEVADA  
 WILLIS A. DEPAULIS, RECORDER  
 FILE NO. 78899  
 FEE \$ 3.00

STATE OF NEVADA  
 COUNTY OF \_\_\_\_\_ ) ss.

Locator:  
 AMERICAN SELCO, INC.

By Mike Perry  
 Agent for  
 AMERICAN SELCO, INC.

I hereby certify that the within instrument was filed and recorded at the request of: \_\_\_\_\_ FILE NO. \_\_\_\_\_ on \_\_\_\_\_ at \_\_\_\_\_ n. s. t. \_\_\_\_\_ Page \_\_\_\_\_

Witness my hand and official seal the day and year aforesaid.

BOOK 91 PAGE 457  
 County Recorder

NOTICE IS HEREBY GIVEN that St. Pat No. 367 lode mining claim has been located by American Selco, a New York corporation, whose address 90 West Grove Street, Suite 100, Reno, Nevada 89509. This claim is a relocation of the St. Pat No. 367 lode mining claim, the certificate of location of which is of record in the office of the Recorder of Eureka County, Nevada in Book 89 Page 39, in accordance with NRS 517.080. The general course of this claim is North/South. This claim is 1500 feet in length along the course of the claim, being 1490 feet from the point of discovery in an North direction to the North end line of this claim, and 10 feet in a South direction to the South end line of the claim. This claim is 600 feet in width, being 300 feet in width on each side of the center line of the claim.

This claim is located within the NE 1/4 SE Quarter of Section 35, Township 18 North, Range 52 East, Mount Diablo Base and Meridian, Eureka Mining District, Eureka County, Nevada. The location monument of this claim is situated with reference to some natural object or permanent monument as follows: The number 6 corner of this claim is located approximately 6.450 feet N 75° W from the SE corner of section 36, T18N, R52E, MDM.

The corners of this claim are marked by 4" x 4" x 5" posts or pipe with metal tags inscribed with the appropriate corner number as shown on the following sketch and the accompanying claim map.

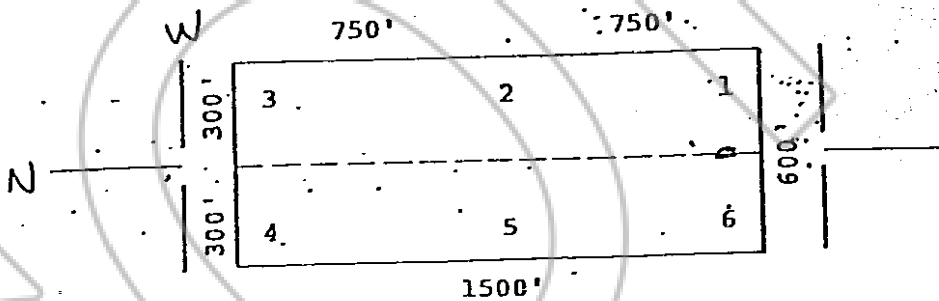

The location work consisted of making the map provided in NRS 517.

Dated and posted on the ground this 10 day of December

19  
 AMERICAN SELCO, INC.  
 BOOK 91 PAGE 458

81 FEB 13 AM 5:50

OFFICIAL RECORDS  
 EUREKA COUNTY, NEVADA  
 WILLIS A. DEPAUL RECORDER  
 FILE NO. 78900  
 FEE \$ 3.00

Locator:

AMERICAN SELCO, INC.

By Michael Perry  
 Agent for  
 AMERICAN SELCO, INC.

STATE OF NEVADA )  
 COUNTY OF ) ss.

I hereby certify that the within instrument was filed and recorded at the request of: \_\_\_\_\_  
 FILE NO. \_\_\_\_\_  
 on \_\_\_\_\_  
 at \_\_\_\_\_  
 Perpet \_\_\_\_\_ Page \_\_\_\_\_

Witness my hand and official seal the day and year afore said.

BOOK 91 PAGE 458  
 County Recorder

NOTICE IS HEREBY GIVEN that St. Pat No. 368 lode mining claim has been located by American Selco, a New York corporation, whose address 90 West Grove Street, Suite 100, Reno, Nevada 89509. This claim is a relocation of the St. Pat No. 368 lode mining claim, the certificate of location of which is of record in the office of the Recorder of Eureka County, Nevada in Book 89 Page 40, in accordance with NRS 517.080. The general course of this claim is North/South. This claim is 1500 feet in length along the course of the claim, being 10 feet from the point of discovery in an North direction to the North end line of this claim, and 1490 feet in a South direction to the South end line of the claim. This claim is 600 feet in width, being 300 feet in width on each side of the center line of the claim.

This claim is located within the SE Quarter of Section 35, Township 18 North, Range 52 East, Mount Diablo Base Meridian, Eureka Mining District, Eureka County, Nevada. The location monument of this claim is situated with reference to some natural object or permanent monument as follows: The number 6 corner of this claim is located approximately 6430 feet N 75° W from the SE corner of section 36, T18N, R52E, MDM.

The corners of this claim are marked by 4" x 4" x 5' posts or pipe with metal tags inscribed with the appropriate corner number as shown on the following sketch and the accompanying claim map.

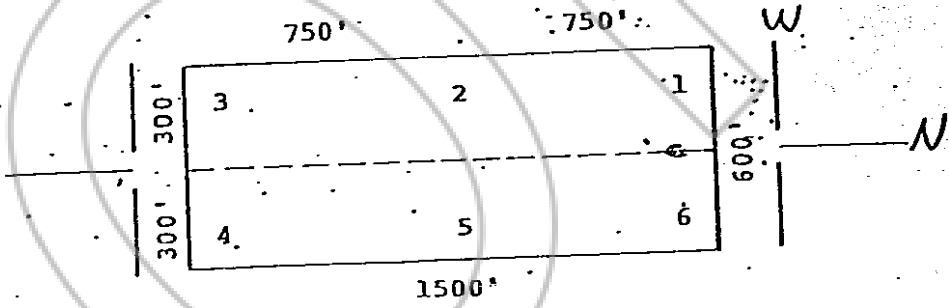

The location work consisted of making the map provided in NRS 517. Dated and posted on the ground this 10 day of December

RECORDED AT REQUEST OF AMERICAN SELCO, INC. BOOK 91 PAGE 459

Business: 81 FEB 13 A 10 50

OFFICIAL RECORDS  
EUREKA COUNTY, NEVADA  
WILLIS A. DEWITT, RECORDER  
FILE NO. 78901  
FEE \$ 3.00

STATE OF NEVADA  
COUNTY OF \_\_\_\_\_

Locator:  
AMERICAN SELCO, INC.

By Mike Perry  
Agent for  
AMERICAN SELCO, INC.

I hereby certify that the within instrument was filed and recorded at the request of: \_\_\_\_\_  
FILE NO. \_\_\_\_\_  
on \_\_\_\_\_  
at \_\_\_\_\_

Witness my hand and official seal the day and year aforesaid.

BOOK 91 PAGE 459  
County Recorder



NOTICE IS HEREBY GIVEN that St. Pat No. 369 10 mining claim has been located by American Selco, a New York corporation whose address 90 West Grove Street, Suite 100, Reno, Nevada 89509. This claim is a relocation of the St. Pat No. 369 lode mining claim, the certificate of location of which is of record in the office of the Recorder of Eureka County, Nevada in Book 89 Page 41, in accordance with NRS 517.080. The general course of this claim is North/South. This claim is 150 feet in length along the course of the claim, being 1490 feet from the point of discovery in an North direction to the North end line of this claim, and 10 feet in a South direction to the South end line of the claim. This claim is 600 feet in width, being 300 feet in width on each side of the center line of the claim.

This claim is located within the NE & SE Quarter of Section 35, Township 18 North, Range 52 East, Mount Diablo Base a Meridian, Eureka Mining District, Eureka County, Nevada. The location monument of this claim is situated with reference to some natural object or permanent monument as follows: The number 6 corner of this claim is located approximately 6,450 feet N 75° W from the SE corner of section 36, T18N, R52E, MDM.

The corners of this claim are marked by 4" x 4" x 5' posts or pipe with metal tags inscribed with the appropriate corner number as shown on the following sketch and the accompanying claim map.

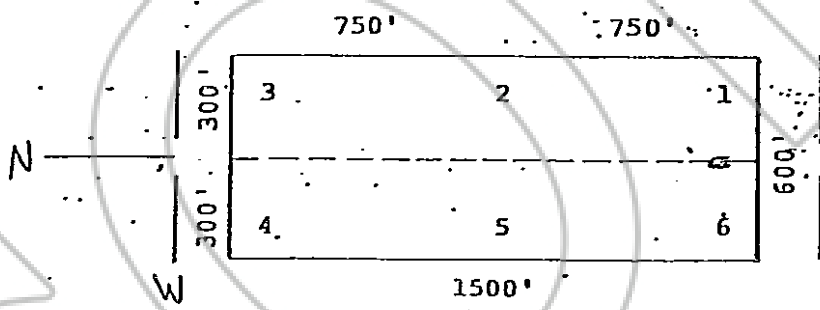

The location work consisted of making the map provided in NRS 517.

Dated and posted on the ground this 10 day of December

1980  
RECORDED AT REQUEST OF  
**AMERICAN SELCO, INC.**  
BOOK 91 PAGE 460

81 FEB 13 AID 50  
OFFICIAL RECORDS  
EUREKA COUNTY, NEVADA  
WILLIAM O'NEILL, RECORDER  
FILE NO. 78902  
FEE \$ 3.00

STATE OF NEVADA )  
COUNTY OF \_\_\_\_\_ ) ss.

Locator:  
AMERICAN SELCO, INC.

By Mike Perry  
Agent for  
AMERICAN SELCO, INC.

I hereby certify that the within instrument was filed and recorded at the request of: \_\_\_\_\_  
FILE NO. \_\_\_\_\_  
on \_\_\_\_\_  
at \_\_\_\_\_  
Page \_\_\_\_\_

Witness my hand and official seal the day and year afore said.  
BOOK 91 PAGE 460  
County Recorder

NOTICE IS HEREBY GIVEN that St. Pat No. 370 loc  
 mining claim has been located by American Selco, a New York corporation,  
 whose address 90 West Grove Street, Suite 100, Reno, Nevada 89509. This  
 claim is a relocation of the St. Pat No. 370 loc  
 mining claim, the certificate of location of which is of record in the  
 office of the Recorder of Eureka County, Nevada in Book  
89 Page 42, in accordance with NRS 517.080.  
 The general course of this claim is North/South. This claim is 150  
 feet in length along the course of the claim, being 10 feet from the  
 point of discovery in an North direction to the North  
 end line of this claim, and 1490 feet in a South direction to  
 the South end line of the claim. This claim is 600 feet in  
 width, being 300 feet in width on each side of the center line of the  
 claim.

This claim is located within the SE Quarter of Section  
35, Township 18 North, Range 52 East, Mount Diablo Base a  
 Meridian, Eureka Mining District, Eureka County,  
 Nevada. The location monument of this claim is situated with reference  
 to some natural object or permanent monument as follows: The number  
6 corner of this claim is located approximately 6,450 feet  
N 75° W from the SE corner of section 36, T18N, R52E, MDM.

The corners of this claim are marked by 4" x 4" x 5' posts or pipe  
 with metal tags inscribed with the appropriate corner number as shown on  
 the following sketch and the accompanying claim map.

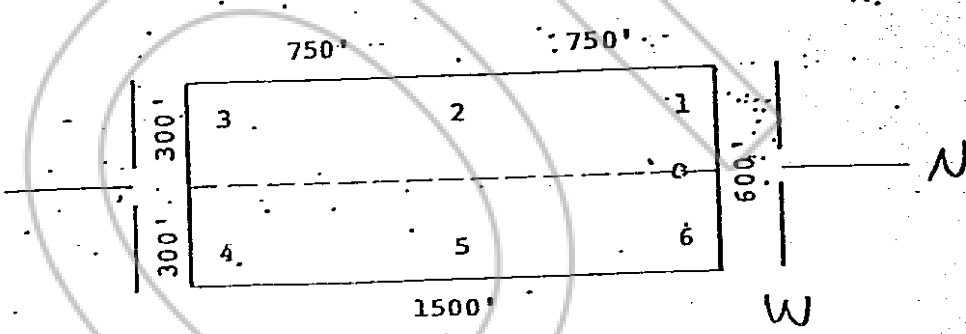

The location work consisted of making the map provided in NRS 517  
 Dated and posted on the ground this 10 day of December

RECORDED AT REQUEST OF  
 AMERICAN SELCO, INC.  
 BOOK 91 PAGE 441

Dated and posted on the ground this 10 day of December  
 Messrs:  
 B1 FEB 13 1960  
 OFFICIAL RECORDS  
 EUREKA COUNTY NEVADA  
 WILLIS A. DILLON, RECORDER  
 FILE NO. 78903  
 FEE \$ 3.00

Locator:  
 AMERICAN SELCO, INC.  
 By Mike Perry  
 Agent for  
 AMERICAN SELCO, INC.

STATE OF NEVADA  
 COUNTY OF \_\_\_\_\_ ) ss.

I hereby certify that the within  
 instrument was filed and recorded at  
 the request of: \_\_\_\_\_  
 FILE NO. \_\_\_\_\_  
 on \_\_\_\_\_  
 at \_\_\_\_\_  
 Booklet \_\_\_\_\_ Page \_\_\_\_\_

Witness my hand and official  
 seal the day and year aforesaid.  
 BOOK 91 PAGE 441  
 County Recorder

NOTICE IS HEREBY GIVEN that St. Pat No. 371 lode mining claim has been located by American Selco, a New York corporation, whose address 90 West Grove Street, Suite 100, Reno, Nevada 89509. This claim is a relocation of the St. Pat No. 371 lode mining claim, the certificate of location of which is of record in the office of the Recorder of Eureka County, Nevada in Book 89 Page 43, in accordance with NRS 517.080. The general course of this claim is North/South. This claim is 1500 feet in length along the course of the claim, being 1490 feet from the point of discovery in an North direction to the North end line of this claim, and 10 feet in a South direction to the South end line of the claim. This claim is 600 feet in width, being 300 feet in width on each side of the center line of the claim.

This claim is located within the all Quarter of Section 35 & 36, Township 18 North, Range 52 East, Mount Diablo Base and Meridian, Eureka Mining District, Eureka County, Nevada. The location monument of this claim is situated with reference to some natural object or permanent monument as follows: The number 6 corner of this claim is located approximately 5,300 feet N73°W from the SE corner of section 36, T18N, R52E, MDM.

The corners of this claim are marked by 4" x 4" x 5' posts or pipe with metal tags inscribed with the appropriate corner number as shown on the following sketch and the accompanying claim map.

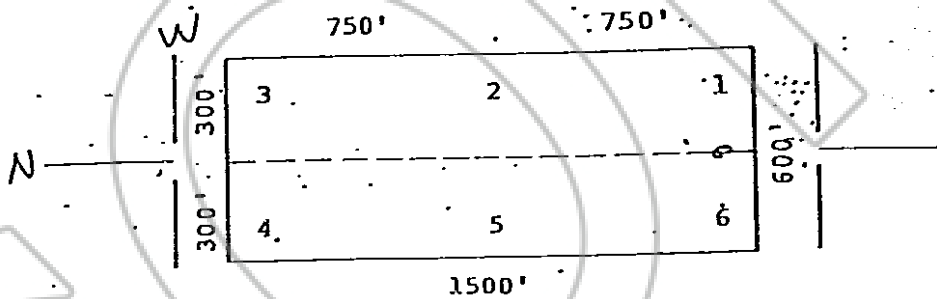

The location work consisted of making the map provided in NRS 517.0

Dated and posted on the ground this 10 day of December

19  
 RECORDED AT REQUEST OF  
 AMERICAN SELCO, INC.  
 BOOK 89 PAGE 462  
 81 FEB 13 AM 10:59  
 OFFICIAL RECORDS  
 EUREKA COUNTY, NEVADA  
 WILLIS A. DEWITT - RECORDER  
 FILE NO. 78904  
 FEE \$ 3.00  
 STATE OF NEVADA )  
 COUNTY OF ) ss.

Locator:  
 AMERICAN SELCO, INC.  
 By Mike Perry  
 Agent for  
 AMERICAN SELCO, INC.

I hereby certify that the within instrument was filed and recorded at the request of:  
 FILE NO. \_\_\_\_\_  
 on \_\_\_\_\_  
 at \_\_\_\_\_  
 Docket \_\_\_\_\_ Page \_\_\_\_\_

Witness my hand and official seal the day and year aforesaid.  
BOOK 91 PAGE 462  
 County Recorder

NOTICE IS HEREBY GIVEN that St. Pat No. 372 lode mining claim has been located by American Selco, a New York corporation, whose address 90 West Grove Street, Suite 100, Reno, Nevada 89509. This claim is a relocation of the St. Pat No. 372 lode mining claim, the certificate of location of which is of record in the office of the Recorder of Eureka County, Nevada in Book 89 Page 44, in accordance with NRS 517.080. The general course of this claim is North/South. This claim is 150 feet in length along the course of the claim, being 10 feet from the point of discovery in an North direction to the North end line of this claim, and 1490 feet in a South direction to the South end line of the claim. This claim is 600 feet in width, being 300 feet in width on each side of the center line of the claim.

This claim is located within the SE 1/4 SW Quarter of Section 35/36, Township 18 North, Range 52 East, Mount Diablo Base a Meridian, Eureka Mining District, Eureka County, Nevada. The location monument of this claim is situated with reference to some natural object or permanent monument as follows: The number 6 corner of this claim is located approximately 5,300 feet N 73°W from the SE corner of section 36, T18N, R52E, MDM.

The corners of this claim are marked by 4" x 4" x 5" posts or pipe with metal tags inscribed with the appropriate corner number as shown on the following sketch and the accompanying claim map.

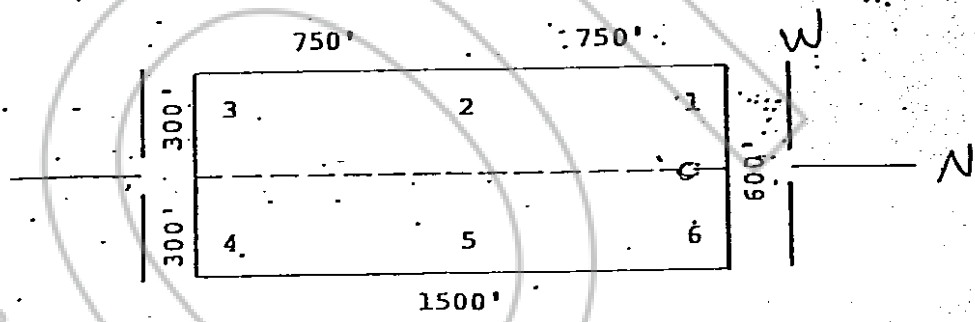

The location work consisted of making the map provided in NRS 517. Dated and posted on the ground this 10 day of December

19 80

RECORDED AT REQUEST OF  
**AMERICAN SELCO, INC.**  
 BOOK 91 PAGE 463  
 FEB 13 10:50  
 OFFICIAL RECORDS  
 EUREKA COUNTY, NEVADA  
 FILE NO. 78905  
 FEE \$ 3.00

Locator:  
**AMERICAN SELCO, INC.**

By Mike Perry  
 Agent for  
**AMERICAN SELCO, INC.**

I hereby certify that the within instrument was filed and recorded at the request of: \_\_\_\_\_  
 FILE NO. \_\_\_\_\_  
 on \_\_\_\_\_  
 at \_\_\_\_\_  
 pocket \_\_\_\_\_ Page \_\_\_\_\_

Witness my hand and official seal the day and year afore said.  
 BOOK 91 PAGE 463  
 County Recorder