

NOTICE IS HEREBY GIVEN that St. Pat No. 354 lode mining claim has been located by American Selco, a New York corporation, whose address 90 West Grove Street, Suite 100, Reno, Nevada 89509. This claim is a relocation of the St. Pat No. 354 lode mining claim, the certificate of location of which is of record in the office of the Recorder of Eureka County, Nevada in Book 89 Page 26, in accordance with NRS 517.080. The general course of this claim is North/South. This claim is 1500 feet in length along the course of the claim, being 10 feet from the point of discovery in an North direction to the North end line of this claim, and 1490 feet in a South direction to the South end line of the claim. This claim is 600 feet in width, being 300 feet in width on each side of the center line of the claim.

This claim is located within the SW Quarter of Section 35, Township 18 North, Range 52 East, Mount Diablo Base and Meridian, Eureka Mining District, Eureka County, Nevada. The location monument of this claim is situated with reference to some natural object or permanent monument as follows: The number 6 corner of this claim is located approximately 11150 feet N 81° W from the SE corner of section 36, T18N, R52E, MDM.

The corners of this claim are marked by 4" x 4" x 5' posts or pipe with metal tags inscribed with the appropriate corner number as shown on the following sketch and the accompanying claim map.

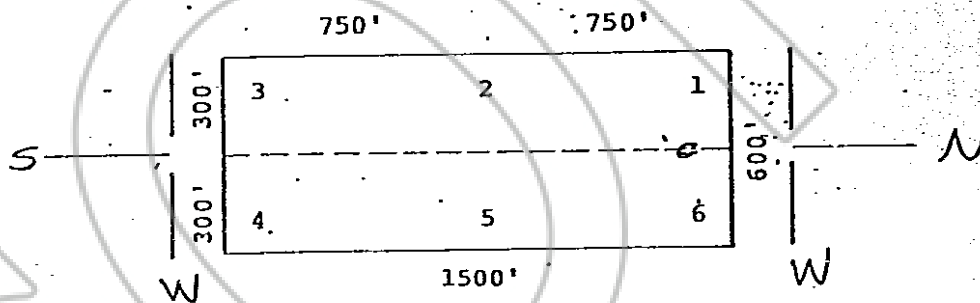

The location work consisted of making the map provided in NRS 517.040

Dated and posted on the ground this 10 day of December 19 80.

Witnesses:

BOOK 91 PAGE 445  
FILE NO. 18887  
FEE \$ 3.00

OFFICIAL RECORDS  
EUREKA COUNTY, NEVADA  
WILLIS A. ORR, RECORDER  
FILE NO. 18887  
FEE \$ 3.00

Locator:

AMERICAN SELCO, INC.

By Mike Perry  
Agent for  
AMERICAN SELCO, INC.

I hereby certify that the within instrument was filed and recorded at the request of:

FILE NO.

on

at

Docket

Page

Witness my hand and official seal the day and year afore-said.

BOOK 91 PAGE 445

County Recorder

By

WILLIS A. ORR