

NOTICE IS HEREBY GIVEN that St. Pat No. 231 lode mining claim has been located by American Selco, a New York corporation, whose address 90 West Grove Street, Suite 100, Reno, Nevada 89509. This claim is a relocation of the St. Pat No. 231 lode mining claim, the certificate of location of which is of record in the office of the Recorder of Eureka County, Nevada in Book 88 Page 512, in accordance with NRS 517.080. The general course of this claim is North/South. This claim is 1500 feet in length along the course of the claim, being 1490 feet from the point of discovery in an North direction to the North end line of this claim, and 10 feet in a South direction to the South end line of the claim. This claim is 600 feet in width, being 300 feet in width on each side of the center line of the claim.

This claim is located within the SW Quarter of Section 8, Township 17 North, Range 52 East, Mount Diablo Base and Meridian, Eureka Mining District, Eureka County, Nevada. The location monument of this claim is situated with reference to some natural object or permanent monument as follows: The number one corner of this claim is located approximately 2,200 feet 5640W from the SE corner of section 36, T18N, R52E, MDM.

The corners of this claim are marked by 4" x 4" x 5' posts or pipe with metal tags inscribed with the appropriate corner number as shown on the following sketch and the accompanying claim map.

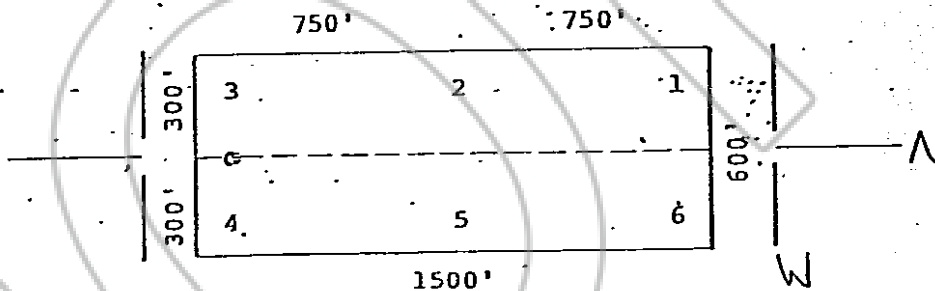

The location work consisted of making the map provided in NRS 517.0.

Dated and posted on the ground this 27 day of January

19

Witnesses:

AMERICAN SELCO, INC.

BOOK 91 PAGE 444

FILE NO. 78907

OFFICIAL RECORDS

WILLIS A. DEPT. 13

FILE NO. 78907

FEE \$ 3.00

ss.

OPB

RECEIVED AT REQUEST OF

AMERICAN SELCO, INC.

BOOK 91 PAGE 444

FILE NO. 78907

OFFICIAL RECORDS

WILLIS A. DEPT. 13

FILE NO. 78907

FEE \$ 3.00

ss.

OPB

I hereby certify that the within instrument was filed and recorded at the request of:

FILE NO. _____

on _____

at _____

Docket _____ Page _____

Locator:

AMERICAN SELCO, INC.

By

Agent for

AMERICAN SELCO, INC.

Witness my hand and official seal the day and year afore-said.

BOOK 91 PAGE 444

County Recorder

By

NOTICE IS HEREBY GIVEN that St. Pat No. 281 lo-
mining claim has been located by American Selco, a New York corporation,
whose address 90 West Grove Street, Suite 100, Reno, Nevada 89509. This
claim is a relocation of the St. Pat No. 281 lode
mining claim, the certificate of location of which is of record in the
office of the Recorder of Eureka County, Nevada in Book
88 Page 564, in accordance with NRS 517.080.
The general course of this claim is North/South. This claim is 1500
feet in length along the course of the claim, being 1490 feet from the
point of discovery in an North direction to the North
end line of this claim, and 10 feet in a South direction to
the South end line of the claim. This claim is 600 feet in
width, being 300 feet in width on each side of the center line of the
claim.

This claim is located within the SE Quarter of Section
18, Township 17 North, Range 52 East, Mount Diablo Base and
Meridian, Eureka Mining District, Eureka County,
Nevada. The location monument of this claim is situated with reference
to some natural object or permanent monument as follows: The number
1 corner of this claim is located approximately 26,700 feet S 53° W from
the located SE corner of section 36, T18N, R52E, WDM.

The corners of this claim are marked by 4" x 4" x 5' posts or pipe
with metal tags inscribed with the appropriate corner number as shown on
the following sketch and the accompanying claim map.

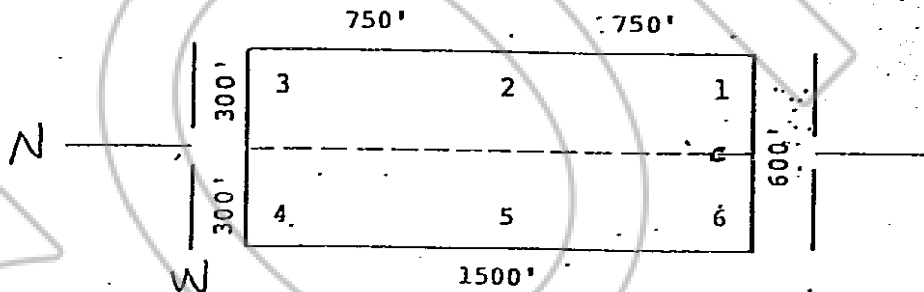

The location work consisted of making the map provided in NRS 517.04

Dated and posted on the ground this 24 day of November

19 80

RECORDED AT REQUEST OF
AMERICAN SELCO, INC.
BOOK 91 PAGE 465

LESS
FEB 13 10:50

OFFICIAL RECORDS
EUREKA COUNTY, NEVADA
FILE NO. 78908
FEE \$ 3.00

COUNTY OF NEVADA
COUNTY OF NEVADA

Locator:

AMERICAN SELCO, INC.

By Mike Perry
Agent for
AMERICAN SELCO, INC.

I hereby certify that the within
instrument was filed and recorded at
the request of:

FILE NO.

on

at

Docket

Page

Witness my hand and official
seal the day and year afore-
said.

BOOK 91 PAGE 465
County Recorder

NOTICE IS HEREBY GIVEN that St. Pat No. 282 lode mining claim has been located by American Selco, a New York corporation whose address 90 West Grove Street, Suite 100, Reno, Nevada 89509. This claim is a relocation of the St. Pat No. 282 lode mining claim, the certificate of location of which is of record in the office of the Recorder of Eureka County, Nevada in Book 88 Page 565, in accordance with NRS 517.080. The general course of this claim is North/South. This claim is 150 feet in length along the course of the claim, being 1490 feet from the point of discovery in an North direction to the North end line of this claim, and 10 feet in a South direction to the South end line of the claim. This claim is 600 feet in width, being 300 feet in width on each side of the center line of the claim.

This claim is located within the SE Quarter of Section 18, Township 17 North, Range 52 East, Mount Diablo Base Meridian, Eureka Mining District, Eureka County, Nevada. The location monument of this claim is situated with reference to some natural object or permanent monument as follows: The number 1 corner of this claim is located approximately 26,900 feet S 53° W from the located SE corner of section 36, T18N, R52E, MDM.

The corners of this claim are marked by 4" x 4" x 5' posts or pipe with metal tags inscribed with the appropriate corner number as shown on the following sketch and the accompanying claim map.

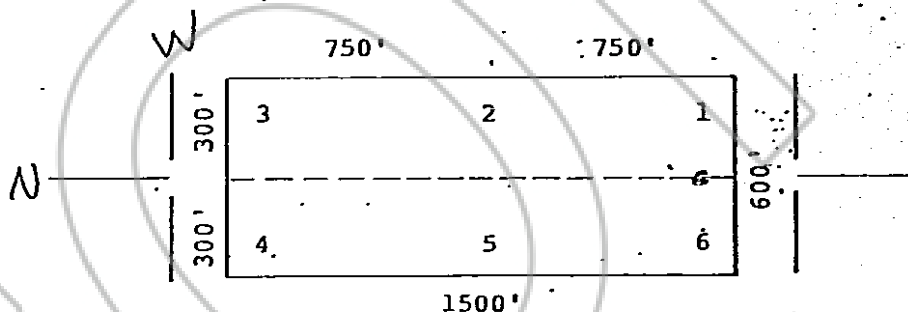

The location work consisted of making the map provided in NRS 517.

Dated and posted on the ground this 24 day of November

9 80

RECORDED AT REQUEST OF
AMERICAN SELCO, INC.
BOOK 91 PAGE 446
FEB 13 4:10:50 PM '80
OFFICE OF NEVADA
COUNTY RECORDER
EUREKA COUNTY, NEVADA
FILE NO. 78909
FEE \$ 4.66

COUNTY OF _____

I hereby certify that the within instrument was filed and recorded at the request of: _____

FILE NO. _____

on _____

at _____

Docket _____

Page _____

Locator: _____

AMERICAN SELCO, INC.

By Mike Peir
Agent for
AMERICAN SELCO, INC.

Witness my hand and official seal the day and year aforesaid.

BOOK 91 PAGE 446
County Recorder

By _____

NOTICE IS HEREBY GIVEN that St. Pat No. 283 lode mining claim has been located by American Selco, a New York corporation, whose address 90 West Grove Street, Suite 100, Reno, Nevada 89509. This claim is a relocation of the St. Pat No. 283 lode mining claim, the certificate of location of which is of record in the office of the Recorder of Eureka County, Nevada in Book 88 Page 566, in accordance with NRS 517.080. The general course of this claim is North/South. This claim is 1500 feet in length along the course of the claim, being 1490 feet from the point of discovery in an North direction to the North end line of this claim, and 10 feet in a South direction to the South end line of the claim. This claim is 600 feet in width, being 300 feet in width on each side of the center line of the claim.

This claim is located within the SW Quarter of Section 17, Township 17 North, Range 52 East, Mount Diablo Base and Meridian, Eureka Mining District, Eureka County, Nevada. The location monument of this claim is situated with reference to some natural object or permanent monument as follows: The number 1 corner of this claim is located approximately 25,200 feet SS 1° W from the located SE corner of section 36, T18N, R52E, MDM.

The corners of this claim are marked by 4" x 4" x 5' posts or pipe with metal tags inscribed with the appropriate corner number as shown on the following sketch and the accompanying claim map.

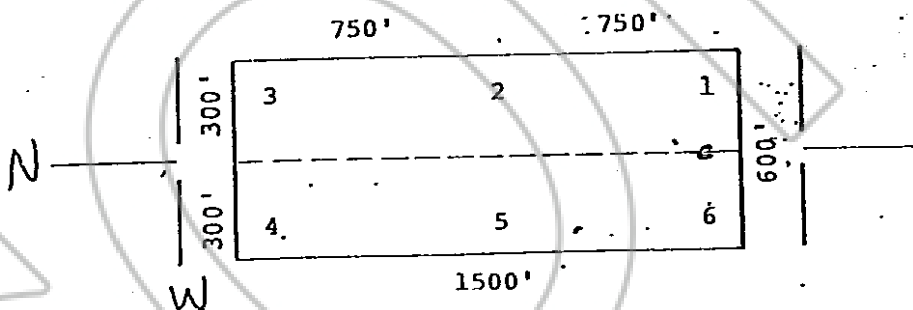

The location work consisted of making the map provided in NRS 517.0.

Dated and posted on the ground this 24 day of November

RECORDED AT REQUEST OF
AMERICAN SELCO, INC.
BOOK 91 PAGE 467
FEB 13 10:00
OFFICIAL RECORDS
EUREKA COUNTY, NEVADA
WILLIS A. DEPLINE, RECORDER
FILE NO. 78910
FEE \$ 3.00

COUNTY OF _____

I hereby certify that the within instrument was filed and recorded at the request of: _____
FILE NO. _____
on _____
at _____
Docket _____ Page _____

Locator:

AMERICAN SELCO, INC.

By Mike Perry
Agent for
AMERICAN SELCO, INC.

Witness my hand and official seal the day and year afore-said.

BOOK 91 PAGE 467
County Recorder

By _____

NOTICE IS HEREBY GIVEN that St. Pat No. 284 lode mining claim has been located by American Selco, a New York corporation, whose address 90 West Grove Street, Suite 100, Reno, Nevada 89509. This claim is a relocation of the St. Pat No. 284 lode mining claim, the certificate of location of which is of record in the office of the Recorder of Eureka County, Nevada in Book 88 Page 567, in accordance with NRS 517.080. The general course of this claim is North/South. This claim is 1500 feet in length along the course of the claim, being 1400 feet from the point of discovery in an North direction to the North end line of this claim, and 10 feet in a South direction to the South end line of the claim. This claim is 600 feet in width, being 300 feet in width on each side of the center line of the claim.

This claim is located within the SW Quarter of Section 17, Township 17 North, Range 52 East, Mount Diablo Base and Meridian, Eureka Mining District, Eureka County, Nevada. The location monument of this claim is situated with reference to some natural object or permanent monument as follows: The number 1 corner of this claim is located approximately 25,900 feet 55° W from the located SE corner of section 36, T18N, R52E, MDM.

The corners of this claim are marked by 4" x 4" x 5' posts or pipe with metal tags inscribed with the appropriate corner number as shown on the following sketch and the accompanying claim map.

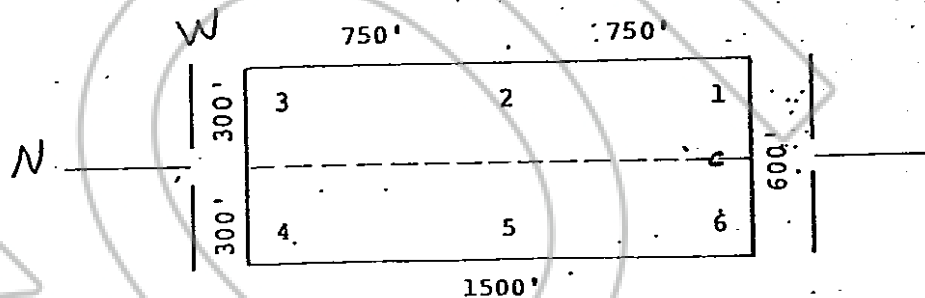

The location work consisted of making the map provided in NRS 517.04

Dated and posted on the ground this 24 day of November

RECORDED AT REQUEST OF
AMERICAN SELCO, INC.
BOOK 91 PAGE 463
FEB 13 10:55 AM
CLERK OF NEVADA

OFFICIAL RECORDS
EUREKA COUNTY, NEVADA
WILLIAM A. DEPAUL, RECORDER
FILE NO. 78911
FEE \$ 3.00

Locator:

AMERICAN SELCO, INC.

By Mike Perry
Agent for
AMERICAN SELCO, INC.

COUNTY OF _____

I hereby certify that the within instrument was filed and recorded at the request of: _____
FILE NO. _____
on _____
at _____
Docket _____ Page _____

Witness my hand and official seal the day and year aforesaid.

BOOK 91 PAGE 463

County Recorder

By _____

NOTICE IS HEREBY GIVEN that St. Pat No. 299 lode mining claim has been located by American Selco, a New York corporation, whose address 90 West Grove Street, Suite 100, Reno, Nevada 89509. This claim is a relocation of the St. Pat No. 299 lode mining claim, the certificate of location of which is of record in the office of the Recorder of Eureka County, Nevada in Book 88 Page 581, in accordance with NRS 517.080. The general course of this claim is North/South. This claim is 1500 feet in length along the course of the claim, being 1490 feet from the point of discovery in an North direction to the North end line of this claim, and 10 feet in a South direction to the South end line of the claim. This claim is 600 feet in width, being 300 feet in width on each side of the center line of the claim.

This claim is located within the NE Quarter of Section 19, Township 17 North, Range 52 East, Mount Diablo Base and Meridian, Eureka Mining District, Eureka County, Nevada. The location monument of this claim is situated with reference to some natural object or permanent monument as follows: The number one corner of this claim is located approximately 26,700 feet S 53°W from the SE corner of section 36, T18N, R52E, MDM.

The corners of this claim are marked by 4" x 4" x 5' posts or pipe with metal tags inscribed with the appropriate corner number as shown on the following sketch and the accompanying claim map.

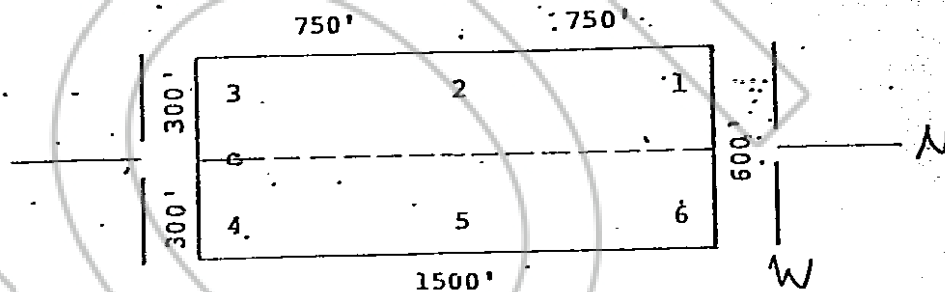

The location work consisted of making the map provided in NRS 517.0

Dated and posted on the ground this 27 day of January 1981.

RECORDED AT REQUEST OF
AMERICAN SELCO, INC.
BOOK 91 PAGE 469
FEB 13 AM 10:30
COUNTY OF NEVADA

OFFICIAL RECORDS
EUREKA COUNTY, NEVADA
WILLIS A. DEAN, RECORDER
FILE NO. 78912
FEES 3.00

Locator:

AMERICAN SELCO, INC.

By Mike P. Peig
Agent for
AMERICAN SELCO, INC.

I hereby certify that the within instrument was filed and recorded at the request of:

FILE NO. _____

on _____

at _____

Docket _____ Page _____

Witness my hand and official seal the day and year afore-said.

BOOK 91 PAGE 469

County Recorder

ny

NOTICE IS HEREBY GIVEN that St. Pat No. 300 lode mining claim has been located by American Selco, a New York corporation, whose address 90 West Grove Street, Suite 100, Reno, Nevada 89509. This claim is a relocation of the St. Pat No. 300 lode mining claim, the certificate of location of which is of record in the office of the Recorder of Eureka County, Nevada in Book 88 Page 582, in accordance with NRS 517.080. The general course of this claim is North/South. This claim is 1500 feet in length along the course of the claim, being 1490 feet from the point of discovery in an North direction to the North end line of this claim, and 10 feet in a South direction to the South end line of the claim. This claim is 600 feet in width, being 300 feet in width on each side of the center line of the claim.

This claim is located within the NE Quarter of Section 19, Township 17 North, Range 52 East, Mount Diablo Base and Meridian, Eureka Mining District, Eureka County, Nevada. The location monument of this claim is situated with reference to some natural object or permanent monument as follows: The number one corner of this claim is located approximately 26,900 feet S 53° W from the SE corner of section 36, T18N, R52E, MDM.

The corners of this claim are marked by 4" x 4" x 5' posts or pipe with metal tags inscribed with the appropriate corner number as shown on the following sketch and the accompanying claim map.

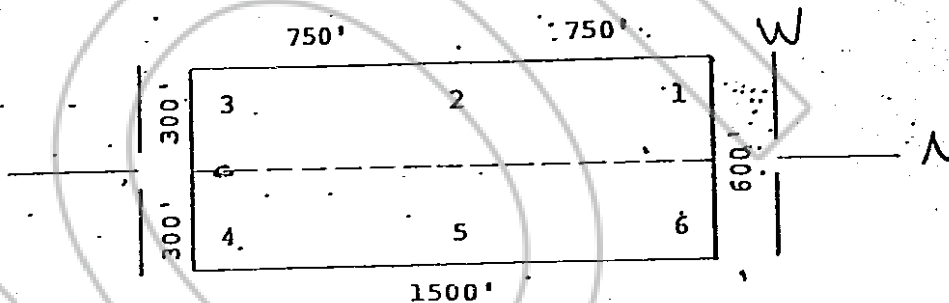

The location work consisted of making the map provided in NRS 517.0.

Dated and posted on the ground this 27 day of January

19

RECORDED AT REQUEST OF
AMERICAN SELCO, INC.
Book 91 Page 470

59

13

18

13

13

13

13

13

OFFICIAL RECORDS
EUREKA COUNTY, NEVADA
WILLIS A. DEAN, CLERK
FILE NO. 28913
FEE \$ 3.00

STATE OF NEVADA

COUNTY OF

ss.

I hereby certify that the within instrument was filed and recorded at the request of:

FILE NO.

on

at

Docket

Page

Locator:

AMERICAN SELCO, INC.

By

Agent for

AMERICAN SELCO, INC.

Witness my hand and official seal the day and year afore-said.

BOOK 91 PAGE 470

County Recorder

ny

NOTICE IS HEREBY GIVEN that St. Pat No. 301 lode mining claim has been located by American Selco, a New York corporation, whose address 90 West Grove Street, Suite 100, Reno, Nevada 89509. This claim is a relocation of the St. Pat No. 301 lode mining claim, the certificate of location of which is of record in the office of the Recorder of Eureka County, Nevada in Book 88 Page 583, in accordance with NRS 517.080. The general course of this claim is North/South. This claim is 1500 feet in length along the course of the claim, being 1490 feet from the point of discovery in an North direction to the North end line of this claim, and 10 feet in a South direction to the South end line of the claim. This claim is 600 feet in width, being 300 feet in width on each side of the center line of the claim.

This claim is located within the NW Quarter of Section 20, Township 17 North, Range 52 East, Mount Diablo Base and Meridian, Eureka Mining District, Eureka County, Nevada. The location monument of this claim is situated with reference to some natural object or permanent monument as follows: The number one corner of this claim is located approximately 25,900 feet S 51°W from the SE corner of section 36, T18N, R52E, MDM.

The corners of this claim are marked by 4" x 4" x 5' posts or pipe with metal tags inscribed with the appropriate corner number as shown on the following sketch and the accompanying claim map.

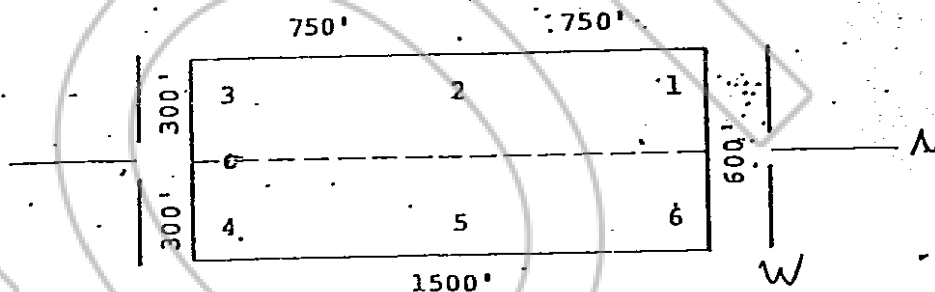

The location work consisted of making the map provided in NRS 517.0

Dated and posted on the ground this 27 day of January

RECORDED AT REQUEST OF
AMERICAN SELCO, INC.
BOOK 91 PAGE 471

8 FEB 13 10:58
ASSSEE

OFFICIAL RECORDS
EUREKA COUNTY, NEVADA
WILLIS A. DUNN, RECORDER
FILE NO. 78914
FEE \$ 3.00

STATE OF NEVADA

COUNTY OF _____

I hereby certify that the within instrument was filed and recorded at the request of: _____

FILE NO. _____

on _____

at _____

Docket _____

Page _____

Locator: _____

AMERICAN SELCO, INC.

By Mike Peiz

Agent for

AMERICAN SELCO, INC.

Witness my hand and official seal the day and year aforesaid.

BOOK 91 PAGE 471

County Recorder

ny

NOTICE IS HEREBY GIVEN that St. Pat No. 302 lode mining claim has been located by American Selco, a New York corporation, whose address 90 West Grove Street, Suite 100, Reno, Nevada 89509. This claim is a relocation of the St. Pat No. 302 lode mining claim, the certificate of location of which is of record in the office of the Recorder of Eureka County, Nevada in Book 88 Page 584, in accordance with NRS 517.080. The general course of this claim is North/South. This claim is 1500 feet in length along the course of the claim, being 1490 feet from the point of discovery in an North direction to the North end line of this claim, and 10 feet in a South direction to the South end line of the claim. This claim is 600 feet in width, being 300 feet in width on each side of the center line of the claim.

This claim is located within the NW Quarter of Section 20, Township 17 North, Range 52 East, Mount Diablo Base and Meridian, Eureka Mining District, Eureka County, Nevada. The location monument of this claim is situated with reference to some natural object or permanent monument as follows: The number one corner of this claim is located approximately 26,900 feet S 510W from the SE corner of section 36, T18N, R52E, MDM.

The corners of this claim are marked by 4" x 4" x 5' posts or pipe with metal tags inscribed with the appropriate corner number as shown on the following sketch and the accompanying claim map.

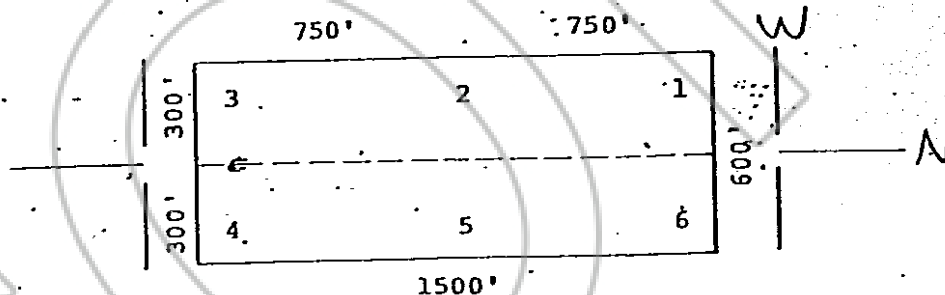

The location work consisted of making the map provided in NRS 517.0

Dated and posted on the ground this 27 day of January

1988

RECORDED AT REQUEST OF
WILLIAM A. DEBARTOLONE
BOOK 91 PAGE 473

11 FEB 13 A 10:50

OFFICIAL RECORDS
EUREKA COUNTY, NEVADA
WILLIAM A. DEBARTOLONE
RECORDER
FILE NO. 78915
FEE \$ 3.00

STATE OF NEVADA

COUNTY OF

ss.

I hereby certify that the within instrument was filed and recorded at the request of:

FILE NO.

on

at

Docket

Page

Locator:

AMERICAN SELCO, INC.

By

Agent for

AMERICAN SELCO, INC.

Witness my hand and official seal the day and year afore-said.

BOOK 91 PAGE 473

County Recorder

ry