

NOTICE IS HEREBY GIVEN that St. Pat No. 284 lode mining claim has been located by American Selco, a New York corporation, whose address 90 West Grove Street, Suite 100, Reno, Nevada 89509. This claim is a relocation of the St. Pat No. 284 lode mining claim, the certificate of location of which is of record in the office of the Recorder of Eureka County, Nevada in Book 88 Page 567, in accordance with NRS 517.080. The general course of this claim is North/South. This claim is 1500 feet in length along the course of the claim, being 1400 feet from the point of discovery in an North direction to the North end line of this claim, and 10 feet in a South direction to the South end line of the claim. This claim is 600 feet in width, being 300 feet in width on each side of the center line of the claim.

This claim is located within the SW Quarter of Section 17, Township 17 North, Range 52 East, Mount Diablo Base and Meridian, Eureka Mining District, Eureka County, Nevada. The location monument of this claim is situated with reference to some natural object or permanent monument as follows: The number 1 corner of this claim is located approximately 25,900 feet S 51° W from the located SE corner of section 36, T18N, R52E, MDM.

The corners of this claim are marked by 4" x 4" x 5' posts or pipe with metal tags inscribed with the appropriate corner number as shown on the following sketch and the accompanying claim map.

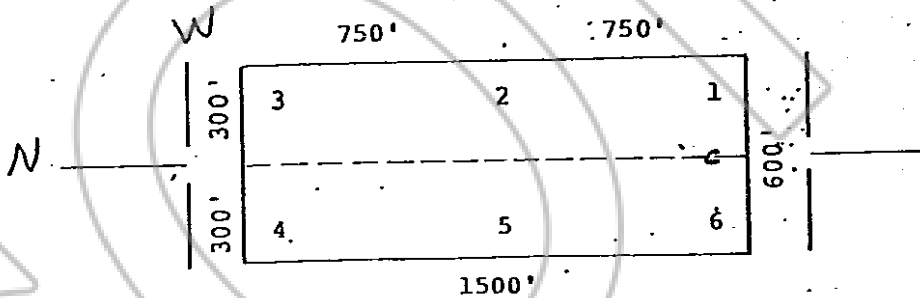

The location work consisted of making the map provided in NRS 517.080

Dated and posted on the ground this 24 day of November

RECORDED AT REQUEST OF  
 AMERICAN SELCO, INC.  
 BOOK 88 PAGE 567  
 FEB 13 10 10 AM '80  
 OFFICIAL RECORDS  
 EUREKA COUNTY, NEVADA  
 WILLIS A. DEPAUL RECORDER  
 FILE NO. 78911  
 FEE \$ 3.00

Locator:

AMERICAN SELCO, INC.

By Mike Perry  
 Agent for  
 AMERICAN SELCO, INC.

COUNTY OF \_\_\_\_\_ )  
 ) ss.

I hereby certify that the within instrument was filed and recorded at the request of: \_\_\_\_\_  
 FILE NO. \_\_\_\_\_  
 on \_\_\_\_\_  
 at \_\_\_\_\_  
 Docket \_\_\_\_\_ Page \_\_\_\_\_

Witness my hand and official seal the day and year aforesaid.

BOOK 91 PAGE 468

County Recorder

By \_\_\_\_\_