

STATE OF NEVADA
CERTIFICATE OF MINING LOCATION
LODE CLAIM ON PUBLIC DOMAIN

79158

NOTICE IS HEREBY GIVEN that the RIL No. 25
lode mining claim has been located by AMERICAN SELCO INC.
a New York corporation, whose address is 90 West Grove Street,
Suite 100, Reno, Nevada 89509. The general course of this claim
is Northeast & Southwest. This claim is 1500 feet in length
along the course of the claim, being 10 feet from the point
of discovery in a N50°E direction to the Northeast end
line of this claim, and 1490 feet in a S50°W
direction to the Southwest end line of the claim. This claim is
600 feet in width, being 300 feet in width on each side of the
center line of the claim.

This claim is located within the NE & NW & SE & SW Quarter
of Section 12, Township 19 North, Range 52
East, Mount Diablo Base and Meridian, unknown Mining District,
Eureka County, Nevada. The location monument of this claim is
situated with reference to some natural object or permanent monument
as follows: The number one corner of this claim is located approximately
3,525 feet N23°45'W from the located southwest corner of
section 7, T19N, R53E, MDM.

The corners of this claim are marked by 4"x4" posts or 4" trees
with metal tags inscribed with the appropriate corner number as
shown on the following sketch and the accompanying claim-map.

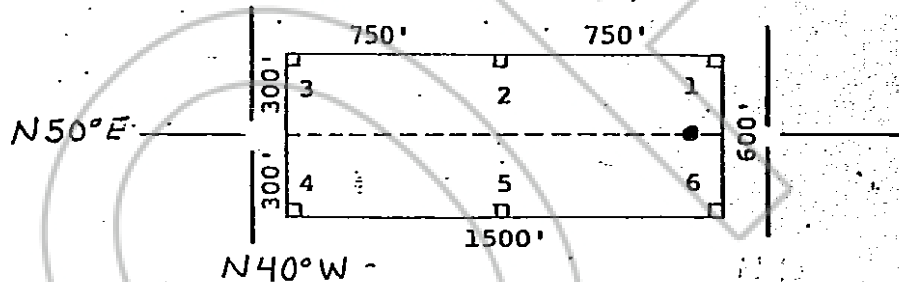

The location work consisted of making the maps as provided in
NRS 517.040.

Dated and posted on the ground this 16 day of January,
1981

Witnesses:

Locator:

AMERICAN SELCO INC.

By Mike Perig
Agent for
American Selco Inc.

RECORDED AT REQUEST OF
AMERICAN SELCO INC.

BOOK 92 PAGE 206

58

AIO: 58

81 MAR 11

STATE OF NEVADA

COUNTY OF

OFFICIAL RECORDS
EUREKA COUNTY, NEVADA
WILLIS A. DUFFOLI - RECORDER
FILE # 79158
FEE \$ 3.00

STATE OF NEVADA

COUNTY OF

ss.

I hereby certify that the within

instrument was filed and recorded at

the request of:

FILE NO.

on

at

Docket

Page

Witness my hand and official
seal the day and year aforesaid

County Recorder

BOOK 92 PAGE 206

Deputy Recorder