

STATE OF NEVADA
 CERTIFICATE OF MINING LOCATION
 LODE CLAIM ON PUBLIC DOMAIN

NOTICE IS HEREBY GIVEN that the RIL No. 33 lode mining claim has been located by AMERICAN SELCO INC., a New York corporation, whose address is 90 West Grove Street, Suite 100, Reno, Nevada 89509. The general course of this claim is Northwest & Southeast. This claim is 1500 feet in length along the course of the claim, being 1490 feet from the point of discovery in a N40°W direction to the Northwest end line of this claim, and 10 feet in a S40°E direction to the Southeast end line of the claim. This claim is 600 feet in width, being 300 feet in width on each side of the center line of the claim.

This claim is located within the 1 SE & NE Quarter of Section 13, Township 19 North, Range 52 East, Mount Diablo Base and Meridian, unknown Mining District, Eureka County, Nevada. The location monument of this claim is situated with reference to some natural object or permanent monument as follows: The number one corner of this claim is located approximately 3,600 feet S5°W from the located southwest corner of section 7, T19N, R53E, MDM.

The corners of this claim are marked by 4"x4" posts or 4" trees with metal tags inscribed with the appropriate corner number as shown on the following sketch and the accompanying claim map.

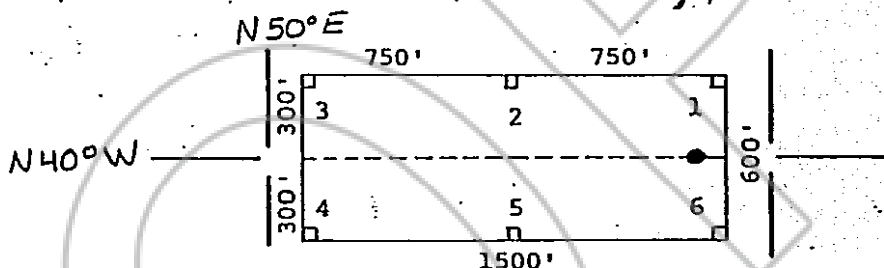

The location work consisted of making the maps as provided in NRS 517.040.

Dated and posted on the ground this 2 day of February, 1981

Witnesses:

Locator:

AMERICAN SELCO INC.

By Mike Perry
 Agent for
 American Selco Inc.

RECORDED AT REQUEST OF
 AMERICAN SELCO INC.

BOOK 92 PAGE 214

8 MAR 11 AM 10:59

STATE OF NEVADA

OFFICIAL RECORDS
 EUREKA COUNTY, NEVADA
 FILE NO. 79166
 FEE \$ 3.00

) ss.

COUNTY OF

I hereby certify that the within instrument was filed and recorded at the request of:

FILE NO. _____
 on _____
 at _____
 Docket _____ Page _____

Witness my hand and official seal the day and year aforesaid.

County Recorder

By Book 92 PAGE 214
 Deputy Recorder