

**CERTIFICATE OF MINING LOCATION
LODE CLAIM ON PUBLIC DOMAIN**

NOTICE IS HEREBY GIVEN that the RIL No. 36 lode mining claim has been located by AMERICAN SELCO INC., a New York corporation, whose address is 90 West Grove Street, Suite 100, Reno, Nevada 89509. The general course of this claim is Northwest & Southeast. This claim is 1500 feet in length along the course of the claim, being 10 feet from the point of discovery in a N40°W direction to the Northwest end line of this claim, and 1490 feet in a S40°E direction to the Southeast end line of the claim. This claim is 600 feet in width, being 300 feet in width on each side of the center line of the claim.

This claim is located within the SW/1/4 Quarter of Section 18/19, Township 19 North, Range 53 East, Mount Diablo Base and Meridian, unknown Mining District, Eureka County, Nevada. The location monument of this claim is situated with reference to some natural object or permanent monument as follows: The number one corner of this claim is located approximately 6,100 feet S 15° 25' E from the located southwest corner of section 7, T19N, R53E, MDM.

The corners of this claim are marked by 4"x4" posts or 4" trees with metal tags inscribed with the appropriate corner number as shown on the following sketch and the accompanying claim map.

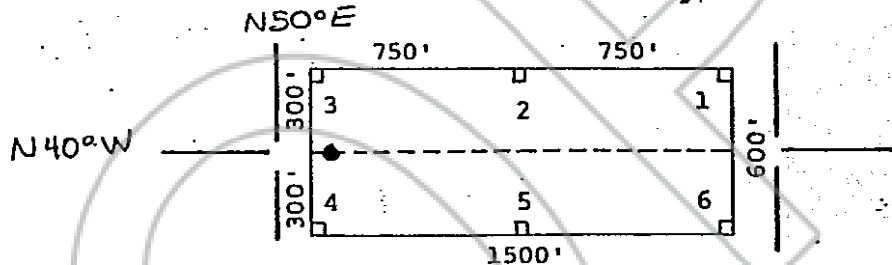

The location work consisted of making the maps as provided in NRS 517.040.

Dated and posted on the ground this 2 day of February, 1981

Witnesses:

Locator:

AMERICAN SELCO INC.

By Mike Perry
Agent for
American Selco Inc.

RECORDED AT REQUEST OF
AMERICAN SELCO INC.
BOOK 92 PAGE 277

81 MAR 11 AM 10:58

OFFICIAL RECORDS
EUREKA COUNTY, NEVADA
WILLIS A. DEPAULI-RECORDER
FILE NO. 79169
FEE \$3.20

STATE OF NEVADA

COUNTY OF

)

) ss.

)

I hereby certify that the within instrument was filed and recorded at the request of:

FILE NO. _____

on _____

at _____

Docket _____ Page _____

Witness my hand and official seal the day and year aforesaid.

County Recorder

BOOK 92 PAGE 217

By _____

Deputy Recorder