

3. This Lease (Short Form) is made upon the terms, covenants and conditions set forth in that certain Lease of February 25, 1981, by and between the said parties hereto, or their predecessors, covering the real property above described, which Lease is by this reference incorporated herein and made a part hereof in all respects as though the same were fully set forth herein.

4. This Lease and all its terms, conditions and stipulations shall extend to and be binding upon the heirs, executors, administrators, grantees, successors and assigns of the parties hereto.

IN WITNESS WHEREOF, the parties hereto have caused this Lease Agreement to be duly executed as of the date first hereinabove written.

ZEDA CORPORATION

By [Signature]
Title: President

and by [Signature]
Title: Vice President

Lessor

THE WESTERN PACIFIC RAILROAD COMPANY

By [Signature]
Senior Vice President

and by [Signature]
Secretary

Lessee

Approved as to Execution
[Signature]
General Attorney

Approved as to Form
[Signature]
General Attorney

ATTESTED
[Signature]

STATE OF NEVADA)
) : SS.
COUNTY OF WASHOE)

On this 10th day of March, 1981, before me, PAMELA GULLIHUR, a Notary Public in and for the County of Washoe, State of Nevada, residing therein, duly commissioned and sworn, personally appeared BART M. SCHOUWEILER and ROBERT L. SCHOUWEILER known to me to be the President and Vice President, respectively, of ZEDA CORPORATION, the corporation described in and that executed the within instrument, and they acknowledged to me that such corporation executed the same pursuant to its by-laws or a resolution of its Board of Directors.

IN WITNESS WHEREOF, I have hereunto set my hand and affixed my official seal at my office in the County of Washoe, the day and year in this certificate first above written.

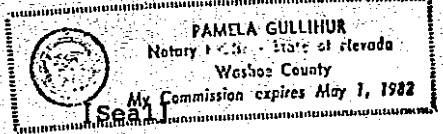

Pamela Gullihur
Notary Public

My Commission expires: 5/1/82.

STATE OF CALIFORNIA)
) : SS.
CITY AND COUNTY OF SAN FRANCISCO)

On this 20th day of March, 1981, before me, DIANE LORETTE FAFOUTIS, a Notary Public in and for the said City and County of San Francisco, State of California, residing therein, duly commissioned and sworn, personally appeared A. P. VICTORS and W. D. BREW, known to me to be the Senior Vice President and the Secretary, respectively, of THE WESTERN PACIFIC RAILROAD COMPANY the corporation described in and that executed the within instrument, and they acknowledged to me that such corporation executed the same pursuant to its by-laws or a resolution of its Board of Directors.

IN WITNESS WHEREOF, I have hereunto set my hand and affixed my official seal at my office in the City and County of San Francisco, the day and year in this certificate first above written.

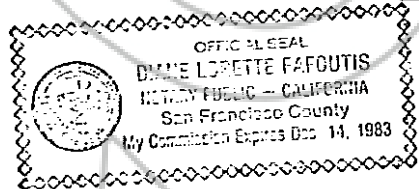

Diane Lorette Fafoutis
DIANE LORETTE FAFOUTIS
Notary Public

BOOK 93 PAGE 546

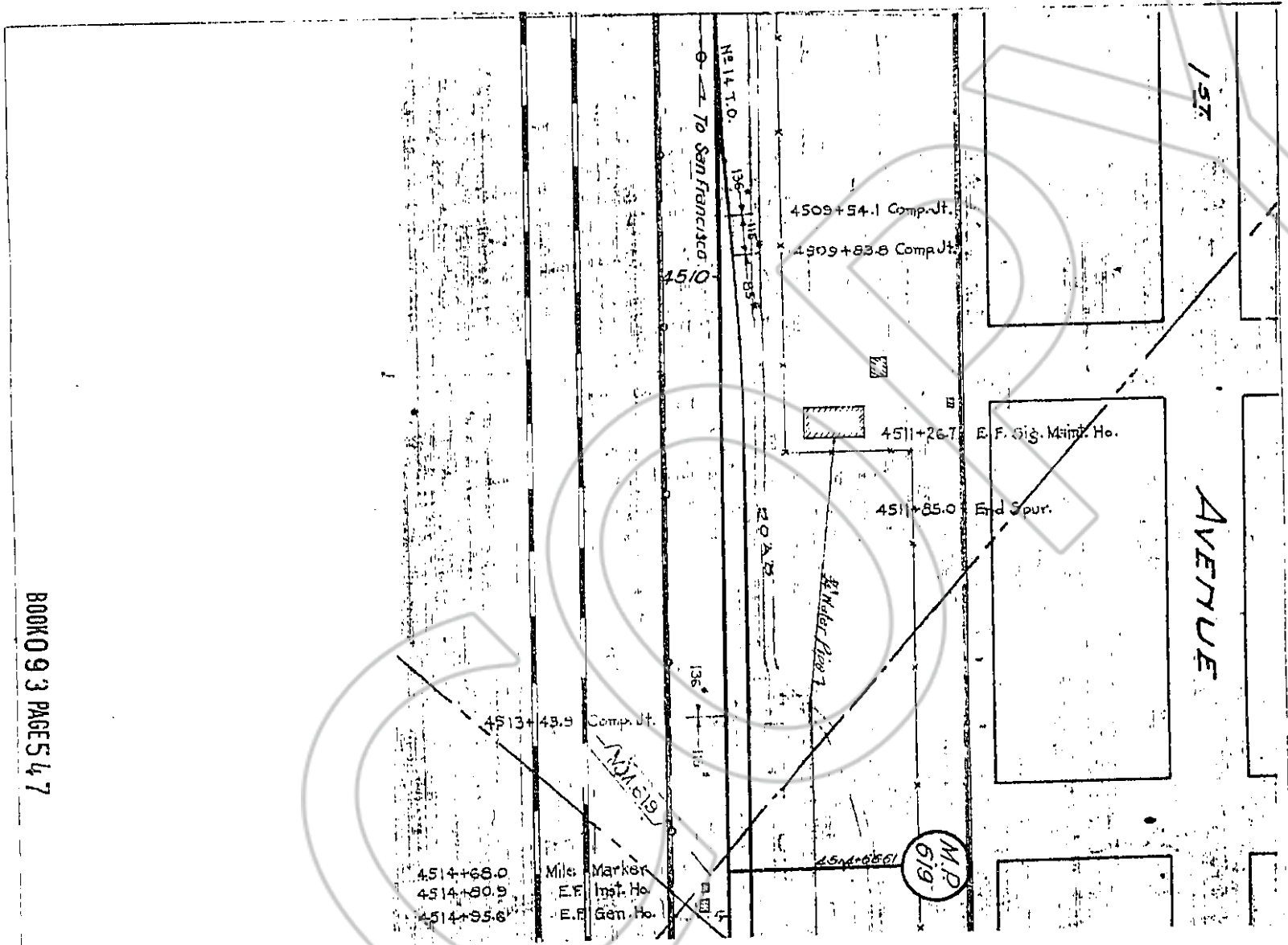



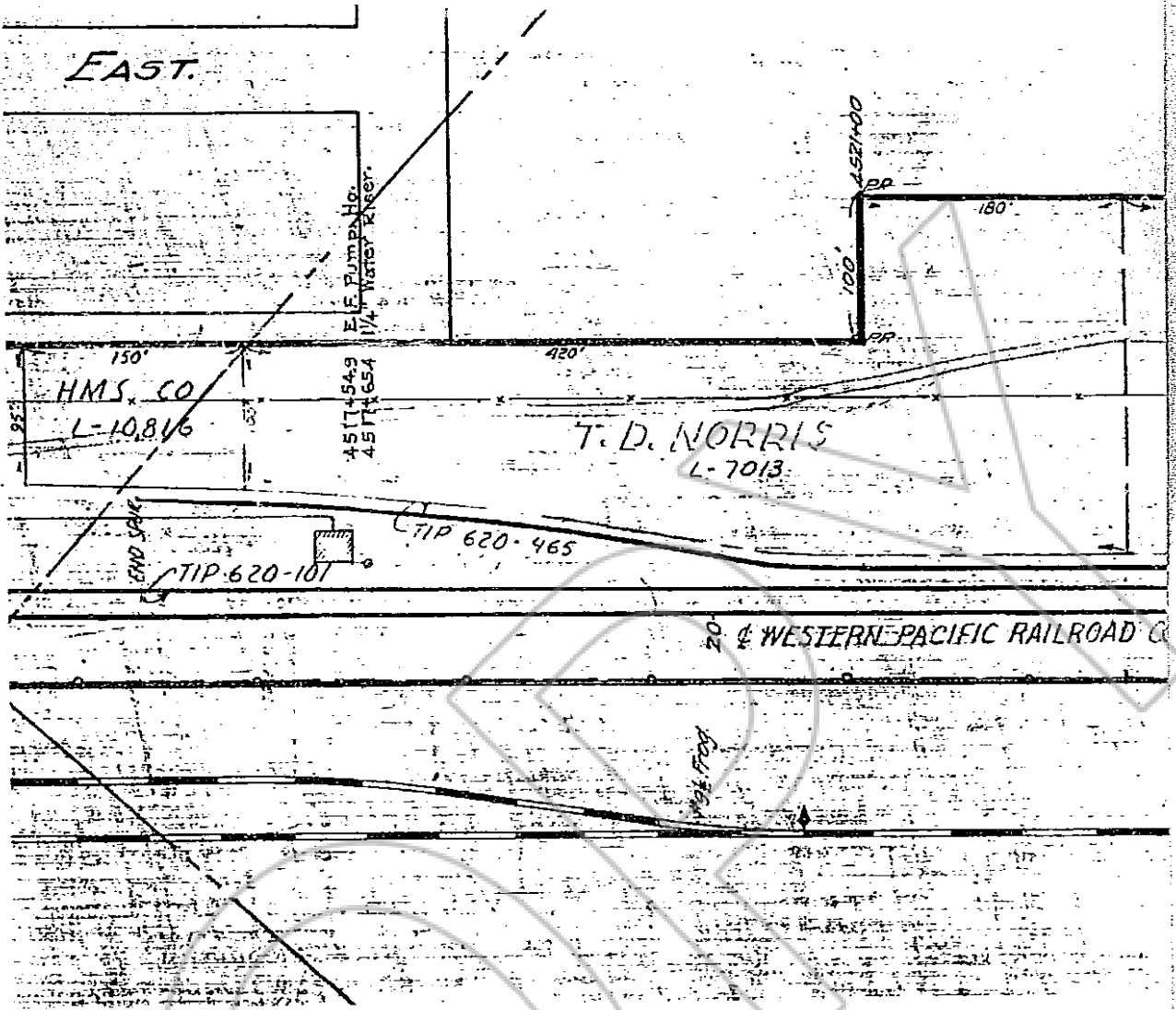

4514+68.0	Mile Marker
4514+60.9	E. F. Inst. Ho.
4514+55.0	E. F. Gen. Ho.

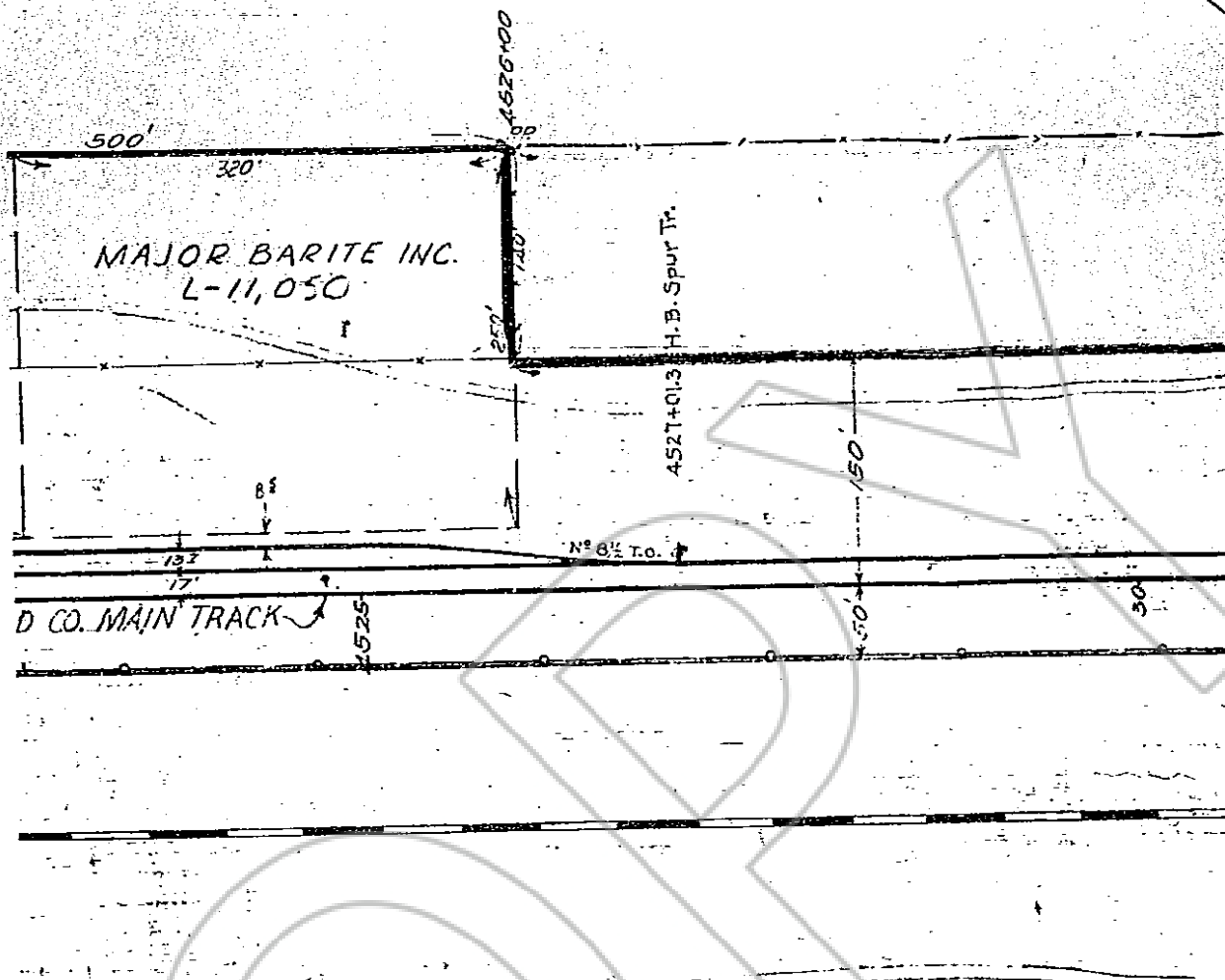
EAST.





~ Legend ~

-  Proposed Facilities
-  Facilities to be Relocated
-  Proposed Lease - 6.4 Ac ±
-  PROPOSED LEASE - HORSESHU RANCH T

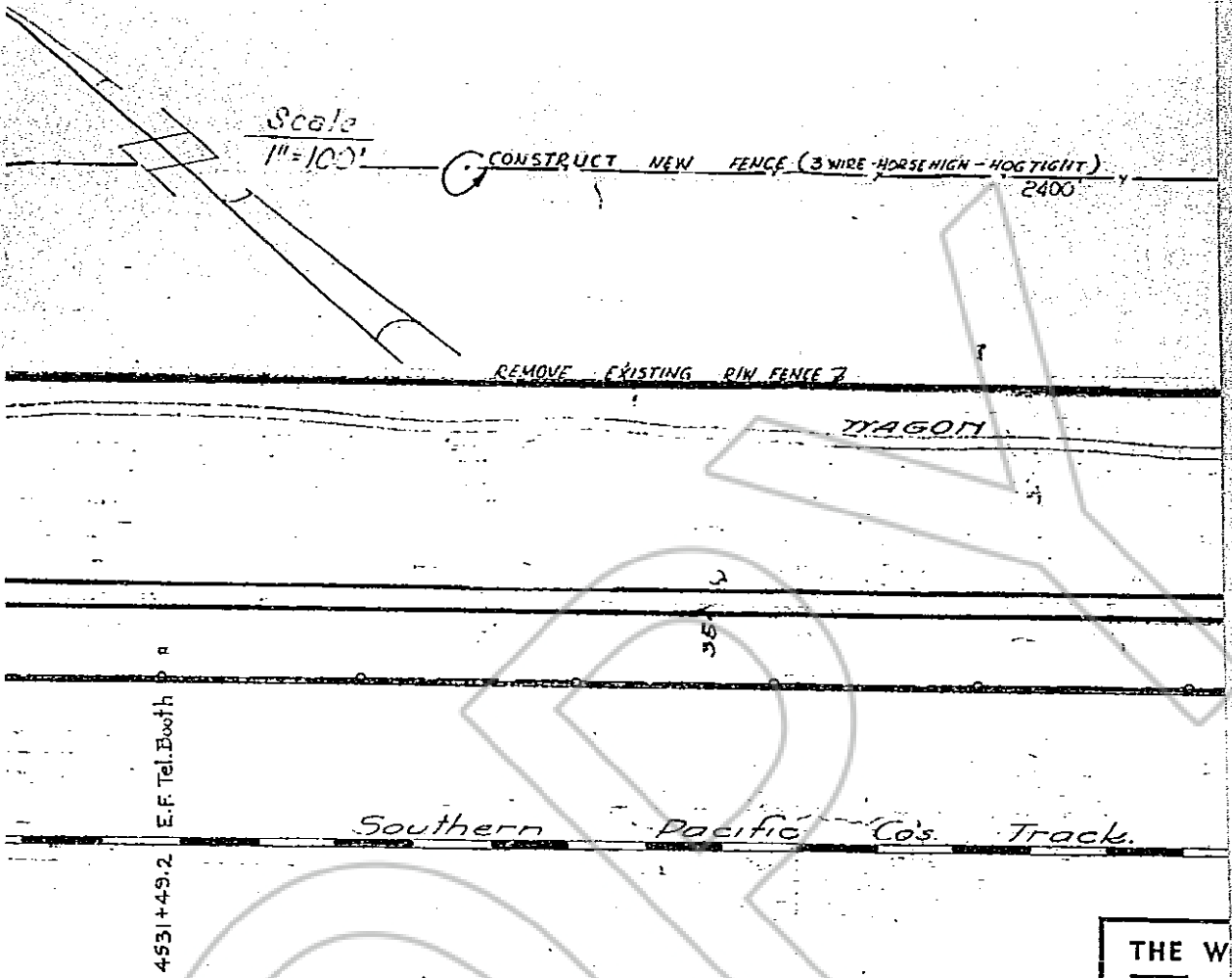

THE W
MISSION
526 MISSION S

TO WP 7.71 AC ±

LTR	DATE	DESCRIPTION	BY
B	1-14-81	REV'D TRACK	EFJ
A	11-24-80	EXTEND SPUR (1000'); ADD PROP. LEASE	ZBY

TABLE OF CHANGES
USE ONLY PRINTS SHOWING LATEST CHANGES

OFFICE O
DR: REF
CK:
DATE: 6-1-77
SCALE: 1"=100'

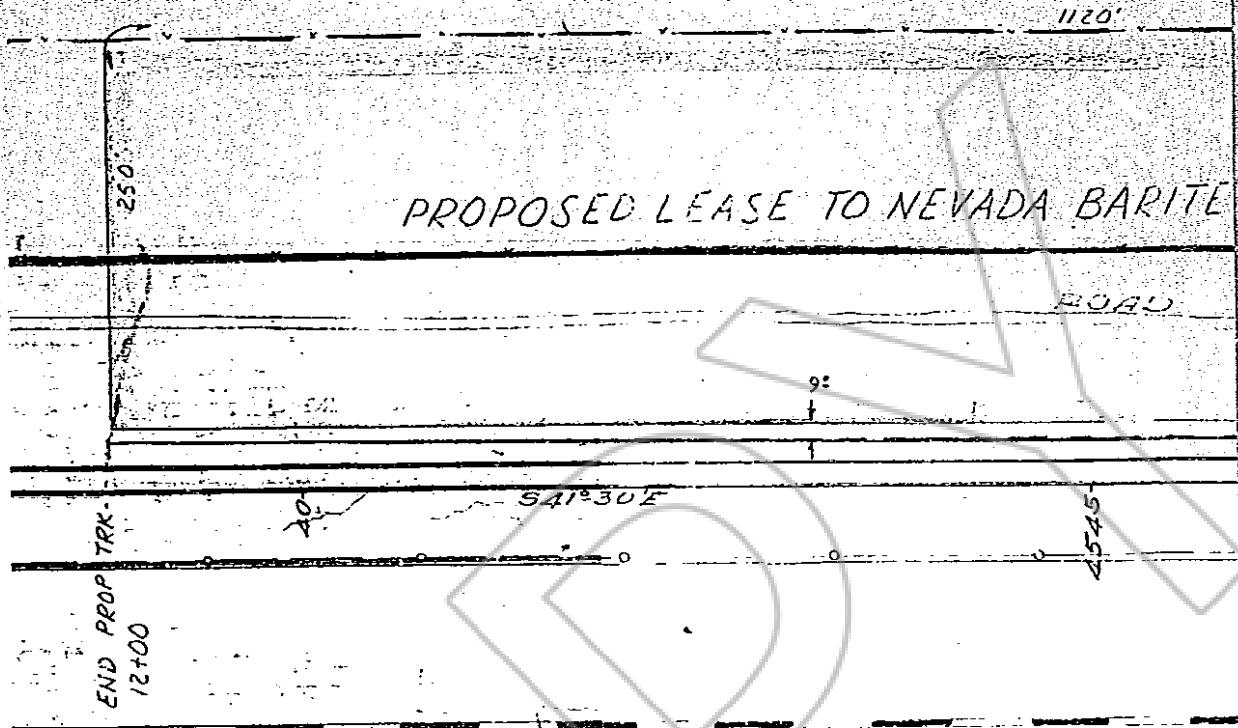

EXHIBIT "A"

WESTERN PACIFIC RAILROAD COMPANY
 SACRAMENTO NORTHERN RAILWAY
 TIDEWATER SOUTHERN RAILWAY CO.

ION STREET SAN FRANCISCO, CALIFORNIA 94105 TELEPHONE 982-2100



BEOVAWE

PROPOSED
 FACILITIES

CE OF CHIEF ENGINEER		SAN FRANCISCO	
APPROVED	LE	FILE NO.	
TITLE	Engineer - Design & Planning	SURVEY NO.	6960
DRAWING NO.	CE. 23-62	SHEET	CHANGE
		1 OF 2	B

TE - 6.4 AC ±

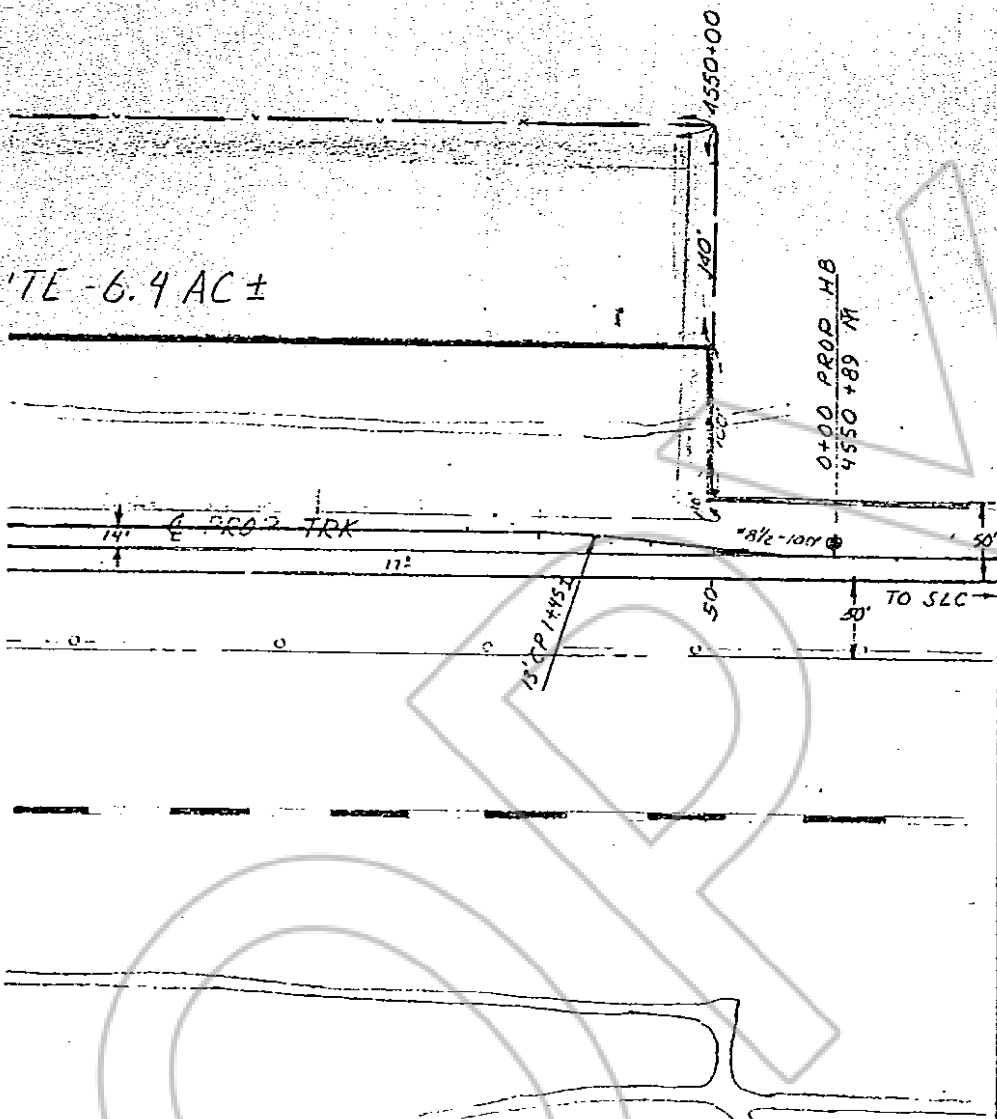

RECORDED AT REQUEST OF
Western Pacific Railroad Co.
 BOOK 93 PAGE 544-552

81 APR 3 AIO: 48

LOCAL RECORDS
 EUREKA COUNTY OFFICE
 NELLIS A. DI PAOLI - RECORDER
 FILE NO. 80048
 FEE \$ 11.00

55107