

R 51 E

T 32 N M.D.B. & M.

T 33 N M.D.B. & M.

R 51 E

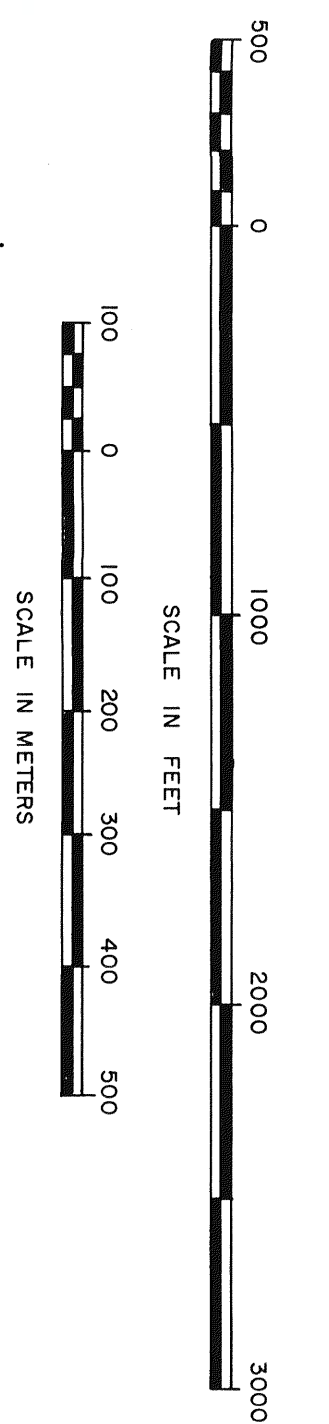
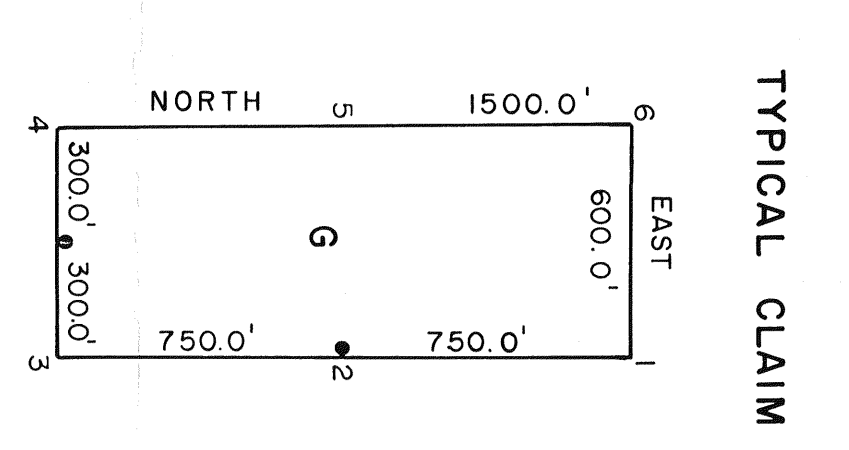

Field notes at the request of LABRIDEX CORP. by Mark J. ...

OWNER: LABRIDEX CORPORATION
 1280 TERMINAL WAY
 RENO, NEVADA 89502

NO'S 1-67
 EUREKA COUNTY, NEVADA

G-CLAIMS GROUP

50453