

NOTICE IS HEREBY GIVEN that the St. Pat No. 440 lode mining claim has been located by AMERICAN SELCO INCORPORATED, a New York corporation, whose address is 90 West Grove Street, Suite 100, Reno, Nevada 89509. The general course of this claim is North/South. This claim is 1500 feet in length along the course of the claim, being 1490 feet from the point of discovery in a North direction to the North end line of this claim, and 10 feet in a South direction to the South end line of the claim. This claim is 600 feet in width, being 300 feet in width on each side of the center line of the claim.

This claim is located all or in part in the following quarter section(s), township(s) and range(s):

SW 1/4, Section 1, T 17 N., R 51 E., M.D.B. & M.  
1/4, Section 1, T 17 N., R 51 E., M.D.B. & M.  
1/4, Section 1, T 17 N., R 51 E., M.D.B. & M.  
1/4, Section 1, T 17 N., R 51 E., M.D.B. & M.,

in Eureka Mining District, Eureka County, Nevada. The location monument of this claim is situated with reference to some natural object or permanent monument as follows: The number one corner of this claim lies approximately 4,275 feet N11°40'W from BM 6478 T17N, R51E, MDM

The corners of this claim are marked by 4" by 4" x 5' wood posts, 4" diameter x 5' plastic pipe, or 4" trees with metal tags inscribed with the appropriate corner number as shown on the following sketch and accompanying claim map(s).

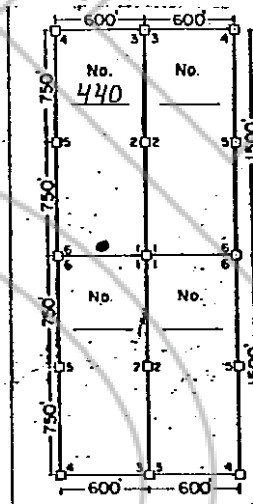

TRUE NORTH

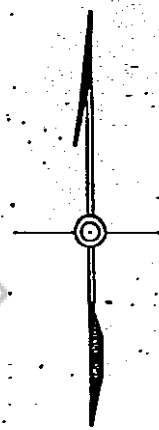

RECORDED AT REQUEST OF  
AMERICAN SELCO INC  
BOOK 95 PAGE 152

81 JUN 9 AM 11:17

OFFICIAL RECORDS  
EUREKA COUNTY, NEVADA  
WILLIAM J. BARNES, RECORDER  
FILE NO. 80539  
FEE \$ 3.00

The location work consisted of making the map(s) as provided in NRS 517.040.

Dated and posted on the ground this 30 day of March 1981.

Witnesses:

Locator:

By Mike Perry  
Agent for  
AMERICAN SELCO INCORPORATED

STATE OF NEVADA )  
COUNTY OF ) ss

I hereby certify that the within instrument was filed and recorded at the request of:

Witness my hand and official seal the day and year afore-said

FILE NO. \_\_\_\_\_  
on \_\_\_\_\_  
at \_\_\_\_\_  
Book \_\_\_\_\_ Page \_\_\_\_\_

County Recorder  
BOOK 95 PAGE 152  
By \_\_\_\_\_