

NOTICE IS HEREBY GIVEN that the St. Pat No. 576 lode mining claim has been located by AMERICAN SELCO INCORPORATED, a New York corporation, whose address is 90 West Grove Street, Suite 100, Reno, Nevada 89509. The general course of this claim is North/South. This claim is 1500 feet in length along the course of the claim, being 10 feet from the point of discovery in a North direction to the North end line of this claim, and 1490 feet in a South direction to the South end line of the claim. This claim is 600 feet in width, being 300 feet in width on each side of the center line of the claim.

This claim is located all or in part in the following quarter section(s), township(s) and range(s):

SE 1/4, Section 13, T 17 N., R 51 E., M.D.B. & M.
NE 1/4, Section 24, T 17 N., R 51 E., M.D.B. & M.
1/4, Section , T N., R E., M.D.B. & M.,

in Eureka Mining District, Eureka County, Nevada. The location monument of this claim is situated with reference to some natural object or permanent monument as follows: The number one corner of this claim lies approximately 8,100 feet S 10° 10' E from BM 6478 T17N, R51E, MDM

The corners of this claim are marked by 4" by 4" x 5' wood posts, 4" diameter x 5' plastic pipe, or 4" trees with metal tags inscribed with the appropriate corner number as shown on the following sketch and accompanying claim map(s).

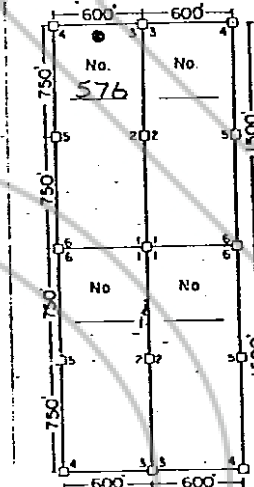

TRUE NORTH

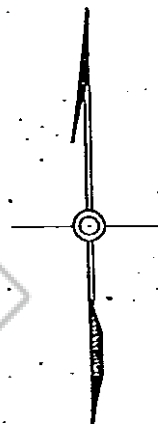

RECORDED AT REQUEST OF
AMERICAN SELCO INC.
BOOK 95 PAGE 289

81 JUN 9 AM 11:27

OFFICIAL RECORDS
EUREKA COUNTY, NEVADA
WILLIS A. DEVALO - RECORDER
FILE NO. 80676
FEE \$ 3.00

The location work consisted of making the map(s) as provided in NRS 517.040.

Dated and posted on the ground this 27 day of March 1981.

Witnesses:

Locator:

By

Mike Perry
Agent for
AMERICAN SELCO INCORPORATED

STATE OF NEVADA

COUNTY OF

I hereby certify that the within instrument was filed and recorded at the request of:

Witness my hand and official seal the day and year afore-said

FILE NO.

on

at

Book

Page

County Recorder

BOOK 95 PAGE 289

By