

81075

CERTIFICATE OF MINING LOCATION

LODE CLAIM ON PUBLIC DOMAIN

NOTICE IS HEREBY GIVEN that the St Pat No. 140 lode mining claim has been located by AMERICAN SELCO INCORPORATED a New York corporation, whose address is 90 West Grove Street, Suite 100, Reno, Nevada 89509. The claim is a relocation of the ST Pat No. 140 lode mining claim, the certificate of location of which is of record in the office of the Recorder of EUREKA County, Nevada in Book 88 Page 429 in accordance with NRS 517.080. The general course of this claim is NORTH / South. This claim is 1500 feet in length along the course of the claim, being 1490 feet from the point of discovery in a NORTH direction to the NORTH end line of this claim, and 10 feet in a South direction to the South end line of the claim. This claim is 600 feet in width, being 300 feet in width on each side of the center line of the claim.

This claim is located all or in part in the following quarter sections(s), township(s) and range(s):

NW 1/4, Section 4, T 17 N., R S2 E., M.D.B. & M.
1/4, Section _____, T _____ N., R _____ E., M.D.B. & M.
1/4, Section _____, T _____ N., R _____ E., M.D.B. & M.
1/4, Section _____, T _____ N., R _____ E., M.D.B. & M.
 in EUREKA Mining District, EUREKA County, Nevada. The location monument of this claim is situated with reference to some natural object or permanent monument as follows: Corner #1 of this claim is located Approximately 21.00 feet S86°W of the located SE CORNER of Section 26 T18N R S2 E MDM

The corners of this claim are marked by 4" by 4" x 5' wood posts, 4" diameter x 5' plastic pipe, or 4" trees with metal tags inscribed with the appropriate corner number as shown on the following sketch and accompanying claim map(s).

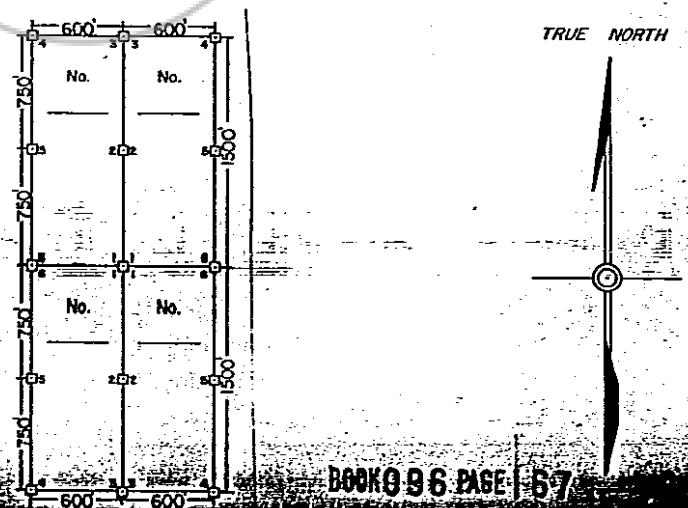

The location work consisted of making the map(s) as provided
in NRS 517.040.

Dated and posted on the ground this 11 day of June
1981.

Witnesses:

Locator:

By

Mike Perry
Agent for

AMERICAN SELCO INCORPORATED

STATE OF NEVADA)

) ss

COUNTY OF _____)

I hereby certify that the within
instrument was filed and recorded
at the request of: _____

Witness my hand and official
seal the day and year afore-
said

FILE NO. _____

on _____

at _____

Book _____

Page _____

County Recorder

By _____

Deputy Recorder

RECORDED AT REQUEST OF
AMERICAN SELCO INC
BOOK 96 FILE 161

81 JUL 27 10:35

OFFICIAL RECORDS
EUREKA COUNTY, NEVADA
WILLIS A. DEPAUL RECORDER
FILE NO. 8106
FEE \$ 5.00

BOOK 96 PAGE 161

NOTICE IS HEREBY GIVEN that the ST Pat No. 141 lode mining claim has been located by AMERICAN SELCO INCORPORATED a New York corporation, whose address is 90 West Grove Street, Suite 100, Reno, Nevada 89509. The claim is a relocation of the ST Pat No. 141 lode mining claim, the certificate of location of which is of record in the office of the Recorder of ELUREKA County, Nevada in Book 88 Page 430 in accordance with NRS 517.080. The general course of this claim is NORTH/SOUTH. This claim is 1500 feet in length along the course of the claim, being 1490 feet from the point of discovery in a NORTH direction to the NORTH end line of this claim, and 10 feet in a SOUTH direction to the SOUTH end line of the claim. This claim is 600 feet in width, being 300 feet in width on each side of the center line of the claim.

This claim is located all or in part in the following quarter sections(s), township(s) and range(s):

NW 1/4, Section 4, T 17 N., R 52 E., M.D.B. & M.
1/4, Section _____, T _____ N., R _____ E., M.D.B. & M.
1/4, Section _____, T _____ N., R _____ E., M.D.B. & M.
1/4, Section _____, T _____ N., R _____ E., M.D.B. & M.
 in ELUREKA Mining District, ELUREKA County,

Nevada. The location monument of this claim is situated with reference to some natural object or permanent monument as follows: CORNER #1 OF THIS CLAIM IS LOCATED APPROXIMATELY 19,900 FEET S 86 W OF THE LOCATED SE CORNER OF SECTION 36 T 18 N, R 52 E MOM.

The corners of this claim are marked by 4" by 4" x 5' wood posts, 4" diameter x 5' plastic pipe, or 4" trees with metal tags inscribed with the appropriate corner number as shown on the following sketch and accompanying claim map(s).

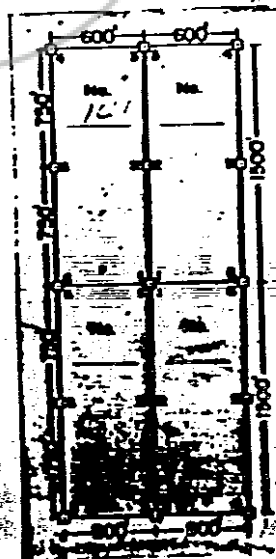

The location work consisted of making the map(s) as provided
in NRS 517.040.

Dated and posted on the ground this 11 day of June
1981.

Witnesses:

Locator:

By

M. L. Perry

Agent for

AMERICAN SELCO INCORPORATED

STATE OF NEVADA

)

) ss

COUNTY OF _____

)

I hereby certify that the within
instrument was filed and recorded
at the request of: _____

Witness my hand and official
seal the day and year afore-
said

FILE NO. _____

on _____

at _____

Book _____

Page _____

County Recorder

By _____

Deputy Recorder

RECORDED AT REQUEST OF
AMERICAN SELCO INC
BOOK 96 PAGE 169

81 JUL 27 AIO: 35

OFFICIAL RECORDS
EUREKA COUNTY, CALIFORNIA
WILLIS A. DEPAUL - RECORDER
FILE NO. 81076
FEE \$ 5.00

BOOK 96 PAGE 170

NOTICE IS HEREBY GIVEN that the ST. Pat No. 142 lode mining claim has been located by AMERICAN SELCO INCORPORATED a New York corporation, whose address is 90 West Grove Street, Suite 100, Reno, Nevada 89509. The claim is a relocation of the ST Pat No. 142 lode mining claim, the certificate of location of which is of record in the office of the Recorder of EUREKA County, Nevada in Book 88 Page 431 in accordance with NRS 517.080. The general course of this claim is NORTH/SOUTH. This claim is 1500 feet in length along the course of the claim, being 1490 feet from the point of discovery in a NORTH direction to the NORTH end line of this claim, and 10 feet in a SOUTH direction to the SOUTH end line of the claim. This claim is 600 feet in width, being 300 feet in width on each side of the center line of the claim.

This claim is located all or in part in the following quarter sections(s), township(s) and range(s):

NW 1/4, Section 4, T 17 N., R 52 E., M.D.B. & M.
1/4, Section _____, T _____ N., R _____ E., M.D.B. & M.
1/4, Section _____, T _____ N., R _____ E., M.D.B. & M.
1/4, Section _____, T _____ N., R _____ E., M.D.B. & M.

in EUREKA Mining District, EUREKA County, Nevada. The location monument of this claim is situated with reference to some natural object or permanent monument as follows: CORNER #1 OF THIS CLAIM IS LOCATED APPROXIMATE 19,900 FEET S66W OF THE LOCATED SE CORNER OF SECTION 36 T18N, R52E MDM.

The corners of this claim are marked by 4" by 4" x 5' wood posts, 4" diameter x 5' plastic pipe, or 4" trees with metal tags inscribed with the appropriate corner number as shown on the following sketch and accompanying claim map(s).

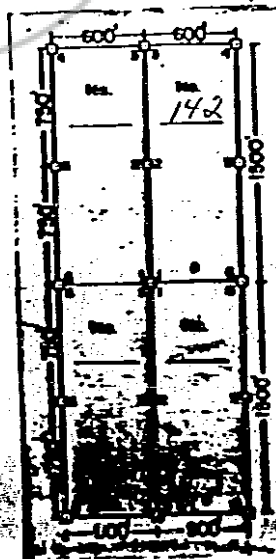

The location work consisted of making the map(s) as provided
in NRS 517.040.

Dated and posted on the ground this 11 day of June
19 81.

Witnesses:

Locator:

By

Mike Perry
Agent for

AMERICAN SELCO INCORPORATED

STATE OF NEVADA

)
) ss

COUNTY OF _____

I hereby certify that the within
instrument was filed and recorded
at the request of: _____

Witness my hand and official
seal the day and year afore-
said

FILE NO. _____

on _____

at _____

Book _____

Page _____

County Recorder

By _____

Deputy Recorder

RECORDED AT REQUEST OF
AMERICAN SELCO INC
BOOK 96 PAGE 177

81 JUL 27 AID: 35

OFFICIAL RECORDS
EUREKA COUNTY, NEVADA
WILLIS A. DEPUTY RECORDER
FILE NO. 81077
FEE \$ 5.00

BOOK 96 PAGE 172

NOTICE IS HEREBY GIVEN that the ST. Pat No. 143 lode mining claim has been located by AMERICAN SELCO INCORPORATED a New York corporation, whose address is 90 West Grove Street, Suite 100, Reno, Nevada 89509. The claim is a relocation of the ST. Pat No. 143 lode mining claim, the certificate of location of which is of record in the office of the Recorder of EUREKA County, Nevada in Book 88 Page 432 in accordance with NRS 517.080. The general course of this claim is NORTH/SOUTH. This claim is 1500 feet in length along the course of the claim, being 1490 feet from the point of discovery in a NORTH direction to the NORTH end line of this claim, and 10 feet in a SOUTH direction to the SOUTH end line of the claim. This claim is 600 feet in width, being 300 feet in width on each side of the center line of the claim.

This claim is located all or in part in the following quarter sections(s), township(s) and range(s):

NW 1/4, Section 4, T 17 N., R 52 E., M.D.B. & M.
1/4, Section _____, T _____ N., R _____ E., M.D.B. & M.
1/4, Section _____, T _____ N., R _____ E., M.D.B. & M.
1/4, Section _____, T _____ N., R _____ E., M.D.B. & M.

in EUREKA Mining District, EUREKA County, Nevada. The location monument of this claim is situated with reference to some natural object or permanent monument as follows: CORNER #1 OF THIS CLAIM IS LOCATED APPROXIMATE 18,200 FEET S85°W OF THE LOCATED SE CORNER OF SECTION 36 T18N, R52E MDM.

The corners of this claim are marked by 4" by 4" x 5' wood posts, 4" diameter x 5' plastic pipe, or 4" trees with metal tags inscribed with the appropriate corner number as shown on the following sketch and accompanying claim map(s).

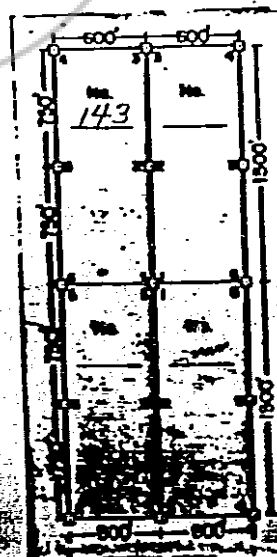

The location work consisted of making the map(s) as provided
in NRS 517:040.

Dated and posted on the ground this 11 day of June
19 81.

Witnesses:

Locator:

By

Mike Perry
Agent for

AMERICAN SELCO INCORPORATED

STATE OF NEVADA

)
)ss

COUNTY OF _____)

I hereby certify that the within
instrument was filed and recorded
at the request of: _____

Witness my hand and official
seal the day and year afore-
said

FILE NO. _____

on _____

at _____

Book _____

Page _____

County Recorder

By _____

Deputy Recorder

RECORDED AT REQUEST OF
AMERICAN SELCO INC
BOOK 96 PAGE 173

81 JUL 27 AID: 35

OFFICIAL RECORDS
EUREKA COUNTY, NEVADA
WILLIS A. DEPT. CLERK
FILE NO. 81078
FEE \$ 5.00

BOOK 96 PAGE 174

LODE CLAIM ON PUBLIC DOMAIN

NOTICE IS HEREBY GIVEN that the ST. Pat No. 144 lode mining claim has been located by AMERICAN SELCO INCORPORATED a New York corporation, whose address is 90 West Grove Street, Suite 100, Reno, Nevada 89509. The claim is a relocation of the ST. Pat No. 144 lode mining claim, the certificate of location of which is of record in the office of the Recorder of EUREKA County, Nevada in Book 88 Page 433 in accordance with NRS 517.080. The general course of this claim is NORTH/SOUTH. This claim is 1500 feet in length along the course of the claim, being 1490 feet from the point of discovery in a NORTH direction to the NORTH end line of this claim, and 10 feet in a SOUTH direction to the SOUTH end line of the claim. This claim is 600 feet in width, being 300 feet in width on each side of the center line of the claim.

This claim is located all or in part in the following quarter sections(s), township(s) and range(s):

NW 1/4, Section 4, T 17 N., R 52 E., M.D.B. & M.

NE 1/4, Section 4, T 17 N., R 52 E., M.D.B. & M.

1/4, Section , T N., R E., M.D.B. & M.

1/4, Section , T N., R E., M.D.B. & M.

in EUREKA Mining District, EUREKA County,

Nevada. The location monument of this claim is situated with reference to some natural object or permanent monument as follows:

CORNER #1 OF THIS CLAIM IS LOCATED APPROXIMATELY 10,700 FEET S85°W1 OF THE LOCATED SE CORNER OF SECTION 36 T18N, R52E MDM.

The corners of this claim are marked by 4" by 4" x 5' wood posts, 4" diameter x 5' plastic pipe, or 4" trees with metal tags inscribed with the appropriate corner number as shown on the following sketch and accompanying claim map(s).

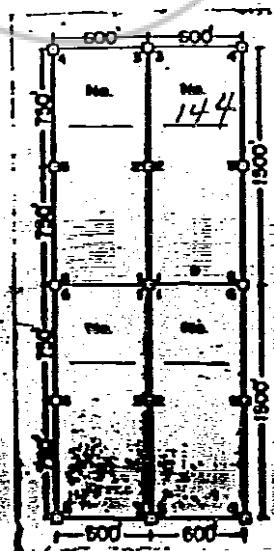

The location work consisted of making the map(s) as provided
in NRS 517.040.

Dated and posted on the ground this 11 day of June
19 91.

Witnesses:

Locator:

By

Mike Perry
Agent for

AMERICAN SELCO INCORPORATED

STATE OF NEVADA

)
) ss

COUNTY OF _____

I hereby certify that the within
instrument was filed and recorded
at the request of: _____

Witness my hand and official
seal the day and year afore-
said

FILE NO. _____

on _____

at _____

Book _____

Page _____

County Recorder

By _____

Deputy Recorder

RECORDED AT REQUEST OF
AMERICAN SELCO INC
BOOK 96 PAGE 175

81 JUL 27 A10:35

OFFICIAL RECORDS
EUREKA COUNTY, NEVADA
WILLIS A. DEPAULI, RECORDER
FILE NO. 81073
FEE \$ 5.00

BOOK 96 PAGE 176

81080 CERTIFICATE OF MINING LOCATION
LODE CLAIM ON PUBLIC DOMAIN

NOTICE IS HEREBY GIVEN that the ST Pat No. 145 lode mining claim has been located by AMERICAN SELCO INCORPORATED a New York corporation, whose address is 90 West Grove Street, Suite 100, Reno, Nevada 89509. The claim is a relocation of the ST Pat No. 145 lode mining claim, the certificate of location of which is of record in the office of the Recorder of EUREKA County, Nevada in Book 88 Page 434 in accordance with NRS 517.080. The general course of this claim is NORTH/SOUTH. This claim is 1500 feet in length along the course of the claim, being 1490 feet from the point of discovery in a NORTH direction to the NORTH end line of this claim, and 10 feet in a SOUTH direction to the SOUTH end line of the claim. This claim is 600 feet in width, being 300 feet in width on each side of the center line of the claim.

This claim is located all or in part in the following quarter sections(s), township(s) and range(s):

NE 1/4, Section 4, T 17 N., R 52 E., M.D.B. & M.
1/4, Section _____, T _____ N., R _____ E., M.D.B. & M.
1/4, Section _____, T _____ N., R _____ E., M.D.B. & M.
1/4, Section _____, T _____ N., R _____ E., M.D.B. & M.

in EUREKA Mining District, EUREKA County, Nevada. The location monument of this claim is situated with reference to some natural object or permanent monument as follows:

CORNER #1 OF THIS CLAIM IS LOCATED APPROXIMATE 12,500 FEET S85°W OF THE LOCATED SE CORNER OF SECTION 36 T18N, R52E MDM.

The corners of this claim are marked by 4" by 4" x 5' wood posts, 4" diameter x 5' plastic pipe, or 4" trees with metal tags inscribed with the appropriate corner number as shown on the following sketch and accompanying claim map(s).

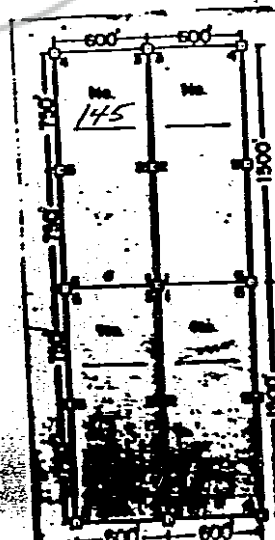

BOOK 96 PAGE 177

The location work consisted of making the map(s) as provided
in NRS 517.040.

Dated and posted on the ground this 11 day of June
19 81.

Witnesses:

Locator:

By

Mila Perry
Agent for

AMERICAN SELCO INCORPORATED

STATE OF NEVADA)

) ss

COUNTY OF _____)

I hereby certify that the within
instrument was filed and recorded
at the request of: _____

Witness my hand and official
seal the day and year afore-
said

FILE NO. _____

on _____

at _____

Book _____ Page _____

County Recorder

By _____

Deputy Recorder

RECORDED AT REQUEST OF
AMERICAN SELCO INC
BOOK 96 PAGE 177

81 JUL 27 A10:35

OFFICIAL RECORDS
EUREKA COUNTY, NEVADA
WILLIS A. DEPAUL - RECORDER
FILE NO. 81080
FEE \$ 5.00

BOOK 96 PAGE 177

CERTIFICATE OF MINING LOCATION

81081

LODE CLAIM ON PUBLIC DOMAIN

NOTICE IS HEREBY GIVEN that the ST Pat No. 146 lode mining claim has been located by AMERICAN SELCO INCORPORATED a New York corporation, whose address is 90 West Grove Street, Suite 100, Reno, Nevada 89509. The claim is a relocation of the ST Pat No. 146 lode mining claim, the certificate of location of which is of record in the office of the Recorder of EUREKA County, Nevada in Book 88 Page 435 in accordance with NRS 517.080. The general course of this claim is NORTH/SOUTH. This claim is 1500 feet in length along the course of the claim, being 1490 feet from the point of discovery in a NORTH direction to the NORTH end line of this claim, and 10 feet in a SOUTH direction to the SOUTH end line of the claim. This claim is 600 feet in width, being 300 feet in width on each side of the center line of the claim.

This claim is located all or in part in the following quarter sections(s), township(s) and range(s):

NE 1/4, Section 4, T 17 N., R 52 E., M.D.B. & M.
1/4, Section _____, T _____ N., R _____ E., M.D.B. & M.
1/4, Section _____, T _____ N., R _____ E., M.D.B. & M.
1/4, Section _____, T _____ N., R _____ E., M.D.B. & M.

in EUREKA Mining District, EUREKA County, Nevada. The location monument of this claim is situated with reference to some natural object or permanent monument as follows: CORNER #1 OF THIS CLAIM IS LOCATED APPROXIMATE 12,500 FEET S85°W OF THE LOCATED SE CORNER OF SECTION 36 T18N, R52E MDM.

The corners of this claim are marked by 4" by 4" x 5' wood posts, 4" diameter x 5' plastic pipe, or 4" trees with metal tags inscribed with the appropriate corner number as shown on the following sketch and accompanying claim map(s).

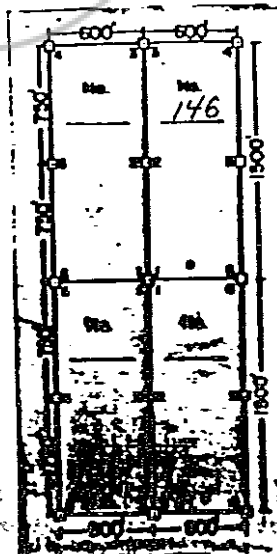

BOOK 86 PAGE 179

The location work consisted of making the map(s) as provided
in NRS 517.040.

Dated and posted on the ground this 11 day of June
19 81.

Witnesses:

Locator:

By

M. L. Perry
Agent for

AMERICAN SELCO INCORPORATED

STATE OF NEVADA)

) ss

COUNTY OF _____)

I hereby certify that the within
instrument was filed and recorded
at the request of: _____

Witness my hand and official
seal the day and year afore-
said

FILE NO. _____

on _____

at _____

Book _____ Page _____

County Recorder

By _____

Deputy Recorder

RECORDED AT REQUEST OF
AMERICAN SELCO INC
BOOK 96 PAGE 179

81 JUL 27 A10:35

OFFICIAL RECORDS
EUREKA COUNTY, NEVADA
WILLIS A. DePAOLI - RECORDER
FILE NO. 81081
FEE \$ 5.00

NOTICE IS HEREBY GIVEN that the ST Pat No. 147 lode mining claim has been located by AMERICAN SELCO INCORPORATED a New York corporation, whose address is 90 West Grove Street, Suite 100, Reno, Nevada 89509. The claim is a relocation of the ST Pat No. 147 lode mining claim, the certificate of location of which is of record in the office of the Recorder of EUREKA County, Nevada in Book 88 Page 436 in accordance with NRS 517.080. The general course of this claim is NORTH/SOUTH. This claim is 1500 feet in length along the course of the claim, being 1490 feet from the point of discovery in a NORTH direction to the NORTH end line of this claim, and 10 feet in a SOUTH direction to the SOUTH end line of the claim. This claim is 600 feet in width, being 300 feet in width on each side of the center line of the claim.

This claim is located all or in part in the following quarter sections(s), township(s) and range(s):

NE 1/4, Section 4, T 17 N., R 52 E., M.D.B. & M.
1/4, Section _____, T _____ N., R _____ E., M.D.B. & M.
1/4, Section _____, T _____ N., R _____ E., M.D.B. & M.
1/4, Section _____, T _____ N., R _____ E., M.D.B. & M.

in EUREKA Mining District, EUREKA County, Nevada. The location monument of this claim is situated with reference to some natural object or permanent monument as follows: CORNER #1 OF THIS CLAIM IS LOCATED APPROXIMATE 16,300 FEET S85°W OF THE LOCATED SE CORNER OF SECTION 36 T18N, R52E MDM.

The corners of this claim are marked by 4" by 4" x 5' wood posts, 4" diameter x 5' plastic pipe, or 4" trees with metal tags inscribed with the appropriate corner number as shown on the following sketch and accompanying claim map(s).

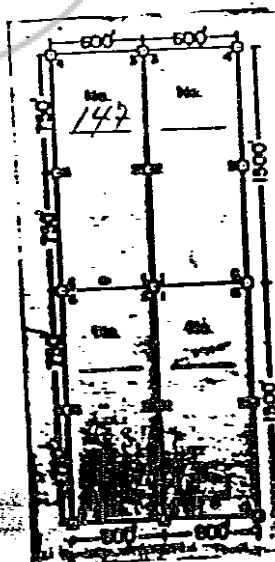

The location work consisted of making the map(s) as provided in NRS 517.040.

Dated and posted on the ground this 11 day of June 19 81.

Witnesses:

Locator:

By M. L. Perry
Agent for

AMERICAN SELCO INCORPORATED

STATE OF NEVADA

)

) ss

COUNTY OF _____)

I hereby certify that the within instrument was filed and recorded at the request of: _____

Witness my hand and official seal the day and year afore-said

FILE NO. _____

on _____

at _____

Book _____ Page _____

County Recorder

By _____

Deputy Recorder

RECORDED AT REQUEST OF
AMERICAN SELCO INC
BOOK 96 PAGE 181

81 JUL 27 AIO: 35

OFFICE OF THE COUNTY CLERK
CLERK OF COUNTY OF NEVADA
WALLIS A. DEFRASCO - RECORDER
FILE NO. 81082
FEE \$ 5.00

BOOK 96 PAGE 182

NOTICE IS HEREBY GIVEN that the ST. Pat No. 148 lode mining claim has been located by AMERICAN SELCO INCORPORATED a New York corporation, whose address is 90 West Grove Street, Suite 100, Reno, Nevada 89509. The claim is a relocation of the ST Pat No. 148 lode mining claim, the certificate of location of which is of record in the office of the Recorder of EUREKA County, Nevada in Book 88 Page 437 in accordance with NRS 517.080. The general course of this claim is NORTH/SOUTH. This claim is 1500 feet in length along the course of the claim, being 1490 feet from the point of discovery in a NORTH direction to the NORTH end line of this claim, and 10 feet in a SOUTH direction to the SOUTH end line of the claim. This claim is 600 feet in width, being 300 feet in width on each side of the center line of the claim.

This claim is located all or in part in the following quarter sections(s), township(s) and range(s):

NE 1/4, Section 4, T 17 N., R 52 E., M.D.B. & M.
NW 1/4, Section 3, T 17 N., R 52 E., M.D.B. & M.
1/4, Section _____, T _____ N., R _____ E., M.D.B. & M.
1/4, Section _____, T _____ N., R _____ E., M.D.B. & M.

in EUREKA Mining District, EUREKA County, Nevada. The location monument of this claim is situated with reference to some natural object or permanent monument as follows: CORNER #1 OF THIS CLAIM IS LOCATED APPROXIMATE 16,300 FEET S25°W OF THE LOCATED SE CORNER OF SECTION 36 T18N, R52E MDM.

The corners of this claim are marked by 4" by 4" x 5' wood posts, 4" diameter x 5' plastic pipe, or 4" trees with metal tags inscribed with the appropriate corner number as shown on the following sketch and accompanying claim map(s).

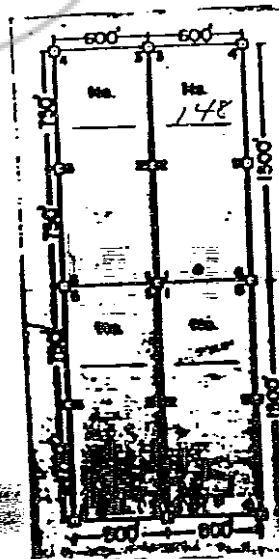

The location work consisted of making the map(s) as provided in NRS 517.040.

Dated and posted on the ground this 11 day of June 19 81.

Witnesses:

Locator:

By

Mike Perry
Agent for

AMERICAN SELCO INCORPORATED

STATE OF NEVADA)

) ss

COUNTY OF _____)

I hereby certify that the within instrument was filed and recorded at the request of: _____

Witness my hand and official seal the day and year aforesaid

FILE NO. _____

on _____

at _____

Book _____

Page _____

County Recorder

By _____

Deputy Recorder

RECORDED AT REQUEST OF
AMERICAN SELCO INC
BOOK 96 PAGE 183

61 JUL 27 A10:35

OFFICIAL RECORDS
CLERK COUNTY CLERK
WILLIS A. DEPAULI-RECORDER
FILE NO. 81083
FEE \$ 5.00

BOOK 96 PAGE 184

81084

LODE CLAIM ON PUBLIC DOMAIN

NOTICE IS HEREBY GIVEN that the ST. Pat No. 149 lode mining claim has been located by AMERICAN SELCO INCORPORATED a New York corporation, whose address is 90 West Grove Street, Suite 100, Reno, Nevada 89509. The claim is a relocation of the ST Pat No. 149 lode mining claim, the certificate of location of which is of record in the office of the Recorder of EUREKA County, Nevada in Book 88 Page 438 in accordance with NRS 517.080. The general course of this claim is NORTH/SOUTH. This claim is 1500 feet in length along the course of the claim, being 1490 feet from the point of discovery in a NORTH direction to the NORTH end line of this claim, and 10 feet in a SOUTH direction to the SOUTH end line of the claim. This claim is 600 feet in width, being 300 feet in width on each side of the center line of the claim.

This claim is located all or in part in the following quarter sections(s), township(s) and range(s):

NW 1/4, Section 3, T 17 N., R 52 E., M.D.B. & M.
1/4, Section , T N., R E., M.D.B. & M.
1/4, Section , T N., R E., M.D.B. & M.
1/4, Section , T N., R E., M.D.B. & M.

in EUREKA Mining District, EUREKA County, Nevada. The location monument of this claim is situated with reference to some natural object or permanent monument as follows: CORNER #1 OF THIS CLAIM IS LOCATED APPROXIMATELY 15,100 FEET S84 1/2° W OF THE LOCATED SE CORNER OF SECTION 36 T18N, R52E MDM.

The corners of this claim are marked by 4" by 4" x 5' wood posts, 4" diameter x 5' plastic pipe, or 4" trees with metal tags inscribed with the appropriate corner number as shown on the following sketch and accompanying claim map(s).

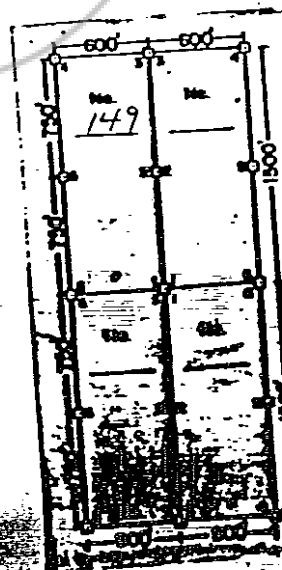

The location work consisted of making the map(s) as provided
in NRS 517.040.

Dated and posted on the ground this 11 day of June
19 81.

Witnesses:

Locator:

By

Milo Perry
Agent for

AMERICAN SELCO INCORPORATED

STATE OF NEVADA)

) ss

COUNTY OF _____)

I hereby certify that the within
instrument was filed and recorded
at the request of: _____

Witness my hand and official
seal the day and year afore-
said

FILE NO. _____

on _____

at _____

Book _____ Page _____

County Recorder

By _____

Deputy Recorder

RECORDED AT REQUEST OF
AMERICAN SELCO INC
BOOK 96 PAGE 185

21 JUL 27 A10:35

RECORDS
CLERK OF COUNTY CLERK
WILLIS A. DEPAULI-RECORDER
FILE NO. 81084
FILE \$ 5.00

BOOK 96 PAGE 186

81085 CERTIFICATE OF MINING LOCATION
LODE CLAIM ON PUBLIC DOMAIN

NOTICE IS HEREBY GIVEN that the ST Pat No. 150 lode mining claim has been located by AMERICAN SELCO INCORPORATED a New York corporation, whose address is 90 West Grove Street, Suite 100, Reno, Nevada 89509. The claim is a relocation of the ST Pat No. 150 lode mining claim, the certificate of location of which is of record in the office of the Recorder of EUREKA County, Nevada in Book 88 Page 439 in accordance with NRS 517.080. The general course of this claim is NORTH/SOUTH. This claim is 1500 feet in length along the course of the claim, being 1490 feet from the point of discovery in a NORTH direction to the NORTH end line of this claim, and 10 feet in a SOUTH direction to the SOUTH end line of the claim. This claim is 600 feet in width, being 300 feet in width on each side of the center line of the claim.

This claim is located all or in part in the following quarter sections(s), township(s) and range(s):

NW 1/4, Section 3, T 17 N., R 52 E., M.D.B. & M.
1/4, Section , T N., R E., M.D.B. & M.
1/4, Section , T N., R E., M.D.B. & M.
1/4, Section , T N., R E., M.D.B. & M.
in EUREKA Mining District, EUREKA County,

Nevada. The location monument of this claim is situated with reference to some natural object or permanent monument as follows: CORNER #1 OF THIS CLAIM IS LOCATED APPROXIMATE 15,100 FEET S84°W OF THE LOCATED SE CORNER OF SECTION 36 T18N, R52E MDM.

The corners of this claim are marked by 4" by 4" x 5' wood posts, 4" diameter x 5' plastic pipe, or 4" trees with metal tags inscribed with the appropriate corner number as shown on the following sketch and accompanying claim map(s).

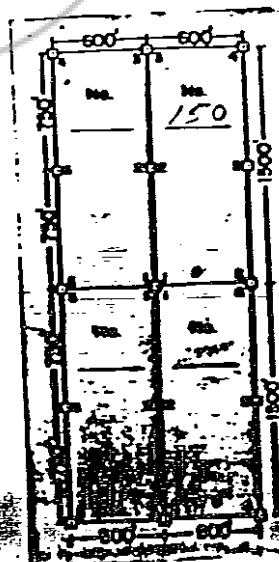

The location work consisted of making the map(s) as provided in NRS 517.040.

Dated and posted on the ground this 11 day of June 19 81.

Witnesses:

Locator:

By

Mile Perry
Agent for

AMERICAN SELCO INCORPORATED

STATE OF NEVADA)

) ss

COUNTY OF _____)

I hereby certify that the within instrument was filed and recorded at the request of: _____

Witness my hand and official seal the day and year afore-said

FILE NO. _____
on _____
at _____
Book _____ Page _____

County Recorder

By _____
Deputy Recorder

RECORDED AT REQUEST OF
AMERICAN SELCO INC
BOOK 96 PAGE 187

61 JUL 27 A10:35

OFFICE OF THE CLERK
EMERSON COUNTY, NEVADA
WILLIS A. DEAN, CLERK
FILE NO. 81085
FEE \$ 5.00

BOOK 96 PAGE 188

NOTICE IS HEREBY GIVEN that the ST. Pat No. 151 lode mining claim has been located by AMERICAN SELCO INCORPORATED a New York corporation, whose address is 90 West Grove Street, Suite 100, Reno, Nevada 89509. The claim is a relocation of the ST Pat No. 151 lode mining claim, the certificate of location of which is of record in the office of the Recorder of EUREKA County, Nevada in Book 88 Page 440 in accordance with NRS 517.080. The general course of this claim is NORTH/SOUTH. This claim is 1500 feet in length along the course of the claim, being 1490 feet from the point of discovery in a NORTH direction to the NORTH end line of this claim, and 10 feet in a SOUTH direction to the SOUTH end line of the claim. This claim is 600 feet in width, being 300 feet in width on each side of the center line of the claim.

This claim is located all or in part in the following quarter sections(s), township(s) and range(s):

NW 1/4, Section 3, T 17 N., R 52 E., M.D.B. & M.
1/4, Section _____, T _____ N., R _____ E., M.D.B. & M.
1/4, Section _____, T _____ N., R _____ E., M.D.B. & M.
1/4, Section _____, T _____ N., R _____ E., M.D.B. & M.

in EUREKA Mining District, EUREKA County, Nevada. The location monument of this claim is situated with reference to some natural object or permanent monument as follows: CORNER #1 OF THIS CLAIM IS LOCATED APPROXIMATE 13,900 FEET S84W OF THE LOCATED SE CORNER OF SECTION 36 T18N, R52E MDM.

The corners of this claim are marked by 4" by 4" x 5' wood posts, 4" diameter x 5' plastic pipe, or 4" trees with metal tags inscribed with the appropriate corner number as shown on the following sketch and accompanying claim map(s).

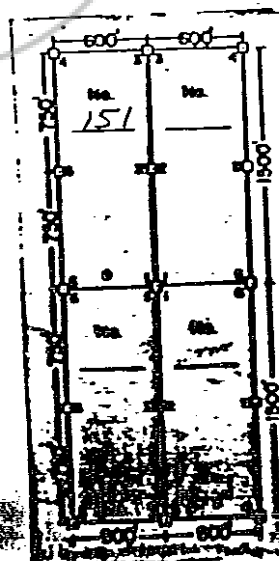

The location work consisted of making the map(s) as provided in NRS 517.040.

Dated and posted on the ground this 11 day of June 19 81.

Witnesses:

Locator:

By

M. L. Perry
Agent for

AMERICAN SELCO INCORPORATED

STATE OF NEVADA)

) ss

COUNTY OF _____)

I hereby certify that the within instrument was filed and recorded at the request of: _____

Witness my hand and official seal the day and year afore-said

FILE NO. _____

on _____

at _____

Book _____

Page _____

County Recorder

By _____

Deputy Recorder

RECORDED AT REQUEST OF
AMERICAN SELCO INC
BOOK 96 PAGE 189

81 JUL 27 A10:35

OFFICIAL RECORDS
EUREKA COUNTY, NEVADA
WILLIS A. DEPAOLI-RECORDER
FILE NO. 81086
FEE \$ 5.00

BOOK 96 PAGE 190

CERTIFICATE OF MINING LOCATION
LODE CLAIM ON PUBLIC DOMAIN

NOTICE IS HEREBY GIVEN that the ST. Pat No. 152 lode mining claim has been located by AMERICAN SELCO INCORPORATED a New York corporation, whose address is 90 West Grove Street, Suite 100, Reno, Nevada 89509. The claim is a relocation of the ST Pat No. 152 lode mining claim, the certificate of location of which is of record in the office of the Recorder of EUREKA County, Nevada in Book 88 Page 441 in accordance with NRS 517.080. The general course of this claim is NORTH/SOUTH. This claim is 1500 feet in length along the course of the claim, being 1490 feet from the point of discovery in a NORTH direction to the NORTH end line of this claim, and 10 feet in a SOUTH direction to the SOUTH end line of the claim. This claim is 600 feet in width, being 300 feet in width on each side of the center line of the claim.

This claim is located all or in part in the following quarter sections(s), township(s) and range(s):

NW 1/4, Section 3, T 17 N., R 52 E., M.D.B. & M.
1/4, Section _____, T _____ N., R _____ E., M.D.B. & M.
1/4, Section _____, T _____ N., R _____ E., M.D.B. & M.
1/4, Section _____, T _____ N., R _____ E., M.D.B. & M.

in EUREKA Mining District, EUREKA County, Nevada. The location monument of this claim is situated with reference to some natural object or permanent monument as follows: CORNER #1 OF THIS CLAIM IS LOCATED APPROXIMATE 13,900 FEET S84W1 OF THE LOCATED SE CORNER OF SECTION 36 T18N, R52E MDM.

The corners of this claim are marked by 4" by 4" x 5' wood posts, 4" diameter x 5' plastic pipe, or 4" trees with metal tags inscribed with the appropriate corner number as shown on the following sketch and accompanying claim map(s).

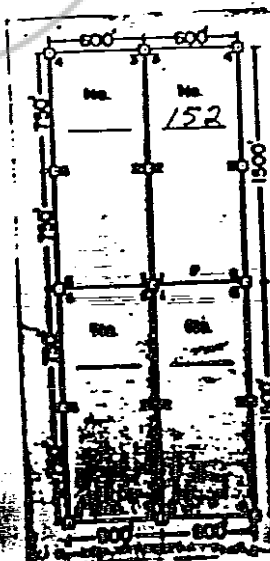

The location work consisted of making the map(s) as provided
in NRS 517.040.

Dated and posted on the ground this 11 day of June
19 81.

Witnesses:

Locator:

By

M. L. Perry
Agent for

AMERICAN SELCO INCORPORATED

STATE OF NEVADA)

) ss

COUNTY OF _____)

I hereby certify that the within
instrument was filed and recorded
at the request of: _____

Witness my hand and official
seal the day and year afore-
said

FILE NO. _____

on _____

at _____

Book _____

Page _____

County Recorder

By _____

Deputy Recorder

RECORDED AT REQUEST OF
AMERICAN SELCO INC
BOOK 96 PAGE 191

81 JUL 27 A10:35

OFFICIAL RECORDS
CLERK OF COUNTY CLERK
WILLIS A. DEFAULT-RECORDER
FILE NO. 81087
FEE \$ 5.00

BOOK 96 PAGE 192

NOTICE IS HEREBY GIVEN that the ST. Pat No. 153 lode mining claim has been located by AMERICAN SELCO INCORPORATED a New York corporation, whose address is 90 West Grove Street, Suite 100, Reno, Nevada 89509. The claim is a relocation of the ST Pat No. 153 lode mining claim, the certificate of location of which is of record in the office of the Recorder of EUREKA County, Nevada in Book 88 Page 442 in accordance with NRS 517.080. The general course of this claim is NORTH/SOUTH. This claim is 1500 feet in length along the course of the claim, being 1490 feet from the point of discovery in a NORTH direction to the NORTH end line of this claim, and 10 feet in a SOUTH direction to the SOUTH end line of the claim. This claim is 600 feet in width, being 300 feet in width on each side of the center line of the claim.

This claim is located all or in part in the following quarter sections(s), township(s) and range(s):

NE 1/4, Section 3, T 17 N., R 52 E., M.D.B. & M.
1/4, Section _____, T _____ N., R _____ E., M.D.B. & M.
1/4, Section _____, T _____ N., R _____ E., M.D.B. & M.
1/4, Section _____, T _____ N., R _____ E., M.D.B. & M.

in EUREKA Mining District, EUREKA County, Nevada. The location monument of this claim is situated with reference to some natural object or permanent monument as follows: CORNER #1 OF THIS CLAIM IS LOCATED APPROXIMATELY 12,200 FEET S83°W1 OF THE LOCATED SE CORNER OF SECTION 36 T18N, R52E MDM.

The corners of this claim are marked by 4" by 4" x 5' wood posts, 4" diameter x 5' plastic pipe, or 4" trees with metal tags inscribed with the appropriate corner number as shown on the following sketch and accompanying claim map(s).

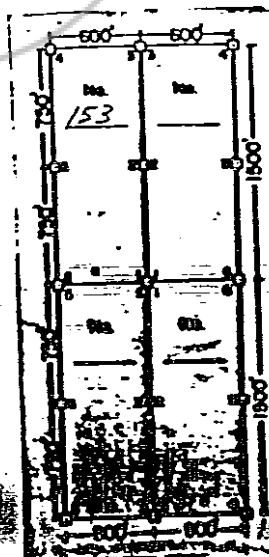

The location work consisted of making the map(s) as provided
in NRS 517.040.

Dated and posted on the ground this 11 day of June
19 81.

Witnesses:

Locator:

By

M. L. Perry
Agent for

AMERICAN SELCO INCORPORATED

STATE OF NEVADA

)

) ss

COUNTY OF _____

)

I hereby certify that the within
instrument was filed and recorded
at the request of: _____

Witness my hand and official
seal the day and year afore-
said

FILE NO. _____

on _____

at _____

Book _____ Page _____

County Recorder

By _____

Deputy Recorder

RECORDED AT REQUEST OF
AMERICAN SELCO INC
BOOK 96 PAGE 193

81 JUL 27 AIO: 35

OFFICIAL RECORDS
EUREKA COUNTY, NEVADA
WILLIS A. DEFFOLI-RECORDER
FILE NO. 81088
FEE \$ 5.00

BOOK 96 PAGE 194

NOTICE IS HEREBY GIVEN that the ST Pat No. 154 lode mining claim has been located by AMERICAN SELCO INCORPORATED a New York corporation, whose address is 90 West Grove Street, Suite 100, Reno, Nevada 89509. The claim is a relocation of the ST Pat No. 154 lode mining claim, the certificate of location of which is of record in the office of the Recorder of EUREKA County, Nevada in Book 88 Page 443 in accordance with NRS 517.080. The general course of this claim is NORTH/SOUTH. This claim is 1500 feet in length along the course of the claim, being 1490 feet from the point of discovery in a NORTH direction to the NORTH end line of this claim, and 10 feet in a SOUTH direction to the SOUTH end line of the claim. This claim is 600 feet in width, being 300 feet in width on each side of the center line of the claim.

This claim is located all or in part in the following quarter sections(s), township(s) and range(s):

NE 1/4, Section 3, T 17 N., R 52 E., M.D.B. & M.
1/4, Section _____, T _____ N., R _____ E., M.D.B. & M.
1/4, Section _____, T _____ N., R _____ E., M.D.B. & M.
1/4, Section _____, T _____ N., R _____ E., M.D.B. & M.

in EUREKA Mining District, EUREKA County, Nevada. The location monument of this claim is situated with reference to some natural object or permanent monument as follows:

CORNER #1 OF THIS CLAIM IS LOCATED APPROXIMATELY 12,700 FEET S83 1/2° W OF THE LOCATED SE CORNER OF SECTION 36 T18N, R52E MOM.

The corners of this claim are marked by 4" by 4" x 5' wood posts, 4" diameter x 5' plastic pipe, or 4" trees with metal tags inscribed with the appropriate corner number as shown on the following sketch and accompanying claim map(s).

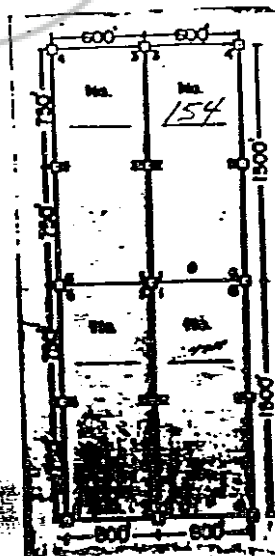

The location work consisted of making the map(s) as provided
in NRS 517.040.

Dated and posted on the ground this 11 day of June
1981.

Witnesses:

Locator:

By

M. L. Perry
Agent for

AMERICAN SELCO INCORPORATED

STATE OF NEVADA)

) ss

COUNTY OF _____)

I hereby certify that the within
instrument was filed and recorded
at the request of: _____

Witness my hand and official
seal the day and year afore-
said

FILE NO. _____

on _____

at _____

Book _____

Page _____

County Recorder

By _____

Deputy Recorder

RECORDED AT REQUEST OF
AMERICAN SELCO INC
BOOK 96 PAGE 195

81 JUL 27 AIO: 35

OFFICIAL RECORDS
CLERK COUNTY CLERK
WILLIAM A. BOWEN - RECORDER
FILE NO. 81089
FILE # 5.00

BOOK 996 PAGE 196

CERTIFICATE OF MINING LOCATION
81090 LODE CLAIM ON PUBLIC DOMAIN

NOTICE IS HEREBY GIVEN that the ST Pat No. 155 lode mining claim has been located by AMERICAN SELCO INCORPORATED a New York corporation, whose address is 90 West Grove Street, Suite 100, Reno, Nevada 89509. The claim is a relocation of the ST Pat No. 155 lode mining claim, the certificate of location of which is of record in the office of the Recorder of EUREKA County, Nevada in Book 88 Page 444 in accordance with NRS 517.080. The general course of this claim is NORTH / SOUTH. This claim is 1500 feet in length along the course of the claim, being 1490 feet from the point of discovery in a NORTH direction to the NORTH end line of this claim, and 10 feet in a SOUTH direction to the SOUTH end line of the claim. This claim is 600 feet in width, being 300 feet in width on each side of the center line of the claim.

This claim is located all or in part in the following quarter sections(s), township(s) and range(s):

NE 1/4, Section 3, T 17 N., R 52 E., M.D.B. & M.
1/4, Section _____, T _____ N., R _____ E., M.D.B. & M.
1/4, Section _____, T _____ N., R _____ E., M.D.B. & M.
1/4, Section _____, T _____ N., R _____ E., M.D.B. & M.

in EUREKA Mining District, EUREKA County, Nevada. The location monument of this claim is situated with reference to some natural object or permanent monument as follows: CORNER #1 OF THIS CLAIM IS LOCATED APPROXIMATELY 11,600 FEET S83°W OF THE LOCATED SE CORNER OF SECTION 36 T18N, R52E MDM.

The corners of this claim are marked by 4" by 4" x 5' wood posts, 4" diameter x 5' plastic pipe, or 4" trees with metal tags inscribed with the appropriate corner number as shown on the following sketch and accompanying claim map(s).

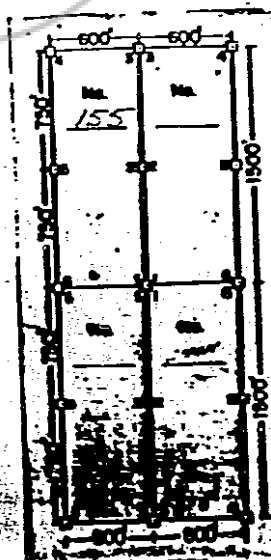

The location work consisted of making the map(s) as provided
in NRS 517.040.

Dated and posted on the ground this 11 day of June
19 81.

Witnesses:

Locator:

By

M. L. Perry
Agent for

AMERICAN SELCO INCORPORATED

STATE OF NEVADA)

) ss

COUNTY OF _____)

I hereby certify that the within
instrument was filed and recorded
at the request of: _____

Witness my hand and official
seal the day and year afore-
said

FILE NO. _____

on _____

at _____

Book _____

Page _____

County Recorder

By _____

Deputy Recorder

RECORDED AT REQUEST OF
AMERICAN SELCO INC
BOOK 96 PAGE 97

81 JUL 27 AID: 35

OFFICIAL RECORDS
CLERK COUNTY, NEVADA
WILLIS A. DEPAOLI-RECORDER
FILE NO. 81090
FEE \$ 5.00

BOOK 96 PAGE 98

CERTIFICATE OF MINING LOCATION
LODE CLAIM ON PUBLIC DOMAIN

NOTICE IS HEREBY GIVEN that the ST. Pat No. 156 lode mining claim has been located by AMERICAN SELCO INCORPORATED a New York corporation, whose address is 90 West Grove Street, Suite 100, Reno, Nevada 89509. The claim is a relocation of the ST Pat No. 156 lode mining claim, the certificate of location of which is of record in the office of the Recorder of EUREKA County, Nevada in Book 88 Page 445 in accordance with NRS 517.080. The general course of this claim is NORTH/SOUTH. This claim is 1500 feet in length along the course of the claim, being 1490 feet from the point of discovery in a NORTH direction to the NORTH end line of this claim, and 10 feet in a SOUTH direction to the SOUTH end line of the claim. This claim is 600 feet in width, being 300 feet in width on each side of the center line of the claim.

This claim is located all or in part in the following quarter sections(s), township(s) and range(s):

NE 1/4, Section 3, T 17 N., R 52 E., M.D.B. & M.
1/4, Section , T N., R E., M.D.B. & M.
1/4, Section , T N., R E., M.D.B. & M.
1/4, Section , T N., R E., M.D.B. & M.
 in EUREKA Mining District, EUREKA County,

Nevada. The location monument of this claim is situated with reference to some natural object or permanent monument as follows: CORNER #1 OF THIS CLAIM IS LOCATED APPROXIMATELY 11,600 FEET S83W1 OF THE LOCATED SE CORNER OF SECTION 36 T18N, R52E MDM.

The corners of this claim are marked by 4" by 4" x 5' wood posts, 4" diameter x 5' plastic pipe, or 4" trees with metal tags inscribed with the appropriate corner number as shown on the following sketch and accompanying claim map(s).

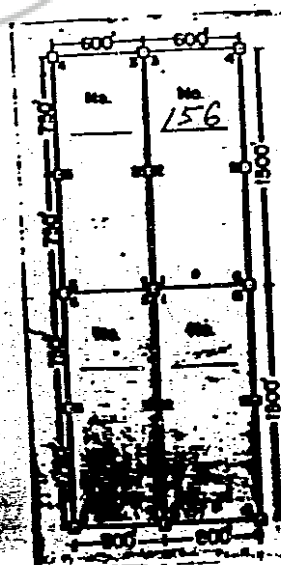

The location work consisted of making the map(s) as provided
in NRS 517.040.

Dated and posted on the ground this 11 day of June
19 81.

Witnesses:

Locator:

By

Agent for

AMERICAN SELCO INCORPORATED

STATE OF NEVADA

) ss

COUNTY OF

I hereby certify that the within
instrument was filed and recorded
at the request of:

Witness my hand and official
seal the day and year afore-
said

FILE NO.

on

at

Book

Page

County Recorder

By

Deputy Recorder

RECORDED AT REQUEST OF
AMERICAN SELCO INC
BOOK 96 PAGE 199

81 JUL 27 A10:35

OFFICIAL RECORDS
CLERK COUNTY CLERK
WILLIS A. DEPT. OF RECORDS
FILE NO. 81091
FEE \$ 5.00

BOOK 96 PAGE 200