

# Affidavit or Statement of Annual Assessment Work (PROOF OF LABOR) ON UNPATENTED MINING CLAIM

TO ALL WHOM IT MAY CONCERN:

The undersigned hereby certifies (certify) that he (she, they) has (have) expended more than \$3600.00 dollars for labor and improvements, as the annual assessment work for the year ending September 1, 1981, on the (list claim names here)

BLS #1-18, BLS Fraction #19-24 (NMC 138940-138963)

BLS #25-33, BLS Fraction #34-36 (NMC 160160-160171)

locate ~~plot~~ mining claim(s) in Section 16, Township 34N, Range 50E, in the unknown Mining District, in Eureka County, Nevada, owned by Cordex Exploration Co. for the purpose of holding said claim(s).

The claim map showing said claim(s) is filed as Document No. 72280 & 75242 in the Eureka County records.

Said labor was performed or improvements made by (name and address) Don Avery and Andy Wallace, 573 East Second Street, Reno, NV 89502 between the dates of August 21, 1981 and August 28, 1981, and consisted of Geochemical Survey. All work was done at the expense of Cordex Exploration Co., 573 East Second Street, Reno, NV 89502.

(Describe work done, and claim or part of claim affected)

Dated this second day of September, 1981.

*J. J. [Signature]*  
(Name of subscriber)

(Witness)

(Witness)

Subscribed and sworn to before me this 14th day of September, 1981.

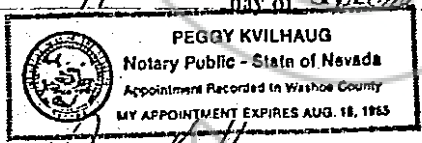

*Peggy Kvilhaug*

Note 1: This Affidavit or Statement of Annual Assessment work must be filed within 60 days after the performance of labor or making of improvements.

Note 2: "Each locator shall file two copies of a map prepared in accordance with NRS 517.030 with the county recorder in which the claim is located not later than September 1, 1972." NRS 517.230, Subsection 3.

RECORDER'S STAMP

BLS CLAIMS  
EUREKA COUNTY, NEVADA  
REPORT ON GEOCHEMICAL SURVEY

A geochemical survey was performed on Cordex's BLS claims, Section 16, T.34N., R.50E., during the period August 21 through August 28, 1981. The field work was done by Don Avery under the supervision of Andy Wallace, both geologists employed by Cordex. Sample analysis of the samples was performed by Rocky Mountain Geochemical Company, 840 Greg Street, Sparks, Nevada. The total expenditures for sampling and assaying exceeded \$3600.00.

A total of 152 soil and rock chip samples were taken on 300 centers on a line spacing of 750'. Grid sampling covered each of the BLS claims, as shown on the attached map (1"=500'), which shows the BLS claims, sample numbers and locations, and topography.

The geochemical survey was designed to locate unknown geochemical anomalies worthy of drilling. It was unsuccessful however as all 152 samples were barren of gold and silver value.

*Andy Wallace*  
Andy Wallace  
Geologist

BOOK 98 PAGE 564



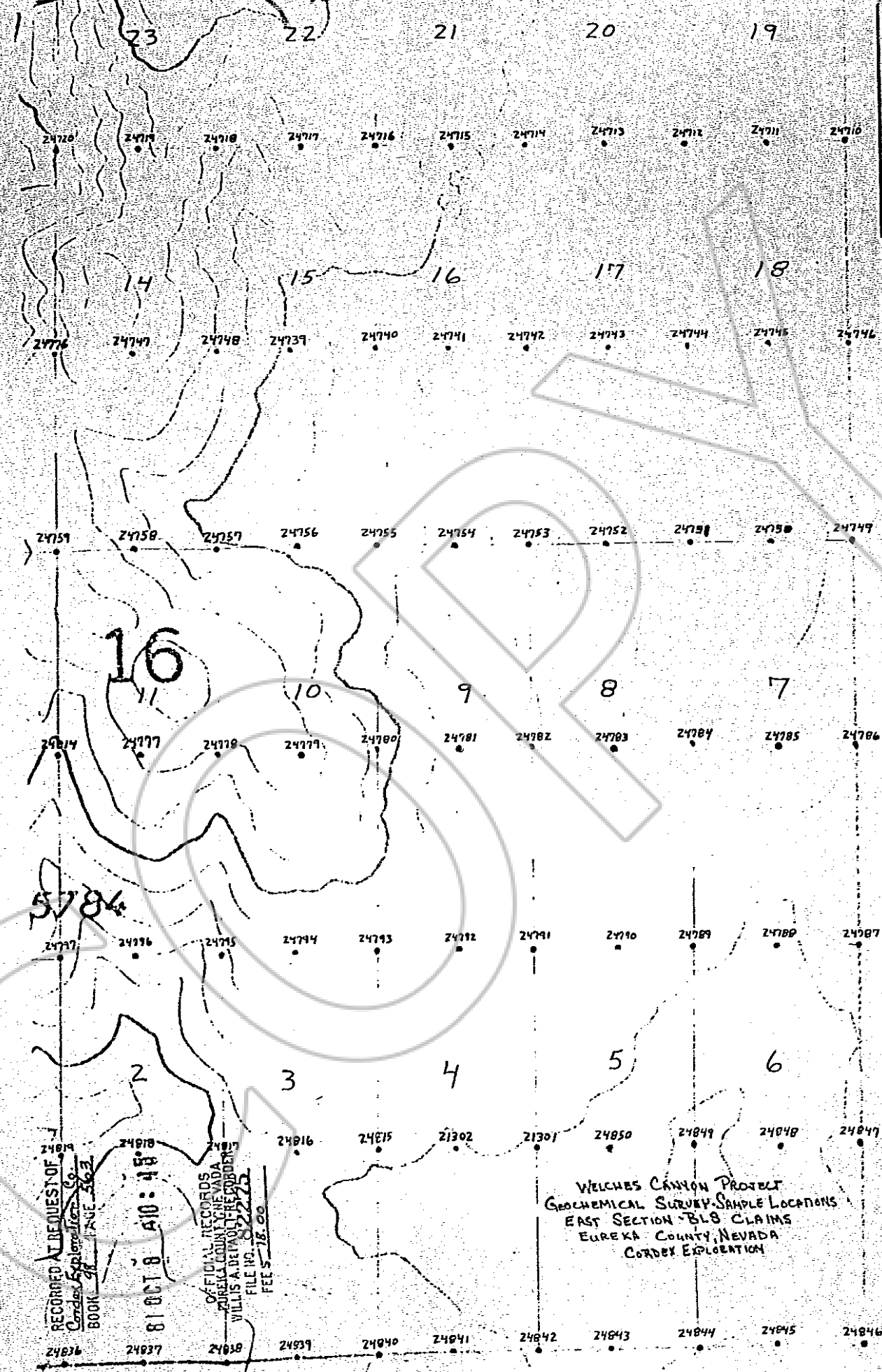

RECORDED AT REQUEST OF  
 Cordex Exploration Co.  
 BOOK 98 PAGE 566

81 OCT 8 AIO: AB

OFFICIAL RECORDS  
 EUREKA COUNTY, NEVADA  
 WILLIS A. DEWITT - RECORDER  
 FILE NO. 22225  
 FEE \$ 18.00

WELCHES CANYON PROTECT  
 GEOCHEMICAL SURVEY SAMPLE LOCATIONS  
 EAST SECTION 18 CLAIMS  
 EUREKA COUNTY, NEVADA  
 CORDOX EXPLORATION