

NOTICE IS HEREBY GIVEN that the Hot Shot No. 13 lode mining claim has been located by AMERICAN SELCO INCORPORATED, a Nevada corporation, whose address is 90 West Grove Street, Suite 100, Reno, Nevada 89509. The general course of this claim is East/West. This claim is 1500 feet in length along the course of the claim, being 1490 feet from the point of discovery in a East direction to the East end line of this claim, and 10 feet in a West direction to the West end line of the claim. This claim is 600 feet in width, being 300 feet in width on each side of the center line of the claim.

This claim is located all or in part in the following quarter section(s), township(s) and range(s):

SW 1/4, Section 31, T 23 N., R 51 E., M.D.B. & M.
NW 1/4, Section 6, T 22 N., R 51 E., M.D.B. & M.
SE 1/4, Section _____, T _____ N., R _____ E., M.D.B. & M.
SW 1/4, Section _____, T _____ N., R _____ E., M.D.B. & M.

in unknown Mining District, Eureka County, Nevada. The location monument of this claim is situated with reference to some natural object or permanent monument as follows: The number one corner of this claim lies approximately 11,600' feet N22°10'W from the NW corner of section 17, T22N, R51E.

The corners of this claim are marked by 4" by 4" x 5' wood posts, 4" diameter x 5' plastic pipe, or 4" trees with metal tags inscribed with the appropriate corner number as shown on the following sketch and accompanying claim map(s).

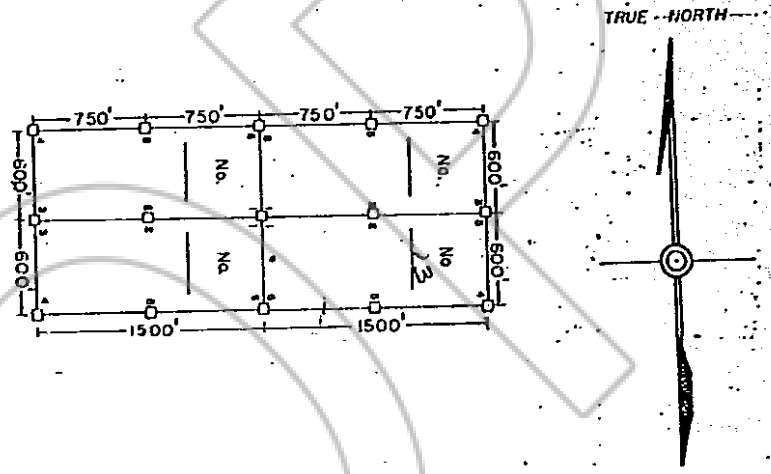

The location work consisted of making the map(s) as provided NRS 517.040.

Dated and posted on the ground this 31 day of July

RECORDED AT REQUEST OF
AMERICAN SELCO INC
BOOK 99 PAGE 32
81 OCT 19 410:55
OFFICIAL RECORDS
EUREKA COUNTY, NEVADA
WILLIS A. ORFORD - RECORDER
FILE # 82314
FEE \$ 17.00

Locator: [Signature]
By AMERICAN SELCO INCORPORATED
Agent for

STATE OF NEVADA)
COUNTY OF _____) ss

I hereby certify that the within instrument was filed and recorded at the request of: _____

Witness my hand and official seal the day and year aforesaid

BOOK 99 PAGE 32

FILE NO. _____
on _____
at _____

County Recorder