

82337

Affidavit of Performance of Annual  
Assessment Work  
(Proof of Labor)

State of Nevada )  
                          )ss  
County of Washoe )

Mike Perry, whose address is 464 Smithridge Park, Reno, Nevada, being first sworn, on behalf of the owner, states that at least one hundred dollars in value of labor was performed or improvements made upon or for the direct benefit of each of the following unpatented lode mining claims located in Eureka County, Nevada, to wit:

<u>Claim Name</u>	<u>BLM Serial No.</u>	<u>Location Notice Recorded</u> <u>Book</u> <u>Page</u>
Lake	See attachment	See attachment

That labor was performed and improvements were made between September 1, 1980 and September 1, 1981, for the assessment year ending September 1, 1981. The amount of money expended for such labor and improvement was \$ 6,576.00, and the character of the expenditures, labor and improvements is as follows:

Soil sampling

The owner of the claims is American Selco Incorporated, whose address is 90 West Grove Street, Suite 100, Reno, Nevada 89509, and the expenditures were made at the expense of American Selco Incorporated, for the benefit of the owner. The person(s), corporation(s), contractor(s) or subcontractor(s) who performed the work or made the improvements are Randy Briggs, Ray Hill and Alan Niles.

Mike Perry  
Affiant

Phonela H. Andrews  
Witness

DENN TERPASE  
Witness

Subscribed and sworn to before me this 20th day of October, 19 81, by Mike Perry.

(SEAL)

Tamara L. Tramble  
Notary Public

My commission expires:

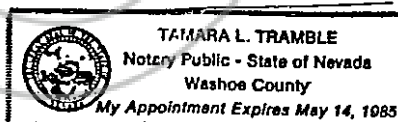

BOOK 99 PAGE 071

Attachment to Affidavit of Labor Performed and Improvements Made  
for year ending September 1, 1981 for the Lake Claim Group.

<u>Claim Name</u>	<u>BLM Serial No.</u>	<u>Book</u>	<u>Page</u>
Lake No. 1	174251	89	344
Lake No. 2	174252	89	345
Lake Nos. 17-30	174253-174260	89	346-359
Lake Nos. 32-35	174267-174270	89	360-363
Lake No. 37	174271	89	364
Lake No. 39	174272	89	365
Lake No. 41	174273	89	366
Lake No. 43	174274	89	367
Lake No. 45	174275	89	368
Lake No. 46, Relocated	188059	93	438
Lake Nos. 47-75	174277-174305	89	370-398

REPORT OF MINERAL EXPLORATION ACTIVITIES  
CONDUCTED ON THE Lake CLAIMS

Eureka COUNTY, Nevada

The location of the work performed in relation to the point of discovery and boundaries of the claim(s):  
Western half and southeastern sections of the claim block.

Nature or type of work performed: Soil sampling.

Extent of work performed:  
1,020 soil samples were collected and analyzed.

Cost of work performed: \$6,576.00 was expended for soil sampling.

Basic findings of work performed:  
The analyses of the soil sampling will serve as a basis for further physical, geophysical and geochemical work.

Person or persons conducting the work:

Name	Address	Professional Background
<u>Randy Briggs</u>	<u>Ruth, Nevada</u>	<u>Field Technician</u>
<u>Ray Hill</u>	<u>Ruth, Nevada</u>	<u>Field Technician</u>
<u>Alan Niles</u>	<u>Ruth, Nevada</u>	<u>Geologist</u>
<u></u>	<u></u>	<u></u>
<u></u>	<u></u>	<u></u>
<u></u>	<u></u>	<u></u>

Such survey has not been applied as labor for more than two consecutive years or for more than a total of five years on any one mining claim, and such survey has been nonrepetitive of any previous survey on the same claim.



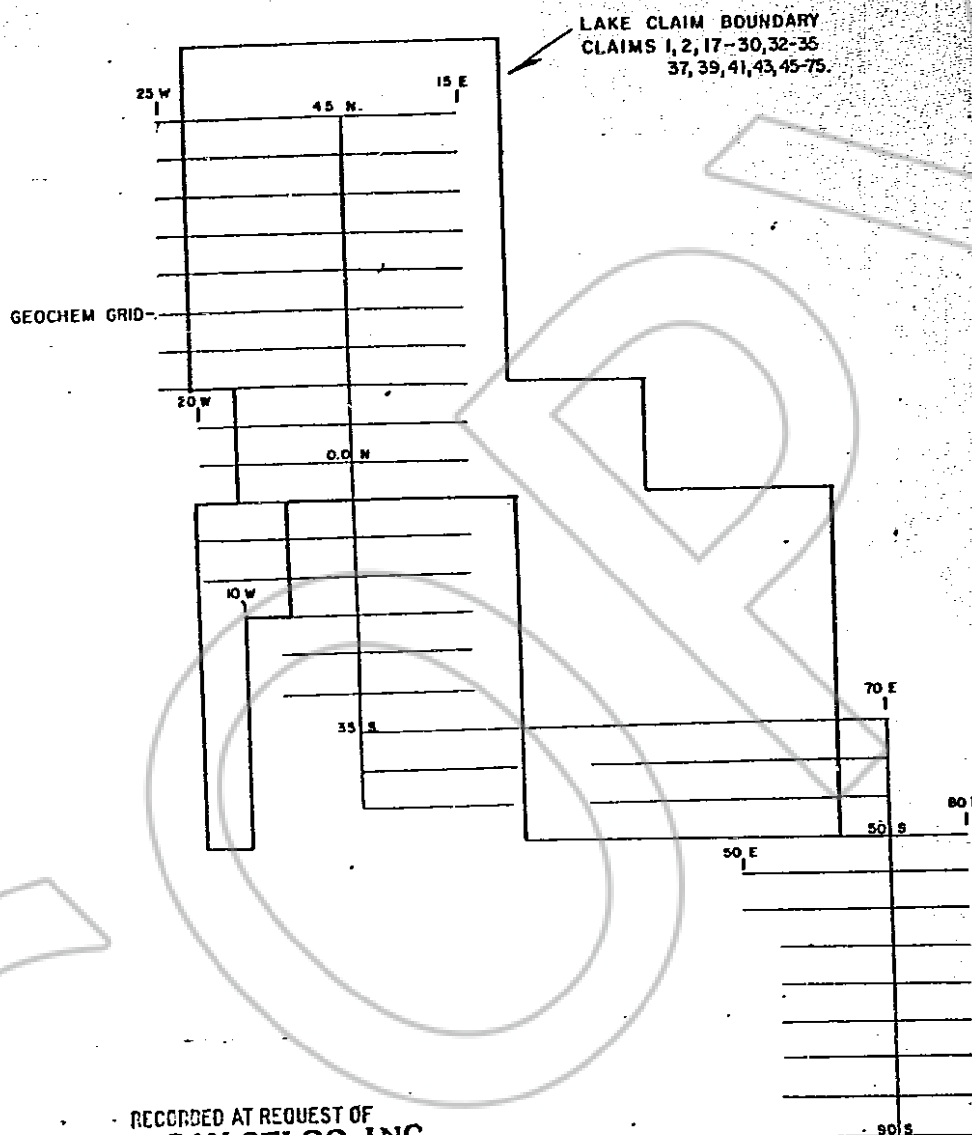
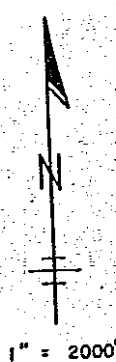

RECORDED AT REQUEST OF  
**AMERICAN SELCO INC**  
BOOK 99 PAGE 71

81 OCT 22 AID: 30

OFFICIAL RECORDS  
EUREKA COUNTY, NEVADA  
WILLIS A. DEPAULY, RECORDER  
FILE NO. 82337  
FEE \$ 27.50

**AMERICAN SELCO INC.**

**LAKE CLAIMS**

SOIL GEOCHEMISTRY  
SAMPLES TAKEN EVERY 100'  
ON WING LINES

MAPPED BY A. NILES  
DRAWN BY S. ESMONT  
DRAFTED BY D. HIGLEY

BOOK 99 PAGE 74  
T. 17, 18 N. R. 52 E.