

84083

RELOCATION
 CERTIFICATE OF MINING LOCATION
 LODE CLAIM ON PUBLIC DOMAIN

NOTICE IS HEREBY GIVEN that the St Pat No. 200 lode mining claim has been relocated by AMERICAN SELCO INCORPORATED, a New York corporation, whose address is 90 West Grove Street, Suite 100, Reno, Nevada 89509. The claim is a relocation of the St Pat No. 200 lode mining claim, the certificate of location of which is of record in the office of the Recorder of Eureka County, Nevada in Book 88 Page 486 in accordance with N.R.S. 517.080. The general course of this claim is North/South. This claim is 1500 feet in length along the course of the claim, being 1490 feet from the point of discovery in a North direction to the North end line of this claim, and 10 feet in a South direction to the South end line of the claim. This claim is 600 feet in width, being 300 feet in width on each side of the center line of the claim.

This claim is located all or in part in the following quarter section(s), township(s) and range(s):

NW	1/4, Section	9	, T	17	N., R	52	E., M.D.B & M.
	1/4, Section		, T		N., R		E., M.D.B & M.
	1/4, Section		, T		N., R		E., M.D.B & M.
	1/4, Section		, T		N., R		E., M.D.B & M.

in Eureka Mining District, Eureka County, Nevada. The location monument of this claim is situated with reference to some natural object or permanent monument as follows: Corner No. 1 of this claim is located approximately 14,900 feet S 67° W of the located SE corner of section 36 T 10N, R52E MDM.

The corners of this claim are marked by 4" by 4" x 5' wood posts, 4" diameter x 5' plastic pipe, or 4" trees with metal tags inscribed with the appropriate corner number as shown on the following sketch and accompanying claim map(s).

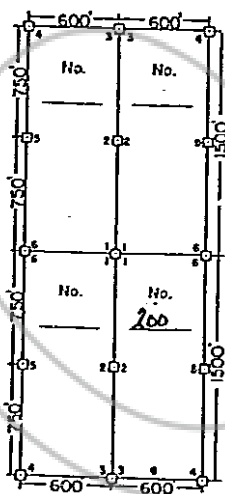

TRUE NORTH

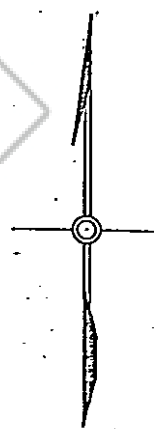

The location work consisted of making the map(s) as provided in NRS 517.040.

Dated and posted on the ground this 24 day of March 1982.

Witnesses:

RECORDED AT REQUEST OF
American Selco, Inc.
 BOOK 102 PAGE 92

Locator:

82 APR 12 AID: 28

By

Van R. Hurlburt
 Agent for
 AMERICAN SELCO INCORPORATED

OFFICIAL RECORDS
 EUREKA COUNTY, NEVADA
 WILLIS A. DEPAUL RECORDER
 FILE NO. 84083
 FEE \$ 4.00

BOOK 102 PAGE 92

RELOCATION
 CERTIFICATE OF MINING LOCATION
 LODE CLAIM ON PUBLIC DOMAIN

NOTICE IS HEREBY GIVEN that the St. Pat No. 220 lode mining claim has been relocated by AMERICAN SELCO INCORPORATED, a New York corporation, whose address is 90 West Grove Street, Suite 100, Reno, Nevada 89509. The claim is a relocation of the St. Pat No. 220 lode mining claim, the certificate of location of which is of record in the office of the Recorder of Eureka County, Nevada in Book 88 Page 505 in accordance with N.R.S. 517.080. The general course of this claim is North/South. This claim is 1500 feet in length along the course of the claim, being 1490 feet from the point of discovery in a North direction to the North end line of this claim, and 10 feet in a South direction to the South end line of the claim. This claim is 600 feet in width, being 300 feet in width on each side of the center line of the claim.

This claim is located all or in part in the following quarter section(s), township(s) and range(s):

SW 1/4, Section 9, T 17 N., R 52 E., M.D.B & M.
1/4, Section , T N., R E., M.D.B & M.
1/4, Section , T N., R E., M.D.B & M.
1/4, Section , T N., R E., M.D.B & M.

in Eureka Mining District, Eureka County, Nevada. The location monument of this claim is situated with reference to some natural object or permanent monument as follows: Corner No. 1 of this claim is located approximately 17600 feet S 59° W of the located SE corner of Section 36 T18N, R52E MDM

The corners of this claim are marked by 4" by 4" x 5' wood posts, 4" diameter x 5' plastic pipe, or 4" trees with metal tags inscribed with the appropriate corner number as shown on the following sketch and accompanying claim map(s).

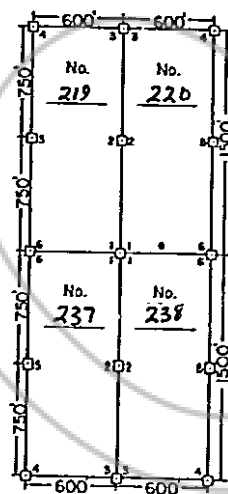

TRUE NORTH

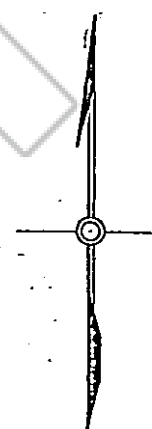

The location work consisted of making the map(s) as provided in NRS 517.040.

Dated and posted on the ground this 24 day of March 19 82.

Witnesses:

RECORDED AT REQUEST OF
AMERICAN SELCO INC
 BOOK 102 PAGE 93

Locator:

82 APR 12 AID: 28

By

Van R. Shuck
 Agent for
AMERICAN SELCO INCORPORATED

OFFICIAL RECORDS
 EUREKA COUNTY, NEVADA
 WALLIS A. DEPAUL, RECORDER
 FILE # 84084
 FEE \$ 4.00

BOOK 102 PAGE 93

**RELOCATION
CERTIFICATE OF MINING LOCATION
LODE CLAIM ON PUBLIC DOMAIN**

NOTICE IS HEREBY GIVEN that the St. Pat No. 219 lode mining claim has been relocated by AMERICAN SELCO INCORPORATED, a New York corporation, whose address is 90 West Grove Street, Suite 100, Reno, Nevada 89509. The claim is a relocation of the St. Pat No. 219 lode mining claim, the certificate of location of which is of record in the office of the Recorder of Eureka County, Nevada in Book 88 Page 503 in accordance with N.R.S. 517.080. The general course of this claim is North/South. This claim is 1500 feet in length along the course of the claim, being 1490 feet from the point of discovery in a North direction to the North end line of this claim, and 10 feet in a South direction to the South end line of the claim. This claim is 600 feet in width, being 300 feet in width on each side of the center line of the claim.

This claim is located all or in part in the following quarter section(s), township(s) and range(s):

SW 1/4, Section 9, T 17 N., R 52 E., M.D.B & M.
1/4, Section , T N., R E., M.D.B & M.
1/4, Section , T N., R E., M.D.B & M.
1/4, Section , T N., R E., M.D.B & M.

in Eureka Mining District, Eureka County, Nevada. The location monument of this claim is situated with reference to some natural object or permanent monument as follows: Corner No. 1 of this claim is located approximately 17600 feet S 59° W of the located SE corner of Section 36 T18N, R52E MDM.

The corners of this claim are marked by 4" by 1" x 5' wood posts, 4" diameter x 5' plastic pipe, or 4" trees with metal tags inscribed with the appropriate corner number as shown on the following sketch and accompanying claim map(s).

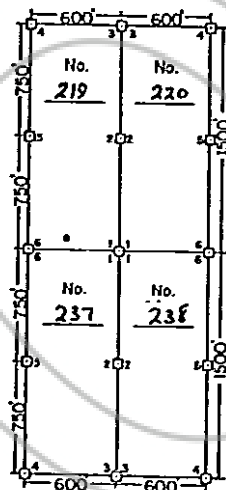

TRUE NORTH

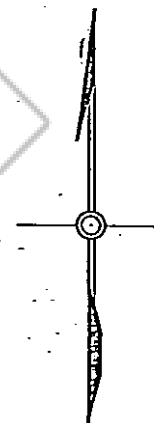

The location work consisted of making the map(s) as provided in NRS 517.040.

Dated and posted on the ground this 24 day of March 19 82.

Witnesses:

RECORDED AT REQUEST OF
AMERICAN SELCO INC
BOOK 102 PAGE 94

Locator:

82 APR 12 AIO: 29

By Van R. Huellett
Agent for
AMERICAN SELCO INCORPORATED

OFFICIAL RECORDS
EUREKA COUNTY, NEVADA
WILLIS A. BEPko, RECORDER
FILE NO. 84085
FEE \$ 4.00

BOOK 102 PAGE 94

RELOCATION
 CERTIFICATE OF MINING LOCATION
 LOSE CLAIM ON PUBLIC DOMAIN

NOTICE IS HEREBY GIVEN that the St. Pat No. 221 lode mining claim has been relocated by AMERICAN SELCO INCORPORATED, a New York corporation, whose address is 90 West Grove Street, Suite 100, Reno, Nevada 89509. The claim is a relocation of the St. Pat No. 221 lode mining claim, the certificate of location of which is of record in the office of the Recorder of Eureka County, Nevada in Book 88 Page 506 in accordance with N.R.S. 517.080. The general course of this claim is North/South. This claim is 1500 feet in length along the course of the claim, being 1490 feet from the point of discovery in a North direction to the North end line of this claim, and 10 feet in a South direction to the South end line of the claim. This claim is 600 feet in width, being 300 feet in width on each side of the center line of the claim.

This claim is located all or in part in the following quarter section(s), township(s) and range(s):

SW	1/4, Section	9	T	17	N., R	52	E.,	M.D.B & M.
	1/4, Section		T		N., R		E.,	M.D.B & M.
	1/4, Section		T		N., R		E.,	M.D.B & M.
	1/4, Section		T		N., R		E.,	M.D.B & M.

in Eureka Mining District, Eureka County, Nevada. The location monument of this claim is situated with reference to some natural object or permanent monument as follows: Corner No. 1 of this claim is located approximately 16,400 feet S 56° W of the located SE corner of Section 36 T18N, R52E MDM.

The corners of this claim are marked by 4" by 4" x 5' wood posts, 4" diameter x 5' plastic pipe, or 4" trees with metal tags inscribed with the appropriate corner number as shown on the following sketch and accompanying claim map(s).

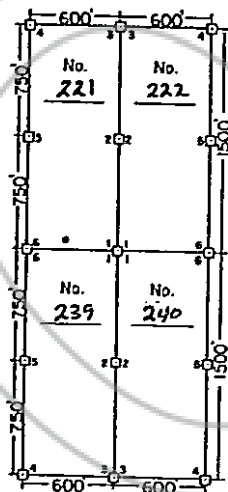

TRUE NORTH

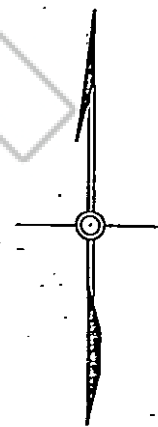

The location work consisted of making the map(s) as provided in NRS 517.040.

Dated and posted on the ground this 24 day of March 19 82.

Witnesses: RECORDED AT REQUEST OF
AMERICAN SELCO INC
BOOK 102 PAGE 95

Locator:

82 APR 12 AID: 28

By Wm R. Newkirk
 Agent for
AMERICAN SELCO INCORPORATED

OFFICIAL RECORDS
 EUREKA COUNTY, NEVADA
 WILLIS A. DEPAULI, RECORDER
 FILE NO. 84086
 FEE \$ 4.00

BOOK 102 PAGE 95

RELOCATION
CERTIFICATE OF MINING LOCATION
LODE CLAIM ON PUBLIC DOMAIN

NOTICE IS HEREBY GIVEN that the St. Pat No. 222 lode mining claim has been relocated by AMERICAN SELCO INCORPORATED, a New York corporation, whose address is 90 West Grove Street, Suite 100, Reno, Nevada 89509. The claim is a relocation of the St. Pat No. 222 lode mining claim, the certificate of location of which is of record in the office of the Recorder of Eureka County, Nevada in Book 88 Page 504 in accordance with N.R.S. 517.080. The general course of this claim is North/South. This claim is 1500 feet in length along the course of the claim, being 1490 feet from the point of discovery in a North direction to the North end line of this claim, and 10 feet in a South direction to the South end line of the claim. This claim is 600 feet in width, being 300 feet in width on each side of the center line of the claim.

This claim is located all or in part in the following quarter section(s), township(s) and range(s):

SW 1/4, Section 9, T 17 N., R 52 E., M.D.B & M.
1/4, Section , T N., R E., M.D.B & M.
1/4, Section , T N., R E., M.D.B & M.
1/4, Section , T N., R E., M.D.B & M.
in Eureka Mining District, Eureka County, Nevada. The location monument of this claim is situated with reference to some natural object or permanent monument as follows: Corner No. 1 of this claim is located approximately 16,400 feet S 56° W of the located SE corner of Section 36 T18N, R52E MDM

The corners of this claim are marked by 4" by 4" x 5' wood posts, 4" diameter x 5' plastic pipe, or 4" trees with metal tags inscribed with the appropriate corner number as shown on the following sketch and accompanying claim map(s).

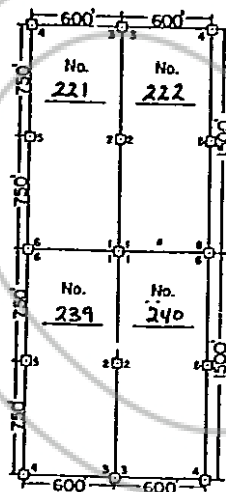

TRUE NORTH

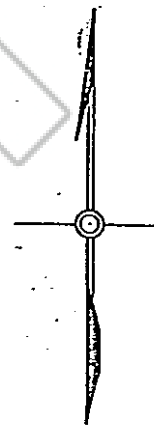

The location work consisted of making the map(s) as provided in NRS 517.040.

Dated and posted on the ground this 24 day of March 19 82.

Witnesses:

RECORDED AT REQUEST OF
AMERICAN SELCO INC
BOOK 102 PAGE 96

Locator:

82 APR 12 AIO: 28

By W. R. Lawrence
Agent for
AMERICAN SELCO INCORPORATED

OFFICIAL RECORDS
EUREKA COUNTY, NEVADA
WILLIS A. DEPAOLI-RECORDER
FILE # 84087
FEE \$ 4.00

BOOK 102 PAGE 96.

RELOCATION
 CERTIFICATE OF MINING LOCATION
 LOSE CLAIM ON PUBLIC DOMAIN

NOTICE IS HEREBY GIVEN that the St. Pat No. 223 lode mining claim has been relocated by AMERICAN SELCO INCORPORATED, a New York corporation, whose address is 90 West Grove Street, Suite 100, Reno, Nevada 89509. The claim is a relocation of the St. Pat No. 223 lode mining claim, the certificate of location of which is of record in the office of the Recorder of Eureka County, Nevada in Book 88 Page 507 in accordance with N.R.S. 517.080. The general course of this claim is North/South. This claim is 1500 feet in length along the course of the claim, being 1490 feet from the point of discovery in a North direction to the North end line of this claim, and 10 feet in a South direction to the South end line of the claim. This claim is 600 feet in width, being 300 feet in width on each side of the center line of the claim.

This claim is located all or in part in the following quarter section(s), township(s) and range(s):

SE 1/4, Section 9, T 17 N., R 52 E., M.D.B & M.
1/4, Section , T N., R E., M.D.B & M.
1/4, Section , T N., R E., M.D.B & M.
1/4, Section , T N., R E., M.D.B & M.

in Eureka Mining District, Eureka County, Nevada. The location monument of this claim is situated with reference to some natural object or permanent monument as follows: Corner No. 1 of this claim is located approximately 15,300 feet S 53° W of the located corner of Section 36 T 18N, R52E MDM.

The corners of this claim are marked by 4" by 4" x 5' wood posts, 4" diameter x 5' plastic pipe, or 4" trees with metal tags inscribed with the appropriate corner number as shown on the following sketch and accompanying claim map(s).

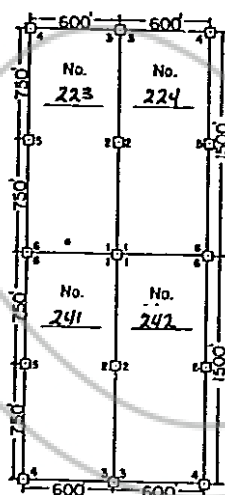

TRUE NORTH

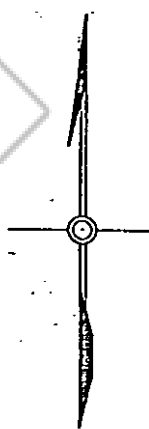

The location work consisted of making the map(s) as provided in NRS 517.040.

Dated and posted on the ground this 24 day of March 19 82.

Witnesses:

RECORDED AT REQUEST OF
AMERICAN SELCO INC
 BOOK 102 PAGE 97

Locator:

82 APR 12 AIO: 89

By

Wm. R. Smith
 Agent for
 AMERICAN SELCO INCORPORATED

OFFICIAL RECORDS
 EUREKA COUNTY, NEVADA
 WILLIS A. DEPAUL RECORDER
 FILE NO. 84088
 FEE \$ 4.00

BOOK 102 PAGE 97

84089

**RELOCATION
CERTIFICATE OF MINING LOCATION
LODE CLAIM ON PUBLIC DOMAIN**

NOTICE IS HEREBY GIVEN that the St. Pat No. 224 lode mining claim has been relocated by AMERICAN SELCO INCORPORATED, a New York corporation, whose address is 90 West Grove Street, Suite 100, Reno, Nevada 89509. The claim is a relocation of the St. Pat No. 224 lode mining claim, the certificate of location of which is of record in the office of the Recorder of Eureka County, Nevada in Book 88 Page 508 in accordance with N.R.S. 517.080. The general course of this claim is North/South. This claim is 1500 feet in length along the course of the claim, being 1490 feet from the point of discovery in a North direction to the North end line of this claim, and 10 feet in a South direction to the South end line of the claim. This claim is 600 feet in width, being 300 feet in width on each side of the center line of the claim.

This claim is located all or in part in the following quarter section(s), township(s) and range(s):

SE 1/4, Section 9, T 17 N., R 52 E., M.D.B & M.
1/4, Section , T N., R E., M.D.B & M.
1/4, Section , T N., R E., M.D.B & M.
1/4, Section , T N., R E., M.D.B & M.
 in Eureka Mining District, Eureka County, Nevada. The location monument of this claim is situated with reference to some natural object or permanent monument as follows: Corner No. 1 of this claim is located approximately 15300 feet S 53° W of the located SE corner of Section 36 T18N, R52E MDM.

The corners of this claim are marked by 4" by 4" x 5' wood posts, 4" diameter x 5' plastic pipe, or 4" trees with metal tags inscribed with the appropriate corner number as shown on the following sketch and accompanying claim map(s).

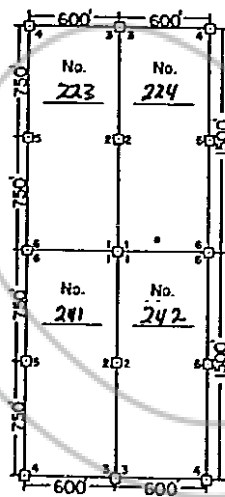

TRUE NORTH

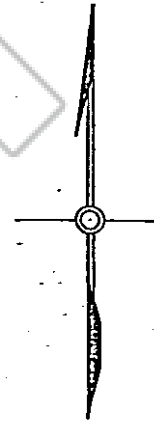

The location work consisted of making the map(s) as provided in NRS 517.040.

Dated and posted on the ground this 24 day of March 19 82.

Witnesses:

RECORDED AT REQUEST OF
AMERICAN SELCO INC
 BOOK 102 PAGE 98

Locator:

82 APR 12 AIO: 29

By

Van R. Sullivan
 Agent for
AMERICAN SELCO INCORPORATED

OFFICIAL RECORDS
 EUREKA COUNTY, NEVADA
 WILLIS A. DEPAOLI-RECORDER
 REC # 84089
 FEE \$ 4.00

BOOK 102 PAGE 98

RELOCATION
 CERTIFICATE OF MINING LOCATION
 LODE CLAIM ON PUBLIC DOMAIN

NOTICE IS HEREBY GIVEN that the St. Pat No. 225 lode mining claim has been relocated by AMERICAN SELCO INCORPORATED, a New York corporation, whose address is 90 West Grove Street, Suite 100, Reno, Nevada 89509. The claim is a relocation of the St. Pat No. 225 lode mining claim, the certificate of location of which is of record in the office of the Recorder of Eureka County, Nevada in Book 88 Page 509 in accordance with N.R.S. 517.080. The general course of this claim is North/South. This claim is 1500 feet in length along the course of the claim, being 1490 feet from the point of discovery in a North direction to the North end line of this claim, and 10 feet in a South direction to the South end line of the claim. This claim is 600 feet in width, being 300 feet in width on each side of the center line of the claim.

This claim is located all or in part in the following quarter section(s), township(s) and range(s):

SE 1/4, Section 9, T 17 N., R 52 E., M.D.B & M.
1/4, Section , T N., R E., M.D.B & M.
1/4, Section , T N., R E., M.D.B & M.
1/4, Section , T N., R E., M.D.B & M.

in Eureka Mining District, Eureka County, Nevada. The location monument of this claim is situated with reference to some natural object or permanent monument as follows: Corner No. 1 of this claim is located approximately 24,300 feet S 50° W of the located SE corner of Section 36 T 18N, R52E MDM.

The corners of this claim are marked by 4" by 4" x 5' wood posts, 4" diameter x 5' plastic pipe, or 4" trees with metal tags inscribed with the appropriate corner number as shown on the following sketch and accompanying claim map(s).

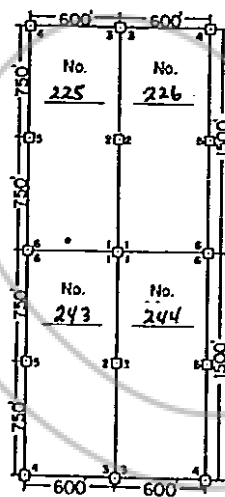

TRUE NORTH

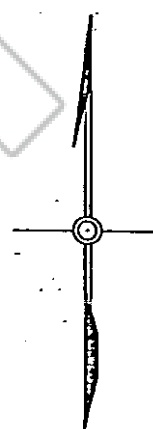

The location work consisted of making the map(s) as provided in NRS 517.040.

Dated and posted on the ground this 24 day of March 19 82.

Witnesses:

RECORDED AT REQUEST OF
AMERICAN SELCO INC
 BOOK 102 PAGE 997

Locator:

82 APR 12 AID: 29

By

Van R. Stenhouse
 Agent for
 AMERICAN SELCO INCORPORATED

OFFICIAL RECORDS
 EUREKA COUNTY, NEVADA
 WILLIS A. DEPAOLI - RECORDER
 FILE NO. 84090
 FEE \$ 4.00

BOOK 102 PAGE 99

RELOCATION
CERTIFICATE OF MINING LOCATION
LODE CLAIM ON PUBLIC DOMAIN

NOTICE IS HEREBY GIVEN that the St. Pat No. 226 lode mining claim has been relocated by AMERICAN SELCO INCORPORATED, a New York corporation, whose address is 90 West Grove Street, Suite 100, Reno, Nevada 89509. The claim is a relocation of the St. Pat No. 226 lode mining claim, the certificate of location of which is of record in the office of the Recorder of Eureka County, Nevada in Book 88 Page 510 in accordance with N.R.S. 517.080. The general course of this claim is North/South. This claim is 1500 feet in length along the course of the claim, being 1490 feet from the point of discovery in a North direction to the North end line of this claim, and 10 feet in a South direction to the South end line of the claim. This claim is 600 feet in width, being 300 feet in width on each side of the center line of the claim.

This claim is located all or in part in the following quarter section(s), township(s) and range(s):

SE 1/4, Section 9, T 17 N., R 52 E., M.D.B & M.
1/4, Section , T N., R E., M.D.B & M.
1/4, Section , T N., R E., M.D.B & M.
1/4, Section , T N., R E., M.D.B & M.

in Eureka Mining District, Eureka County, Nevada. The location monument of this claim is situated with reference to some natural object or permanent monument as follows: Corner No. 1 of this claim is located approximately 24,300 feet S 50° W of the located SE corner of Section 36 T18N, R52E MDM.

The corners of this claim are marked by 4" by 4" x 5' wood posts, 4" diameter x 5' plastic pipe, or 4" trees with metal tags inscribed with the appropriate corner number as shown on the following sketch and accompanying claim map(s).

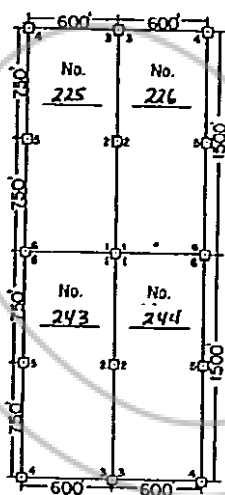

TRUE NORTH

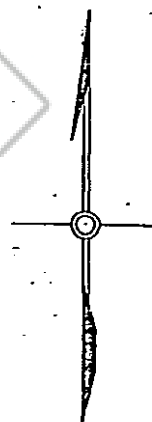

The location work consisted of making the map(s) as provided in NRS 517.040.

Dated and posted on the ground this 24 day of March 19 82.

Witnesses:

RECORDED AT REQUEST OF
AMERICAN SELCO INC
BOOK 102 PAGE 100

Locator:

82 APR 12 AIO: 29

By Van R. Smith
Agent for
AMERICAN SELCO INCORPORATED

OFFICIAL RECORDS
EUREKA COUNTY, NEVADA
WILLIS A. DEPAUL - RECORDER
FILE NO. 84091
FEE \$ 4.00

BOOK 102 PAGE 100

RELOCATION
CERTIFICATE OF MINING LOCATION
LODE CLAIM ON PUBLIC DOMAIN

NOTICE IS HEREBY GIVEN that the St. Pat No. 231 lode mining claim has been relocated by AMERICAN SELCO INCORPORATED, a New York corporation, whose address is 90 West Grove Street, Suite 100, Reno, Nevada 89509. The claim is a relocation of the St. Pat No. 231 lode mining claim, the certificate of location of which is of record in the office of the Recorder of Eureka County, Nevada in Book 91 Page 464 in accordance with N.R.S. 517.080. The general course of this claim is North/South. This claim is 1500 feet in length along the course of the claim, being 1490 feet from the point of discovery in a North direction to the North end line of this claim, and 10 feet in a South direction to the South end line of the claim. This claim is 600 feet in width, being 300 feet in width on each side of the center line of the claim.

This claim is located all or in part in the following quarter section(s), township(s) and range(s):

<u>SW</u>	<u>1/4</u>	Section <u>8</u>	T	<u>17</u>	N.	R	<u>52</u>	E.	M.D.B & M.
	<u>1/4</u>	Section <u> </u>	T	<u> </u>	N.	R	<u> </u>	E.	M.D.B & M.
	<u>1/4</u>	Section <u> </u>	T	<u> </u>	N.	R	<u> </u>	E.	M.D.B & M.
	<u>1/4</u>	Section <u> </u>	T	<u> </u>	N.	R	<u> </u>	E.	M.D.B & M.

in Eureka Mining District, Eureka County, Nevada. The location monument of this claim is situated with reference to some natural object or permanent monument as follows: Corner No. 1 of this claim is located approximately 2,200 feet S64° W from the SE corner of Section 36 T18N, R52E, MDM. 20200

The corners of this claim are marked by 4" by 4" x 5' wood posts, 4" diameter x 5' plastic pipe, or 4" trees with metal tags inscribed with the appropriate corner number as shown on the following sketch and accompanying claim map(s).

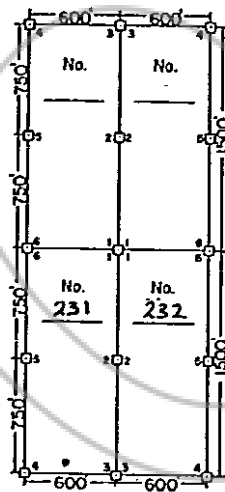

TRUE NORTH

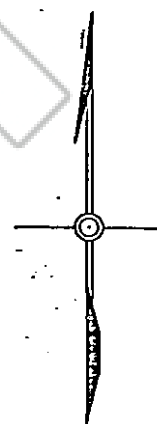

The location work consisted of making the map(s) as provided in NRS 517.040.

Dated and posted on the ground this 25 day of March 19 82.

Witnesses:

RECORDED AT REQUEST OF
AMERICAN SELCO INC Locator:
BOOK 102 PAGE 101

82 APR 12 A10:20

By Van R. Sullivan
Agent for
AMERICAN SELCO INCORPORATED

OFFICIAL RECORDS
EUREKA COUNTY, NEVADA
WILLIS A. GUNDEL, RECORDER
FILE NO. 84092
FEE \$ 4.00

BOOK 102 PAGE 101

**RELOCATION
CERTIFICATE OF MINING LOCATION
LODE CLAIM ON PUBLIC DOMAIN**

NOTICE IS HEREBY GIVEN that the St. Pat No. 288 lode mining claim has been relocated by AMERICAN SELCO INCORPORATED, a New York corporation, whose address is 90 West Grove Street, Suite 100, Reno, Nevada 89509. The claim is a relocation of the St. Pat No. 288 lode mining claim, the certificate of location of which is of record in the office of the Recorder of Eureka County, Nevada in Book 88 Page 571 in accordance with N.R.S. 517.080. The general course of this claim is North/South. This claim is 1500 feet in length along the course of the claim, being 1490 feet from the point of discovery in a North direction to the North end line of this claim, and 10 feet in a South direction to the South end line of the claim. This claim is 600 feet in width, being 300 feet in width on each side of the center line of the claim.

This claim is located all or in part in the following quarter section(s), township(s) and range(s):

<u>SE</u>	<u>1/4</u> , Section <u>17</u>	, T <u>17</u> N., R <u>52</u> E.,	M.D.B & M.
	<u>1/4</u> , Section	, T N., R E.,	M.D.B & M.
	<u>1/4</u> , Section	, T N., R E.,	M.D.B & M.
	<u>1/4</u> , Section	, T N., R E.,	M.D.B & M.

in Eureka Mining District, Eureka County, Nevada. The location monument of this claim is situated with reference to some natural object or permanent monument as follows: Corner No. 1 of this claim is located approximately 23,800 feet S 48° W of the located SE corner of Section 36 T18N, R52E MDM.

The corners of this claim are marked by 4" by 4" x 5' wood posts, 4" diameter x 5' plastic pipe, or 4" trees with metal tags inscribed with the appropriate corner number as shown on the following sketch and accompanying claim map(s).

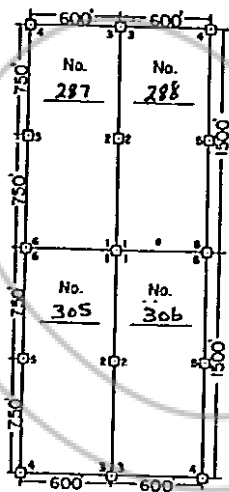

The location work consisted of making the map(s) as provided in NRS 517.040.

Dated and posted on the ground this 25 day of March 19 82.

Witnesses:

RECORDED AT REQUEST OF
AMERICAN SELCO INC Locator:
BOOK 102 PAGE 102

82 APR 12 A10: 29

By Van R. Smith
Agent for
AMERICAN SELCO INCORPORATED

OFFICIAL RECORDS
EUREKA COUNTY, NEVADA
WILLIS A. DEPAUL RECORDER
FILE # 84093
FEE \$ 4.00

BOOK 102 PAGE 102

RELOCATION
CERTIFICATE OF MINING LOCATION
LODE CLAIM ON PUBLIC DOMAIN

NOTICE IS HEREBY GIVEN that the St. Pat No. 289 lode mining claim has been relocated by AMERICAN SELCO INCORPORATED, a New York corporation, whose address is 90 West Grove Street, Suite 100, Reno, Nevada 89509. The claim is a relocation of the St. Pat No. 289 lode mining claim, the certificate of location of which is of record in the office of the Recorder of Eureka County, Nevada in Book 88 Page 572 in accordance with N.R.S. 517.080. The general course of this claim is North/South. This claim is 1500 feet in length along the course of the claim, being 1490 feet from the point of discovery in a North direction to the North end line of this claim, and 10 feet in a South direction to the South end line of the claim. This claim is 600 feet in width, being 300 feet in width on each side of the center line of the claim.

This claim is located all or in part in the following quarter section(s), township(s) and range(s):

SE 1/4, Section 17, T 17 N., R 52 E., M.D.B & M.
1/4, Section , T N., R E., M.D.B & M.
1/4, Section , T N., R E., M.D.B & M.
1/4, Section , T N., R E., M.D.B & M.
 in Eureka Mining District, Eureka County, Nevada. The location monument of this claim is situated with reference to some natural object or permanent monument as follows: Corner No. 1 of this claim is located approximately 22,800 feet S 45° W of the located SE corner of Section 36 T18N, R52E MDM.

The corners of this claim are marked by 4" by 4" x 5' wood posts, 4" diameter x 5' plastic pipe, or 4" trees with metal tags inscribed with the appropriate corner number as shown on the following sketch and accompanying claim map(s).

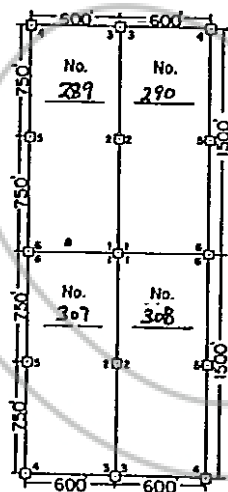

TRUE NORTH

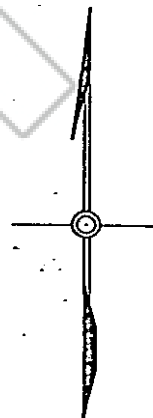

The location work consisted of making the map(s) as provided in NRS 517.040.

Dated and posted on the ground this 25 day of March 19 82.

Witnesses:

RECORDED AT REQUEST OF
AMERICAN SELCO INC
BOOK 102 PAGE 103

Locator:

82 APR 12 AIO: 28

By Van R. Bradley
Agent for
AMERICAN SELCO INCORPORATED
BOOK 102 PAGE 103

OFFICIAL RECORDS
EUREKA COUNTY, NEVADA
WILLIS A. DEPAOLI - RECORDER
FILE # 84094
FEE \$ 4.00

**RELOCATION
CERTIFICATE OF MINING LOCATION
LODE CLAIM ON PUBLIC DOMAIN**

NOTICE IS HEREBY GIVEN that the St. Pat No. 290 lode mining claim has been relocated by AMERICAN SELCO INCORPORATED, a New York corporation, whose address is 90 West Grove Street, Suite 100, Reno, Nevada 89509. The claim is a relocation of the St. Pat No. 290 lode mining claim, the certificate of location of which is of record in the office of the Recorder of Eureka County, Nevada in Book 88 Page 573 in accordance with N.R.S. 517.080. The general course of this claim is North/South. This claim is 1500 feet in length along the course of the claim, being 1490 feet from the point of discovery in a North direction to the North end line of this claim, and 10 feet in a South direction to the South end line of the claim. This claim is 600 feet in width, being 300 feet in width on each side of the center line of the claim.

This claim is located all or in part in the following quarter section(s), township(s) and range(s):

SE 1/4, Section 17, T 17 N., R 52 E., M.D.B & M.
1/4, Section 17, T 17 N., R 52 E., M.D.B & M.
1/4, Section 17, T 17 N., R 52 E., M.D.B & M.
1/4, Section 17, T 17 N., R 52 E., M.D.B & M.
 in Eureka Mining District, Eureka County, Nevada. The location monument of this claim is situated with reference to some natural object or permanent monument as follows: Corner No. 1 of this claim is located approximately 22,800 feet S 45° W of the located SE corner of Section 36 T18N, R52E MDM.

The corners of this claim are marked by 4" by 4" x 5' wood posts, 4" diameter x 5' plastic pipe, or 4" trees with metal tags inscribed with the appropriate corner number as shown on the following sketch and accompanying claim map(s).

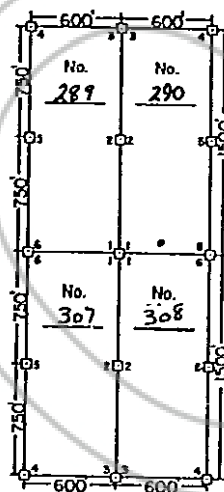

TRUE NORTH

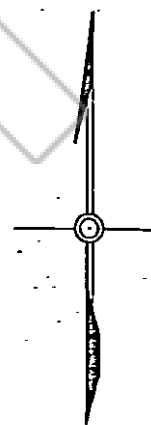

The location work consisted of making the map(s) as provided in NRS 517.040.

Dated and posted on the ground this 25 day of March 19 82.

Witnesses:

RECORDED AT REQUEST OF
AMERICAN SELCO INC
BOOK 102 PAGE 104

Locator:

82 APR 12 AIO: 29

By Van R. Hurlburt
Agent for
AMERICAN SELCO INCORPORATED

OFFICIAL RECORDS
EUREKA COUNTY, NEVADA
WILLIS A. DEPAULI, RECORDER
FILE # 84095
FEE \$ 4.00

BOOK 102 PAGE 104

**RELOCATION
CERTIFICATE OF MINING LOCATION
LODE CLAIM ON PUBLIC DOMAIN**

NOTICE IS HEREBY GIVEN that the St. Pat No. 306 lode mining claim has been relocated by AMERICAN SELCO INCORPORATED, a New York corporation, whose address is 90 West Grove Street, Suite 100, Reno, Nevada 89509. The claim is a relocation of the St. Pat No. 306 lode mining claim, the certificate of location of which is of record in the office of the Recorder of Eureka County, Nevada in Book 88 Page 588 in accordance with N.R.S. 517.080. The general course of this claim is North/South. This claim is 1500 feet in length along the course of the claim, being 10 feet from the point of discovery in a North direction to the North end line of this claim, and 1490 feet in a South direction to the South end line of the claim. This claim is 600 feet in width, being 300 feet in width on each side of the center line of the claim.

This claim is located all or in part in the following quarter section(s), township(s) and range(s):

NE 1/4, Section 20, T 17 N., R 52 E., M.D.B & M.
1/4, Section , T N., R E., M.D.B & M.
1/4, Section , T N., R E., M.D.B & M.
1/4, Section , T N., R E., M.D.B & M.

in Eureka Mining District, Eureka County, Nevada. The location monument of this claim is situated with reference to some natural object or permanent monument as follows: Corner No. 1 of this claim is located approximately 23,800 feet S 48° W of the located SE corner of Section 36 T18N, R52E MDM.

The corners of this claim are marked by 4" by 4" x 5' wood posts, 4" diameter x 5' plastic pipe, or 4" trees with metal tags inscribed with the appropriate corner number as shown on the following sketch and accompanying claim map(s).

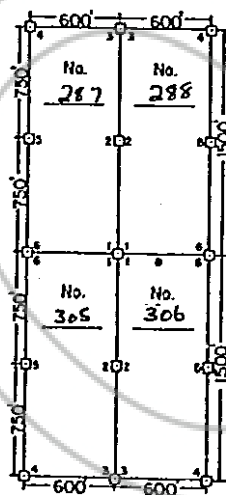

TRUE NORTH

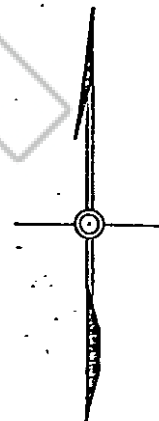

The location work consisted of making the map(s) as provided in NRS 517.040.

Dated and posted on the ground this 25 day of March 19 82.

Witnesses:

RECORDED AT REQUEST OF
AMERICAN SELCO INC
BOOK 102 PAGE 105

Locator:

82 APR 12 410: 28

By Van R. Shultz
Agent for
AMERICAN SELCO INCORPORATED

OFFICIAL RECORDS
EUREKA COUNTY, NEVADA
WILLIS A. DEPAULI-RECORDER
FILE NO. 84096
FEE \$ 4.00

BOOK 102 PAGE 105

RELOCATION
 CERTIFICATE OF MINING LOCATION
 LOSE CLAIM ON PUBLIC DOMAIN

NOTICE IS HEREBY GIVEN that the St. Pat No. 307 lode mining claim has been relocated by AMERICAN SELCO INCORPORATED, a New York corporation, whose address is 90 West Grove Street, Suite 100, Reno, Nevada 89509. The claim is a relocation of the St. Pat No. 307 lode mining claim, the certificate of location of which is of record in the office of the Recorder of Eureka County, Nevada in Book 88 Page 590 in accordance with N.R.S. 517.080. The general course of this claim is North/South. This claim is 1500 feet in length along the course of the claim, being 10 feet from the point of discovery in a North direction to the North end line of this claim, and 1490 feet in a South direction to the South end line of the claim. This claim is 600 feet in width, being 300 feet in width on each side of the center line of the claim.

This claim is located all or in part in the following quarter section(s), township(s) and range(s):

NE 1/4, Section 20, T 17 N., R 52 E., M.D.B & M.
1/4, Section , T N., R E., M.D.B & M.
1/4, Section , T N., R E., M.D.B & M.
1/4, Section , T N., R E., M.D.B & M.
 in Eureka Mining District, Eureka County, Nevada. The location monument of this claim is situated with reference to some natural object or permanent monument as follows: Corner No. 1 of this claim is located approximately 22,800 feet S 45° W of the located SE corner of Section 36 T18N, R52E MDM.

The corners of this claim are marked by 4" by 4" x 5' wood posts, 4" diameter x 5' plastic pipe, or 4" trees with metal tags inscribed with the appropriate corner number as shown on the following sketch and accompanying claim map(s).

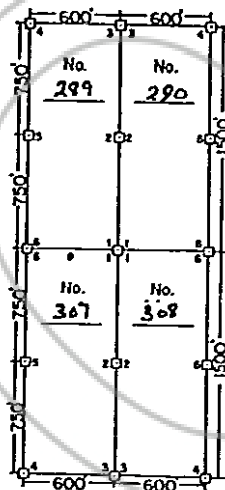

TRUE NORTH

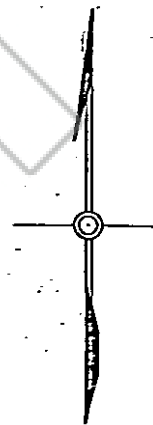

The location work consisted of making the map(s) as provided in NRS 517.040.

Dated and posted on the ground this 25 day of March 19 82.

Witnesses:

RECORDED AT REQUEST OF
AMERICAN SELCO INC
 BOOK 102 PAGE 106

Locator:

82 APR 12 AIO: 30

By Van R. Shively
 Agent for
AMERICAN SELCO INCORPORATED

OFFICIAL RECORDS
 EUREKA COUNTY, NEVADA
 WILLIS A. DEFAUILL-RECORDER
 FILE NO. 84097
 FEE \$ 4.00

BOOK 102 PAGE 106

84098

RELOCATION
 CERTIFICATE OF MINING LOCATION
 LOPE CLAIM ON PUBLIC DOMAIN

NOTICE IS HEREBY GIVEN that the St. Pat No. 308 lode mining claim has been relocated by AMERICAN SELCO INCORPORATED, a New York corporation, whose address is 90 West Grove Street, Suite 100, Reno, Nevada 89509. The claim is a relocation of the St. Pat No. 308 lode mining claim, the certificate of location of which is of record in the office of the Recorder of Eureka County, Nevada in Book 88 Page 591 in accordance with N.R.S. 517.080. The general course of this claim is North/South. This claim is 1500 feet in length along the course of the claim, being 10 feet from the point of discovery in a North direction to the North end line of this claim, and 1490 feet in a South direction to the South end line of the claim. This claim is 600 feet in width, being 300 feet in width on each side of the center line of the claim.

This claim is located all or in part in the following quarter section(s), township(s) and range(s):

NE 1/4, Section 20, T 17 N., R 52 E., M.D.B & M.
 1/4, Section , T N., R E., M.D.B & M.
 1/4, Section , T N., R E., M.D.B & M.
 1/4, Section , T N., R E., M.D.B & M.

in Mining District, County, Nevada. The location monument of this claim is situated with reference to some natural object or permanent monument as follows: Corner No. 1 of this claim is located approximately 21,900 feet S 43° W of the located SE corner of Section 36 T18N, R52E MDM.

The corners of this claim are marked by 4" by 4" x 5' wood posts, 4" diameter x 5' plastic pipe, or 4" trees with metal tags inscribed with the appropriate corner number as shown on the following sketch and accompanying claim map(s).

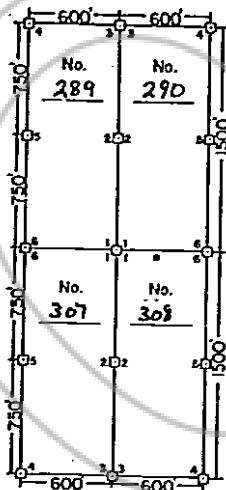

TRUE NORTH

The location work consisted of making the map(s) as provided in NRS 517.040.

Dated and posted on the ground this 25 day of March 1982.

Witnesses:

RECORDED AT REQUEST OF
AMERICAN SELCO INC
 BOOK 102 PAGE 107

Locator:

82 APR 12 A10:30

BY Van R. Jewell
 Agent for
 AMERICAN SELCO INCORPORATED

OFFICIAL RECORDS
 EUREKA COUNTY, NEVADA
 WILLIS A. DEPAUL RECORDER
 FILE NO. 84098
 FEE \$ 4.00

BOOK 102 PAGE 107