

85084
Affidavit of Performance of Annual
Assessment Work
(Proof of Labor)

State of Nevada)
County of White Pine) ss

August 10, 1982

Dennis J. Sestanovich, whose address is P. O. Box 14, Ruth, Nevada 89319, being first sworn, on behalf of the owner, states that at least one hundred dollars in value of labor was performed or improvements made upon or for the direct benefit of each of the following unpatented lode mining claims located in Eureka County, Nevada, to wit:

<u>Claim Name</u>	<u>BLM Serial Number</u>	<u>Location Notice Recorded</u>	
		<u>Book</u>	<u>Page</u>
Jennie Nos. 1-6	203227-203332	95	486-491

That labor was performed and improvements were made between September 1, 1982 and September 1, 1982 for the assessment year ending September 1, 1982. The amount of money expended for such labor and improvements was at least \$600.00 and the character of the expenditures, labor and improvements is as follows:

Geologic mapping and rock sampling.

The owners of the claims are Leo G. and Mary C. Damele, Eureka, Nevada 89316, Peter A. and Jenny L. Edera, Eureka, Nevada 89316, and Lincoln J. and Margaret Holly, Eureka, Nevada 89316. The expenditures were made at the expense of American Selco Incorporated for the benefit of the owners. The person(s), corporation(s), contractor(s), or subcontractor(s) who performed the work or made the improvements is Allyn Niles, Ely, Nevada and Steve Sutherland, Ely, Nevada

Dennis Sestanovich
Affiant

Mary Ingle
Witness

Harvey L. Morgan
Witness

Subscribed and sworn to before me this 10 day of August, 1982, by Dennis Sestanovich
(SEAL)

Sandra K. Williams
Notary Public

BOOK 104 PAGE 206

My commission expires:

Dec. 23, 1985



REPORT OF MINERAL EXPLORATION ACTIVITIES
 CONDUCTED ON THE Jennie CLAIM(S)
Eureka COUNTY, Nevada

The location of the work performed in relation to the point of discovery and boundaries of the claim(s): Performed within the outside perimeter of the group of 6 claims.

Nature or type of work performed: Geologic mapping and rock chip sampling.

Extent of work performed: Entire claim group was mapped and 37 rock chip samples were taken.

Cost of work performed: \$600.00

Basic findings of work performed: The geologic mapping and rock chip sampling defined an area of mineralization and laid the groundwork for additional mineral exploration activity.

Person or persons conducting the work:

Name	Address	Professional Background
<u>Allyn Niles</u>	<u>Ely, Nevada</u>	<u>Geologist</u>
<u>Steve Sutherland</u>	<u>Ely, Nevada</u>	<u>Geologist</u>

Such survey has not been applied as labor for more than two consecutive years or for more than a total of five years on any one mining claim, and such survey has been nonrepetitive of any previous survey on the same claim.

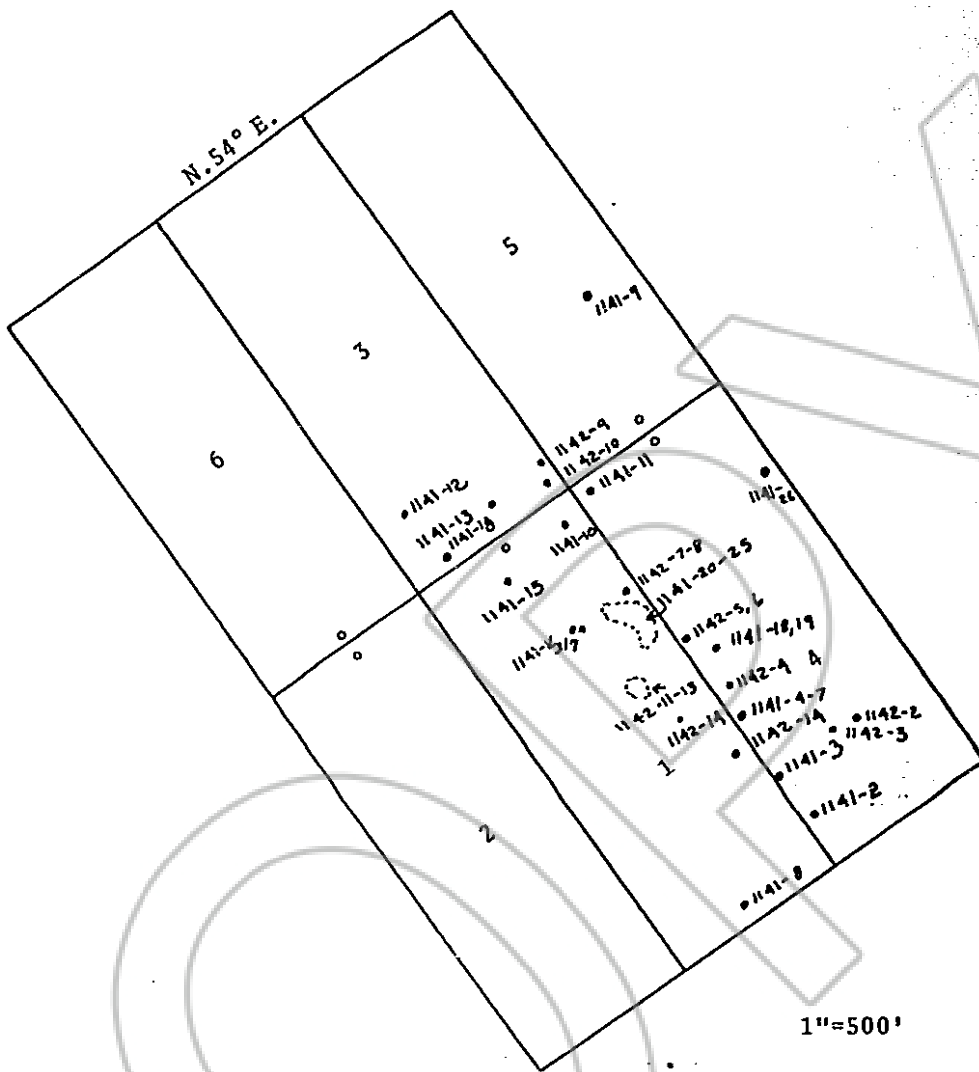

1"=500'

RECORDED AT REQUEST OF
American Selco Inc.
 BOOK 104 PAGE 206

82 AUG 12 10:27

JENNIE CLAIM GROUP
 T.19 N., R.52 E.
 Eureka County, Nevada

- Location Monuments
- Rock Sample Locations

OFFICIAL RECORDS
 EUREKA COUNTY, NEVADA
 WILLIS A. DEPAOLI - RECORDER
 FILE NO. 85084
 FEE \$ 3.00