

CERTIFICATE OF MINING LOCATION
LODE CLAIM ON PUBLIC DOMAIN

NOTICE IS HEREBY GIVEN that the COAL No. 45 lode mining claim has been located by AMSELCO EXPLORATION, INC. whose address is 90 WEST GROVE, RENO, NEV.

The general course of this claim is NORTH-SOUTH. This claim is 1500 feet in length along the course of the claim, being 1480 feet from the point of discovery in a NORTH direction to the NORTH end line of this claim, and 20 feet in a SOUTH direction to the SOUTH end line of the claim. This claim is 600 feet in width, being 300 feet in width on each side of the center line of the claim.

This claim is located all or in part in the following quarter section(s), township(s) and range(s):

SW 1/4, Section 20, T 25 N., R 49 E., M.D.B & M.
NW 1/4, Section 29, T 25 N., R 49 E., M.D.B & M.
1/4, Section _____, T 25 N., R 49 E., M.D.B & M.
1/4, Section _____, T 25 N., R 49 E., M.D.B & M.

in UNKNOWN Mining District, ELUREKA County, Nevada. The location monument of this claim is situated with reference to some natural object or permanent monument as follows: 11280 FEET SOUTH AND 4650 FEET WEST FROM THE NE COR. OF SEC. 17, T25N, R49E, M.D.B. & M.

The corners of this claim are marked by 4" by 4" x 5' wood posts, 4" diameter x 5' plastic pipe, or 4" trees with metal tags inscribed with the appropriate corner number as shown on the following sketch and accompanying claim map(s).

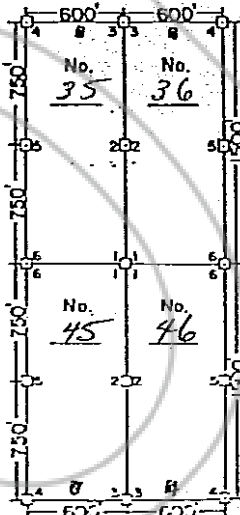

The location work consisted of making the map(s) as provided in NRS 517.040.

Dated and posted on the ground this 15th day of SEPT. 19 82.

Witnesses:

RECORDED AT REQUEST OF
AMERICAN SELCO, INC
BOOK 105 PAGE 427

82 SEP 22 A 11:21

OFFICIAL RECORDS
EUREKA COUNTY, NEVADA
WILLIS A. DEPAOLI, RECORDER
FILE NO. 85434
FEE \$ 4.00

Locator: AMSELCO EXPLORATION, INC.
90 WEST GROVE RENO, NEV.

By Frank Collins
Agent for
FRANK COLLINS