

**CERTIFICATE OF MINING LOCATION
LODE CLAIM ON PUBLIC DOMAIN**

NOTICE IS HEREBY GIVEN that the COAL No. 46 lode mining claim has been located by AMSELCO EXPLORATION, INC. whose address is 90 WEST GROVE, RENO, NEV.

The general course of this claim is NORTH-SOUTH. This claim is 1500 feet in length along the course of the claim, being 1480 feet from the point of discovery in a NORTH direction to the NORTH end line of this claim, and 20 feet in a SOUTH direction to the SOUTH end line of the claim. This claim is 600 feet in width, being 300 feet in width on each side of the center line of the claim.

This claim is located all or in part in the following quarter section(s), township(s) and range(s):

<u>SW</u>	<u>1/4</u> , Section <u>20</u> , T <u>25</u> N., R <u>49</u> E., M.D.B. & M.
<u>NW</u>	<u>1/4</u> , Section <u>29</u> , T <u>25</u> N., R <u>49</u> E., M.D.B. & M.
	<u>1/4</u> , Section <u>38</u> , T <u>25</u> N., R <u>49</u> E., M.D.B. & M.
	<u>1/4</u> , Section <u>47</u> , T <u>25</u> N., R <u>49</u> E., M.D.B. & M.

in UNKNOWN Mining District, ELUREKA County, Nevada. The location monument of this claim is situated with reference to some natural object or permanent monument as follows: 11280 FEET SOUTH AND 4050 FEET WEST FROM THE NE COR. OF SEC. 17, T.25N., R.49E., M.D.B. & M.

The corners of this claim are marked by 4" by 4" x 5' wood posts, 4" diameter x 5' plastic pipe, or 4" trees with metal tags inscribed with the appropriate corner number as shown on the following sketch and accompanying claim map(s).

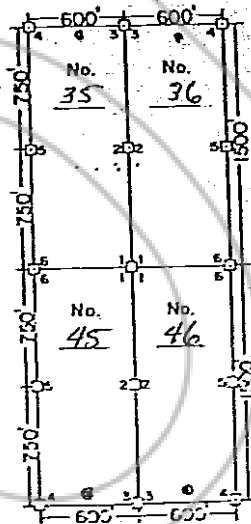

The location work consisted of making the map(s) as provided in NRS 517.040.

Dated and posted on the ground this 1st day of SEPT. 19 82.

Witnesses:

Locator: AMSELCO EXPLORATION, INC.
90 WEST GROVE RENO, NEV.

By

Agent for

FRANK COLLINS

RECORDED AT REQUEST OF
AMERICAN SELCO, INC.
BOOK 105 PAGE 428

82 SEP 22 AM 1:21

OFFICIAL RECORDS
EUREKA COUNTY, CALIFORNIA
WILLIS A. DEPAOLI - RECORDER
FILE NO. 85435
FEE \$ 44.00

BOOK 105 PAGE 428