

CERTIFICATE OF MINING LOCATION  
LODE CLAIM ON PUBLIC DOMAIN

NOTICE IS HEREBY GIVEN that the COAL No. 59 lode mining claim has been located by AMSELCO EXPLORATION, INC. whose address is 90 WEST GROVE, RENO, NEV.

The general course of this claim is NORTH-SOUTH. This claim is 1500 feet in length along the course of the claim, being 20 feet from the point of discovery in a NORTH direction to the NORTH end line of this claim, and 1480 feet in a SOUTH direction to the SOUTH end line of the claim. This claim is 600 feet in width, being 300 feet in width on each side of the center line of the claim.

This claim is located all or in part in the following quarter section(s), township(s) and range(s):

- NE 1/4, Section 29, T 25 N., R 49 E., M.D.B. & M.
- 1/4, Section \_\_\_\_\_, T 25 N., R 49 E., M.D.B. & M.
- 1/4, Section \_\_\_\_\_, T 25 N., R 49 E., M.D.B. & M.
- 1/4, Section \_\_\_\_\_, T 25 N., R 49 E., M.D.B. & M.

in UNKNOWN Mining District, EVREKA County, Nevada. The location monument of this claim is situated with reference to some natural object or permanent monument as follows: 11320 FEET SOUTH AND 2250 FEET WEST FROM THE NE COR. OF SEC. 17, T25N, R49E, M.D.B. & M.

The corners of this claim are marked by 4" by 4" x 5" wood posts, 4" diameter x 5' plastic pipe, or 4" trees with metal tags inscribed with the appropriate corner number as shown on the following sketch and accompanying claim map(s).

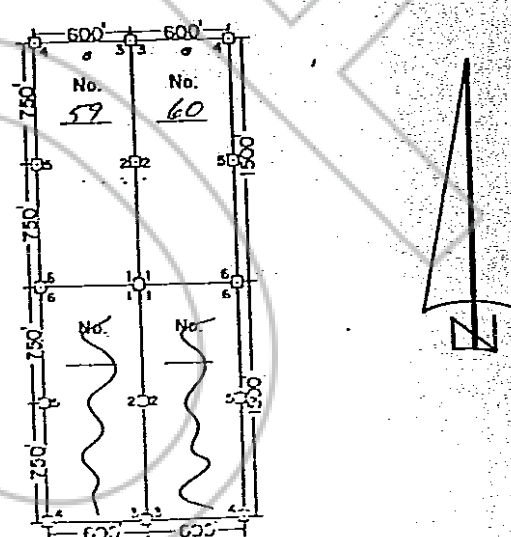

The location work consisted of making the map(s) as provided in NRS 517.040.

Dated and posted on the ground this 1st day of SEPT

RECORDED AT REQUEST OF  
**AMERICAN SELCO, INC.**  
BOOK 05 PAGE 447

82 SEP 22 AM 11:22

OFFICIAL RECORDS  
EVREKA COUNTY, NEVADA  
WILLIS A. DEPAUL - RECORDER  
FILE NO. 85448  
FEE \$ 7.00

Locator: AMSELCO EXPLORATION, INC.  
90 WEST GROVE RENO, NEV.

By Frank Collins  
Agent for  
FRANK COLLINS