

CERTIFICATE OF MINING LOCATION  
LODE CLAIM ON PUBLIC DOMAIN

NOTICE IS HEREBY GIVEN that the SEL RAT No. 386 lode mining claim has been located by AMSELCO EXPLORATION INC., a Delaware corporation, whose address is 90 West Grove Street, Suite 100, Reno, Nevada 89509. The general course of this claim is North & South. This claim is 1500 feet in length along the course of the claim, being 20 feet from the point of discovery in a N direction to the N end line of this claim, and 1480 feet in a S direction to the S end line of the claim. This claim is 600 feet in width, being 300 feet in width on each side of the center line of the claim.

This claim is located all or in part in the following quarter section(s), township(s) and range(s):

<u>NW</u> 1/4, Section <u>35</u> , T <u>18</u> N., R <u>53</u> E., M.D.B & M.
<u>SW</u> 1/4, Section <u>35</u> , T <u>18</u> N., R <u>53</u> E., M.D.B & M.
1/4, Section _____, T _____ N., R _____ E., M.D.B & M.
1/4, Section _____, T _____ N., R _____ E., M.D.B & M.

in unknown Mining District, Eureka County, Nevada. The location monument of this claim is situated with reference to some natural object or permanent monument as follows: Approximately S38°E and 4900 ft. from claim location marker SR-1. The claim location marker SR-1, a 3"x6' steel pipe, is located approximately as follows: 1.93 miles N76°E from Grays Peak; 0.55 miles S27°W from Surprise Peak; 2.50 miles N8°E from South Hill.

The corners of this claim are marked by 4" by 4" x 5' wood posts, 4" diameter x 5' plastic pipe, or 4" trees with metal tags inscribed with the appropriate corner number as shown on the following sketch and accompanying claim map(s).

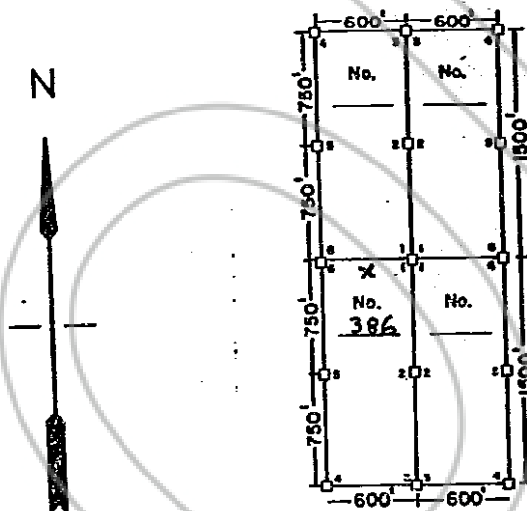

RECORDED AT REQUEST OF  
**AMERICAN SELCO INC**  
BOOK 107 PAGE 597

83 FEB 3 AIO: 06

OFFICIAL RECORDS  
EUREKA COUNTY, NEVADA  
M.N. REBALEATI, RECORDER  
FILE NO. 86285  
FEE \$ 4.00

The location work consisted of making the map(s) as provided in NRS 517.040.

Dated and posted on the ground this 16 day of December 1982.

Witnesses:

[Signature]  
[Signature]

Locator: Amselco Exploration Inc.

By [Signature]  
Agent for  
AMSELCO EXPLORATION INC.

BOOK 107 PAGE 597