

**CERTIFICATE OF MINING LOCATION
LODE CLAIM ON PUBLIC DOMAIN**

NOTICE IS HEREBY GIVEN that the SEL RAT No. 396 lode mining claim has been located by AMSELCO EXPLORATION INC., a Delaware corporation, whose address is 90 West Grove Street, Suite 100, Reno, Nevada 89509. The general course of this claim is North & South. This claim is 1500 feet in length along the course of the claim, being 20 feet from the point of discovery in a North direction to the North end line of this claim, and 1480 feet in a South direction to the South end line of the claim. This claim is 600 feet in width, being 300 feet in width on each side of the center line of the claim.

This claim is located all or in part in the following quarter section(s), township(s) and range(s):

<u>NE</u>	<u>1/4</u> , Section	<u>27</u>	, T. <u>18</u>	N., R. <u>53</u>	E., M.D.B & M.
<u>SE</u>	<u>1/4</u> , Section	<u>27</u>	, T. <u>18</u>	N., R. <u>53</u>	E., M.D.B & M.
	<u>1/4</u> , Section		, T. <u></u>	N., R. <u></u>	E., M.D.B & M.
	<u>1/4</u> , Section		, T. <u></u>	N., R. <u></u>	E., M.D.B & M.

in unknown Mining District, Eureka County, Nevada. The location monument of this claim is situated with reference to some natural object or permanent monument as follows: Approximately N1°W and 1600 ft. from claim location marker SR-1. The claim location marker SR-1, a 3"x6" steel pipe, is located approximately as follows: 1.93 miles N76°E from Grays Peak; 0.55 miles S27°W from Surprise Peak; 2.50 miles N8°E from South Hill.

The corners of this claim are marked by 4" by 4" x 5' wood posts, 4" diameter x 5' plastic pipe, or 4" trees with metal tags inscribed with the appropriate corner number as shown on the following sketch and accompanying claim map(s).

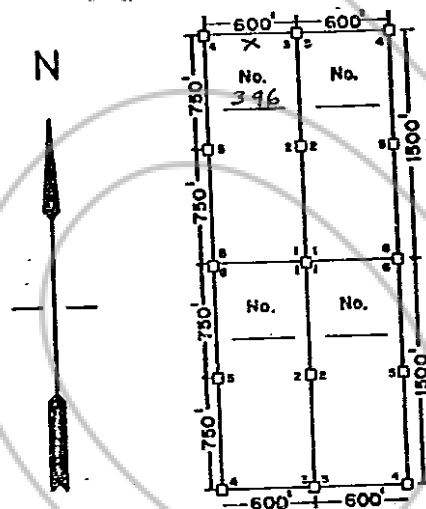

RECORDED AT REQUEST OF
AMERICAN SELCO INC
BOOK 107 PAGE 607

83 FEB 3 A10:06

OFFICIAL RECORDS
EUREKA COUNTY, NEVADA
M.N. REBALEATI, RECORDER
FILE NO. 86295
FEE \$ 4.00

The location work consisted of making the map(s) as provided in NRS 517.040.

Dated and posted on the ground this 10 day of January 1983.

Witnesses:

E. E. Huntz
D. M. Tarr

Locator: Amselco Exploration Inc.

By Dennis S. Semonch
Agent for
AMSELCO EXPLORATION INC.

BOOK 107 PAGE 607