

16

15

14

21

22

23

28

27

26

Adjoins sheet 2

Filed AT THE REQUEST OF **MAPCO MINERALS CORP**
 on Nov 10, 1983, at 52 mins. past 10 A. M. In
 _____, RECORDS OF
 EUREKA COUNTY, NEVADA. M.N. REBALEATI, Recorder
 File No. 90594 Fee \$ 660.00

Corner 2 of claim 23 is approximately 9200 feet along a bearing N07° 14' 31" W from the SE corner of section 34, T22N, R50E.

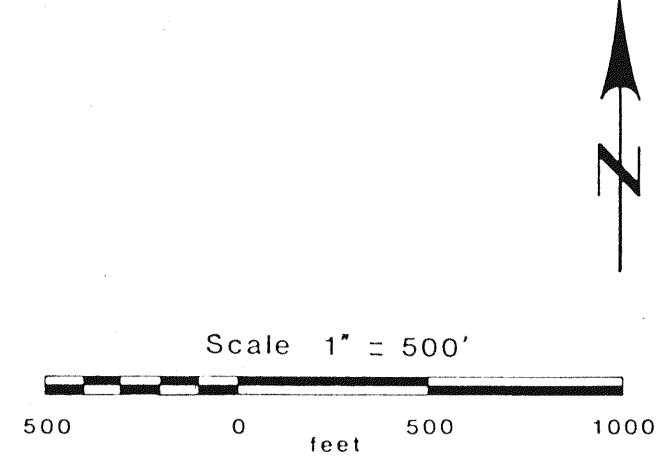

Sheet 1 of 2

Located September 1, 1983, by:
 MAPCO Minerals Corporation
 1667 Cole Blvd. Suite 150
 Golden, CO 80401

JAM LODE CLAIMS
 Sheet 1 of 2
 Secs. 14, 15, 16, 21, 22
 23 & 27, T22N, R50E
 Eureka County, Nevada

Drafting by G. Gale

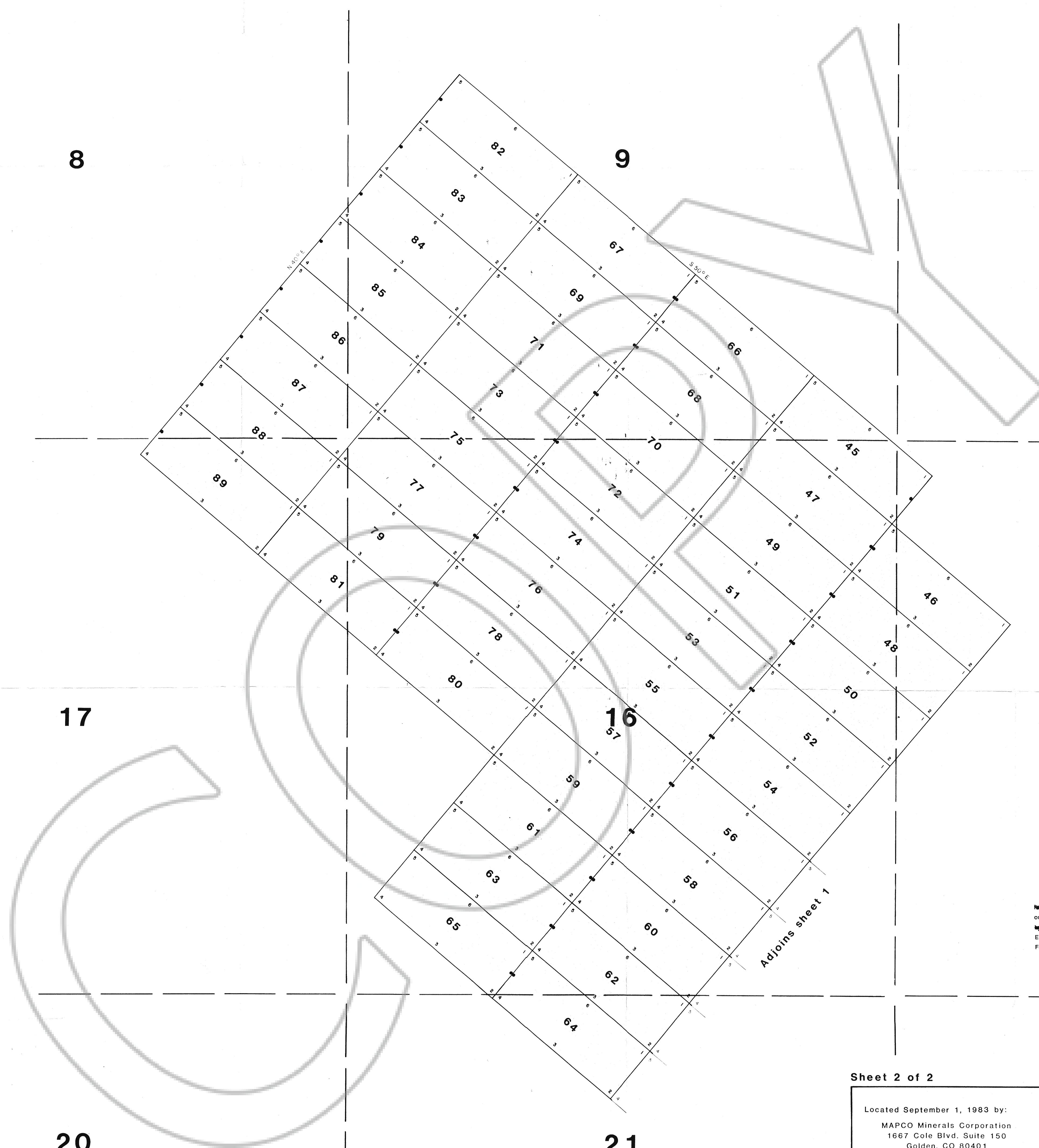

Filed 10/10/83 AT THE REQUEST OF **MAPCO MINERALS CORP**
 on 10/10/83 at 52 mins. past 10 A.M. In
 _____ RECORDS OF
 EUREKA COUNTY, NEVADA. M.H. REBALEATI, Recorder
 File No. 90594 Fee \$ 675.00

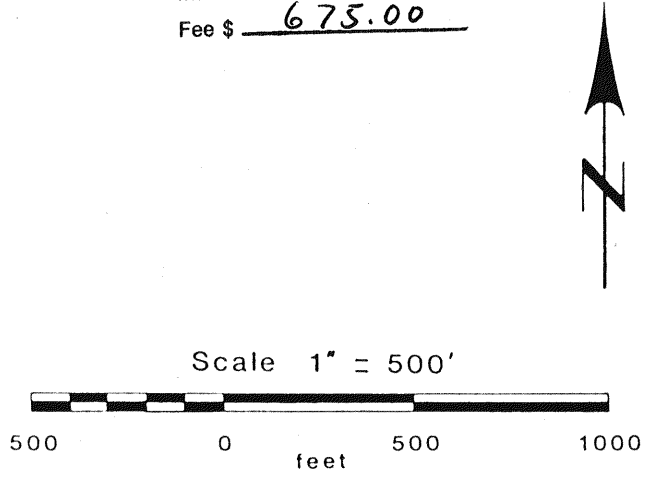

Sheet 2 of 2

Located September 1, 1983 by:
 MAPCO Minerals Corporation
 1667 Cole Blvd. Suite 150
 Golden, CO 80401

Drafting by G. Gale

JAM LODE CLAIMS
 Sheet 2 of 2
 Secs. 8, 9, 15, 16, 17
 & 21, T22N, R50E
 Eureka County, Nevada