

Proof of Performance and Completion of ANNUAL ASSESSMENT WORK

STATE OF COLORADO }
County of JEFFERSON } ss.

The undersigned, in whose behalf the following described work was performed or improvements made, certifies that at least \$3,600.00 Dollars was expended, and/or the following labor expended or improvements made having a value thereof, consisting of:
Seismic geophysical survey (see attached report, Exhibit "B")
(Describe Character and Location of Expenditures or Labor or Improvements)

were performed and made ~~upon~~ for the benefit of DP Nos. 1 - 36, a contiguous
block of claims located in Section 16, T34N, R51E, (See attached
Exhibit "A")
(Insert Name(s) of Claim(s))

situated in the unknown Mining District of the County of Eureka

State of Nevada, during the year ending 12:00 Noon, September 1, 1984
during period of August 9, 1984

The work described above was performed ~~on~~ through August 11, 1984.
(Insert Date the Work was Performed)
by Cooksley Geophysics, Inc, P. O. Box 1602, Reading, California 96099
(Insert Name(s) of Person, Corporation or Contractor who Performed the Work or made the Improvements)

Such expenditure was made by or at the expense of MAPCO Minerals Corporation
1667 Cole Blvd., Suite 150, Golden, CO 80401.

owner(s) of said claim(s) for the purpose of holding said claim(s).

[Signature]
(Signature of Person Certifying the Above)

Subscribed and sworn to before me this

30th day of August, 1984

Cheryl Lynn Burdett
NOTARY PUBLIC

My Commission Expires 11/27/86
OR

WITNESS

WITNESS

Recorder's Stamp

Proof of Performance and Completion of Annual Assessment Work must be Recorded within 60 days after Completion of Work and must be sworn to before a Notary Public or subscribed to by Two Competent Witnesses. (NRS 517.230)

Please Type or Print in Black Ink Only

BOOK 127 PAGE 142

EXHIBIT "A"

	<u>Book</u>	<u>Page</u>	<u>BLM Serial #</u>
DP #1	115	312	NMC 285525
DP #2	115	313	NMC 285526
DP #3	115	314	NMC 285527
DP #4	115	315	NMC 285528
DP #5	115	316	NMC 285529
DP #6	115	317	NMC 285530
DP #7	115	318	NMC 285531
DP #8	115	319	NMC 285532
DP #9	115	320	NMC 285533
DP #10	115	321	NMC 285534
DP #11	115	322	NMC 285535
DP #12	115	323	NMC 285536
DP #13	115	324	NMC 285537
DP #14	115	325	NMC 285538
DP #15	115	326	NMC 285539
DP #16	115	327	NMC 285540
DP #17	115	328	NMC 285541
DP #18	115	329	NMC 285542
DP #19	115	330	NMC 285543
DP #20	115	331	NMC 285544
DP #21	115	332	NMC 285545
DP #22	115	333	NMC 285546
DP #23	115	334	NMC 285547
DP #24	115	335	NMC 285548
DP #25	115	336	NMC 285549
DP #26	115	337	NMC 285550
DP #27	115	338	NMC 285551
DP #28	115	339	NMC 285552
DP #29	115	340	NMC 285553
DP #30	115	341	NMC 285554
DP #31	115	342	NMC 285555
DP #32	115	343	NMC 285556
DP #33	115	344	NMC 285557
DP #34	115	345	NMC 285558
DP #35	115	346	NMC 285559
DP #36	115	347	NMC 285560

Located in Section 16, Township 34 North, Range 51 East, unknown
Mining District, Eureka County, Nevada

EXHIBIT "B"
Geophysical Report

This detailed report is filed in compliance with the requirements of Title 30, U. S. Code, Section 28.1 for the "DP" Claims Nos. 1 - 36, and is attached to and made a part of that certain Proof of Performance and Completion of Annual Assessment Work prepared by MAPCO Minerals Corporation and dated August 28, 1984.

A reflection seismic survey was performed by Cooksley Geophysics, Inc. and paid for by MAPCO Minerals Corporation. The cost of the survey was \$4,000.00. The survey was performed along the line shown on the attached map. Mr. James Cooksley and Sheryl Siegmann were in charge of field operations and data acquisition. The work consisted of shooting seismic and various points to evaluate the stratigraphy and structural control existent in the area to assist in planning for further exploration and development work. Mr. Cooksley has a Professional Engineering Degree from Colorado School of Mines and he has 28 years experience in geophysical data acquisition and interpretation. Ms. Siegmann has a Masters Degree in Geology from the University of Idaho and has 3 years experience. Initial interpretations of the data suggest a thick bed of alluvial cover over the "DP" Claims.

Exhibit "B"

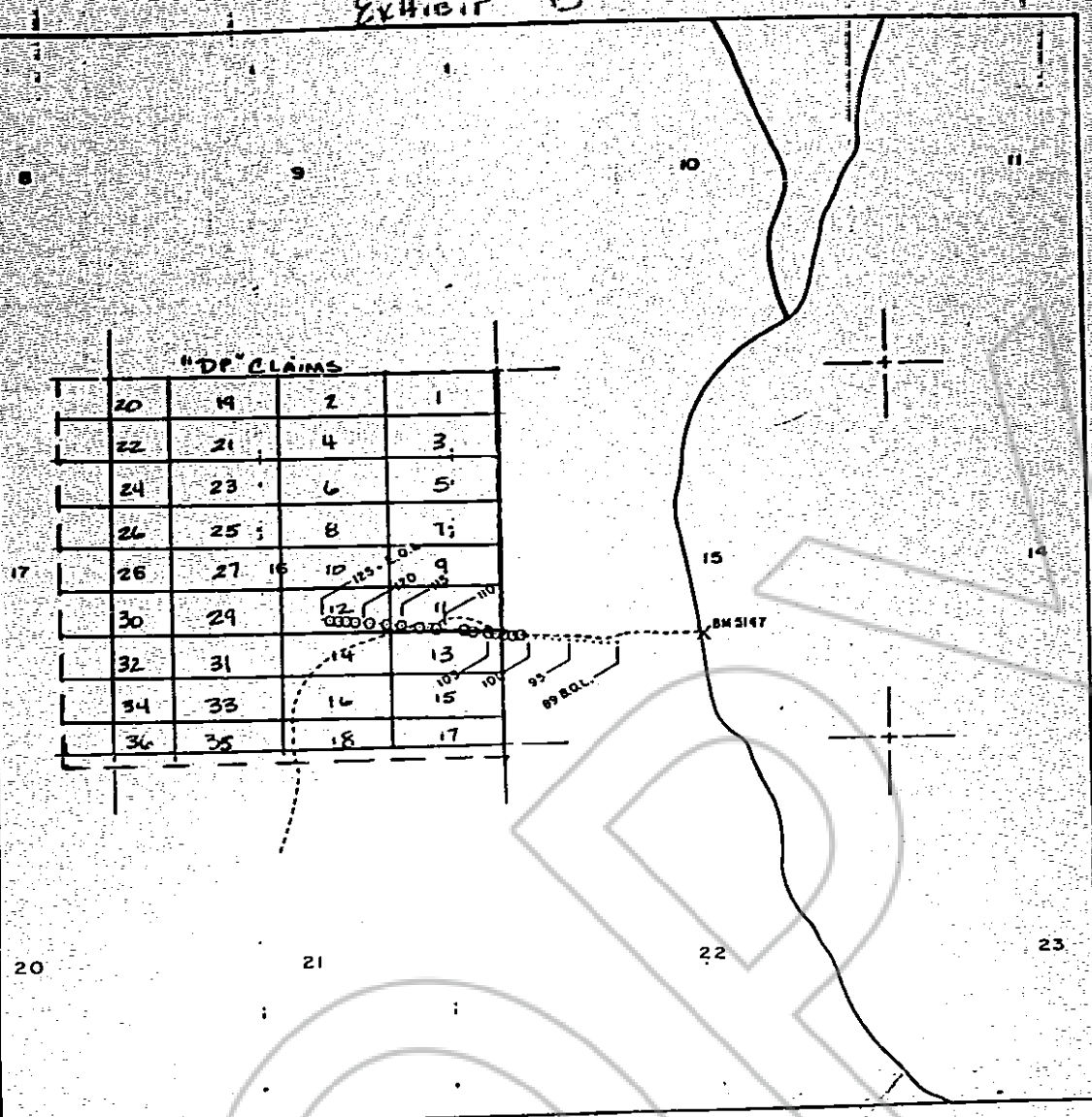

SEISMIC LINE LOCATION MAP
 T. 34 N., R. 51 E.,
 Eureka County, Nevada
 for: Mapco Minerals

by: **COOKSLEY GEOPHYSICS, INC.**
P.O. Box 16027/Reno, Nev. 89502/81241-341

RECORDED AT REQUEST OF
Mapco Minerals Corp.
 BOOK 127 PAGE 142

84 SEP 4 AM 11:30

OFFICIAL RECORDS
 EUREKA COUNTY, NEVADA
 M.H. REBALEATI, RECORDER
 FILE NO. 95367
 FEE \$ 45.00

SCALE: 1" = 2000'

771/8/84

BOOK 127 PAGE 145