

95687

**AFFIDAVIT OF PERFORMANCE OF ANNUAL
ASSESSMENT WORK
(Proof of Labor)**

September 4, 1984

STATE OF NEVADA)
) ss
COUNTY OF WHITE PINE)

Dennis J. Sestanovich, whose address is 685 Lyons Avenue, Ely, Nevada 89301, being first sworn, on behalf of the owner, states that at least one hundred dollars in value of labor was performed or improvements made upon or for the direct benefit of each of the following contiguous unpatented lode mining claims located in Eureka County, Nevada to wit:

<u>CLAIM NAME</u>	<u>BLM SERIAL NUMBER</u>	<u>LOCATION NOTICE RECORD</u>
		<u>BOOK</u> <u>PAGE</u>
Coal Nos. 1-63	251548-251610	105 383-445
Coal Nos. 64-89	273268-273293	111 231-256

That labor was performed and improvements were made between July 30, 1984 to September 4, 1984 for the assessment year ending September 1, 1984. The amount of money expended for such labor and improvements was at least \$100.00 per claim and the character of the expenditures, labor, and improvements is as follows: Geologic mapping, rock sampling, and trenching.

The owner(s) of the claim is: Amselco Exploration Inc., whose address is 90 West Grove Street, Suite 100, Reno, Nevada 89509. The expenditures were made at the expense of Amselco Exploration Inc. for the benefit of the owner. The person(s), corporation(s), contractor(s), or subcontractor(s) who performed the work or made the improvements: Eureka Custom Contractors, Eureka, Nevada 89316.

Witness Alma L. Allred Affiant Dennis J. Sestanovich
Witness Paul J. Mutsaers

Subscribed and sworn to before me this 10 day of September 1984, by Dennis J. Sestanovich

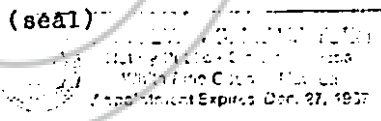

Carol Ann S. Morris
Notary Public

My commission expires: December 27, 1987

kls
7.21/29

BOOK 127 PAGE 517

REPORT OF MINERAL EXPLORATION ACTIVITIES

CONDUCTED ON THE COAL CLAIMS, EUREKA COUNTY, NEVADA

The location of the work performed in relation to the point of discovery and boundaries of the claim(s): Geologic mapping and rock sampling of entire group. All work done within the claim boundaries of Coal Nos. 1-89.

Nature or type of work performed: Geologic mapping, rock sampling, and trenching.

Extent of work performed: 89 claims were mapped, 125 rock samples were taken, and 8 trenches were dug.

Cost of work performed: At least \$100.00 was spent on each claim.

Basic findings of work performed: Mapping and sampling revealed the extent and distribution of metal anomalies and host rock alteration; indicating possibilities of disseminated mineralization.

Person or persons conducting the work:

<u>NAME</u>	<u>ADDRESS</u>	<u>PROFESSIONAL BACKGROUND</u>
Margie Lane	685 Lyons Avenue Ely, Nevada 89301	Geologist

Such survey has not been applied as labor for more than two consecutive years or for more than a total of five years on any one mining claim, and such survey has been nonrepetitive of any previous survey on the same claim.

klb
7.21/29

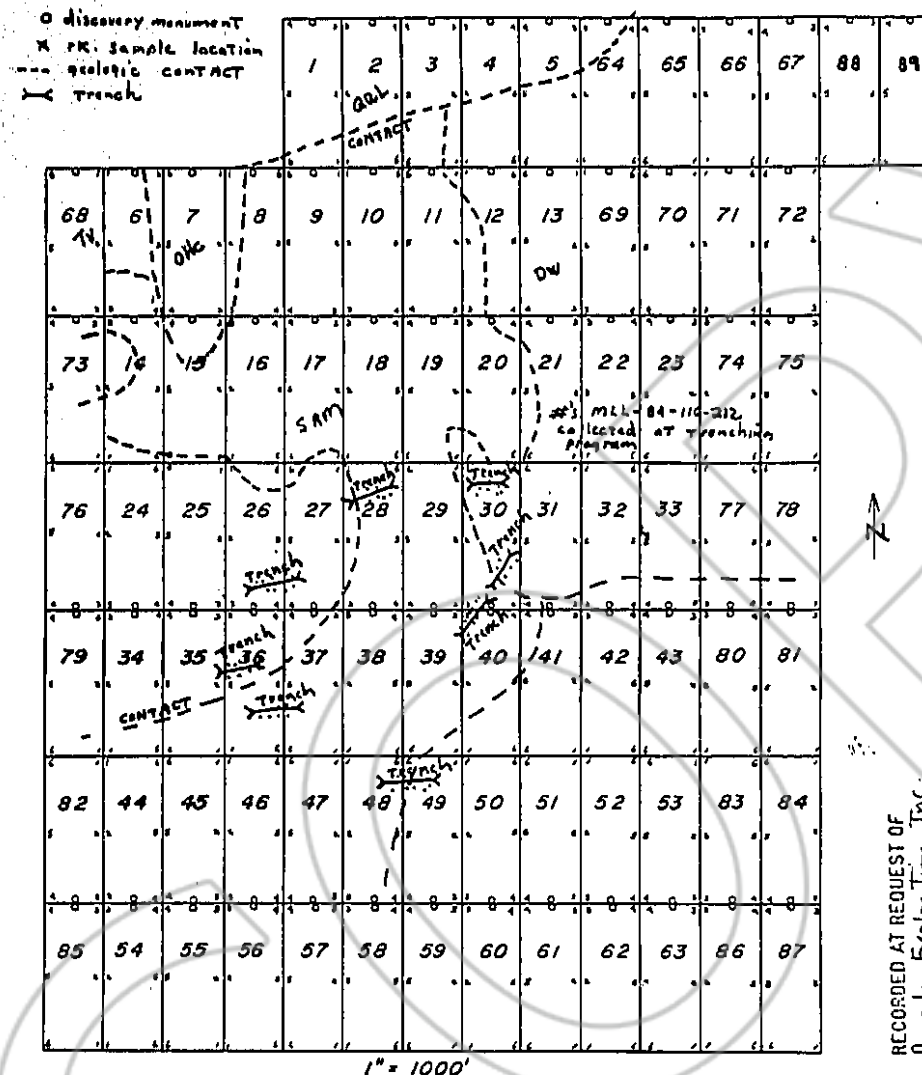

Map Of Amselco Exploration Inc. "Coal" Claims Nos. 1-87
 Located in Sections 16-21, 28, 29 & 30, T. 25N., R. 49E.,
 M.D.B.M. Eureka County, Nevada

RECORDED AT REQUEST OF
 Amselco Exploration, Inc.
 BOOK 127 PAGE 517

84 SEP 11 A10:30

OFFICIAL RECORDS
 EUREKA COUNTY, NEVADA
 M.I.N. REBATE AT RECORDER
 FILE NO. 95687
 SEP 3 11/135

BOOK 127 PAGE 519