

T36N, R49E

95970

30 August 1984

Field Date  
14 August 1984

## CERTIFIED LAND CORNER RECORDATION

## DESCRIPTION OF CORNER EVIDENCE FOUND, AND ORIGINAL RECORD (if known)

Record:-- North between Section 36, T36N, R49E and Section 31, T36N, R50E for corner common to Sections 25 and 36, T36N, R49E and Sections 30 and 31, T36N, R50E.  
80.00 Set a Scoria Stone 18x11x10, as per instructions for Cor. to Sect. 25-30-31 and 36. Sand rolling hills. Soil 2d rate. Bunch grass.

see below

## DESCRIPTION OF MONUMENT AND ACCESSORIES ESTABLISHED TO PERPETUATE THE ORIGINAL LOCATION OF THIS CORNER:

Set:-- Nothing.

## SKETCH, WITH COURSE AND DISTANCE TO ADJACENT CORNER IF DETERMINED IN THIS SURVEY.

(May Sketch or Paste Reproduction on Reverse Side.)

Reference:-- Book NV, page 1.

Found:-- A 2" black iron pipe with 3"x brass cap inscribed as shown

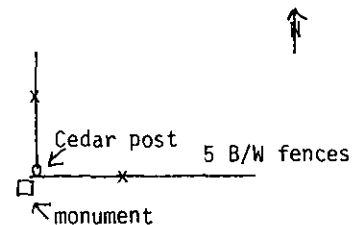
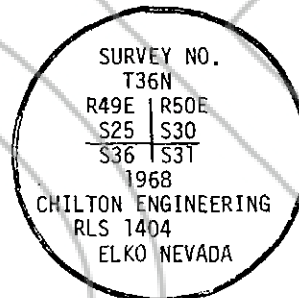

with a 1/2" steel reinforcing rod with aluminum cap inscribed "G S9" alongside to S.

I, Paul N. Scherbel certify that I have carefully performed or reviewed the work done on the diagrammed corner as reported on this recordation form and approve PAUL N. SCHERBEL

Signature of Surveyor

6805

Registration No.

STATE OF ~~WYOMING~~ NEVADA  
Office of Clerk and Recorder,  
County of EUREKA

This "corner record" was filed for record on the 24<sup>th</sup> day of September at 3:00 PM, 1984, was noted on the cross-index plat and is assigned page No. V-25, in book No. 36-49.

cc: BLM

Western States Minerals  
Gordon  
McMahon  
Chilton

M. N. Reblenti  
County Official

Cross Index No.	T.	R.	Mer.
	T.	R.	Mer.
	T.	R.	Mer.
	T.	R.	Mer.
	T.	R.	Mer.
	T.	R.	Mer.
	T.	R.	Mer.