

30 August 1984

T35N, R50E

Field Date
14 August 1984

95974

CERTIFIED LAND CORNER RECORDATION

DESCRIPTION OF CORNER EVIDENCE FOUND, AND ORIGINAL RECORD (if known)

Record:-- North between Sections 4 and 5 for closing corner against
T36N, R49E.

Found:-- A 2" black iron pipe with brass cap inscribed as shown

see below

DESCRIPTION OF MONUMENT AND ACCESSORIES ESTABLISHED
TO PERPETUATE THE ORIGINAL LOCATION OF THIS CORNER:

Set:-- Nothing.

SKETCH, WITH COURSE AND DISTANCE TO ADJACENT CORNER IF DETERMINED IN THIS SURVEY.
(May Sketch or Paste Reproduction on Reverse Side.)

Reference:-- Book NV, page 6.

Found:--
Continued

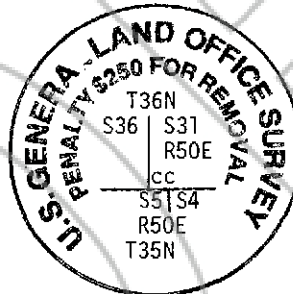

from which a 2" black iron pipe with 3"x brass cap inscribed
4889

B51959-2

MC

CHILTON ENGINEERING
RLS 1404 ELKO NEVADA

bears Sly., 14".

Monument is Nly. 26" of E/W 5 B/W fence.

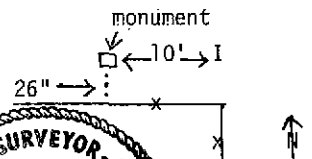

I, Paul N. Scherbel certify that I have carefully performed and reviewed the work
done on the diagrammed corner as reported on this recordation form and approve the same.

Signature of Surveyor

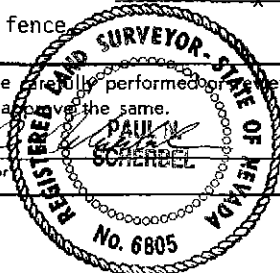

6805
Registration No.

STATE OF ~~WYOMING~~ NEVADA

Office of Clerk and Recorder,

County of EUREKA

This "corner record" was filed for record on the 24th day of September at 3:00 P.M., 1984, was noted
on the cross-index plat and is assigned page No. A-9, in book No. 35-50.

cc: BLM
Western States Minerals
McMahon
Gordon
Chilton

M. J. P. P. P.

County Official

Cross Index No.	T.	R.	Mer.
	T.	R.	Mer.
	T.	R.	Mer.
	T.	R.	Mer.
	T.	R.	Mer.
	T.	R.	Mer.
	T.	R.	Mer.

SURVEYOR SCHERBEL, LTD.

Box 96

BIG PINEY, WYOMING 83113

95974