

T35N, R50E

95975

30 August 1984

Field Date
14 August 1984

CERTIFIED LAND CORNER RECORDATION

DESCRIPTION OF CORNER EVIDENCE FOUND, AND ORIGINAL RECORD (if known)

Record:-- North between Sections 3 and 4 for closing corner against
T36N, R50E.

Found:-- A 2" black iron pipe with brass cap inscribed as shown

see below

**DESCRIPTION OF MONUMENT AND ACCESSORIES ESTABLISHED
TO PERPETUATE THE ORIGINAL LOCATION OF THIS CORNER:**

Set:-- Nothing.

**SKETCH, WITH COURSE AND DISTANCE TO ADJACENT CORNER IF DETERMINED IN THIS SURVEY.
(May Sketch or Paste Reproduction on Reverse Side.)**

Reference:-- Book NV, page 11.

Found:--
Continued

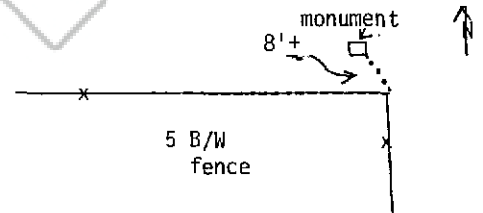
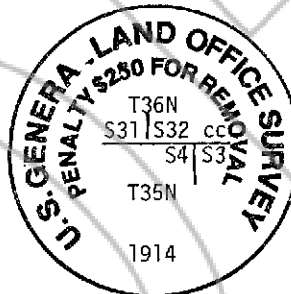

I, Paul N. Scherbel certify that I have carefully performed and reviewed the work
done on the diagrammed corner as reported on this recordation form, and approve PAUL N. SCHERBEL

Signature of Surveyor

6805

Registration No.

STATE OF ~~WYOMING~~, NEVADA

Office of Clerk and Recorder,

County of EUREKA

This "corner record" was filed for record on the 24th day of September at 3:00 P.M., 1984, was noted
on the cross-index plat and is assigned page No. A-13, in book No. 35-50.

cc: BLM

Western States Minerals

McMahon

Gordon

Chilton

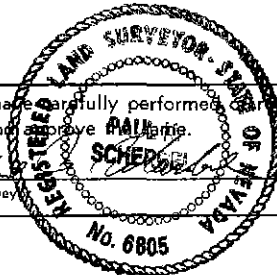

M. M. Reboletti
County Official

Cross Index No.	T.	R.	Mer.
	T.	R.	Mer.
	T.	R.	Mer.
	T.	R.	Mer.
	T.	R.	Mer.
	T.	R.	Mer.
	T.	R.	Mer.