

18 January 1985

T36N, R50E, M. D. B&M

98379

Field Date
27 September 1984

CERTIFIED LAND CORNER RECORDATION

DESCRIPTION OF CORNER EVIDENCE FOUND, AND ORIGINAL RECORD (if known)

Record:-- West on south boundary of T36N, R50E for corner common to Sections 32 and 33, T36N, R50E.

82.24 Set an iron post 3 ft. long, 3 ins. in dia., 24 ins. in the ground for the Std. Cor. of Secs. 32 and 33, with brass cap mkd:

T36N	R50E
S32	S33
1914	

see below

DESCRIPTION OF MONUMENT AND ACCESSORIES ESTABLISHED TO PERPETUATE THE ORIGINAL LOCATION OF THIS CORNER:

Set:-- Enlarged mound of stone to N.

SKETCH, WITH COURSE AND DISTANCE TO ADJACENT CORNER IF DETERMINED IN THIS SURVEY.
(May Sketch or Paste Reproduction on Reverse Side.)

Reference:-- Book NV, page 22.

Record:-- Continued and raise a mound of stone 2 ft. base, 1½ ft. high, N. of cor.

Found:-- A 3" black iron pipe with brass cap inscribed as shown

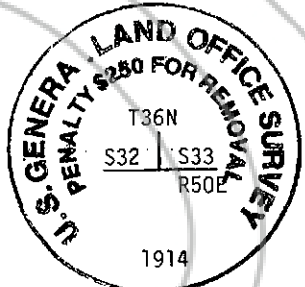

with mound of stone to N and red steel fence post alongside to E.

I, Paul N. Scherbel certify that I have carefully performed or reviewed the work done on the diagrammed corner as reported on this recordation form and approve the same.

Paul N. Scherbel
Signature of Surveyor

6805
Registration No.

STATE OF ~~WYOMING~~ NEVADA
Office of Clerk and Recorder,
County of EUREKA

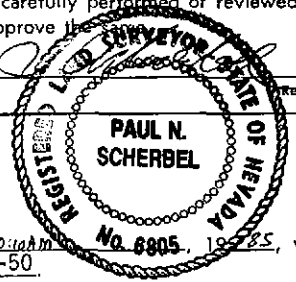

This "corner record" was filed for record on the 24th day of January at 10:10 AM in book No. 36-50, was noted on the cross-index plat and is assigned page No. 7-9.

cc: BLM
McMahon
Gordon
Cerny

M. N. Babalati - Eureka County Recorder
County Official

Cross Index No. _____ T. _____ R. _____ Mer. _____
 _____ T. _____ R. _____ Mer. _____
 _____ T. _____ R. _____ Mer. _____
 _____ T. _____ R. _____ Mer. _____
 _____ T. _____ R. _____ Mer. _____
 _____ T. _____ R. _____ Mer. _____