

98946

CERTIFICATION OF LOCATION OF LODE MINING CLAIM

THIS IS TO CERTIFY THAT the undersigned locator did on the 8 day of May, 1985, locate and claim in compliance with the Mining Laws of the United States and the State of Nevada, and the local customs and rules of the district in which the claim is located, the lode mining claim called the LPS 13 mining claim in the NW /4 Sec 25, T17N, R40E, and the /4 Sec , T , R , M D B & M, in the Unknown Mining District, Eureka County, State of Nevada.

The claim is 1500 feet long and 600 feet wide, and 10 feet are claimed in a S direction and 1490 in a N direction from the location monument, at which the notice of location is posted, and 300 feet on each side of the center line of the claim. The general course of the lode is N & S.

The position of each corner of this claim is shown on a mining claim map prepared pursuant to Chapter 517 of the Nevada Revised Statutes and recorded contemporaneously with the recording of this Certificate, which map is hereby by reference incorporated herein. On the ground each corner is marked with its appropriate number. All monuments are wooden posts at least four and one-half feet in length set firmly in the ground or in a mound of earth and rocks. The numbers established for the claim boundary monuments are shown on the aforesaid mining claim map.

The monumentation and marking of the corners was completed May 8, 1985 in accordance with the Nevada Mining Laws.

The location work consists of a claim map as provided in NRS 517.040, and the \$15.00 lode claim filing fee has been paid to the County Recorder.

Dated this 13 day of May, 1985

Locator
and
Owner :

Nevada Resources Inc.
239 Freeport Blvd., Sparks, NV
P.O. Box 7095
Reno, NV 89510

By :

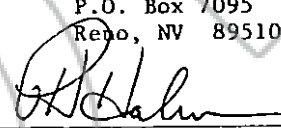

Agent

(Indicate on map
north arrow,
numbering of
corners, position
of location monument
(X), adjoining claims.)

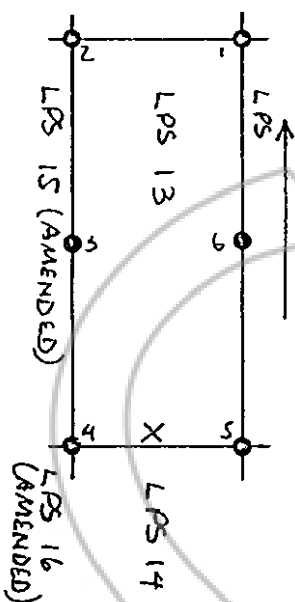

RECORDED AT REQUEST OF
Nevada Resources Inc.
BOOK 135 PAGE 367

85 MAY 17 A 8: 00

OFFICIAL RECORDS
EUREKA COUNTY, NEVADA
MIN. RECL. & L. RECORDER
FILE NO. 98946
FFS \$ 5.75

98947

CERTIFICATION OF LOCATION OF LODE MINING CLAIM

THIS IS TO CERTIFY THAT the undersigned locator did on the 8 day of May, 1985, locate and claim in compliance with the Mining Laws of the United States and the State of Nevada, and the local customs and rules of the district in which the claim is located, the lode mining claim called the LPS 14 mining claim in the NW & SW /4 Sec 25, T17N, R48E, and the /4 Sec , T , R , M D B & M, in the unknown Mining District, Eureka County, State of Nevada.

The claim is 1500 feet long and 600 feet wide, and 10 feet are claimed in a N direction and 1490 in a S direction from the location monument, at which the notice of location is posted, and 300 feet on each side of the center line of the claim. The general course of the lode is N & S.

The position of each corner of this claim is shown on a mining claim map prepared pursuant to Chapter 517 of the Nevada Revised Statutes and recorded contemporaneously with the recording of this Certificate, which map is hereby by reference incorporated herein. On the ground each corner is marked with its appropriate number. All monuments are wooden posts at least four and one-half feet in length set firmly in the ground or in a mound of earth and rocks. The numbers established for the claim boundary monuments are shown on the aforesaid mining claim map.

The monumentation and marking of the corners was completed May 8, 1985 in accordance with the Nevada Mining Laws.

The location work consists of a claim map as provided in NRS 517.040, and the \$15.00 lode claim filing fee has been paid to the County Recorder.

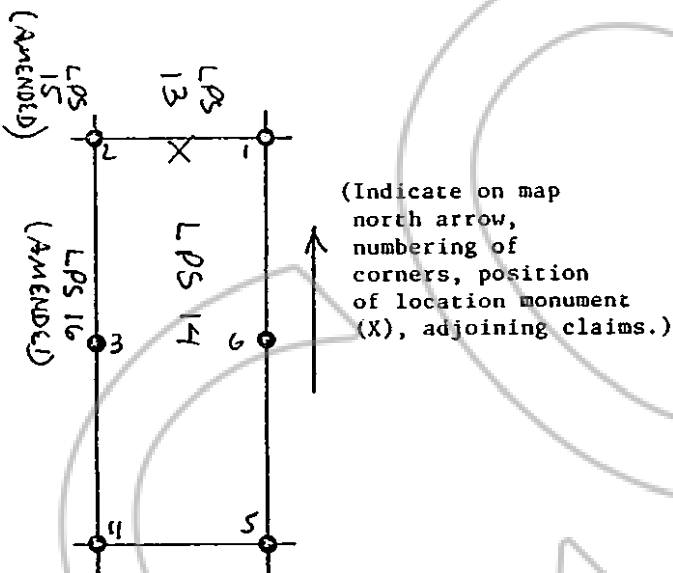

Dated this 13 day of May, 1985

Locator
and
Owner :

Nevada Resources Inc.
239 Freeport Blvd., Sparks, NV
P.O. Box 7095
Reno, NV 89510

By :

[Signature]
Agent

RECORDED AT REQUEST OF
Nevada Resources Inc.
BOOK 135 PAGE 368

85 MAY 17 A 8: 00

OFFICIAL RECORDS
EUREKA COUNTY, NEVADA
M.H. REGALEATI, RECORDER
FILE NO. 98947
FEE \$ 5.75

When Recorded Mail To:
Nevada Resources Inc.
P.O. Box 7095
Reno, NV 89510

98948

CERTIFICATION OF LOCATION OF LODE MINING CLAIM (AMENDED)

THIS IS TO CERTIFY THAT the undersigned locator did on the 19 day of April, 1985, locate and claim in compliance with the Mining Laws of the United States and the State of Nevada, and the local customs and rules of the district in which the claim is located, the lode mining claim called the LPS 15 mining claim in the NE 1/4 Sec 26, T17N, R48E, and the 1/4 Sec , T , R , M D B & M, in the unknown Mining District, Eureka County, State of Nevada. Original locations amended on May 8, 1985, to correct errors or defects in the original locations. The claim is 1500 feet long and 600 feet wide, and 10 feet are claimed in a S direction and 1490 in a N direction from the location monument, at which the notice of location is posted, and 300 feet on each side of the center line of the claim. The general course of the lode is N & S.

The position of each corner of this claim is shown on a mining claim map prepared pursuant to Chapter 517 of the Nevada Revised Statutes and recorded contemporaneously with the recording of this Certificate, which map is hereby by reference incorporated herein. On the ground each corner is marked with its appropriate number. All monuments are wooden posts at least four and one-half feet in length set firmly in the ground or in a mound of earth and rocks. The numbers established for the claim boundary monuments are shown on the aforesaid mining claim map.

The monumentation and marking of the corners was completed May 8, 1985 in accordance with the Nevada Mining Laws.

The location work consists of a claim map as provided in NRS 517.040, and the \$15.00 lode claim filing fee has been paid to the County Recorder.

Dated this 13 day of May, 1985

Locator
and
Owner :

Nevada Resources Inc.
239 Freeport Blvd., Sparks, NV
P.O. Box 7095
Reno, NV 89510

By :

[Signature]

Agent

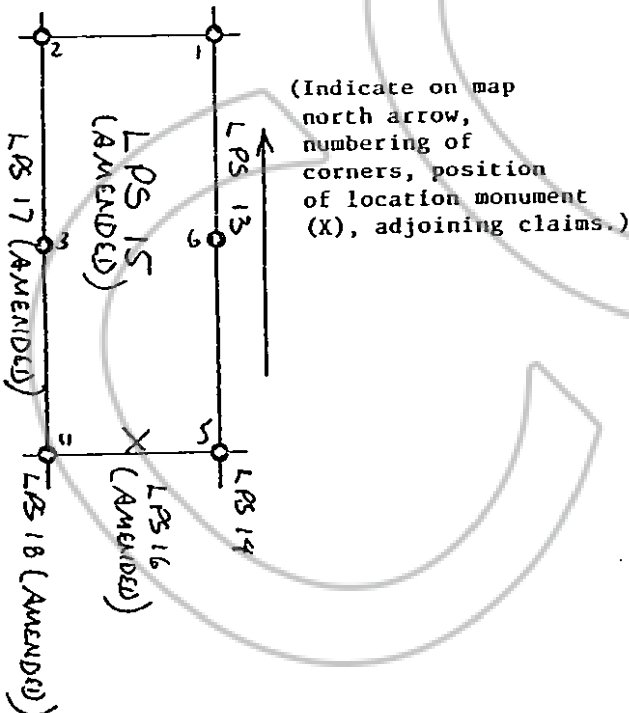

RECORDED AT REQUEST OF
Nevada Resources Inc.
BOOK 135 PAGE 369

85 MAY 17 AB:00

OFFICIAL RECORDS
EUREKA COUNTY, NEVADA
M.H. REDALEATI, RECORDER
FILE NO. 98948
FEE \$ 5.75

When Recorded Mail To:
Nevada Resources Inc.
P.O. Box 7095
Reno, NV 89510

98949

CERTIFICATION OF LOCATION OF LODE MINING CLAIM (AMENDED)

THIS IS TO CERTIFY THAT the undersigned locator did on the 19 day of April, 1985, locate and claim in compliance with the Mining Laws of the United States and the State of Nevada, and the local customs and rules of the district in which the claim is located, the lode mining claim called the LPS 16 mining claim in the NE & SE /4 Sec 26, T17N, R48E, and the /4 Sec , T , R , M D B & M, in the unknown Mining District, Eureka County, State of Nevada. Original locations amended on May 8, 1985 to correct errors or defects in the original locations. The claim is 1500 feet long and 600 feet wide, and 10 feet are claimed in a N direction and 1490 in a S direction from the location monument, at which the notice of location is posted, and 300 feet on each side of the center line of the claim. The general course of the lode is N & S.

The position of each corner of this claim is shown on a mining claim map prepared pursuant to Chapter 517 of the Nevada Revised Statutes and recorded contemporaneously with the recording of this Certificate, which map is hereby by reference incorporated herein. On the ground each corner is marked with its appropriate number. All monuments are wooden posts at least four and one-half feet in length set firmly in the ground or in a mound of earth and rocks. The numbers established for the claim boundary monuments are shown on the aforesaid mining claim map.

The monumentation and marking of the corners was completed May 8, 1985 in accordance with the Nevada Mining Laws.

The location work consists of a claim map as provided in NRS 517.040 , and the \$15.00 lode claim filing fee has been paid to the County Recorder.

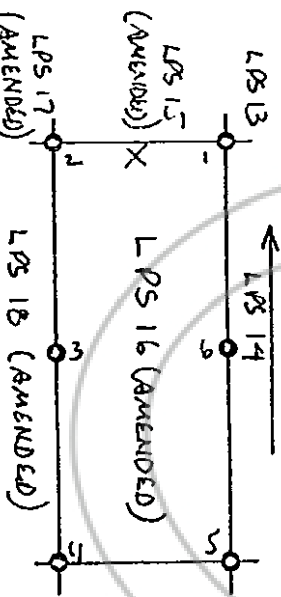

(Indicate on map north arrow, numbering of corners, position of location monument (X), adjoining claims.)

Dated this 13 day of May, 1985
Locator Nevada Resources Inc.
and 239 Freeport Blvd., Sparks, NV
Owner : P.O. Box 7095
Reno, NV 89510
By : [Signature]
Agent

RECORDED AT REQUEST OF
Nevada Resources Inc.
BOOK 135 PAGE 370

85 MAY 17 A 8:00

OFFICIAL RECORDS
EUREKA COUNTY, NEVADA
M.H. REBALEATI, RECORDER
FILE NO. 98949
FEE \$ 5.75

When Recorded Mail To:
Nevada Resources Inc.
P.O. Box 7095
Reno, NV 89510

98950

CERTIFICATION OF LOCATION OF LODE MINING CLAIM (AMENDED)

THIS IS TO CERTIFY THAT the undersigned locator did on the 19 day of April, 1985, locate and claim in compliance with the Mining Laws of the United States and the State of Nevada, and the local customs and rules of the district in which the claim is located, the lode mining claim called the LPS 17 mining claim in the NE 1/4 Sec 26, T 17N, R 48E, and the 1/4 Sec , T , R , M D B & M, in the unknown Mining District, Eureka County, State of Nevada. Original locations amended on May 8, 1985, to correct errors or defects in the original locations. The claim is 1500 feet long and 600 feet wide, and 10 feet are claimed in a S direction and 1490 in a N direction from the location monument, at which the notice of location is posted, and 300 feet on each side of the center line of the claim. The general course of the lode is N 45.

The position of each corner of this claim is shown on a mining claim map prepared pursuant to Chapter 517 of the Nevada Revised Statutes and recorded contemporaneously with the recording of this Certificate, which map is hereby by reference incorporated herein. On the ground each corner is marked with its appropriate number. All monuments are wooden posts at least four and one-half feet in length set firmly in the ground or in a mound of earth and rocks. The numbers established for the claim boundary monuments are shown on the aforesaid mining claim map.

The monumentation and marking of the corners was completed May 8, 1985 in accordance with the Nevada Mining Laws.

The location work consists of a claim map as provided in NRS 517.040, and the \$15.00 lode claim filing fee has been paid to the County Recorder.

Dated this 13 day of May, 1985

Locator and Owner : Nevada Resources Inc.
239 Freeport Blvd., Sparks, NV
P.O. Box 7095
Reno, NV 89510

By : [Signature]
Agent

(Indicate on map north arrow, numbering of corners, position of location monument (X), adjoining claims.)

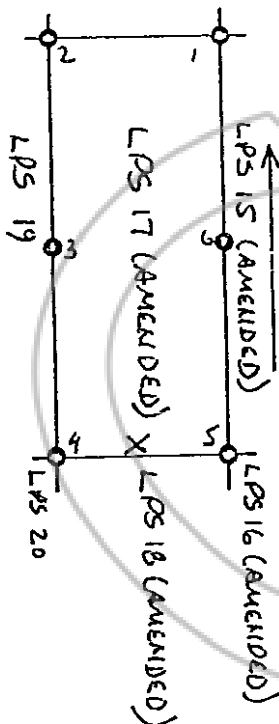

RECORDED AT REQUEST OF
Nevada Resources Inc.
BOOK 135 PAGE 371

85 MAY 17 A 8:01

OFFICIAL RECORDS
EUREKA COUNTY, NEVADA
M.N. REBALEATI, RECORDER
FILE NO. 98950
FEE \$ 5.75