

22 May 1985

T36N, R50E

99345

Field Date
14 May 1985

CERTIFIED LAND CORNER RECORDATION

DESCRIPTION OF CORNER EVIDENCE FOUND, AND ORIGINAL RECORD (if known)

Record:-- West on south boundary on T36N, R50E.
41.12 Set an iron post 3 ft. long, 1 in. in dia., 26 ins. in the ground
for the Std. $\frac{1}{4}$ Sec. Cor., with brass cap mkd:
S 33
 $\frac{1}{4}$
1914
and raise a mound of stone 2 ft. base, 1 $\frac{1}{2}$ ft. high, N. of cor.

DESCRIPTION OF MONUMENT AND ACCESSORIES ESTABLISHED
TO PERPETUATE THE ORIGINAL LOCATION OF THIS CORNER:

see below

Set:-- Nothing.

SKETCH, WITH COURSE AND DISTANCE TO ADJACENT CORNER IF DETERMINED IN THIS SURVEY.
(May Sketch or Paste Reproduction on Reverse Side.)

Reference:-- Book NV, page 11.

Found:-- A 1" black iron pipe with brass cap inscribed as shown

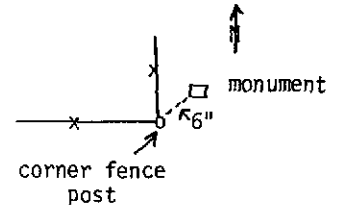
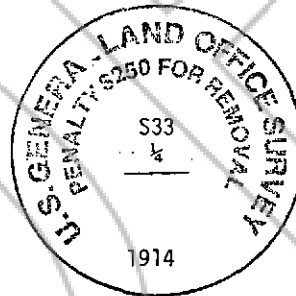

I, Paul N. Scherbel certify that I have performed or reviewed the work done on the diagrammed corner as reported on this recordation form and sketch.

Signature of Surveyor

6805

Registration No.

STATE OF ~~WYOMING~~ NEVADA
Office of Clerk and Recorder,
County of EUREKA

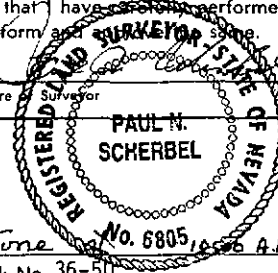

This "corner record" was filed for record on the 3rd day of June, 1985, at 10:56 A.M., was noted on the cross-index plat and is assigned page No. 7-11, in book No. 36-50.

cc: BLM
McMahon
Dominguez

M. J. Reboletti
County Official

Cross Index No. _____ T. _____ R. _____ Mer.
_____ T. _____ R. _____ Mer.
_____ T. _____ R. _____ Mer.
_____ T. _____ R. _____ Mer.
_____ T. _____ R. _____ Mer.
_____ T. _____ R. _____ Mer.

99345