

When Recorded Mail To:
Nevada Resources Inc.
P.O. Box 7095
Reno, NV 89510

99758

CERTIFICATION OF LOCATION OF LODE MINING CLAIM

THIS IS TO CERTIFY THAT the undersigned locator did on the 27 day of June, 1985, locate and claim in compliance with the Mining Laws of the United States and the State of Nevada, and the local customs and rules of the district in which the claim is located, the lode mining claim called the CHAR 46 mining claim in the NW & SW 1/4 Sec 11, T16N, R9E, and the /4 Sec , T16N, R9E, M D B & M, in the unknown Mining District, Eureka County, State of Nevada.

The claim is 1500 feet long and 600 feet wide, and 10 feet are claimed in a N direction and 1490 ft in a S direction from the location monument, at which the notice of location is posted, and 300 feet on each side of the center line of the claim. The general course of the lode is worth and south.

The position of each corner of this claim is shown on a mining claim map prepared pursuant to Chapter 517 of the Nevada Revised Statutes and recorded contemporaneously with the recording of this Certificate, which map is hereby by reference incorporated herein. On the ground each corner is marked with its appropriate number. All monuments are ^{wooden} ~~wooden~~ ^{posts} at least four and one-half feet in length set firmly in the ground or in a mound of earth and rocks. The numbers established for the claim boundary monuments are shown on the aforesaid mining claim map.

The monumentation and marking of the corners was completed 28 June, 1985 in accordance with the Nevada Mining Laws.

The location work consists of a claim map as provided in NRS 517.040, and the \$15.00 lode claim filing fee has been paid to the County Recorder.

Dated this 05 day of July, 1985

Locator Nevada Resources Inc.
and 239 Freeport Blvd., Sparks, NV
Owner : P.O. Box 7095
Reno, NV 89510

By : [Signature]
Agent

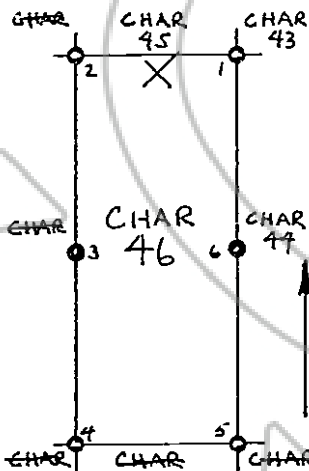

RECORDED AT REQUEST OF
Nevada Resources Inc
BOOK 137 PAGE 176

35 JUL 11 A 8: 03

OFFICIAL RECORDS
EUREKA COUNTY, NEVADA
M.N. REGALEATI, RECORDER
FILE NO. 99758
PAGE 575

BOOK | 37 PAGE | 76

When Recorded Mail To:
Nevada Resources Inc.
P.O. Box 7095
Reno, NV 89510

99760

CERTIFICATION OF LOCATION OF LODE MINING CLAIM

THIS IS TO CERTIFY THAT the undersigned locator did on the 26 day of June, 1985, locate and claim in compliance with the Mining Laws of the United States and the State of Nevada, and the local customs and rules of the district in which the claim is located, the lode mining claim called the ECHO 72 mining claim in the SE 14 Sec 22, T16N, R48E, and the NE 14 Sec 27, T16N, R48E, M D B & M, in the Unknown Mining District, Eureka County, State of Nevada.

The claim is 1500 feet long and 600 feet wide, and 10 feet are claimed in a N direction and 1490 ft in a S direction from the location monument, at which the notice of location is posted, and 300 feet on each side of the center line of the claim. The general course of the lode is north and south.

The position of each corner of this claim is shown on a mining claim map prepared pursuant to Chapter 517 of the Nevada Revised Statutes and recorded contemporaneously with the recording of this Certificate, which map is hereby by reference incorporated herein. On the ground each corner is marked with its appropriate number. All monuments are ^{in PVC} ~~wooden~~ posts at least four and one-half feet in length set firmly in the ground or in a mound of earth and rocks. The numbers established for the claim boundary monuments are shown on the aforesaid mining claim map.

The monumentation and marking of the corners was completed 28 June, 1985 in accordance with the Nevada Mining Laws.

The location work consists of a claim map as provided in NRS 517.040, and the \$15.00 lode claim filing fee has been paid to the County Recorder.

Dated this 5 day of July, 1985

Locator Nevada Resources Inc.
and 239 Freeport Blvd., Sparks, NV
Owner : P.O. Box 7095
Reno, NV 89510

By : [Signature]
Agent

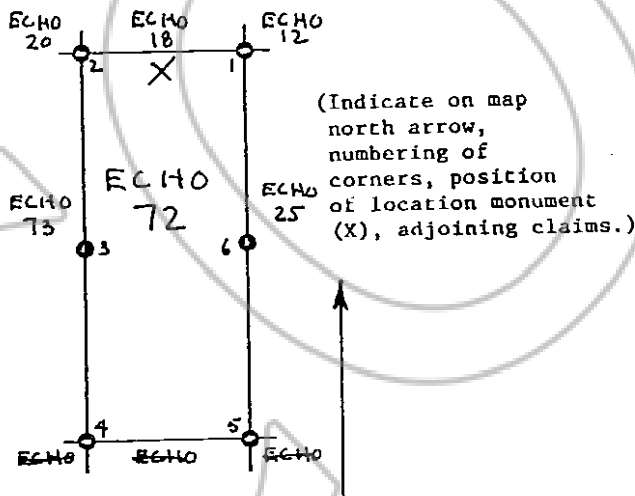

RECORDED AT REQUEST OF
Nevada Resources Inc
BOOK 137 PAGE 77

85 JUL 11 4 8: 96

OFFICIAL RECORDS
EUREKA COUNTY, NEVADA
M. N. REBALEATI, RECORDER
FILE NO. 99760
FFS 575

BOOK 137 PAGE 77

When Recorded Mail To:
Nevada Resources Inc.
P.O. Box 7095
Reno, NV 89510

99761

CERTIFICATION OF LOCATION OF LODE MINING CLAIM

THIS IS TO CERTIFY THAT the undersigned locator did on the 26 day of June, 1985, locate and claim in compliance with the Mining Laws of the United States and the State of Nevada, and the local customs and rules of the district in which the claim is located, the lode mining claim called the ECHO 73 mining claim in the SW 4 SE 14 Sec 22, T16N, R48E, and the NW 4 NE 14 Sec 27, T16N, R48E, M D B & M, in the Unknown Mining District, Eureka County, State of Nevada.

The claim is 1500 feet long and 600 feet wide, and 10 feet are claimed in a N direction and 1490 Ft in a S direction from the location monument, at which the notice of location is posted, and 300 feet on each side of the center line of the claim. The general course of the lode is north and south.

The position of each corner of this claim is shown on a mining claim map prepared pursuant to Chapter 517 of the Nevada Revised Statutes and recorded contemporaneously with the recording of this Certificate, which map is hereby by reference incorporated herein. On the ground each corner is marked with its appropriate number. All monuments are ^{posts} ~~posts~~ at least four and one-half feet in length set firmly in the ground or in a mound of earth and rocks. The numbers established for the claim boundary monuments are shown on the aforesaid mining claim map.

The monumentation and marking of the corners was completed 28 June, 1985 in accordance with the Nevada Mining Laws.

The location work consists of a claim map as provided in NRS 517.040, and the \$15.00 lode claim filing fee has been paid to the County Recorder.

Dated this 5 day of July, 1985

Locator
and
Owner : Nevada Resources Inc.
239 Freeport Blvd., Sparks, NV
P.O. Box 7095
Reno, NV 89510

By : [Signature]
Agent

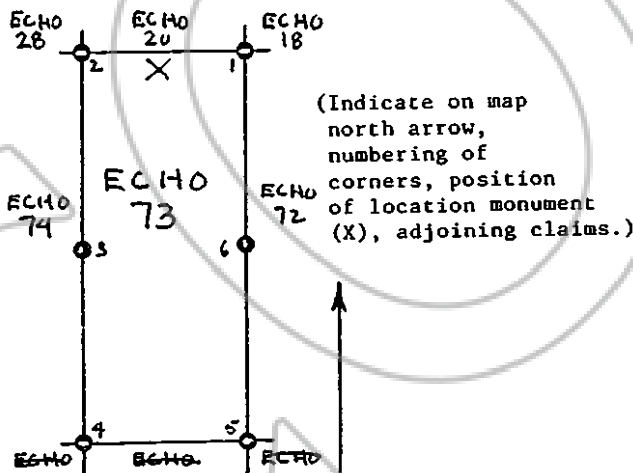

RECORDED AT REQUEST OF
Nevada Resources Inc.
BOOK 137 PAGE 178

85 JUL 11 A 8: 06

OFFICIAL RECORDS
EUREKA COUNTY, NEVADA
M.H. REGALEATI, RECORDER
FILE NO. 99761
REV. 5.75

BOOK 137 PAGE 178

When Recorded Mail To:
Nevada Resources Inc.
P.O. Box 7095
Reno, NV 89510

99762

CERTIFICATION OF LOCATION OF LODE MINING CLAIM

THIS IS TO CERTIFY THAT the undersigned locator did on the 26 day of June, 1985, locate and claim in compliance with the Mining Laws of the United States and the State of Nevada, and the local customs and rules of the district in which the claim is located, the lode mining claim called the ECHO 74 mining claim in the SW/4 Sec 22, T16N, R48E, and the NW/4 Sec 27, T16N, R48E, M D B & M, in the unknown Mining District, Eureka County, State of Nevada.

The claim is 1500 feet long and 600 feet wide, and 10 feet are claimed in a N direction and 1490 Ft in a S direction from the location monument, at which the notice of location is posted, and 300 feet on each side of the center line of the claim. The general course of the lode is north and south.

The position of each corner of this claim is shown on a mining claim map prepared pursuant to Chapter 517 of the Nevada Revised Statutes and recorded contemporaneously with the recording of this Certificate, which map is hereby by reference incorporated herein. On the ground each corner is marked with its appropriate number. All monuments are ^{in PVC} ~~wooden~~ _{posts} at least four and one-half feet in length set firmly in the ground or in a mound of earth and rocks. The numbers established for the claim boundary monuments are shown on the aforesaid mining claim map.

The monumentation and marking of the corners was completed 28 June, 1985 in accordance with the Nevada Mining Laws.

The location work consists of a claim map as provided in NRS 517.040, and the \$15.00 lode claim filing fee has been paid to the County Recorder.

Dated this 5 day of July, 1985

Locator Nevada Resources Inc.
and 239 Freeport Blvd., Sparks, NV
Owner : P.O. Box 7095
Reno, NV 89510

By : [Signature]
Agent

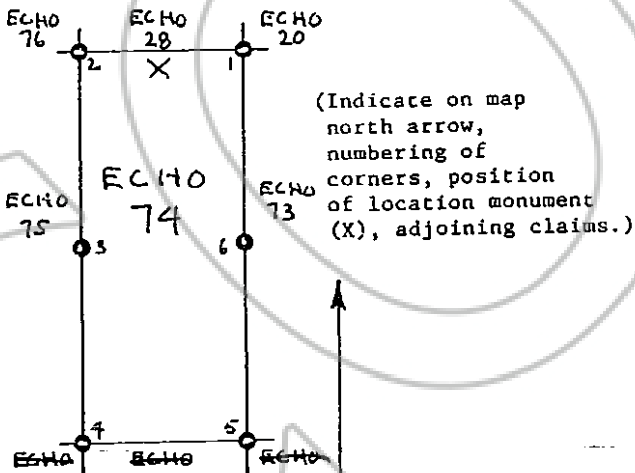

RECORDED AT REQUEST OF
Nevada Resources
BOOK 137 PAGE 177

85 JUL 11 A 8:06

OFFICIAL RECORDS
EUREKA COUNTY, NEVADA
M.N. REBALEATI, RECORDER
FILE NO. 99762
FEE \$ 5.75

BOOK 137 PAGE 179

When Recorded Mail To:
Nevada Resources Inc.
P.O. Box 7095
Reno, NV 89510

99763

CERTIFICATION OF LOCATION OF LODE MINING CLAIM

THIS IS TO CERTIFY THAT the undersigned locator did on the 26 day of June, 1985, locate and claim in compliance with the Mining Laws of the United States and the State of Nevada, and the local customs and rules of the district in which the claim is located, the lode mining claim called the ECHO 75 mining claim in the SW 1/4 Sec 22, T16N, R48E, and the NW 1/4 Sec 27, T16N, R48E, M D B & M, in the Unknown Mining District, Eureka County, State of Nevada.

The claim is 1500 feet long and 600 feet wide, and 10 feet are claimed in a N direction and 1490 ft in a S direction from the location monument, at which the notice of location is posted, and 300 feet on each side of the center line of the claim. The general course of the lode is north and south.

The position of each corner of this claim is shown on a mining claim map prepared pursuant to Chapter 517 of the Nevada Revised Statutes and recorded contemporaneously with the recording of this Certificate, which map is hereby by reference incorporated herein. On the ground each corner is marked with its appropriate number. All monuments are ~~posts~~ ^{posts} at least four and one-half feet in length set firmly in the ground or in a mound of earth and rocks. The numbers established for the claim boundary monuments are shown on the aforesaid mining claim map.

The monumentation and marking of the corners was completed 28 June, 1985 in accordance with the Nevada Mining Laws.

The location work consists of a claim map as provided in NRS 517.040, and the \$15.00 lode claim filing fee has been paid to the County Recorder.

Dated this 5 day of July, 1985

Locator
and
Owner : Nevada Resources Inc.
239 Freeport Blvd., Sparks, NV
P.O. Box 7095
Reno, NV 89510

By :

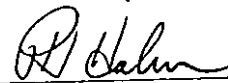

Agent

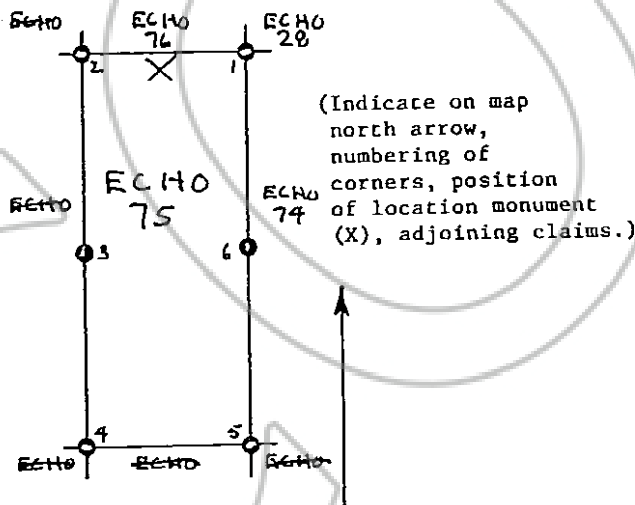

RECORDED AT REQUEST OF
Nevada Resources Inc
BOOK 137 PAGE 180

85 JUL 11 A 8: 06

OFFICIAL RECORDS
EUREKA COUNTY, NEVADA
M. H. REBALEATI, RECORDER
FILE NO. 99763
FEE \$ 5.25

BOOK | 37 PAGE | 80

When Recorded Mail To:
Nevada Resources Inc.
P.O. Box 7095
Reno, NV 89510

39764

CERTIFICATION OF LOCATION OF LODE MINING CLAIM

THIS IS TO CERTIFY THAT the undersigned locator did on the 26 day of June, 1985, locate and claim in compliance with the Mining Laws of the United States and the State of Nevada, and the local customs and rules of the district in which the claim is located, the lode mining claim called the ECHO 76 mining claim in the SW 1/4 Sec 22, T16N, R48E, and the /4 Sec , T16N, R48E, M D B & M, in the Unknown Mining District, Eureka County, State of Nevada.

The claim is 1500 feet long and 600 feet wide, and 10 feet are claimed in a N direction and 1490 ft in a S direction from the location monument, at which the notice of location is posted, and 300 feet on each side of the center line of the claim. The general course of the lode is north and south.

The position of each corner of this claim is shown on a mining claim map prepared pursuant to Chapter 517 of the Nevada Revised Statutes and recorded contemporaneously with the recording of this Certificate, which map is hereby by reference incorporated herein. On the ground each corner is marked with its appropriate number. All monuments are wooden posts at least four and one-half feet in length set firmly in the ground or in a mound of earth and rocks. The numbers established for the claim boundary monuments are shown on the aforesaid mining claim map.

The monumentation and marking of the corners was completed 28 June, 1985 in accordance with the Nevada Mining Laws.

The location work consists of a claim map as provided in NRS 517.040, and the \$15.00 lode claim filing fee has been paid to the County Recorder.

Dated this 5 day of July, 1985

Locator and Owner : Nevada Resources Inc.
239 Freeport Blvd., Sparks, NV
P.O. Box 7095
Reno, NV 89510

By : [Signature]
Agent

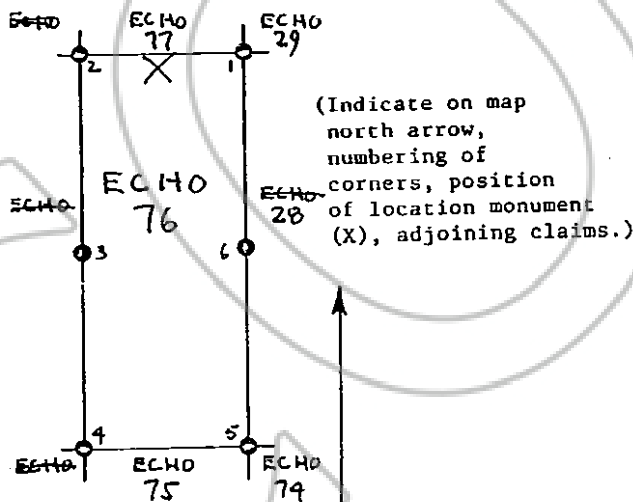

RECORDED AT REQUEST OF
Nevada Resources Inc
BOOK 137 PAGE 181

85 JUL 11 A 8: 06

OFFICIAL RECORDS
EUREKA COUNTY, NEVADA
M.N. REBALEATI, RECORDER
FILE NO. 39764
FFT \$ 5.25

BOOK | 37 PAGE | 81

When Recorded Mail To:
Nevada Resources Inc.
P.O. Box 7095
Reno, NV 89510

99765

CERTIFICATION OF LOCATION OF LODE MINING CLAIM

THIS IS TO CERTIFY THAT the undersigned locator did on the 26 day of June, 1985, locate and claim in compliance with the Mining Laws of the United States and the State of Nevada, and the local customs and rules of the district in which the claim is located, the lode mining claim called the ECHO 77 mining claim in the NW/4 Sec 22, T 16N, R 48E, and the /4 Sec , T 16N, R 48E, M D B & M, in the unknown Mining District, Eureka County, State of Nevada.

The claim is 1500 feet long and 600 feet wide, and 1490 feet are claimed in a N direction and 10A in a S direction from the location monument, at which the notice of location is posted, and 300 feet on each side of the center line of the claim. The general course of the lode is north and south.

The position of each corner of this claim is shown on a mining claim map prepared pursuant to Chapter 517 of the Nevada Revised Statutes and recorded contemporaneously with the recording of this Certificate, which map is hereby by reference incorporated herein. On the ground each corner is marked with its appropriate number. All monuments are ~~wooden posts~~ ^{pipes} at least four and one-half feet in length set firmly in the ground or in a mound of earth and rocks. The numbers established for the claim boundary monuments are shown on the aforesaid mining claim map.

The monumentation and marking of the corners was completed 28 June, 1985 in accordance with the Nevada Mining Laws.

The location work consists of a claim map as provided in NRS 517.040, and the \$15.00 lode claim filing fee has been paid to the County Recorder.

Dated this 5 day of July, 1985

Locator and Owner : Nevada Resources Inc.
239 Freeport Blvd., Sparks, NV
P.O. Box 7095
Reno, NV 89510

By : [Signature]
Agent

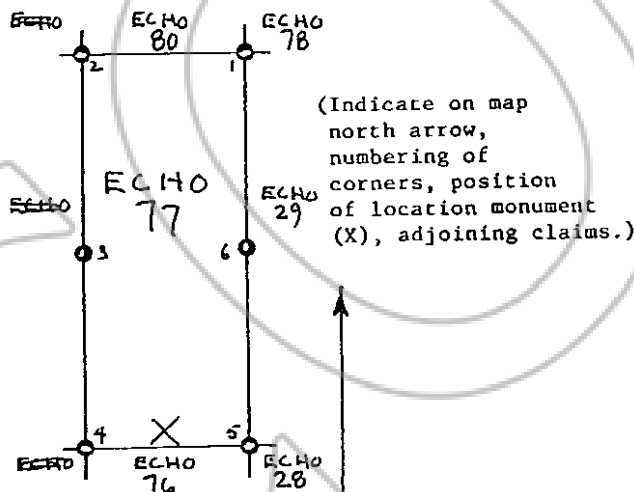

RECORDED AT REQUEST OF
Nevada Resources Inc
BOOK 137 PAGE 782

85 JUL 11 4 8: 08

OFFICIAL RECORDS
EUREKA COUNTY, NEVADA
H.N. REBALEATI, RECORDER
FILE NO. 99765
PFS 5.75

BOOK | 37 PAGE | 82

When Recorded Mail To:
Nevada Resources Inc.
P.O. Box 7095
Reno, NV 89510

99766

CERTIFICATION OF LOCATION OF LODE MINING CLAIM

THIS IS TO CERTIFY THAT the undersigned locator did on the 26 day of June, 1985, locate and claim in compliance with the Mining Laws of the United States and the State of Nevada, and the local customs and rules of the district in which the claim is located, the lode mining claim called the ECHO 78 mining claim in the SW/4 Sec 15, T16N, R48E, and the NW/4 Sec 22, T16N, R48E, M D B & M, in the unknown Mining District, Eureka County, State of Nevada.

The claim is 1500 feet long and 600 feet wide, and 10 feet are claimed in a N direction and 1490 ft in a S direction from the location monument, at which the notice of location is posted, and 200 feet on each side of the center line of the claim. The general course of the lode is north and south.

The position of each corner of this claim is shown on a mining claim map prepared pursuant to Chapter 517 of the Nevada Revised Statutes and recorded contemporaneously with the recording of this Certificate, which map is hereby by reference incorporated herein. On the ground each corner is marked with its appropriate number. All monuments are ^{posts} ~~posts~~ at least four and one-half feet in length set firmly in the ground or in a mound of earth and rocks. The numbers established for the claim boundary monuments are shown on the aforesaid mining claim map.

The monumentation and marking of the corners was completed 28 June, 1985 in accordance with the Nevada Mining Laws.

The location work consists of a claim map as provided in NRS 517.040, and the \$15.00 lode claim filing fee has been paid to the County Recorder.

Dated this 5 day of July, 1985

Locator Nevada Resources Inc.
and 239 Freeport Blvd., Sparks, NV
Owner: P.O. Box 7095
Reno, NV 89510

By: [Signature]
Agent

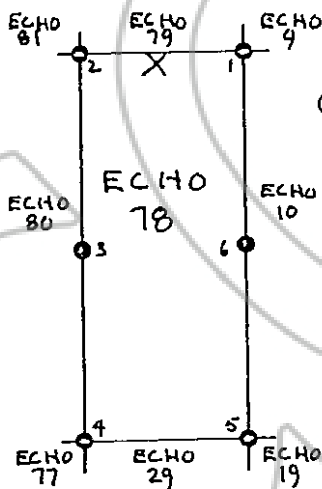

(Indicate on map north arrow, numbering of corners, position of location monument (X), adjoining claims.)

RECORDED AT REQUEST OF
Nevada Resources Inc
BOOK 137 PAGE 183

85 JUL 11 A 8: 06

OFFICIAL RECORDS
EUREKA COUNTY, NEVADA
M.N. REBALEATI, RECORDER
FILE NO. 99766
FEE \$ 5.25

BOOK | 37 PAGE | 83

When Recorded Mail To:
Nevada Resources Inc.
P.O. Box 7095
Reno, NV 89510

99767

CERTIFICATION OF LOCATION OF LODE MINING CLAIM

THIS IS TO CERTIFY THAT the undersigned locator did on the 26 day of June, 1985, locate and claim in compliance with the Mining Laws of the United States and the State of Nevada, and the local customs and rules of the district in which the claim is located, the lode mining claim called the ECHO 79 mining claim in the SW 1/4 Sec 15, T16N, R48E, and the /4 Sec , T16N, R48E, M D B & M, in the unknown Mining District, Eureka County, State of Nevada.

The claim is 1500 feet long and 600 feet wide, and 1490 feet are claimed in a N direction and 10 ft in a S direction from the location monument, at which the notice of location is posted, and 300 feet on each side of the center line of the claim. The general course of the lode is north and south.

The position of each corner of this claim is shown on a mining claim map prepared pursuant to Chapter 517 of the Nevada Revised Statutes and recorded contemporaneously with the recording of this Certificate, which map is hereby by reference incorporated herein. On the ground each corner is marked with its appropriate number. All monuments are ~~wooden~~ ^{metal} posts at least four and one-half feet in length set firmly in the ground or in a mound of earth and rocks. The numbers established for the claim boundary monuments are shown on the aforesaid mining claim map.

The monumentation and marking of the corners was completed 28 June, 1985 in accordance with the Nevada Mining Laws.

The location work consists of a claim map as provided in NRS 517.040, and the \$15.00 lode claim filing fee has been paid to the County Recorder.

Dated this 5 day of July, 1985

Locator
and
Owner : Nevada Resources Inc.
239 Freeport Blvd., Sparks, NV
P.O. Box 7095
Reno, NV 89510

By : [Signature]
Agent

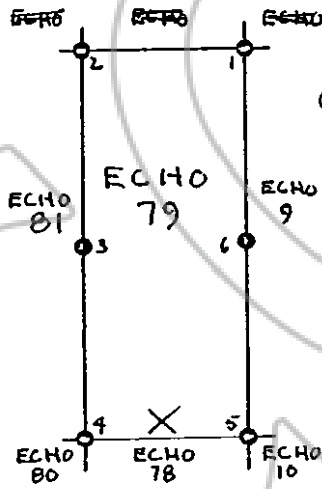

(Indicate on map
north arrow,
numbering of
corners, position
of location monument
(X), adjoining claims.)

RECORDED AT REQUEST OF
Nevada Resources Inc
BOOK 137 PAGE 184

85 JUL 11 8:06

OFFICIAL RECORDS
EUREKA COUNTY, NEVADA
M.N. REBELETTI, RECORDER
FILE NO. 99767
FFS \$ 5.75

BOOK 137 PAGE 184

When Recorded Mail To:
Nevada Resources Inc.
P.O. Box 7095
Reno, NV 89510

99768

CERTIFICATION OF LOCATION OF LODE MINING CLAIM

THIS IS TO CERTIFY THAT the undersigned locator did on the 26 day of June, 1985, locate and claim in compliance with the Mining Laws of the United States and the State of Nevada, and the local customs and rules of the district in which the claim is located, the lode mining claim called the ECHO 80 mining claim in the SW 14 Sec 15, T16N, R48E, and the NW 14 Sec 22, T16N, R48E, M D B & M, in the Unknown Mining District, Eureka County, State of Nevada.

The claim is 1500 feet long and 600 feet wide, and 10 feet are claimed in a N direction and 1490 ft in a S direction from the location monument, at which the notice of location is posted, and 300 feet on each side of the center line of the claim. The general course of the lode is north and south.

The position of each corner of this claim is shown on a mining claim map prepared pursuant to Chapter 517 of the Nevada Revised Statutes and recorded contemporaneously with the recording of this Certificate, which map is hereby by reference incorporated herein. On the ground each corner is marked with its appropriate number. All monuments are ^{in PVC} ~~wooden~~ posts at least four and one-half feet in length set firmly in the ground or in a mound of earth and rocks. The numbers established for the claim boundary monuments are shown on the aforesaid mining claim map.

The monumentation and marking of the corners was completed 28 June, 1985 in accordance with the Nevada Mining Laws.

The location work consists of a claim map as provided in NRS 517.040, and the \$15.00 lode claim filing fee has been paid to the County Recorder.

Dated this 5 day of July, 1985

Locator and Owner : Nevada Resources Inc.
239 Freeport Blvd., Sparks, NV
P.O. Box 7095
Reno, NV 89510

By : [Signature]
Agent

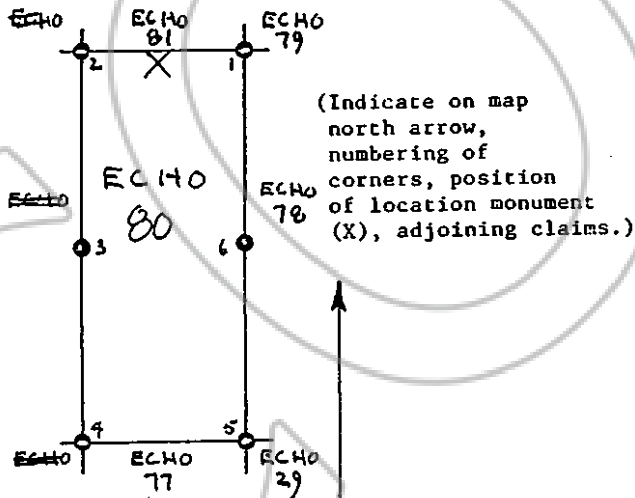

RECORDED AT REQUEST OF
Nevada Resources Inc.
BOOK 137 PAGE 185

85 JUL 11 A 8: 00

OFFICIAL RECORDS
EUREKA COUNTY, NEVADA
M.K. REBALEATI, RECORDER
FILE NO. 99768
OFF. 5.25

BOOK | 37 PAGE | 85

When Recorded Mail To:
Nevada Resources Inc.
P.O. Box 7095
Reno, NV 89510

99769

CERTIFICATION OF LOCATION OF LODE MINING CLAIM

THIS IS TO CERTIFY THAT the undersigned locator did on the 26 day of June, 1985, locate and claim in compliance with the Mining Laws of the United States and the State of Nevada, and the local customs and rules of the district in which the claim is located, the lode mining claim called the ECHO 81 mining claim in the SW 1/4 Sec 15, T16N, R48E, and the /4 Sec , T16N, R48E, M D B & M, in the unknown Mining District, Eureka County, State of Nevada.

The claim is 1500 feet long and 600 feet wide, and 1490 feet are claimed in a N direction and 10 in a S direction from the location monument, at which the notice of location is posted, and 300 feet on each side of the center line of the claim. The general course of the lode is north and south.

The position of each corner of this claim is shown on a mining claim map prepared pursuant to Chapter 517 of the Nevada Revised Statutes and recorded contemporaneously with the recording of this Certificate, which map is hereby by reference incorporated herein. On the ground each corner is marked with its appropriate number. All monuments are ^{in PVC} ~~wood~~ posts at least four and one-half feet in length set firmly in the ground or in a mound of earth and rocks. The monuments established for the claim boundary monuments are shown on the aforesaid mining claim map.

The monumentation and marking of the corners was completed 28 June, 1985 in accordance with the Nevada Mining Laws.

The location work consists of a claim map as provided in NRS 517.040, and the \$15.00 lode claim filing fee has been paid to the County Recorder.

Dated this 5 day of July, 1985

Locator and Owner : Nevada Resources Inc.
239 Freeport Blvd., Sparks, NV
P.O. Box 7095
Reno, NV 89510

By : R. H. Halan
Agent

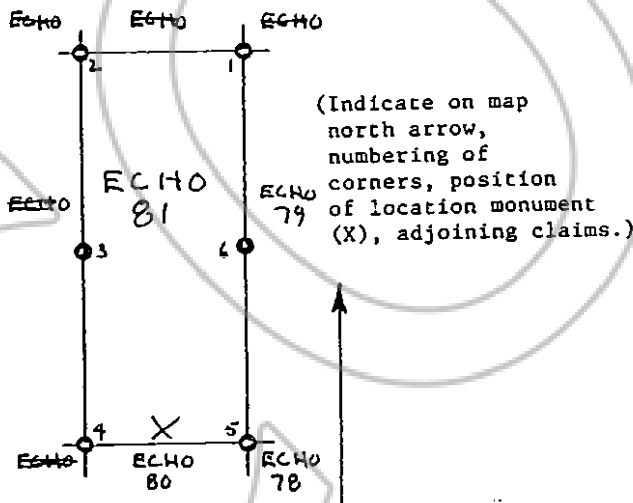

RECORDED AT REQUEST OF
Nevada Resources Inc.
BOOK 137 PAGE 186

85 JUL 11 4 8:06

OFFICIAL RECORDS
EUREKA COUNTY, NEVADA
M.N. REBALEATI, RECORDER
FILE NO. 99769
FEE \$ 5.75

BOOK 137 PAGE 186