

When Recorded Mail To:  
Nevada Resources Inc.  
P.O. Box 7095  
Reno, NV 89510

99777

### CERTIFICATION OF LOCATION OF LODE MINING CLAIM

THIS IS TO CERTIFY THAT the undersigned locator did on the 26 day of June, 1985, locate and claim in compliance with the Mining Laws of the United States and the State of Nevada, and the local customs and rules of the district in which the claim is located, the lode mining claim called the ANT 15 mining claim in the NW 1/4 Sec 30, T16N, R50E, and the        /4 Sec       , T16N, R50E, M D B & M, in the unknown Mining District, Eureka County, State of Nevada.

The claim is 1500 feet long and 600 feet wide, and 10 feet are claimed in a NW direction and 1490 ft in a SE direction from the location monument, at which the notice of location is posted, and 300 feet on each side of the center line of the claim. The general course of the lode is N 40° W.

The position of each corner of this claim is shown on a mining claim map prepared pursuant to Chapter 517 of the Nevada Revised Statutes and recorded contemporaneously with the recording of this Certificate, which map is hereby by reference incorporated herein. On the ground each corner is marked with its appropriate number. All monuments are wooden posts at least four and one-half feet in length set firmly in the ground or in a mound of earth and rocks. The numbers established for the claim boundary monuments are shown on the aforesaid mining claim map.

The monumentation and marking of the corners was completed 11 July, 1985 in accordance with the Nevada Mining Laws.

The location work consists of a claim map as provided in NRS 517.040, and the \$15.00 lode claim filing fee has been paid to the County Recorder.

Dated this 11 day of July, 1985

Locator and Owner : Nevada Resources Inc.  
239 Freeport Blvd., Sparks, NV  
P.O. Box 7095  
Reno, NV 89510

By : [Signature]  
Agent

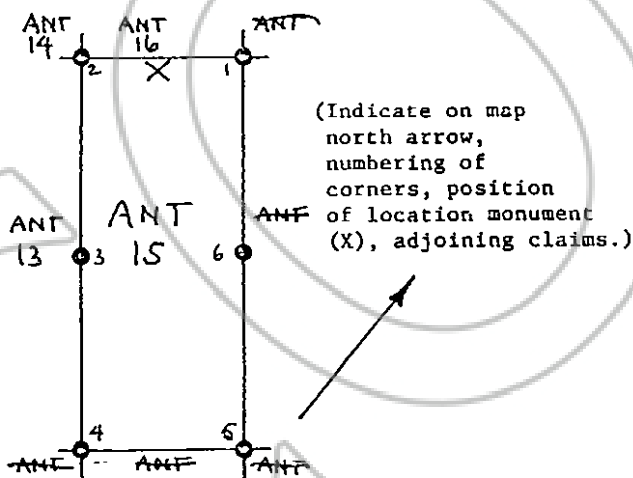

RECORDED AT REQUEST OF  
Nevada Resources Inc  
BOOK 132 PAGE 193

85 JUL 11 A 8:08

OFFICIAL RECORDS  
EUREKA COUNTY, NEVADA  
M.N. REBALEATI, RECORDER  
FILE NO. 99777  
PAGE 575

BOOK 137 PAGE 93