

# Affidavit or Statement of Annual Assessment Work (PROOF OF LABOR)

ON UNPATENTED MINING CLAIM

TO ALL WHOM IT MAY CONCERN:

The undersigned hereby certifies (certify) that he (she, they) has (have) expended more than \$ 3,600.00 dollars for labor and improvements, as the annual assessment work for the year ending September 1, 1985, on the (list claim names here)

35 claims, numbered IK 1-35, recorded at Eureka County, Nevada  
as follows:

LOCATED	RECORDED	No.	BOOK	PAGE	NMC
IK 1-30	11-81	1-15-82	82738-67	100	126-155 230001-30
IK 31-35	11-82	11-19-82	85777-81	106	509-513 255283-87

lode (placer) mining claim(s) in Section 32, Township 35N, Range 51E, in the Maggie Creek Mining District, in Eureka County, Nevada, owned by INTERNATIONAL METALS & ENERGY for the purpose of holding said claim(s).

The claim map showing said claim(s) is filed as Document No. 82738-67, 85777-81 in the Eureka County records.

Said labor was performed or improvements made by (name and address) SEWELL  
MINERAL EXPLORATION, 9950 East Broadway, Tucson, Arizona 85748  
 between the dates of June 1, 1985 and August 31, 1985, and consisted of  
a soil and rock chip geochemical survey.

NOTE: Group Assessment Work is Authorized in 30 U.S.C. 28 and C.F.R. 433851.1

(Describe work done, and claim or part of claim affected)

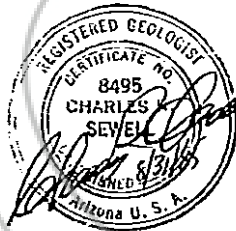
Dated this 23rd day of August, 1985.(Name of subscriber)  
Charles R. Sewell

(Witness)

(Witness)

Subscribed and sworn to before me this

23rd day of Aug, 1985.Patricia D. Wilson

My Commission Expires 11-12-85

Note 1: This Affidavit or Statement of Annual Assessment work must be filed within 60 days after the performance of labor or making of improvements.

Note 2: "Each locator shall file two copies of a map prepared in accordance with NRS 517.030 with the county recorder in which the claim is located not later than September 1, 1972." NRS 517.230, Subsection 3.

RECORDER'S STAMP

BOOK 138 PAGE 353

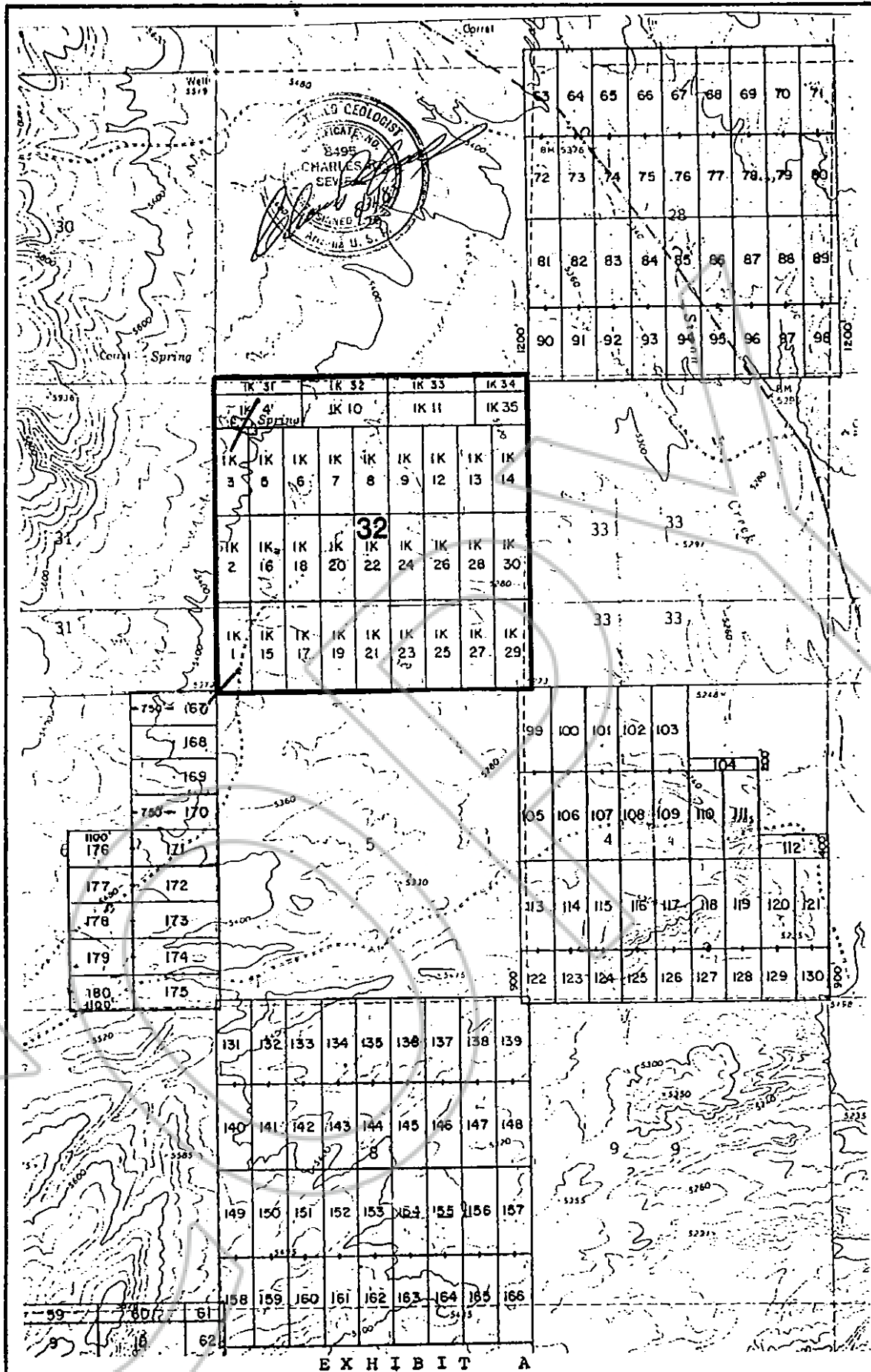

# INTERNATIONAL METALS and ENERGY

## Carlin Project: I.K. and W.P. Claims GEOCHEMICAL SURVEY

Eureka County Nevada  
Sewell Mineral Exploration

Summer 85  
1 in = 2000 ft

GEOCHEMICAL  
ANOMALY

As,  
Hg

BOOK 138 PAGE 54

SEWELL MINERAL EXPLORATION

9950 E. BROADWAY

TUCSON, ARIZONA 85748

PH. (602) 296-3492

EXHIBIT B

CARLIN AREA PROJECT: IK & WP CLAIMS, EUREKA COUNTY, NEVADA

To Whom It May Concern,

During the summer of 1985 (June 1, 1985 to August 31, 1985) SEWELL MINERAL EXPLORATION, Tucson, Arizona conducted a geochemical survey of selected parts of the following lode mining claims: IK 1-35 & WP 1-248. These claims are controlled by INTERNATIONAL METALS & ENERGY (I.M. & E.), Suite 1020, Wichita Towers - Wichita Falls, Texas 76301.

This work was designed as a logical follow up to the previous programs of geology, geochemistry, geophysics & drilling. All this work was conducted by W.P. & P.D. Seward & M.S. Sewell under the supervision of C.R. Sewell. Mr. C.R. Sewell holds a M.S. degree in geology & has more than 30 years experience in mineral exploration. The addresses & qualifications of the geoscientists who preformed the field work are:

W.P. Seward  
Spring Creek, Nv.

P.D. Seward  
Spring Creek, Nv.

M.S. Sewell  
Tucson, Arizona

B.S. in Geology  
Calif. State University  
5 years experience in Au  
exploration.

B.S. in Chemistry & Genetics  
University of Calif @ Davis  
2 years experience in Au  
geochemistry & assaying.

B.S. in Geology  
University of Arizona,  
5 years experience in  
mineral exploration.

RECORDED AT REQUEST OF  
*International Metals & Energy Corp.*  
BOOK 138 PAGE 353

85 SEP 5 P 1:08

OFFICIAL RECORD  
EUREKA COUNTY, NEVADA  
H.N. REBALEATI, RECORDER  
FILE NO. 100246  
FEE \$ 45.00

Sincerely Yours,



C.R. SEWELL  
SEWELL MINERAL EXPLORATION

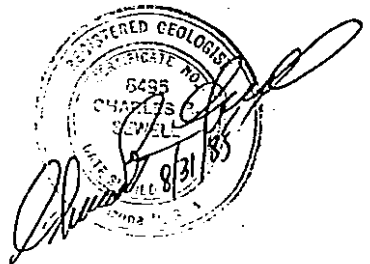

BOOK 138 PAGE 355