

Affidavit or Statement of Annual Assessment Work (PROOF OF LABOR)

ON UNPATENTED MINING CLAIM

TO ALL WHOM IT MAY CONCERN:

The undersigned hereby certifies (certify) that he (she, they) has (have) expended more than \$ 3,200.00 dollars for labor and improvements, as the annual assessment work for the year ending September 1, 19 85, on the (list claim names here)

32 claims, numbered WP 99-130, located 7-24-83, recorded at
Eureka County, Nevada, on August 12, 1983, under numbers 88517-88548
in Book 113, Pages 1-32, B.L.M. (Reno) reported: August 22, 1983
N.M.C. 279260-279291.

lude (placer) mining claim(s) in Section 4, Township 34N, Range 51E, in the Maggie Creek Mining District, in Eureka County, Nevada, owned by International Metals & Energy Corp., for the purpose of holding said claim(s).

The claim map showing said claim(s) is filed as Document No. 88517-88548 in the Eureka County records.

Said labor was performed or improvements made by (name and address) SEWELL
MINERAL EXPLORATION, 9950 East Broadway, Tucson, Arizona 85748
between the dates of June 1, 1985 and August 31, 1985, and consisted of
a soil and rock chip geochemical survey.

NOTE: Group Assessment Work is Authorized in 30 U.S.C. 28 and
C.F.R. 433851.1

(Describe work done, and claim or part of claim affected)

Dated this 23rd day of August, 19 85.

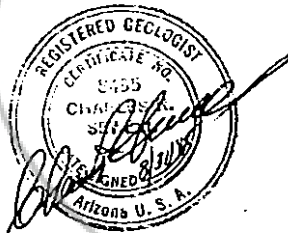

(Name of subscriber)

Charles R. Sewell

(Witness)

(Witness)

Subscribed and sworn to before me this

23rd day of Aug, 1985

Patricia D. Wilson

My Commission Expires 11-12-85

Note 1: This Affidavit or Statement of Annual Assessment work must be filed within 60 days after the performance of labor or making of improvements.

Note 2: "Each locator shall file two copies of a map prepared in accordance with NRS 517.030 with the county recorder in which the claim is located not later than September 1, 1972." NRS 517.230, Subsection 3.

RECORDER'S STAMP

BOOK 138 PAGE 359

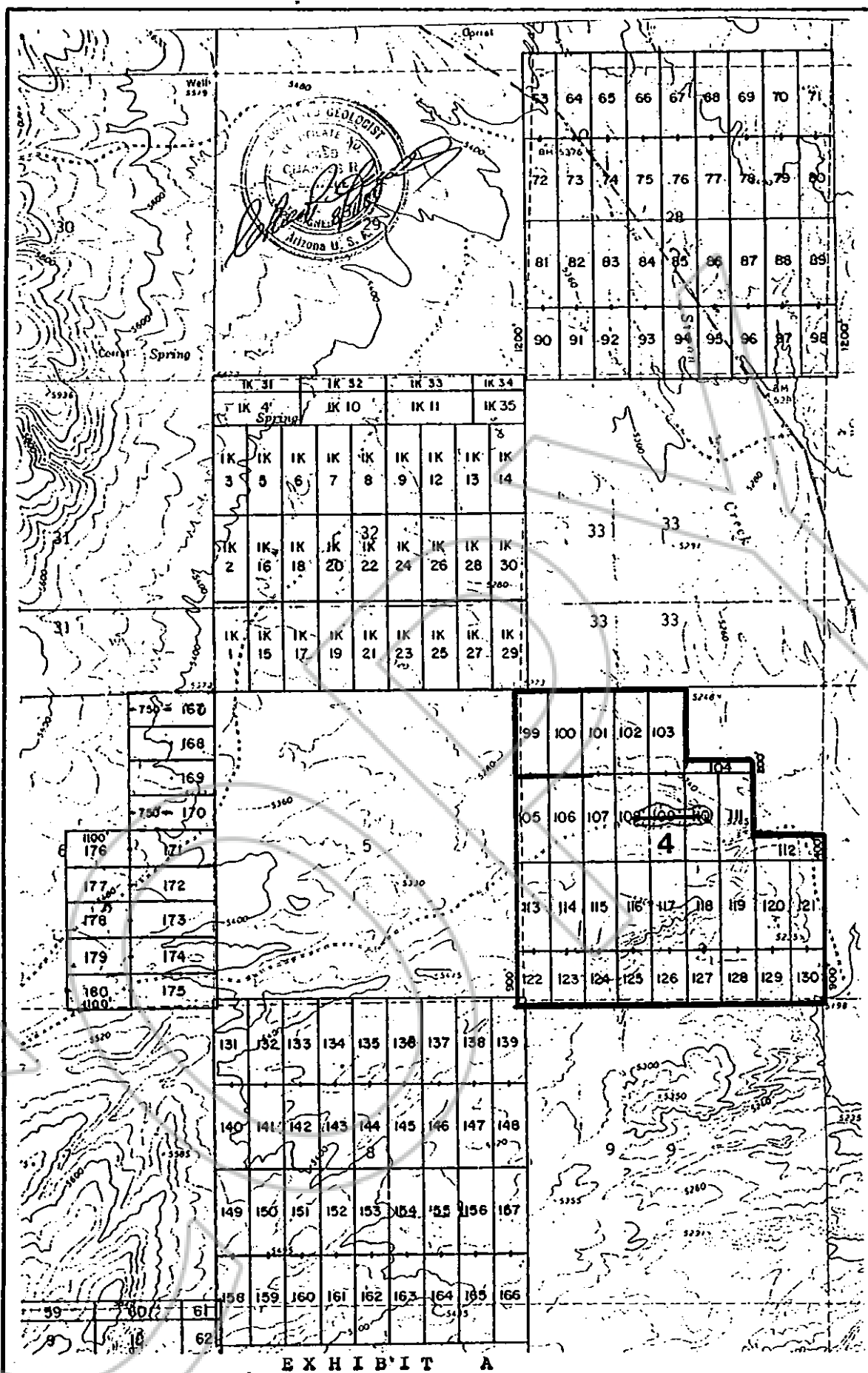

EXHIBIT A

INTERNATIONAL METALS and ENERGY

Carlin Project: I.K. and W.P. Claims

GEOCHEMICAL SURVEY

Eureka County Nevada

Summer 85

Sewell Mineral Exploration

1 in = 2000 ft

GEOCHEMICAL ANOMALY



BOOK 13 PAGE 36

SEWELL MINERAL EXPLORATION
9950 E. BROADWAY
TUCSON, ARIZONA 85748
PH. (602) 296-3492

EXHIBIT B

CARLIN AREA PROJECT: IK & WP CLAIMS, EUREKA COUNTY, NEVADA

To Whom It May Concern,

During the summer of 1985 (June 1, 1985 to August 31, 1985) SEWELL MINERAL EXPLORATION, Tucson, Arizona conducted a geochemical survey of selected parts of the following lode mining claims: IK 1-35 & WP 1-248. These claims are controlled by INTERNATIONAL METALS & ENERGY (I.M. & E.), Suite 1020, Wichita Towers - Wichita Falls, Texas 76301.

This work was designed as a logical follow up to the previous programs of geology; geochemistry, geophysics & drilling. All this work was conducted by W.P. & P.D. Seward & M.S. Sewell under the supervision of C.R. Sewell. Mr. C.R. Sewell holds a M.S. degree in geology & has more then 30 years experience in mineral exploration. The addresses & qualifications of the geoscientists who preformed the field work are:

W.P. Seward
Spring Creek, Nv.

B.S. in Geology
Calif. State University
5 years experience in Au
exploration.

P.D. Seward
Spring Creek, Nv.

B.S. in Chemistry & Genetics
University of Calif @ Davis
2 years experience in Au
geochemistry & assaying.

M.S. Sewell
Tucson, Arizona

B.S. in Geology
University of Arizona,
5 years experience in
mineral exploration.

RECORDED AT REQUEST OF
International Metals & Energy Corp.
BOOK 138
Page 359
Sincerely yours,

85 SEP 5

SEWELL MINERAL EXPLORATION

OFFICIAL RECORDS
EUREKA COUNTY, NEVADA
M.H. REDLEAF, RECORDER
FILE NO. 100248
FFE \$ 40.00

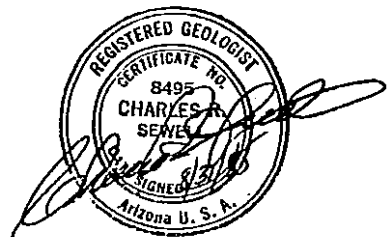

BOOK 138 PAGE 361