

CERTIFICATE OF MINING LOCATION  
(NEVADA-LODE)

NOTICE IS HEREBY GIVEN that on the 5th day of August, 1985, the Right 5050 lode mining claim was located by Amselco Exploration, Inc., whose address is E. 11616 Montgomery Road, Suite 4, Spokane, WA 99206. The claim is situated in the Unorg. Mining District, County of Eureka, State of Nevada, and is located in the following quarter section(s):

- SE 1/4, Section 7, T 35N., R 52E., M.D.B. & M.
- SW 1/4, Section 8, T 35N., R 52E., M.D.B. & M.
- NE 1/4, Section 18, T 35N., R 52E., M.D.B. & M.
- NW 1/4, Section 17, T 35N., R 52E., M.D.B. & M.

This claim is 1500 feet in length along the course of the claim, being 1470 feet from the point of discovery in a S direction to the S end line of this claim, and 30 feet in a N direction to the N end line of the claim. This claim is 300 feet in width, being 300 feet in width on each side of the center line of the claim. The general course of the claim is N-S.

The location monument of this claim is situated with reference to some natural object or permanent monument as follows: App. 4100' S 0° E from the NW Cor. Sec. 8, T. 35N., R. 52E.

The corners of this claim are marked by 4" Pipe with metal tags inscribed with the appropriate corner as shown on the following sketch and the accompanying claim map.

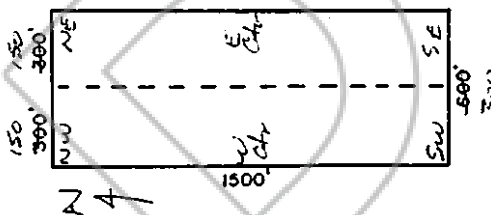

The location work consisted of making the maps as provided in NSR 517.040.

Dated and posted on the ground this 5th day of August, 1985.

Locator: [Signature]  
Agent for Amselco Exploration Inc.  
E. 11616 Montgomery Road, Suite 4  
Spokane, WA 99206

RECORDED AT REQUEST OF  
Amselco Exploration Inc.  
BOOK 138 PAGE 418

85 SEP 9 11:00

OFFICIAL RECORDS  
EUREKA COUNTY, NEVADA  
M.N. REBALEATI, RECORDER  
FILE NO. 100264  
575

CERTIFICATE OF MINING LOCATION  
(NEVADA-LODE)

NOTICE IS HEREBY GIVEN that on the 5th day of August, 1985, the FISH 5051 lode mining claim was located by Amselco Exploration, Inc., whose address is E. 11616 Montgomery Road, Suite 4, Spokane, WA 99206. The claim is situated in the Unorg. Mining District, County of Eureka, State of Nevada, and is located in the following quarter section(s):

NW 1/4, Section 17, T 35N., R 52E., M.D.B. & M.  
SW 1/4, Section 8, T 35N., R 52E., M.D.B. & M.  
1/4, Section \_\_\_\_\_, T \_\_\_\_\_., R \_\_\_\_\_., M.D.B. & M.  
1/4, Section \_\_\_\_\_, T \_\_\_\_\_., R \_\_\_\_\_., M.D.B. & M.

This claim is 1500 feet in length along the course of the claim, being 1476 feet from the point of discovery in a S direction to the S end line of this claim, and 30 feet in a N direction to the N end line of the claim. This claim is 600 feet in width, being 300 feet in width on each side of the center line of the claim. The general course of the claim is N-S.

The location monument of this claim is situated with reference to some natural object or permanent monument as follows: App. 4150' SSE from the NW Cor. Sec. 8, T. 35N., R. 52E.

The corners of this claim are marked by 4" Pipe with metal tags inscribed with the appropriate corner as shown on the following sketch and the accompanying claim map.

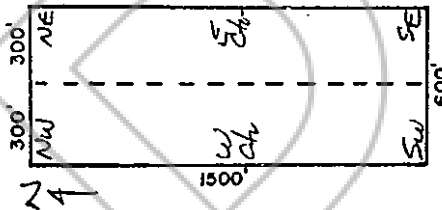

The location work consisted of making the maps as provided in NSR 517.040.

Dated and posted on the ground this 5th day of August, 1985.

Locator: [Signature]

Agent for Amselco Exploration Inc.  
E. 11616 Montgomery Road, Suite 4  
Spokane, WA 99206

RECORDED AT REQUEST OF  
Amselco Exploration Inc  
BOOK 138 PAGE 419

35 SEP 9 11:00

OFFICIAL RECORDS  
ESQUEA COUNTY, NEVADA  
M.H. NEVADA RECORDS  
FILE NO. 100265  
S. 5.75

CERTIFICATE OF MINING LOCATION  
(NEVADA-LODE)

NOTICE IS HEREBY GIVEN that on the 5th day of August, 1985, the Fish 5150 lode mining claim was located by Amselco Exploration, Inc., whose address is E. 11616 Montgomery Road, Suite 4, Spokane, WA 99206. The claim is situated in the Amargosa Mining District, County of Eureka, State of Nevada, and is located in the following quarter section(s):

- NW 1/4, Section 8, T 35N., R 52E., M.D.B. & M.
- SE 1/4, Section 7, T 35N., R 52E., M.D.B. & M.
- SW 1/4, Section \_\_\_\_\_, T \_\_\_\_\_, R \_\_\_\_\_, M.D.B. & M.
- NE 1/4, Section \_\_\_\_\_, T \_\_\_\_\_, R \_\_\_\_\_, M.D.B. & M.

This claim is 1500 feet in length along the course of the claim, being 1470 feet from the point of discovery in a N direction to the N end line of this claim, and 50 feet in a S direction to the S end line of the claim. This claim is 300 feet in width, being 300 feet in width on each side of the center line of the claim. The general course of the claim is N-S.

The location monument of this claim is situated with reference to some natural object or permanent monument as follows: App. 4000' S 0° E from the NW cor. Sec. 8, T. 35N., R. 52E.

The corners of this claim are marked by 4" Pipe with metal tags inscribed with the appropriate corner as shown on the following sketch and the accompanying claim map.

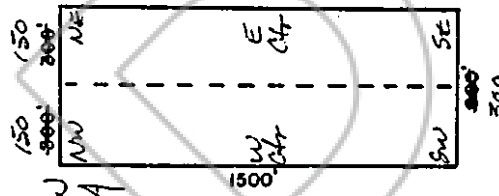

The location work consisted of making the maps as provided in NSR 517.040.

Dated and posted on the ground this 5th day of August, 1985.

Locator: [Signature]  
Agent for Amselco Exploration Inc.  
E. 11616 Montgomery Road, Suite 4  
Spokane, WA 99206

RECORDED AT REQUEST OF  
Amselco Exploration Inc.  
BOOK 138 PAGE 420

85 SEP 9 AM 11:00  
85 SEP 9 AM 11:00

OFFICIAL RECORDS  
EUREKA COUNTY, NEVADA  
HARRIS DALEATI, RECORDER  
HARRIS DALEATI, RECORDER  
File No. 100266  
Fee \$ 5.75

CERTIFICATE OF MINING LOCATION  
(NEVADA-LODE)

NOTICE IS HEREBY GIVEN that on the 5th day of August, 1985, the Fish 5151 lode mining claim was located by Amselco Exploration, Inc., whose address is E. 11616 Montgomery Road, Suite 4, Spokane, WA 99206. The claim is situated in the Miners Mining District, County of Elko/Eureka, State of Nevada, and is located in the following quarter section(s):

SW1/4, Section 8, T 35N, R 52E, M.D.B. & M.  
1/4, Section \_\_\_\_\_, T \_\_\_\_\_, R \_\_\_\_\_, M.D.B. & M.  
1/4, Section \_\_\_\_\_, T \_\_\_\_\_, R \_\_\_\_\_, M.D.B. & M.  
1/4, Section \_\_\_\_\_, T \_\_\_\_\_, R \_\_\_\_\_, M.D.B. & M.

This claim is 1500 feet in length along the course of the claim, being 1470 feet from the point of discovery in a N direction to the N end line of this claim, and 30 feet in a S direction to the S end line of the claim. This claim is 600 feet in width, being 300 feet in width on each side of the center line of the claim. The general course of the claim is N-S.

The location monument of this claim is situated with reference to some natural object or permanent monument as follows: App. 4000' SSE from The NW Cor. Sec. 8, T. 35N., R. 52E.

The corners of this claim are marked by 4" Pipe with metal tags inscribed with the appropriate corner as shown on the following sketch and the accompanying claim map.

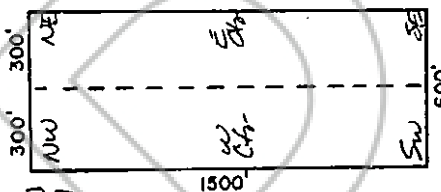

The location work consisted of making the maps as provided in NSR 517.040.

Dated and posted on the ground this 5th day of August, 1985.

Locator: [Signature]  
Agent for Amselco Exploration Inc.  
E. 11616 Montgomery Road, Suite 4  
Spokane, WA 99206

RECORDED AT REQUEST OF  
Amselco Exploration Inc.  
BOOK 138 PAGE 421

85 SEP 9 11:00

OFFICIAL RECORDS  
EUREKA COUNTY, NEVADA  
M.N. REDEALT, RECORDER  
FILE NO. 100267  
S. 575

BOOK 138 PAGE 421