

AFFIDAVIT OF ASSESSMENT WORK - NEVADA

STATE OF TEXAS)
) SS.
COUNTY OF HARRIS)

Steven H. Humphreys, being first duly sworn upon oath deposes and states that:

1. As a person cognizant of the facts, he makes this affidavit for and on behalf of Exxon Corporation.
2. Said Exxon Corporation is the party at whose expense the labor and improvements below mentioned were made or performed and is the owner, optionee or lessee of the unpatented mining claims below mentioned.
3. The labor or improvements below mentioned were made and performed for the assessment work year ending September 1, 1985, and the same were accomplished between the 5th day of August, 1985 and the 8th day of August, 1985.
4. The unpatented lode mining claims, upon which or for the benefit of which the work was performed or improvements made constitute a group of contiguous lode mining claims, are located in Elko and Eureka County, Nevada, and are listed in the schedule marked Exhibit A, attached to and hereby made a part of this affidavit of assessment work.
5. The amount of money expended was \$3,475.00
_____ ; the character of labor or improvements was _____
geophysical survey attached as Exhibits B and C
_____ ;
and the person or corporation who performed the work or made the improvement was Richard C. Fox, President, Practical Geophysics, Inc.

FURTHER Affiant saith naught.

Witness:
James Caple
Dorothy Stewart

Steven H. Humphreys
Steven H. Humphreys
Affiant for and on behalf of
Exxon Corporation *Paul Davis*

Subscribed and sworn to by the above named affiant and subscribing witnesses before me this 18th day of October, 1985.



My commission expires: 9-19-87

Nita Lee
Notary Public

NITA LEE
Notary Public in and for Harris County, Texas
My Commission Expires September 19, 1987

STATE OF TEXAS)
) SS.
COUNTY OF HARRIS)

On October 18, 1985, before me, a notary public, personally appeared Steven H. Humphreys, who acknowledged to me that he executed the above instrument.



My commission expires: 9-19-87

Nita Lee
Notary Public

NITA LEE
Notary Public in and for Harris County, Texas
My Commission Expires September 19, 1987

Canyon Resources Corporation
1019 8th Street, Suite #100
Golden, Colorado 80401

Elreka #6939
Elko and Eureka Counties,
Nevada

CLAIM NAME	CLAIM NO.	SECTION	TOWNSHIP	RANGE	BLM MC NO.	BOOK/PAGE
CC	40	20,29	35N	52E	NMC 293384	118/129
CC	41	20,29	35N	52E	NMC 293385	444/444
CC	42	20,29	35N	52E	NMC 293386	444/445
CC	43	20,29	35N	52E	NMC 293387	444/446
CC	44	20,29	35N	52E	NMC 293388	444/447
CC	45	20,29	35N	52E	NMC 293389	444/448
CC	46	20	35N	52E	NMC 293390	444/449
CC	47	20,21	35N	52E	NMC 293391	444/450
CC	48	20	35N	52E	NMC 293392	118/130
CC	49	20	35N	52E	NMC 293393	444/451
CC	50	20	35N	52E	NMC 293394	444/452
CC	51	20	35N	52E	NMC 293395	444/453
CC	52	20	35N	52E	NMC 293396	444/454
CC	53	20	35N	52E	NMC 293397	444/455
CC	54	20	35N	52E	NMC 293398	444/456
CC	55	20,21	35N	52E	NMC 293399	444/457
CC	56	20	35N	52E	NMC 293400	118/131
CC	57	20	35N	52E	NMC 293401	444/458
CC	58	20	35N	52E	NMC 293402	444/459
CC	59	20	35N	52E	NMC 293403	444/460
CC	60	20	35N	52E	NMC 293404	444/461
CC	61	20	35N	52E	NMC 293405	444/462
CC	62	20	35N	52E	NMC 293406	444/463
CC	63	20,21	35N	52E	NMC 293407	444/464
CC	64	17,20	35N	52E	NMC 293408	118/132
CC	65	17,20	35N	52E	NMC 293409	444/465
CC	66	17,20	35N	52E	NMC 293410	444/466
CC	67	17,20	35N	52E	NMC 293411	444/467
CC	68	17,20	35N	52E	NMC 293412	444/468
CC	69	17,20	35N	52E	NMC 293413	444/469
CC	70	17,20	35N	52E	NMC 293414	444/470
CC	71	16,17,20,21	35N	52E	NMC 293415	444/471

Said labor which was performed upon or for the above mentioned mining claims consisted of a geophysical survey, as follows:

- (1) The survey was performed at the locations in relation to the points of discovery and the boundaries of the claims which are indicated on the map or plat hereto attached, marked Exhibit B, and by reference made a part hereof.
- (2) In August, 1985, a 6000-foot long line (Line 1) was surveyed. Resistivity, Induced Polarization and Self-Potential data were collected. The cost of the geophysical survey was \$3,475.00.
- (3) The basic findings of the survey are set forth on the profiles marked Exhibit C, and by reference made a part hereof.
- (4) The survey was conducted by a qualified expert and the name, address and professional background of such person is Richard C. Fox, President, Practical Geophysics, Inc., 1234 Winder Lane, Salt Lake City, Utah 84124. Mr. Fox received his Baccalaureate Degree in Geology from Bowling Green State University, Ohio, in 1964 and a Masters Degree in Geophysics from the University of Utah in 1968. Since 1966, Mr. Fox has worked as a minerals exploration geophysicist.

R 52 E

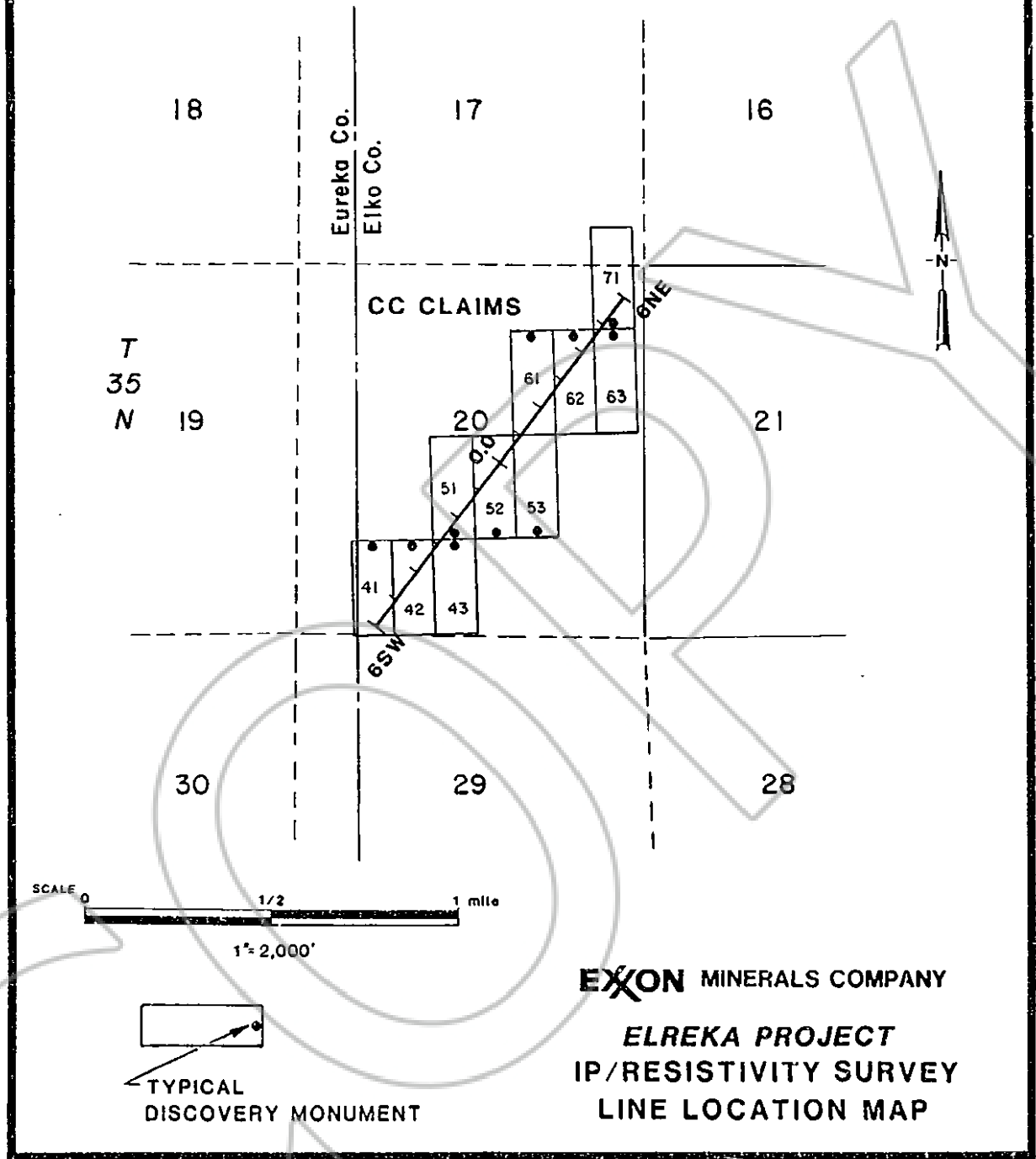

EXHIBIT C

EXXON Minerals Company
 Elreka Project -- Eureka and Elko Counties, Nevada

August 7, 1985

Line 1-SP -- Bearing N. 37° E.
 Station Spacing -- 100 feet

Voltmeter's Common Lead Connected to Stationary Reference
 Potential Electrode

Station	Millivolts		
	Reading 1	Reading 2	Reading 3
1 + 00 SW	-18	- 9	5
2 + 00 SW	- 5	-20	-22
3 + 00 SW	-19	-20	-19
4 + 00 SW	-22	-26	-27
5 + 00 SW	-29	-27	-25
6 + 00 SW	-22	-24	-19
7 + 00 SW	-21	-17	-19
8 + 00 SW	-15	-13	-16
9 + 00 SW	-25	-28	-27
10 + 00 SW	- 8	- 7	-13
11 + 00 SW	-13	-20	-18
12 + 00 SW	- 8	- 8	- 8
13 + 00 SW	2	- 7	- 2
14 + 00 SW	11	7	-11
15 + 00 SW	-12	-14	-16
16 + 00 SW	-23	-19	- 8
17 + 00 SW	2	- 1	18
18 + 00 SW	- 2	- 8	- 3
19 + 00 SW	10	2	- 1
20 + 00 SW	- 9	- 3	3
21 + 00 SW	20	16	17
22 + 00 SW	15	11	7
23 + 00 SW	7	- 7	2
24 + 00 SW	16	- 3	5
25 + 00 SW	10	22	12
26 + 00 SW	5	10	8
27 + 00 SW	2	6	8
28 + 00 SW	- 7	13	10
29 + 00 SW	- 7	6	13
30 + 00 SW	3	-11	6

PRACTICAL GEOPHYSICS, INC.

1634 WINDER LANE
 SALT LAKE CITY, UTAH 84124
 TELEPHONE: (801) 277-1844

EXXON Minerals Company
Elreka Project -- Eureka and Elko Counties, Nevada

August 7, 1985

Line 1-SP -- Bearing N. 37° E.
Station Spacing -- 100 feet

Voltmeter's Common Lead Connected to Stationary Reference
Potential Electrode

Station	Millivolts		
	Reading 1	Reading 2	Reading 3
1 + 00 NE	- 3	2	4
2 + 00 NE	- 2	6	3
3 + 00 NE	- 1	9	8
4 + 00 NE	9	4	- 4
5 + 00 NE	10	- 5	- 4
6 + 00 NE	-18	- 8	-11
7 + 00 NE	-13	-12	- 3
8 + 00 NE	2	4	1
9 + 00 NE	-10	-19	- 2
10 + 00 NE	- 7	- 2	3
11 + 00 NE	-16	-18	-20
12 + 00 NE	-10	-11	- 9
13 + 00 NE	- 4	- 3	- 1
14 + 00 NE	-10	- 8	- 9
15 + 00 NE	- 1	- 1	- 7
16 + 00 NE	-10	-16	- 9
17 + 00 NE	- 7	- 1	- 1
18 + 00 NE	1	- 1	- 4
19 + 00 NE	-13	7	- 9
	2	- 6	- 7
20 + 00 NE	- 3	-10	-12
21 + 00 NE	- 8	-14	-10
22 + 00 NE	-18	-21	-20
23 + 00 NE	- 2	- 3	- 5
24 + 00 NE	7	10	7
25 + 00 NE	20	5	1
26 + 00 NE	36	7	7
	- 4	3	4
27 + 00 NE	-18	-15	-13
28 + 00 NE	-10	3	5
29 + 00 NE	- 4	- 3	-18
30 + 00 NE	-13	- 7	-10

PRACTICAL GEOPHYSICS, INC.

1834 WINDER LANE
SALT LAKE CITY, UTAH 84124
TELEPHONE: (801) 277-1844

BOOK | 39 PAGE 439

PRACTICAL GEOPHYSICS, INC.
SALT LAKE CITY, UTAH

DIPOLE-DIPOLE ARRAY APPARENT RESISTIVITY AND INDUCED POLARIZATION

$a = 50.0'$

Line Bearing N 37° E

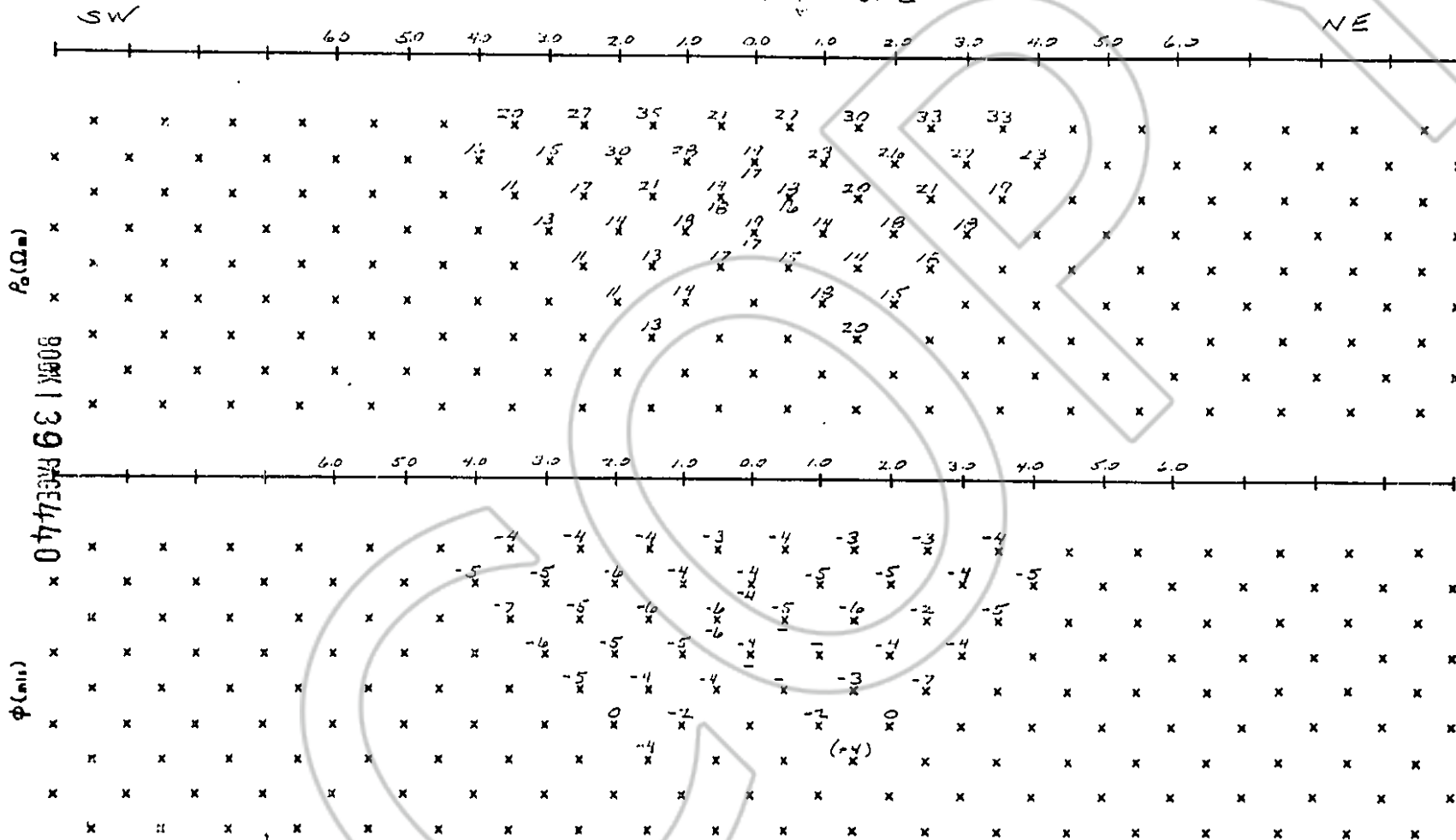
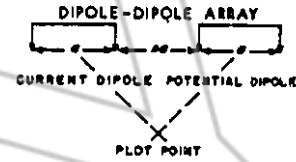

PROJECT Elreka - Exxon STATE Nevada LINE 1 DATA BY ARM/R.C.F DATE 8-6-85 TRANSMITTER ET-15 RECEIVER DR-1 Proto

RECORDED AT REQUEST OF
Exxon Minerals Co.
BOOK 139 PAGE 434

85 OCT 25 AM 11:17

OFFICIAL RECORDS
EUREKA COUNTY, NEVADA
M.N. REBALEATI, RECORDER
FILE No. 100571
FEE \$ 40.00

COPY

BOOK | 39 PAGE 44 |