

CERTIFICATE OF LOCATION

The UNDERSIGNED hereby certifies that ATLAS PRECIOUS METALS INC., by its agent, the undersigned, has located a mining claim in the UNKNOWN Mining District, County of EUREKA, State of Nevada, on a vein known as the N3190.

Said claim was located on the 11 day of November, 1985.

The locator claims 1500 linear feet in length in a NORTH/SOUTH direction along the course of said vein or lode running 1490 feet SOUTH and 10 feet NORTH, from the point of location at which this location certificate is posted, with a width of 300 linear feet on each side of the center of the vein or lode along the entire length of said claim.

The metes and bounds description of claim is as follows:

Beginning at the Northeast Corner Post Number 1,

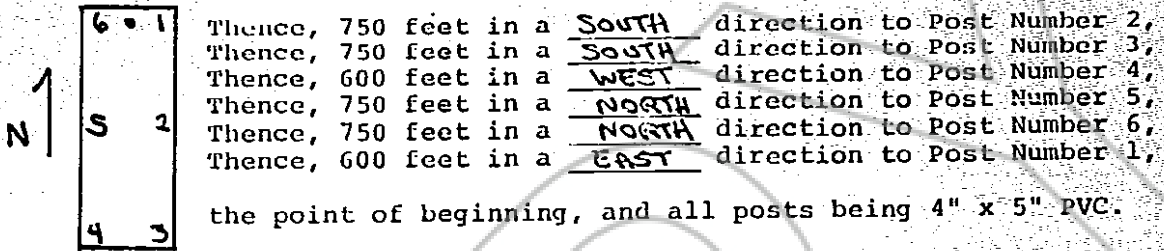

Said claim is located within: (Section lines are projected)
SE 1/4, Section 30, Township 23N, Range 50E
 1/4, Section _____, Township _____, Range _____
 1/4, Section _____, Township _____, Range _____
 1/4, Section _____, Township _____, Range _____

Mt. Diablo Meridan, County of EUREKA, State of Nevada.

To tie this claim to the Public Land Survey, begin at the NE Corner, Section 24, Township 23N, Range 49E, Mt. Diablo Meridan, thence bear South, 7500 feet and West, 4350 feet to the Northeast Corner of this claim. (Section lines are projected.)

The location work consisted of making the map as provided in NRS 517.040.

Dated 11/17, A.D., 1985, and filed in duplicate.

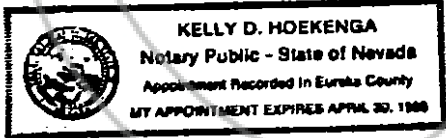

STATE OF NEVADA)
) ss.
 COUNTY OF EUREKA)

ATLAS PRECIOUS METALS INC.
 P. O. Box 1207
 Moab, Utah 84532

by Gregory McN. French
 Its Agent

Subscribed and sworn to before me this 27th day of Nov., 1985, by Gregory McN. French, as Agent for ATLAS PRECIOUS METALS INC.

My Commission Expires: 04-30-86

Kelly D. Hoekenga
 Notary Public

RECORDED AT REQUEST OF
ATLAS PRECIOUS METALS
 BOOK 142 PAGE 265

86 JAN 31 AM 10 00

OFFICIAL RECORDS
 EUREKA COUNTY, NEVADA
 M.N. REGALATI, RECORDER
 FILE NO. 101997
 REC # 5.75

STATE OF NEVADA)
) ss.
 COUNTY OF EUREKA)