

86 MAY 27 P 2: 48

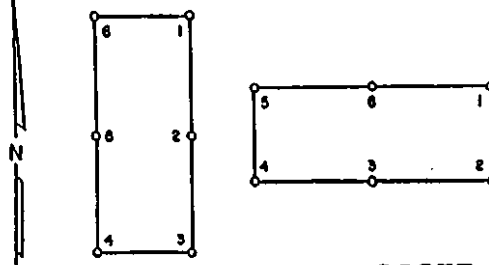

102655

OFFICIAL RECORDS
 EUREKA COUNTY, NEVADA
 M.N. REBALANCE RECORDER
 FILE NO. 102655
 FEE \$ 5.75

CERTIFICATE OF LOCATION - NEVADA

THE UNDERSIGNED, hereby certifies that ATLAS PRECIOUS METALS INC., by its Agent, the undersigned, does hereby locate the SL 3 Lode Mining Claim on this 12th day of March, 19 86, situated in the Eureka Mining District, Eureka County, Nevada.

Said Claim is located in the SW (Quarter) Section(s) 4, Township 19 North, Range 53 East, Mt. Diablo P.M., and more particularly described as follows, to wit:

Beginning at the northeast corner post No. 1,

Thence, 600 feet in a South direction to Post No. 2,
 Thence, 750 feet in a West direction to Post No. 3,
 Thence, 750 feet in a West direction to Post No. 4,
 Thence, 600 feet in a North direction to Post No. 5,
 Thence, 750 feet in a East direction to Post No. 6,
 Thence, 750 feet in a East direction to Post No. 1,

the point of beginning and all posts being 4" x 4 1/2" wood.

The claim monument on which the Notice is posted lies approximately midway between the two sides and is 1490 feet from the East end and 10 feet from the West end.

To tie this Claim to the Public Survey, begin at the northwest corner, Section 9, Township 19 N., Range 53 E., Mt. Diablo P.M., bear North, 2004 feet, and East, 1972 feet to the northeast corner of this Claim.

The location work consisted of making the map as provided in NRS 517.040. Dated May 13 A.D., 19 86, and filed in duplicate.

Atlas Precious Metals Inc.
 P.O. Box 1207
 Moab, Utah 84532

By: [Signature]
 Its Agent
 -Locator-

STATE OF NEVADA }
 COUNTY OF EUREKA } SS.

Sworn to and acknowledged before me this 27th day of May, 19 86, by Richard J. Kehmeier as Agent for ATLAS PRECIOUS METALS INC.

[Signature]
 Notary Public

My Commission Expires:

9/29/89



OFFICIAL SEAL
 SHIRLEY ALLISON
 Notary Public-Nevada
 EUREKA COUNTY
 My Comm. Exp. SEPT 29, 1989