

86 MAY 27 P 2: 54

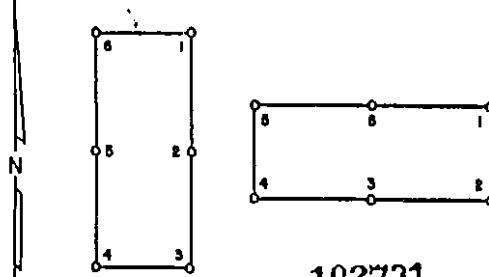

102731

OFFICIAL RECORDS  
EUREKA COUNTY, NEVADA  
FILE NO. 102731  
FFI 5.75

CERTIFICATE OF LOCATION - NEVADA

THE UNDERSIGNED, hereby certifies that ATLAS PRECIOUS METALS INC., by its Agent, the undersigned, does hereby locate the SL 77 Lode Mining Claim on this 12th day of March, 1986, situated in the Eureka Mining District, Eureka County, Nevada.

Said Claim is located in the NE (Quarter) Section(s) 17, Township 19 North, Range 53 East, Mt. Diablo P.M., and more particularly described as follows, to wit:

Beginning at the northeast corner post No. 1,

Thence, 600 feet in a South direction to Post No. 2,  
Thence, 750 feet in a West direction to Post No. 3,  
Thence, 750 feet in a West direction to Post No. 4,  
Thence, 600 feet in a North direction to Post No. 5,  
Thence, 750 feet in a East direction to Post No. 6,  
Thence, 750 feet in a East direction to Post No. 1,

the point of beginning and all posts being 4" X 4 1/2" wood.

The claim monument on which the Notice is posted lies approximately midway between the two sides and is 1490 feet from the East end and 10 feet from the West end.

To tie this Claim to the Public Survey, begin at the northwest corner, Section 9, Township 19 N., Range 53 E., Mt. Diablo P.M., bear South, 5796 feet, and West, 1028 feet to the northeast corner of this Claim.

The location work consisted of making the map as provided in NRS 517.040.  
Dated May 13 A.D., 1986, and filed in duplicate.

Atlas Precious Metals Inc.  
P.O. Box 1207  
Moab, Utah 84532

By: [Signature]  
Its Agent  
-Locator-

STATE OF NEVADA )  
COUNTY OF EUREKA ) SS.

Sworn to and acknowledged before me this 27th day of May, 1986, by Richard J. Kehmeier as Agent for ATLAS PRECIOUS METALS INC.

My Commission Expires:  
9/29/89



OFFICIAL SEAL  
SHIRLEY ALLISON  
Notary Public-Nevada  
EUREKA COUNTY  
My Comm. Exp. SEPT 29, 1989

Notary Public