

104697

3 September 1986

T36N, R50W

Field Date  
20 August 1986

- Revised -

## CERTIFIED LAND CORNER RECORDATION

## DESCRIPTION OF CORNER EVIDENCE FOUND, AND ORIGINAL RECORD (if known)

Record:-- North between Sections 31 and 32 for corner common to Sections 29, 30, 31, and 32.  
80.00 Set a charred post in mound with pits as per instructions for Cor. to Sections 29, 30, 31, and 32.

Found:-- A 2" aluminum pipe with aluminum cap inscribed as shown

see below

## DESCRIPTION OF MONUMENT AND ACCESSORIES ESTABLISHED TO PERPETUATE THE ORIGINAL LOCATION OF THIS CORNER:

Set:-- Nothing.

## SKETCH, WITH COURSE AND DISTANCE TO ADJACENT CORNER IF DETERMINED IN THIS SURVEY.

(May Sketch or Paste Reproduction on Reverse Side.)

Reference:-- Book NV2, page 4.

Found:--  
Continued

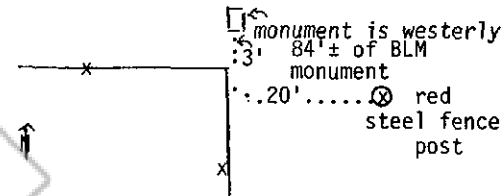

with a green steel fence post alongside to N. Sly., 9 ft. from a mound of stone. Previously reported red steel fence post missing. From which a 2" aluminum pipe with aluminum cap inscribed CARLIN GOLD -- WESTERN STATES 1985 SETTLEMENT LINE PT NO.

11

I, Paul N. Scherbel certify that I have carefully performed or reviewed the work done on the diagrammed corner as reported on this recordation form and approve the same.

Signature of Surveyor

6805

Registration No.

STATE OF ~~WYOMING~~ NEVADA

Office of Clerk and Recorder,

County of EUREKA

This "corner record" was filed for record on the 10<sup>th</sup> day of Sept. at 1:40 p.m., was noted on the cross-index plat and is assigned page No. V-5, in book No. 36-50.

cc: BLM  
Burton

County Official

Cross Index No. \_\_\_\_\_ T. \_\_\_\_\_ R. \_\_\_\_\_ Mer.  
\_\_\_\_\_ T. \_\_\_\_\_ R. \_\_\_\_\_ Mer.  
\_\_\_\_\_ T. \_\_\_\_\_ R. \_\_\_\_\_ Mer.  
\_\_\_\_\_ T. \_\_\_\_\_ R. \_\_\_\_\_ Mer.  
\_\_\_\_\_ T. \_\_\_\_\_ R. \_\_\_\_\_ Mer.  
\_\_\_\_\_ T. \_\_\_\_\_ R. \_\_\_\_\_ Mer.