

FILED AT THE REQUEST OF Placer U.S. Inc.
on Sept 22, 1986 at 46 mins past 8 A.M.
RECORDS OF
EUREKA COUNTY, NEVADA M.N. REBALEATI, Recorder
File No. 104888 Fee \$ 975.00

<p>PLACER U.S. INC. ONE CALIFORNIA STREET SUITE 2500 SAN FRANCISCO, CALIFORNIA 94111</p>	<p>DRAWN: K.A.G.</p>	<p>DATE: AUG. 1986</p>	<p>PROJECT HORSE CANYON EUREKA COUNTY, NEVADA</p>	<p>TITLE NEE LODE CLAIMS # 522-thru-534, & # 549-thru-572</p>		
	<p>DRAFTED: H.H.H.</p>	<p>REVISIONS:</p>			<p>MAP NO. 1 of 2</p>	<p>VENTURE NO.</p>
	<p>SCALE 0 400' 800 FT.</p>				<p>T26N & T27N, R48E M.D.B. & M.</p>	

S. 60° E. 7,350'
 NE Cor. Sec. 31, T26N, R48E

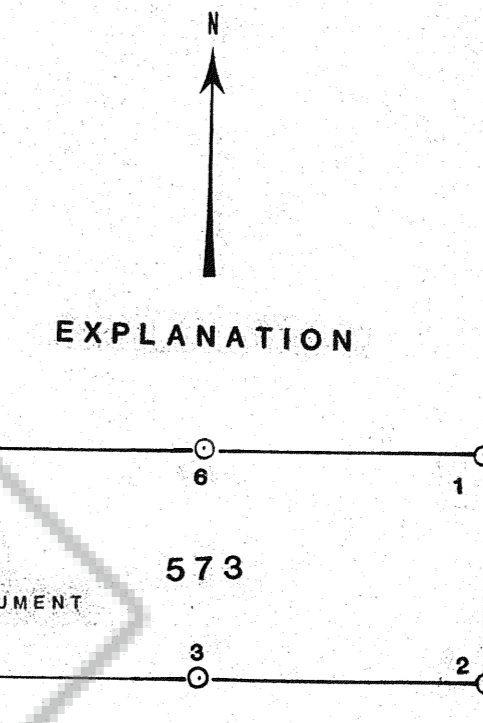

OWNED BY: CORTEZ GOLD MINES

FILED AT THE REQUEST OF Placer U.S. Inc.
 on Sept 27 1986 at 46 mins past 8 A.M.
 RECORDS OF
 EUREKA COUNTY, NEVADA
 M.N. REBALEATI, Recorder
 Fee \$ 975.00
 File No. 104888

<p>PLACER U.S. INC. ONE CALIFORNIA STREET SUITE 2500 SAN FRANCISCO, CALIFORNIA 94111</p>	DRAWN: K.A.G.	DATE: AUG. 1986	PROJECT HORSE CANYON EUREKA COUNTY, NEVADA	TITLE NEE LODE CLAIMS # 535-thru-548 & # 573-thru-586 T26N & T27N, R48E M.D.B. & M.
	DRAFTED: H.H.H.	REVISIONS:		
SCALE 0 400 800 FT.				