

Range 51 East

Due east 360ft to the common corner of Sections 1, 2, 11 & 12, T. 32 N., R. 51 E.

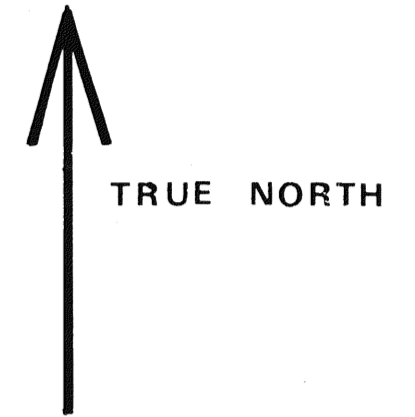
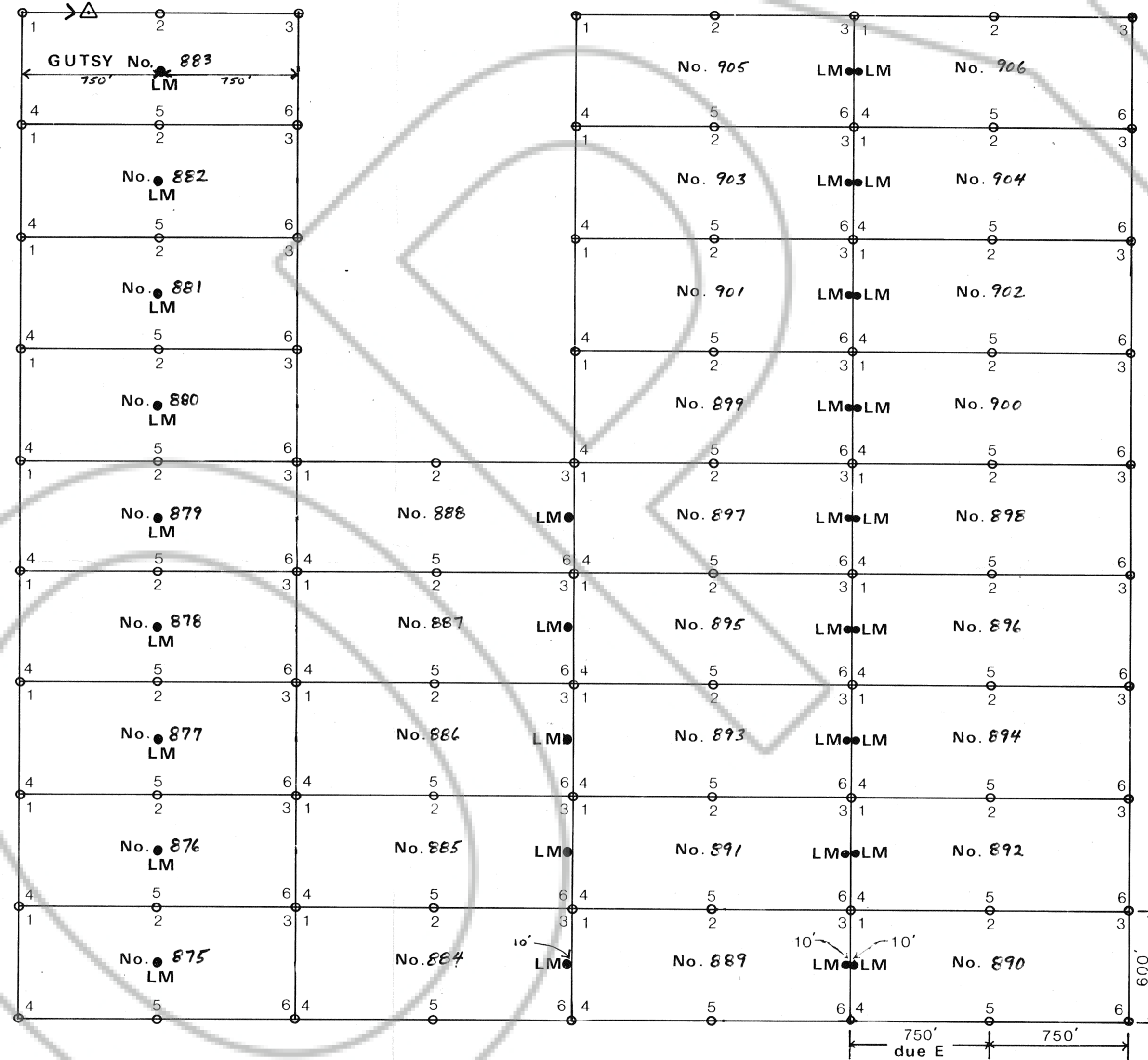

Township 32 North

(All boundary posts & location monuments are 3 in. dia. plastic posts 5 ft. long)

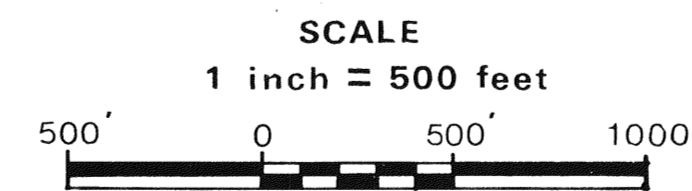

MAP OF THE GUTSY No. 875 thru 906 GROUP OF  
CONTIGUOUS LODE MINING CLAIMS

Township 32 North, Range 51 East, Section 12

Unknown Mining District, Eureka County, Nevada

Located January 23<sup>rd</sup>, 1987 by Bob Goodson

169 Cedar Street  
Elko, Nevada 89801

FILED AT THE REQUEST OF B. B. Goodson  
 on March 9<sup>th</sup> 1987 at 50 mins past 3 P.M.  
 CLERK OF COUNTY CLERK, NEVADA  
 File No. 107695 Fee \$40.00